

SEE NOTE 1
STA. 1B+50

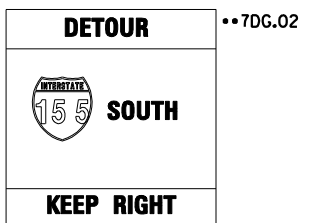

TEMPORARY DETOUR SIGN TO REMAIN
STA. 525+00.00, 74.50' LT
(SEE DETOUR PLAN)

PROPOSED CONCRETE BARRIER
STA. 516+00.00 TO STA. 552+00.00

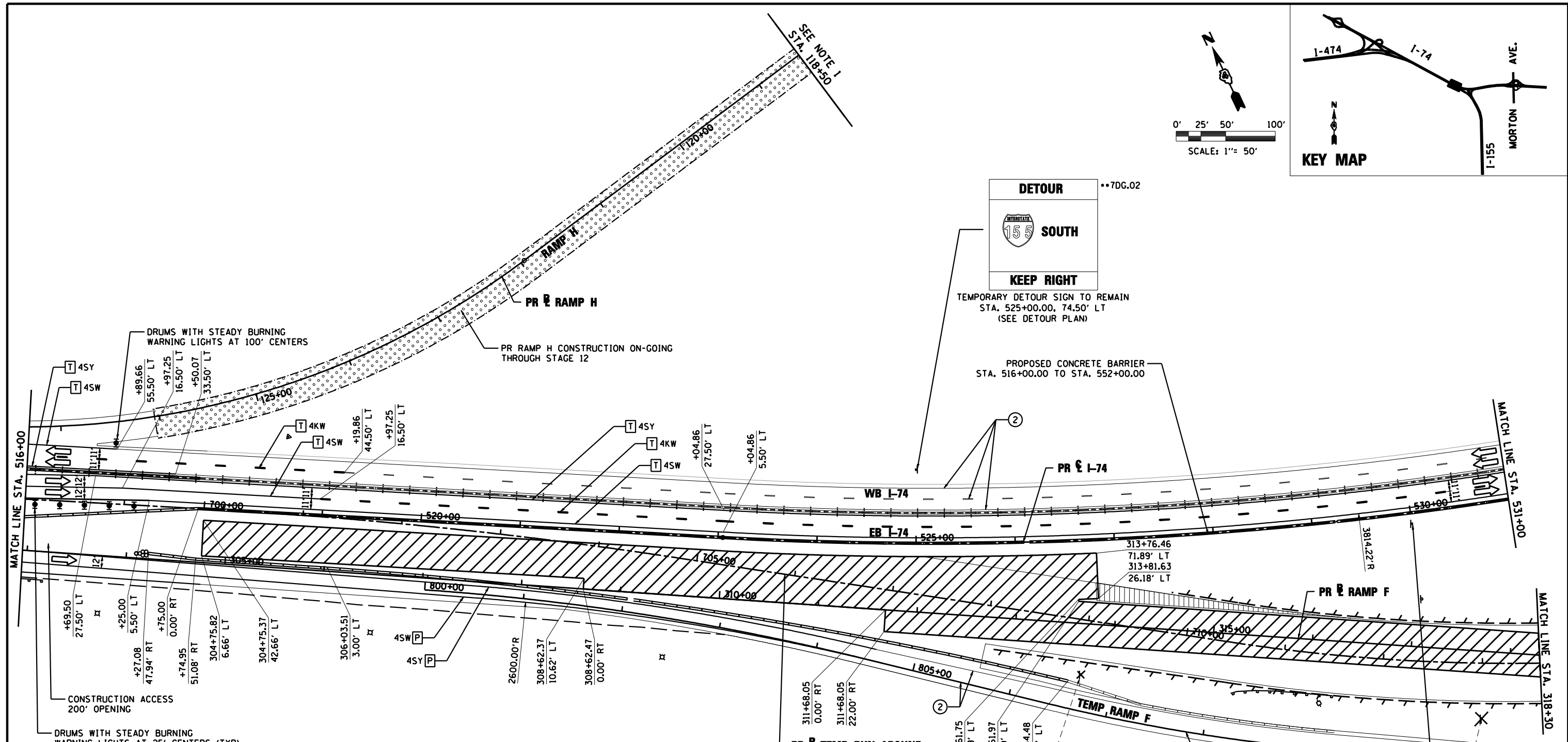
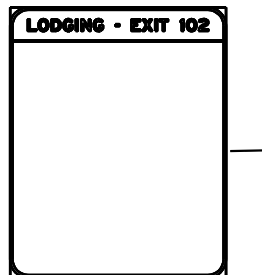
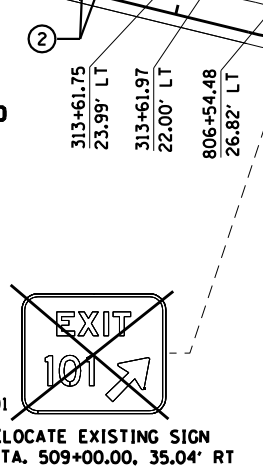

NOTE

- ON-GOING WORK ON RAMP G & H. SEE PROPOSED GEOMETRY PLANS

PAVEMENT MARKING LEGEND

- ① EXISTING PAVEMENT MARKING
 - ② TEMPORARY PAVEMENT MARKING FROM PREVIOUS STAGE
 - ③ PROPOSED PAVEMENT MARKING IN PLACE (SEE PROPOSED PAVEMENT MARKING PLAN)
 - T PAVEMENT MARKING TAPE, TYPE III
 - P POLYUREA PAVEMENT MARKING TYPE II
- | | | | |
|------|---|------|--------------------------------|
| 4SW | 4" SOLID WHITE | 8SW | 8" SOLID WHITE |
| 4SY | 4" SOLID YELLOW | 12SW | 12" SOLID WHITE @ 20' SPACING |
| 4SYY | 4" SOLID DOUBLE YELLOW (11" C-C) | 12SY | 12" SOLID YELLOW @ 20' SPACING |
| 4KW | 4" SKIP-DASH WHITE (30' SKIP, 10' DASH) | 24SW | 24" SOLID WHITE STOP BAR |
| 4DW | 4" DOTTED WHITE (9' SKIP, 3' DASH) | LSW | LETTERS & SYMBOLS, WHITE |

LEGEND

- DRUMS WITH STEADY BURNING WARNING LIGHTS
 - DIRECTION INDICATOR
 - BARRICADE WITH STEADY BURN MONODIRECTIONAL LIGHT
 - || VERTICAL DELINEATOR PANELS
 - FLASHING ARROW BOARD
 - DIRECTION OF TRAFFIC FLOW
 - IMPACT ATTENUATOR, TEMPORARY (NON-REDIRECTIVE)
 - IMPACT ATTENUATOR, TEMPORARY (NARROW, REDIRECTIVE)
 - TCP• SIGN INCLUDED IN TRAFFIC CONTROL & PROTECTION (SEE SIGN SCHEDULE)
- XX-X SIGN REFERENCE NUMBER (SEE SIGN SCHEDULE)
- TEMPORARY PAVEMENT CONSTRUCTION
 - ON-GOING EARTHWORK FOR PROPOSED PAVEMENT
 - PROPOSED PAVEMENT CONSTRUCTION
 - TEMP PVMT REMOVAL (SEE REMOVAL PLAN FOR EX PVMT REMOVAL)
 - REM TEMP AGGREGATE SHOULDERS
 - AGGREGATE SHOULDERS, TYPE B 6"
 - TEMPORARY CONCRETE BARRIER
 - TEMPORARY CONCRETE BARRIER WITH 36" GLARE SCREEN

FILE NAME =	DESIGNED - HTL	REVISED -
D468620-shr-staging07_174-11.dgn	DRAWN - JPS	REVISED -
USER NAME = TERRA	CHECKED - DA/LVA	REVISED -
PLOT DATE = 7/16/2012	DATE - 7/20/2012	REVISED -



STATE OF ILLINOIS
DEPARTMENT OF TRANSPORTATION

MAINTENANCE OF TRAFFIC
STAGE 11

SCALE: SHEET NO. 7 OF 13 SHEETS STA. 516+00 TO STA. 531+00

F.A.I. RTE.	SECTION	COUNTY	TOTAL SHEETS	SHEET NO.
•	90-[14R(14HB-4,14,14HB)BR]	TAZEWELL	2433	1026
CONTRACT NO. 68620			ILLINOIS FED. AID PROJECT	