

**WORK ZONE** W21-1115(0)-3618  
•TCP•

**SPEED LIMIT** R2-1-3648  
•TCP•

**45**

**BEGINS** W2-1113(0)-3612  
•TCP•

**\$375 FINE MINIMUM** R21-1106-3618  
•TCP•

MESSAGE BOARD SHALL READ:  
"DETOUR AHEAD I-74 WEST"

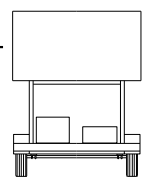

STA. 39+00.00

STA. 41+00.00



•TCP•  
W3-2(0)-48  
STA 45+00



•TCP•  
W20-1103(0)-48  
STA 49+41

EXISTING SIGN TO REMAIN

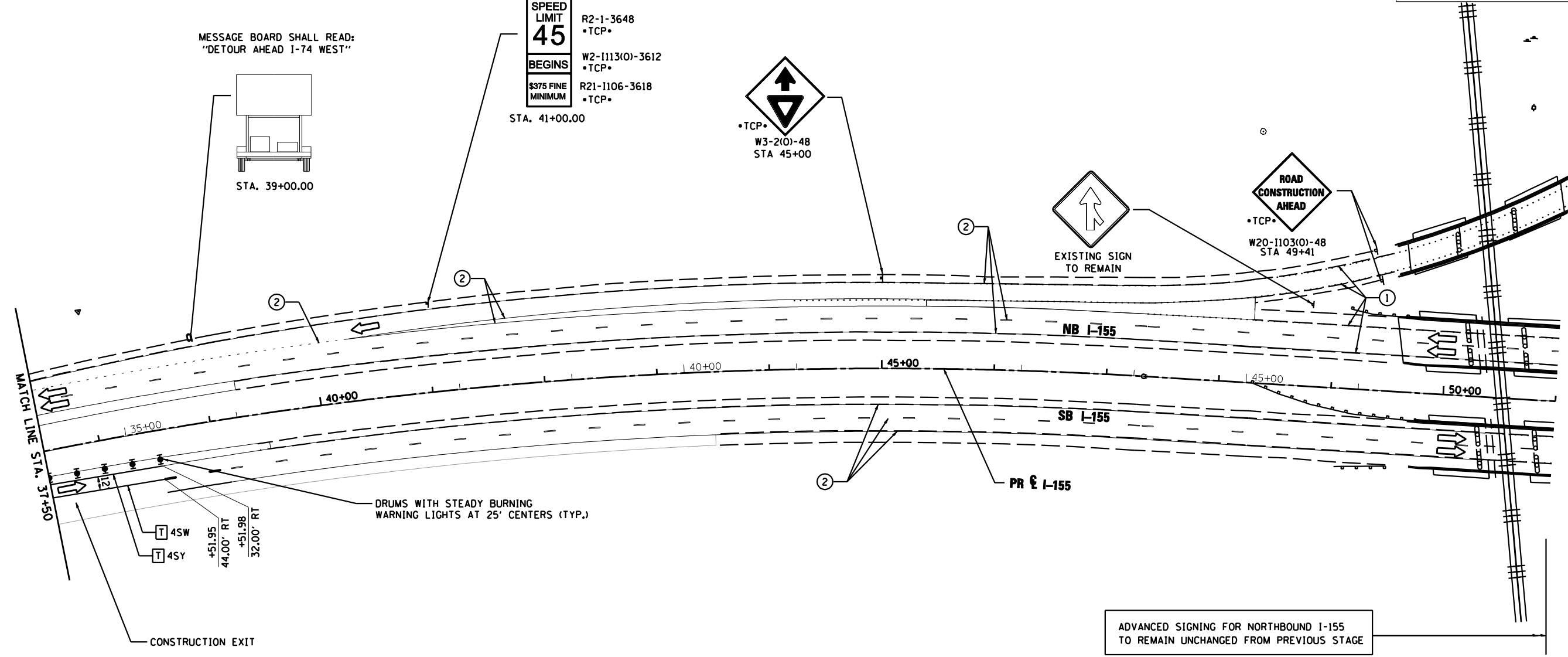

ADVANCED SIGNING FOR NORTHBOUND I-155 TO REMAIN UNCHANGED FROM PREVIOUS STAGE

**PAVEMENT MARKING LEGEND**

- ① EXISTING PAVEMENT MARKING
- ② PAVEMENT MARKING FROM PREVIOUS STAGE
- ③ PROPOSED PAVEMENT MARKING IN PLACE (SEE PROPOSED PAVEMENT MARKING PLAN)
- T PAVEMENT MARKING TAPE, TYPE III
- P POLYUREA PAVEMENT MARKING TYPE II

- |      |   |      |                                |
|------|---|------|--------------------------------|
| 4SW  | 4" SOLID WHITE                          | 8SW  | 8" SOLID WHITE                 |
| 4SY  | 4" SOLID YELLOW                         | 12SW | 12" SOLID WHITE @ 20' SPACING  |
| 4SYY | 4" SOLID DOUBLE YELLOW (11" C-C)        | 12SY | 12" SOLID YELLOW @ 20' SPACING |
| 4KW  | 4" SKIP-DASH WHITE (30' SKIP, 10' DASH) | 24SW | 24" SOLID WHITE STOP BAR       |
| 4DW  | 4" DOTTED WHITE (9' SKIP, 3' DASH)      | LSW  | LETTERS AND SYMBOLS, WHITE     |

**LEGEND**

- ☼ DRUMS WITH STEADY BURNING WARNING LIGHTS
- ➔ DIRECTION INDICATOR BARRICADE WITH STEADY BURN MONODIRECTIONAL LIGHT
- ▬ VERTICAL DELINEATOR PANELS
- ⊥ BARRICADE, TYPE III
- ⬆ FLASHING ARROW BOARD
- ➔ DIRECTION OF TRAFFIC FLOW
- ⊘ IMPACT ATTENUATOR, TEMPORARY (NON-REDIRECTIVE)
- ⊘ IMPACT ATTENUATOR, TEMPORARY (NARROW, REDIRECTIVE)
- TCP• SIGN INCLUDED IN TRAFFIC CONTROL & PROTECTION (SEE SIGN SCHEDULE)
- ▨ TEMPORARY PAVEMENT CONSTRUCTION
- ▨ ON-GOING EARTHWORK FOR PROPOSED PAVEMENT
- ▨ PROPOSED PAVEMENT CONSTRUCTION
- ▨ TEMP PVMT REMOVAL (SEE REMOVAL PLAN FOR EX PVMT REMOVAL)
- ▨ REM TEMP AGGREGATE SHOULDERS
- ▨ AGGREGATE SHOULDERS, TYPE B 6"
- ▨ TEMPORARY CONCRETE BARRIER
- ▨ TEMPORARY CONCRETE BARRIER WITH 36" GLARE SCREEN
- XX-X SIGN REFERENCE NUMBER (SEE SIGN SCHEDULE)

FILE NAME =	DESIGNED - HTL	REVISED -
D468620-shr-staging23 1155-12.dgn	DRAWN - JPS	REVISED -
USER NAME = TERRA	CHECKED - DA/LVA	REVISED -
PLOT DATE = 7/16/2012	DATE - 7/20/2012	REVISED -



**STATE OF ILLINOIS**  
**DEPARTMENT OF TRANSPORTATION**

**MAINTENANCE OF TRAFFIC**  
**STAGE 12**

SCALE: SHEET NO. 13 OF 13 SHEETS STA. 37+50 TO STA. 51+00

F.A.I. RTE.	SECTION	COUNTY	TOTAL SHEETS	SHEET NO.
•	90-[14R(14HB-4,14,14HVB)BR]	TAZEWELL	2433	1083
			CONTRACT NO. 68620	
ILLINOIS FED. AID PROJECT				