

F.A.S. RTE.	SECTION	COUNTY	TOTAL SHEETS	SHEET NO.
1388	(Z-1D-BR-1)I-2	PEORIA	7	1
		ILLINOIS	CONTRACT NO. 68B20	

D-94-067-12



STATE OF ILLINOIS
DEPARTMENT OF TRANSPORTATION
DIVISION OF HIGHWAYS
**PROPOSED
HIGHWAY PLANS**

FAS ROUTE 1388 (IL 8)
SECTION (Z-1D-BR-1)I-2
BRIDGE BEAM BRACING
PEORIA COUNTY

C-94-113-12

INDEX OF SHEETS

- 1 COVER SHEET
- 2 GENERAL NOTES/COMMITMENTS/JOB SPECIFIC NOTES
- 3 SUMMARY OF QUANTITIES
- 4 TYPICAL SECTIONS
- 5 PLAN VIEW
- 6-7 STRUCTURAL DETAILS

HIGHWAY STANDARDS

- 701001-02
- 701006-03
- 701201-04
- 701301-04
- 701901-02

DESIGN DESIGNATION

ADT = 1300 (2011)
MU = 2.31%
SU = 6.92%

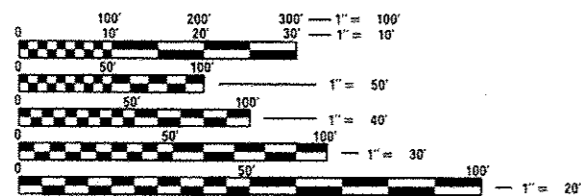

FULL SIZE PLANS HAVE BEEN PREPARED USING STANDARD ENGINEERING SCALES. REDUCED SIZED PLANS WILL NOT CONFORM TO STANDARD SCALES. IN MAKING MEASUREMENTS ON REDUCED PLANS, THE ABOVE SCALES MAY BE USED.

J.U.L.I.E.
JOINT UTILITY LOCATION INFORMATION FOR EXCAVATION
1-800-892-0123
OR 811

PROJECT ENGINEER RICH DOTSON
PROJECT MANAGER TERRISA WORSFOLD

CATALOG NO. 034841-00D
CONTRACT NO. 68B20

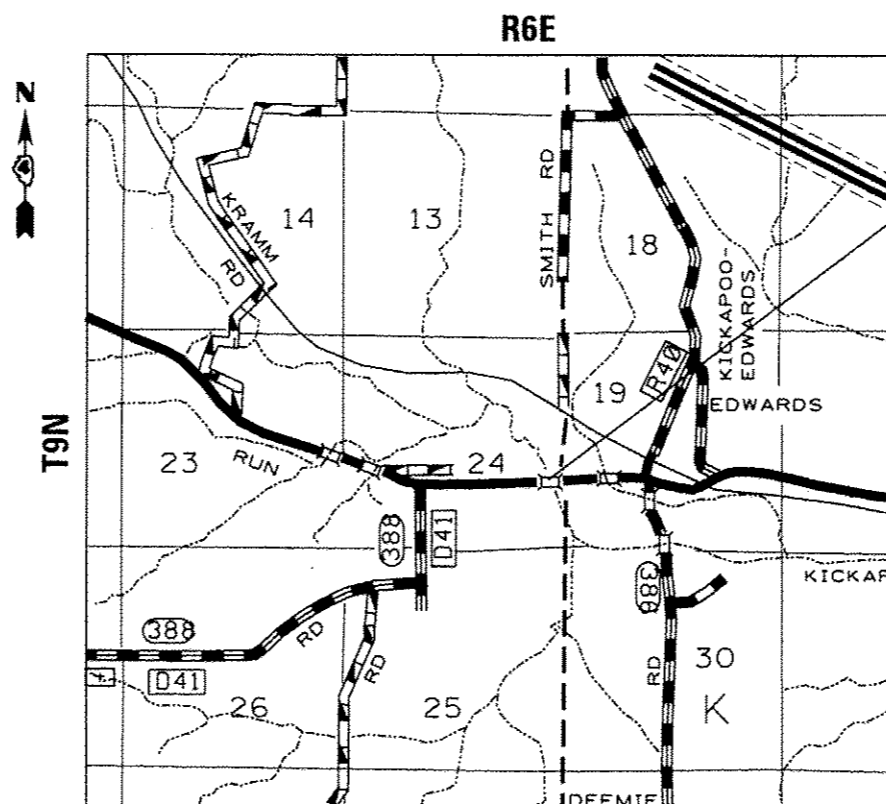

PROPOSED IMPROVEMENT
SN 072-0047

GROSS LENGTH = 358 FT. = 0.05 MILE
NET LENGTH = 280 FT. = 0.05 MILE

STATE OF ILLINOIS
DEPARTMENT OF TRANSPORTATION
DIVISION OF HIGHWAYS

SUBMITTED July 10, 2012

Joseph F. Cowan
DEPUTY DIRECTOR OF HIGHWAYS, REGION ENGINEER

August 17, 2012
John D. Salamelli, P.E.
ENGINEER OF DESIGN AND ENVIRONMENT

August 17, 2012
William R. Frey, Jr.
DIRECTOR OF HIGHWAYS, CHIEF ENGINEER

**PRINTED BY THE AUTHORITY
OF THE STATE OF ILLINOIS**