

INDEX OF SHEETS

SHEET NO.	DESCRIPTION
1	COVER SHEET
2 - 3	INDEX OF SHEETS/ HIGHWAY STANDARDS/ GENERAL NOTES
4 - 13	SUMMARY OF QUANTITIES
14 - 18	TYPICAL SECTIONS
19 - 23	SCHEDULE OF QUANTITIES
24 - 33	ALIGNMENT, TIES, AND BENCHMARKS
34 - 35	CONSTRUCTION LIMITS
35A - 35C	PRELIMINARY SITE INVESTIGATION PLANS
36 - 41	PROPOSED ROADWAY PLANS
42 - 50	PROPOSED ROADWAY PROFILES
51 - 57	MAINTENANCE OF TRAFFIC & SUGGESTED STAGING
58 - 63	EROSION AND SEDIMENT CONTROL PLANS
64	EROSION CONTROL DETAILS
65 - 69	EXISTING DRAINAGE PLANS
70 - 75	PROPOSED DRAINAGE PLANS
76 - 80	PROPOSED DRAINAGE PROFILES
81 - 83	DRAINAGE SCHEDULE
84 - 86	DRAINAGE DETAILS
87 - 102	UTILITY PLANS BY TBE
103 - 109	SOIL PROFILES
110 - 117	PLAT OF HIGHWAYS
118 - 133	PAVEMENT ELEVATION PLANS
134 - 141	GORE DETAILS
142 - 155	PAVEMENT MARKING PLANS
156 - 164	SIGNING PLANS
165	SIGNING SCHEDULE
166 - 179	SIGN PANEL DETAILS
180 - 206	SIGN STRUCTURE PLANS
207 - 212	SIGN STRUCTURE LOCATION PLANS
213	ELECTRICAL PLANS
214 - 221	ROADWAY DETAILS
222 - 226	STRUCTURE PLANS - APPROACH SLAB - PROPOSED I-70 OVER NS, TRRA, MCT & INDUSTRIAL DR. (082-0318 EB, 082-0319 WB)
227 - 230	STRUCTURE PLANS - PROPOSED I-70 RETAINING WALL (082-W234)
231 - 232	ANCHORAGE SLAB AND BARRIER WALL DETAILS
233 - 294	CROSS SECTIONS



SHEETS 35A TO 35C ADDED



INDICATES PAYMENT INCLUDED IN COST OF ANOTHER ITEM.

GENERAL NOTES

- ILLINOIS STATE LAW REQUIRES A 48 - HOUR NOTICE BE GIVEN TO ALL UTILITIES BEFORE DIGGING. FIELD MARKING OF FACILITIES MAY BE OBTAINED BY CONTACTING J.U.L.I.E. OR FOR NON-MEMBERS, THE UTILITY COMPANY DIRECTLY. AGENCIES KNOWN TO HAVE FACILITIES WITHIN THE PROJECT AREA ARE AS FOLLOWS:
 - AmerenCIPS - ELECTRIC
 - AmerenIP - GAS
 - AT&T ILLINOIS - COMMUNICATIONS
 - ILLINOIS AMERICAN WATER COMPANY - WATER
 - QWEST SOLUTIONS CENTER - COMMUNICATIONS
 - SHO-ME TECHNOLOGIES - COMMUNICATIONS
 - FAIRMONT CITY - SEWER
 - METRO EAST SANITARY DISTRICT (M.E.S.D.) - CAHOKIA CANAL
- MEMBERS OF J.U.L.I.E. (800-892-0123, OR 811) ARE INDICATED BY AN *. NON-J.U.L.I.E. MEMBERS MUST BE NOTIFIED INDIVIDUALLY.
- THE ATTENTION OF THE CONTRACTOR IS DIRECTED TO THE SPECIAL PROVISIONS FOR POTENTIAL UTILITY CONFLICTS.
- THE ATTENTION OF THE CONTRACTOR IS DIRECTED TO THE FACT THAT THERE WILL BE A LIGHTING SYSTEM AND AN I.T.S. SYSTEM INSTALLED WITHIN THE R.O.W. AS PART OF CONTRACT 76E06 (BY OTHERS). THE CONTRACTOR SHALL LOCATE ALL CABLES, STRUCTURES AND APPURTENANCES ASSOCIATED WITH THESE SYSTEMS PRIOR TO THE CONSTRUCTION OF THE ROADWAY ITEMS.

GENERAL NOTES (CONTINUED)

- THE CONTRACTOR WILL NOT BE ALLOWED TO SET UP A YARD OR FIELD OFFICE ON STATE PROPERTY WITHOUT WRITTEN PERMISSION FROM THE DEPARTMENT.
- BARRICADES: THE CONTRACTOR SHALL PROVIDE AND INSTALL TWO (2) WEIGHTED SANDBAGS ON EACH TYPE I OR TYPE II BARRICADE USED - ONE (1) WEIGHTED SAND BAG ACROSS EACH BOTTOM RAIL.
- THE CONTRACTOR SHALL BE RESPONSIBLE FOR THE PROTECTION OF ALL OVERHEAD, SURFACE, AND UNDERGROUND UTILITIES WITHIN THE PROJECT LIMITS WHETHER OR NOT THE UTILITIES ARE SHOWN ON THE PLANS. ANY UTILITY THAT IS DAMAGED DURING CONSTRUCTION SHALL BE REPLACED OR RELOCATED BY THE CONTRACTOR AT HIS/ HER OWN EXPENSE.
- THE CONTRACTOR SHALL USE CARE IN GRADING OR EXCAVATING NEAR ANY AND ALL EXISTING ITEMS WHICH WILL NOT BE REMOVED. ANY DAMAGE DONE TO EXISTING ITEMS BY THE CONTRACTOR SHALL BE REPAIRED/REPLACED BY THE CONTRACTOR AT THE CONTRACTORS' OWN EXPENSE.
- THE CONTRACTOR SHALL BE RESPONSIBLE FOR CONTACTING THE EAST ST. LOUIS FIRE AND POLICE DEPARTMENTS, AND MESD 14 WORKING DAYS PRIOR TO START OF CONSTRUCTION IN ORDER TO REVIEW AND COORDINATE THE CONSTRUCTION SCHEDULE.
 - EAST ST. LOUIS FIRE DEPT. CHIEF THOMAS GRIMMETT (618) 482-6875.
 - EAST ST. LOUIS POLICE DEPT. CHIEF LENZIE STEWART (618) 482-6740 OR 482-6700.
 - FAIRMONT CITY: FIRE AND POLICE DEPARTMENT: SCOTT PENNY (618) 274-4504 EXT. 2.
 - METRO EAST SANITARY DISTRICT (MESD): BOB SHIPLEY - (618) 452-9400
- CONTRACTOR SHALL BE RESPONSIBLE FOR CONTACTING THE STATE ARCHAEOLOGICAL COORDINATOR JOSEPH M. GALLOY, Ph.D., RPA (618) 251-3922 - 14 WORKING DAYS PRIOR TO START OF ANY PAVEMENT OR FOUNDATION REMOVAL.
- THE EXISTING TOPOGRAPHY SHOWN ON THE PLANS REFLECTS THE FINAL CONDITION AFTER THE COMPLETION OF CONTRACTS 76C39, 76C40, 76C68, 76C69, 76C44, 76D05, 76E06 AND GRADING FROM CONTRACT 76C41, AND DOES NOT NECESSARILY REFLECT CURRENT FIELD CONDITIONS.

11. ANY SEWER OR STRUCTURE REMOVAL WHICH REQUIRES ABANDONMENT OF A PORTION OF EXISTING SEWER, OR RESULTS IN A HOLE IN AN EXISTING STRUCTURE, WILL REQUIRE THE REMAINING SEWER OR STRUCTURE TO BE SECURELY SEALED WITH CLASS SI CONCRETE OR BRICK AND MORTAR PER ARTICLE 605.04 OF THE STANDARD SPECIFICATIONS. THIS WORK SHALL NOT BE PAID FOR SEPARATELY, BUT SHALL BE INCLUDED IN THE COST OF THE SEWER OR STRUCTURE REMOVAL ITEM.

12. ABBREVIATIONS: T.E. = TEMPORARY EASEMENT, P.E. = PERMANENT EASEMENT.

13. ALL DOWEL BARS AND TIE BARS UTILIZED IN PCC PAVEMENT SHALL BE EPOXY COATED.

14. THE CONTRACTOR SHALL USE CAUTION WHEN EXCAVATING NEAR ANY RAILROAD LINE. THE DETAIL SHOWN ON SHEET 215 SHALL BE THE MINIMUM REQUIREMENTS FOR EXCAVATION IN THE VICINITY OF ANY RAILROAD.

15. IF THE CONTRACTOR ENCOUNTERS PREVIOUSLY UNIDENTIFIED UTILITIES DURING EXCAVATION, THE CONTRACTOR SHALL FIRST DETERMINE IF THE UTILITY IS ABANDONED. IF THE UTILITY IS ABANDONED, THE CONTRACTOR SHALL REMOVE THE PORTIONS OF THE UTILITY THAT CONFLICT WITH CONSTRUCTION OPERATIONS AND DISPOSE OF THE REMOVED UTILITY OUTSIDE OF THE STATE RIGHT OF WAY. THIS WORK SHALL BE PAID FOR PER ARTICLE 109.04.

16. ALL MANHOLE LIDS OR INLET GRATES THAT ARE REMOVED DURING THIS CONTRACT SHALL REMAIN PROPERTY OF THE ILLINOIS DEPT. OF TRANSPORTATION AND SHALL BE REMOVED WITHOUT DAMAGE AND TRANSPORTED TO THE FOLLOWING ADDRESS: BOWMAN AVE. PUMP STATION, 728 EXCHANGE AVE., EAST ST. LOUIS, ILLINOIS - IF THERE ARE ANY QUESTIONS PLEASE CONTACT PETE SAWYER AT 618-346-3275.

17. THE DEPARTMENT STRONGLY ENCOURAGES THE PRIME CONTRACTOR AND THEIR APPROVED SUB-CONTRACTORS TO HIRE MINORITY, WOMEN AND DISADVANTAGED INDIVIDUALS FROM ITS FEDERALLY FUNDED HIGHWAY CONSTRUCTION CAREERS TRAINING PROGRAM (HCCTP) TO HELP MEET WORKFORCE AND TRAINEE GOALS. THIS PROGRAM IS TRAINING MINORITIES, WOMEN AND DISADVANTAGED INDIVIDUALS IN HIGHWAY CONSTRUCTION-RELATED SKILLS, E.G., MATH FOR THE TRADES, JOB READINESS, TECHNICAL SKILLS COURSEWORK (CARPENTRY, CONCRETE FLATWORK, BLUEPRINT READING, SITE PLANS, SITE WORK, TOOLS USE, ETC.) AND OSHA 10 HOUR CERTIFICATION, TO PREPARE THEM FOR A CAREER IN THE HIGHWAY CONSTRUCTION TRADES. GRADUATES ARE WELL-TRAINED AND READY TO BECOME PRODUCTIVE ENTRY-LEVEL CONSTRUCTION WORKERS. CONTACT THE DISTRICT 8 EEO OFFICE AT 618-346-3360 AND/OR THE HCCTP COORDINATOR AT 618/874-6528 TO LEARN MORE ABOUT THE PROGRAM AND FOR ASSISTANCE IN MEETING WORKFORCE AND TRAINEE GOALS.

18. THE RIGHT OF WAY MARKER SHALL BE INSTALLED SO THAT THE BACK OF THE POST IS TWELVE INCHES (12") INSIDE THE RIGHT OF WAY BOUNDARY. THE RIGHT OF WAY MARKER SHALL BE A WITNESS TO THE RIGHT OF WAY CORNER WHICH IS THE PROPERTY PIN.

19. THE RIGHT OF WAY CORNER OR PROPERTY PIN IS A 5/8" IRON ROD WITH IDOT ALUMINUM CAP THAT SHALL NOT BE REMOVED, DAMAGED OR DISTURBED WHEN SETTING THE RIGHT OF WAY MARKER AT THE TWELVE INCHES (12") OFFSET.

20. THE CONTRACTOR SHALL VERIFY ALL DIMENSIONS AND CONDITIONS IN THE FIELD PRIOR TO CONSTRUCTION AND ORDERING OF MATERIALS.

21. THE COST OF CONNECTING PROPOSED STORM SEWER OR PIPE UNDERDRAINS TO EXISTING DRAINAGE STRUCTURES SHALL NOT BE PAID FOR SEPARATELY BUT SHALL BE INCLUDED IN THE COST OF THE STORM SEWER OR PIPE UNDERDRAIN PAY ITEM.

HIGHWAY STANDARDS

000001	-06	STANDARD SYMBOLS, ABBREVIATIONS AND PATTERNS
001001	-02	AREAS OF REINFORCEMENT BARS
001006	-07	DECIMAL OF AN INCH AND OF A FOOT
280001	-06	TEMPORARY EROSION CONTROL SYSTEMS
420001	-07	PAVEMENT JOINTS
420111	-03	PCC PAVEMENT ROUNDOUTS
420206	-08	ENTRANCE RAMP TERMINAL (JOINTED PCC RAMP PAVEMENT ADJACENT TO CRC MAINLINE PAVEMENT)
420306	-06	EXIT RAMP TERMINAL (JOINTED PCC RAMP PAVEMENT ADJACENT TO CRC MAINLINE PAVEMENT)
420401	-08	BRIDGE APPROACH PAVEMENT CONNECTOR
421001	-02	BAR REINFORCEMENT FOR CRC PAVEMENT
421206	-06	36" CRC PAVEMENT (WITH LUG SYSTEM)
483001	-04	PCC SHOULDER
542301	-03	PRECAST REINFORCED CONCRETE FLARED END SECTION
542311	-03	GRATING FOR FLARED END SECTIONS 24"-54" PIPES
542401	-01	METAL END SECTION FOR PIPE CULVERTS
601001	-04	SUB-SURFACE DRAINS
601101	-01	CONCRETE HEADWALL FOR PIPE DRAIN
602001	-02	CATCH BASIN TYPE A
602306	-03	INLET TYPE B
602401	-03	MANHOLE TYPE A
602406	-05	MANHOLE TYPE A 6' DIAMETER
602601	-02	PRECAST REINFORCED CONCRETE FLAT SLAB TOP
602701	-02	MANHOLE STEPS
604001	-03	FRAME AND LIDS TYPE 1
604071	-04	FRAME AND GRATE TYPE 20
604091	-02	FRAME AND GRATE TYPE 24
606001	-04	CONCRETE CURB TYPE B AND COMBINATION CONCRETE CURB AND GUTTER
610001	-06	SHOULDER INLET WITH CURB
630001	-10	STEEL PLATE BEAM GUARDRAIL
630201	-06	PCC/HMA STABILIZATION AT STEEL PLATE BEAM GUARDRAIL
630301	-05	SHOULDER WIDENING FOR TYPE 1 (SPECIAL) GUARDRAIL TERMINALS
631011	-08	TRAFFIC BARRIER TERMINAL, TYPE 2
631026	-05	TRAFFIC BARRIER TERMINAL, TYPE 5
631031	-10	TRAFFIC BARRIER TERMINAL, TYPE 6
635001	-01	DELINEATORS
635006	-03	REFLECTOR AND TERMINAL MARKER PLACEMENT
635011	-02	REFLECTOR MARKER AND MOUNTING DETAILS
637006	-02	CONCRETE BARRIER, DOUBLE FACE, 42 IN. HEIGHT
642001	-02	SHOULDER RUMBLE STRIPS, 16 IN.
664001	-02	CHAIN LINK FENCE
665001	-02	WOVEN WIRE FENCE
701001	-02	OFF-ROAD OPERATIONS, 2L, 2W, MORE THAN 15' AWAY
701006	-03	OFF-ROAD OPERATIONS, 2L, 2W, 15' TO 24" FROM PAVEMENT EDGE
701400	-05	APPROACH TO LANE CLOSURE, FREEWAY / EXPRESSWAY
701401	-06	LANE CLOSURE, FREEWAY / EXPRESSWAY
701451	-01	RAMP CLOSURE, FREEWAY / EXPRESSWAY
701901	-02	TRAFFIC CONTROL DEVICES
720001	-01	SIGN PANEL MOUNTING DETAILS
720006	-03	SIGN PANEL ERECTION DETAILS
720011	-01	METAL POSTS FOR SIGNS, MARKERS & DELINEATORS
720021	-02	SIGN PANELS EXTRUDED ALUMINUM TYPE
728001	-01	TELESCOPING STEEL SIGN SUPPORT
729001	-01	APPLICATIONS OF TYPES A & B METAL POSTS (FOR SIGNS & MARKERS)
780001	-03	TYPICAL PAVEMENT MARKINGS
781001	-03	TYPICAL APPLICATIONS RAISED REFLECTIVE PAVEMENT MARKERS
814001	-02	HANDHOLES
878001	-09	CONCRETE FOUNDATION DETAILS
886001	-01	DETECTOR LOOP INSTALLATIONS
886006	-01	TYPICAL LAYOUT FOR DETECTION LOOPS

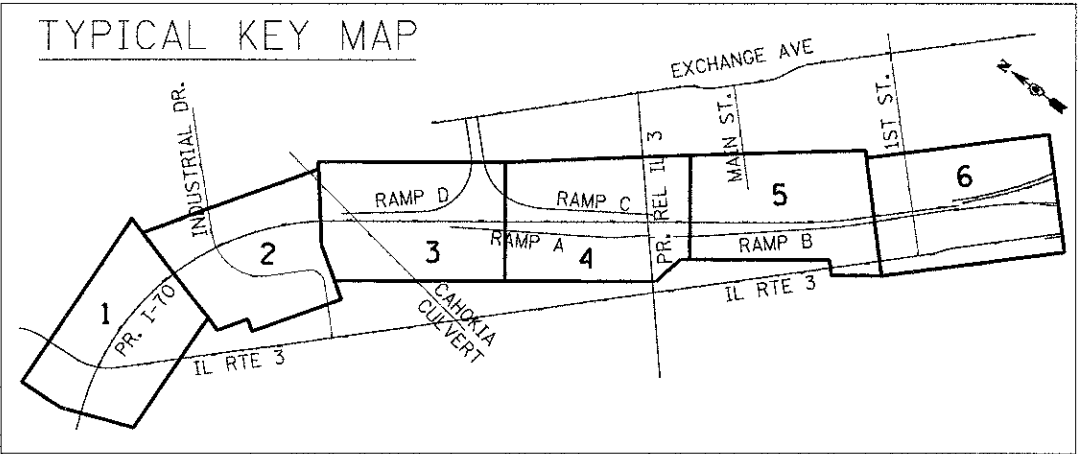

SUMMARY OF QUANTITIES

CODE NO.	ITEM	UNIT	100% STATE URBAN TOTAL QUANTITY	CONSTRUCTION CODE				
				ROADWAY 0001	BRIDGE 0008	RETAINING WALL 0040	SIGNING 0021	ITS 0021
* X7830076	GROOVING FOR RECESSED PAVEMENT MARKING 9"	FOOT	12,843	12,843				
* X7830078	GROOVING FOR RECESSED PAVEMENT MARKING 13"	FOOT	474	474				
* X8730810	ELECTRIC CABLE IN CONDUIT, CONOGA-30003	FOOT	2,475					2,475
Z0013796	SEDIMENT CONTROL, STABILIZED CONSTRUCTION ENTRANCE	SO YD	500	500				
Z0013798	CONSTRUCTION LAYOUT	L SUM	1	1				
Z0015551	DEBRIS REMOVAL (SPECIAL)	CU YD	10,000	10,000				
Z0048665	RAILROAD PROTECTIVE LIABILITY INSURANCE	L SUM	1	1				
Z0065753	SLOTTED DRAIN 15" WITH 6" SLOT	FOOT	245	245				
+ Z0076602	TRAINEES (SPECIAL)	HOUR	3000	3000				
+ Z0076604	TRAINEES TRAINING PROGRAM GRADUATE	HOUR	3000	3000				
66900200	NON-SPECIAL WASTE DISPOSAL	CU YD	1320	1320				
66900450	SPECIAL WASTE PLANS AND REPORTS	L SUM	1	1				
66900530	SOIL DISPOSAL ANALYSIS	EACH	3	3				

* DENOTES SPECIALTY ITEMS + 0042

D:\CONTRACTS\CONNS\SHEETS\CONTRACT_08\UBCONN-08-SHT-SUMMARY-LOGN
 \\\FS-0844\NIV\BULT.D-TRANS\72292\28869-001\CIVIL\CAU\99
 6-27-2012 11:19:47
 BONDHOTO
 TENG & ASSOCIATES, INC.
 ENGINEERS/ARCHITECTS/PLANNERS
 CHICAGO, ILLINOIS

FILE NAME * USER NAME * #USER# DESIGNED - MDN REVISED - ADDED SHEET JOB 09/07/12 STATE OF ILLINOIS DEPARTMENT OF TRANSPORTATION PRELIMINARY SITE INVESTIGATION PLANS STA. 148+00 TO STA. 162+00 F.A.P. R.T.E. 998 SECTION 82-R COUNTY ST. CLAIR TOTAL SHEETS 294 SHEET NO. 35A CONTRACT NO. 76C43

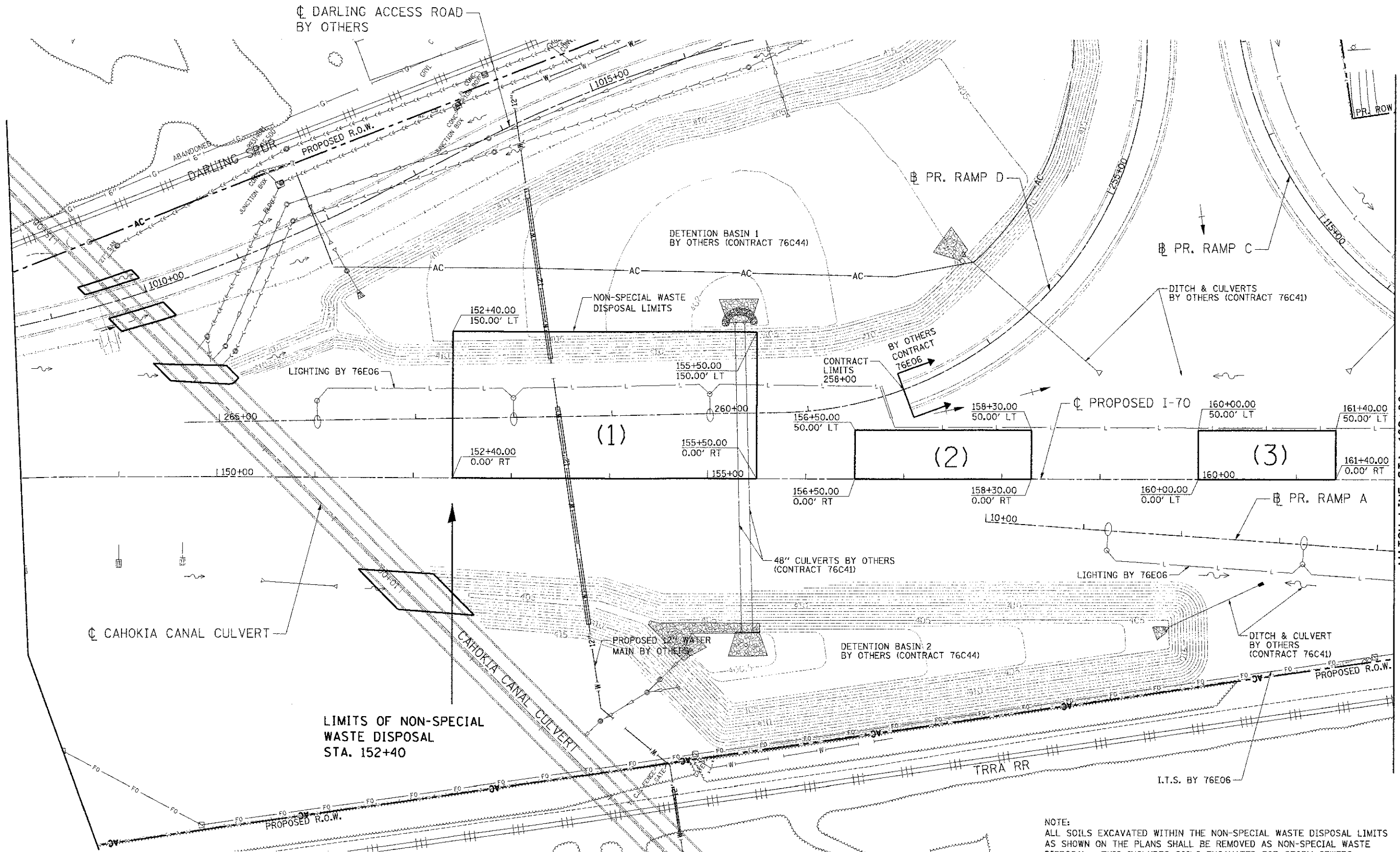

LEGEND (X) NON-SPECIAL WASTE DISPOSAL LIMITS. SEE SPECIAL PROVISIONS FOR CONTAMINANTS OF CONCERN.

NOTE: ALL SOILS EXCAVATED WITHIN THE NON-SPECIAL WASTE DISPOSAL LIMITS AS SHOWN ON THE PLANS SHALL BE REMOVED AS NON-SPECIAL WASTE DISPOSAL. THIS INCLUDES SOILS EXCAVATED FOR STORM SEWERS, DRAINAGE STRUCTURES AND UNDERDRAINS.

MATCH LINE STA. 162+00 SEE SHEET 35B

FILE NAME * #FILE#	USER NAME * #USER#	DESIGNED - MDN	REVISED - ADDED SHEET JOB 09/07/12
TENG & ASSOCIATES, INC. ENGINEERS/ARCHITECTS/PLANNERS CHICAGO, ILLINOIS	PLOT SCALE # SCALE#	DRAWN - MDN	REVISED -
9-27-2012, 11:02:28	PLOT DATE # DATE#	CHECKED - TKL	REVISED -
		DATE - 09/07/12	REVISED -

STATE OF ILLINOIS
DEPARTMENT OF TRANSPORTATION
I-70 CONNECTION

PRELIMINARY SITE INVESTIGATION PLANS
STA. 148+00 TO STA. 162+00

SCALE: 1"=50' SHEET NO. 1 OF 3 SHEETS STA. TO STA.

F.A.P. R.T.E. 998	SECTION 82-R	COUNTY ST. CLAIR	TOTAL SHEETS 294	SHEET NO. 35A
FED. ROAD DIST. NO.		ILLINOIS FED. AID PROJECT	CONTRACT NO. 76C43	

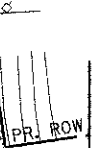

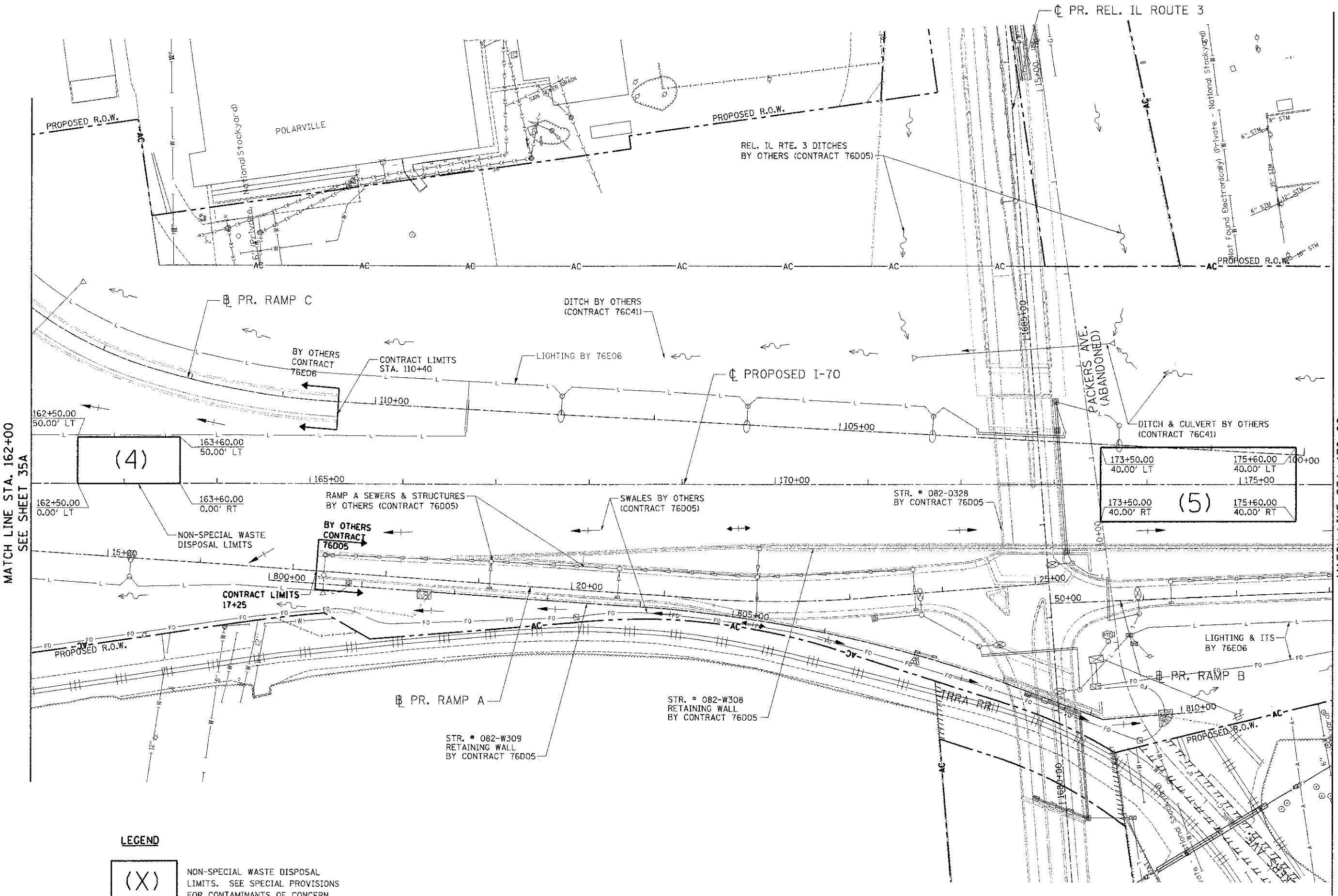

MATCH LINE STA. 162+00
SEE SHEET 35A

MATCH LINE STA. 176+00
SEE SHEET 35C

FILE NAME = 972012_118234
USER NAME = #USER#
DESIGNED - MDN
DRAWN - MDN
CHECKED - TKL
DATE - 09/07/12

FILE NAME =	USER NAME = #USER#	DESIGNED - MDN	REVISED - ADDED SHEET JB 09/07/12
#7LEL#		DRAWN - MDN	REVISED -
	PLOT SCALE = #SCALE#	CHECKED - TKL	REVISED -
	PLOT DATE = #DATE#	DATE - 09/07/12	REVISED -

STATE OF ILLINOIS
DEPARTMENT OF TRANSPORTATION
I-70 CONNECTION

PRELIMINARY SITE INVESTIGATION PLANS		F.A.P. RTE.	SECTION	COUNTY	TOTAL SHEETS	SHEET NO.
STA. 162+00 TO STA. 176+00		998	82-IR	ST. CLAIR	294	359
SCALE: 1"=50'	SHEET NO. 2 OF 3 SHEETS	STA.	TO STA.	CONTRACT NO. 76C43		

FED. ROAD DIST. NO.	ILLINOIS FED. AID PROJECT
---------------------	---------------------------



TENG & ASSOCIATES, INC.
ENGINEERS/ARCHITECTS/PLANNERS
CHICAGO, ILLINOIS

\\S0123456789\proj\123456\123456.dwg... 09/07/12 10:00:00 AM

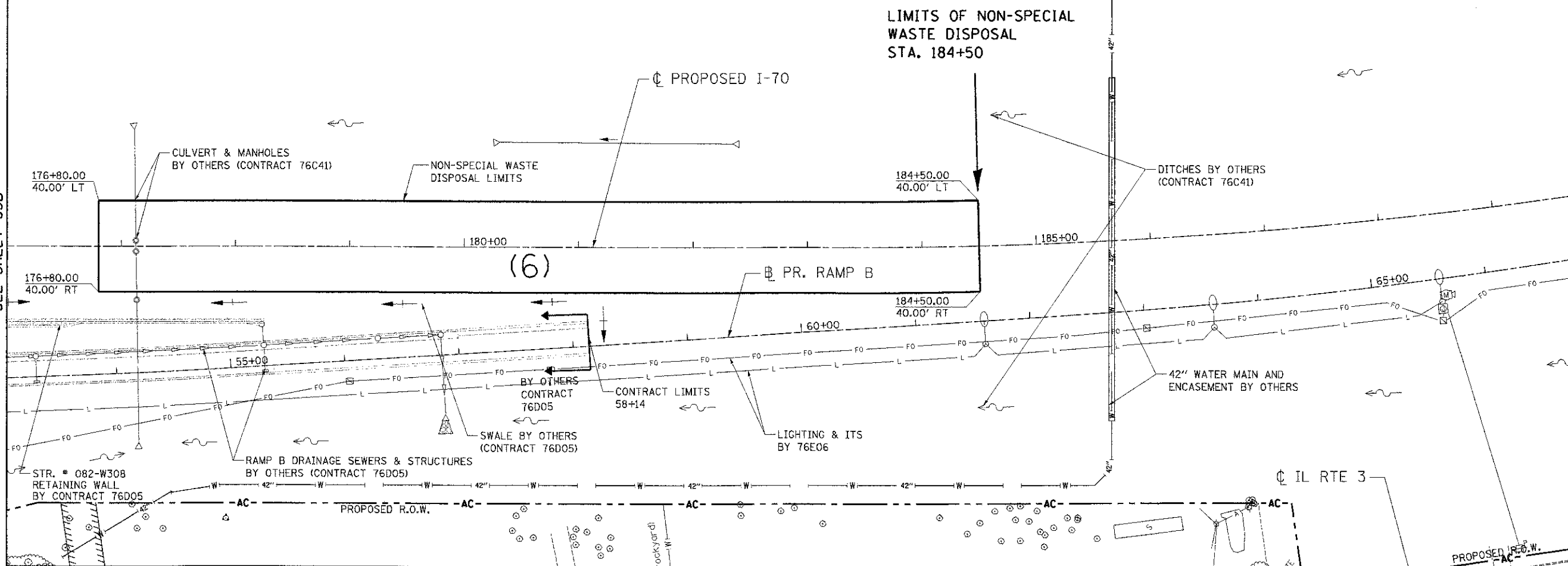
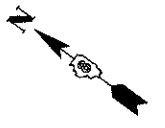
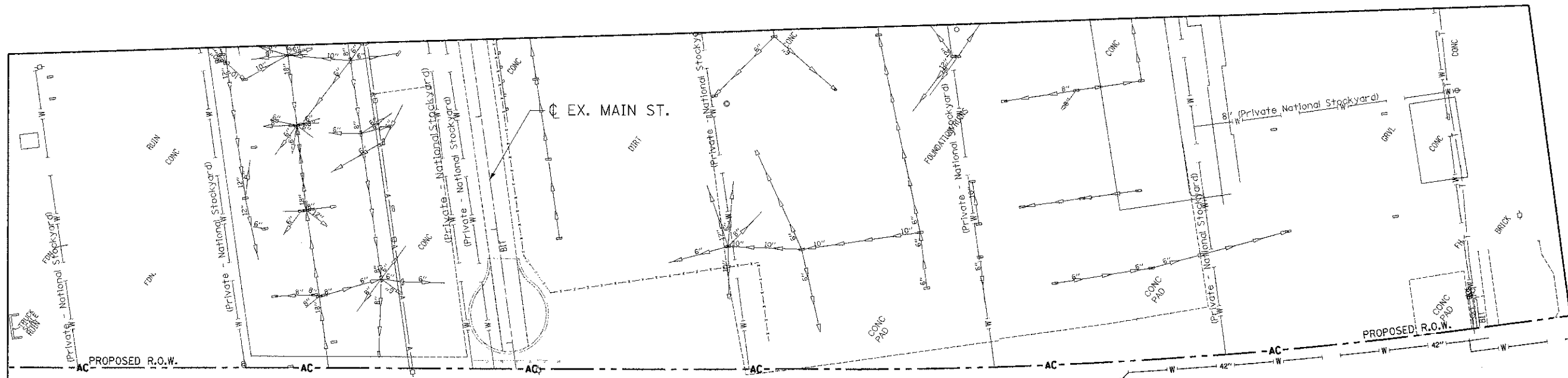

MATCH LINE STA. 176+00
SEE SHEET 35B

LEGEND

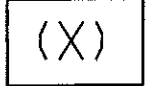

NON-SPECIAL WASTE DISPOSAL LIMITS. SEE SPECIAL PROVISIONS FOR CONTAMINANTS OF CONCERN.

FILE NAME #	USER NAME #	DESIGNED - MDN	REVISED -	ADDED SHEET JB	09/07/12
#FILE#		DRAWN - MDN	REVISED -		
		CHECKED - TKL	REVISED -		
		DATE - 09/07/12	REVISED -		

STATE OF ILLINOIS
DEPARTMENT OF TRANSPORTATION
I-70 CONNECTION

PRELIMINARY SITE INVESTIGATION PLANS
STA. 176+00 TO STA. 190+00
SCALE: 1"=50'
SHEET NO. 3 OF 3 SHEETS

F.A.P. RTE.	SECTION	COUNTY	TOTAL SHEETS	SHEET NO.
998	82-R	ST. CLAIR	294	35C
CONTRACT NO. 76C43		ILLINOIS FED. AID PROJECT		

