

ALL IMPROVEMENTS ON THIS SHEET BY OTHERS
FOR INFORMATION ONLY

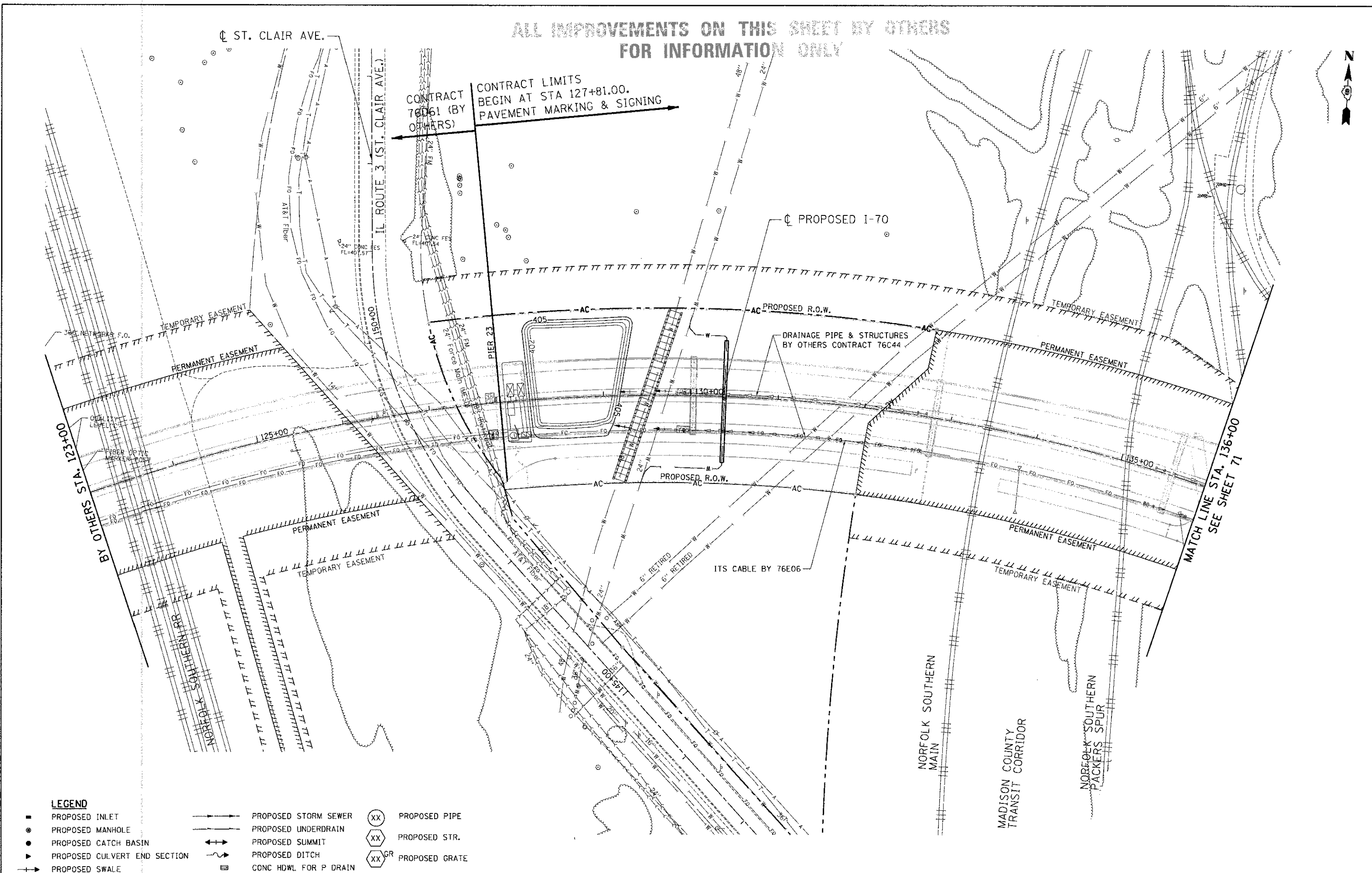

LEGEND

- PROPOSED INLET
- PROPOSED MANHOLE
- PROPOSED CATCH BASIN
- ▶ PROPOSED CULVERT END SECTION
- PROPOSED SWALE
- PROPOSED STORM SEWER
- PROPOSED UNDERDRAIN
- ↔ PROPOSED SUMMIT
- PROPOSED DITCH
- ▭ CONC HDWL FOR P DRAIN
- ⊗ PROPOSED PIPE
- ⊗ PROPOSED STR.
- ⊗^{GR} PROPOSED GRATE

FILE NAME =
#FILE#

TENG
TENG & ASSOCIATES, INC.
ENGINEERS/ARCHITECTS/PLANNERS
CHICAGO, ILLINOIS

USER NAME = #USER#

PLOT SCALE = #SCALE#

PLOT DATE = #DATE#

DESIGNED - MDN

DRAWN - MDN

CHECKED - ACL

DATE - 06/29/12

REVISED -

REVISED -

REVISED -

REVISED -

STATE OF ILLINOIS
DEPARTMENT OF TRANSPORTATION
I-70 CONNECTION

PROPOSED I-70
PROPOSED DRAINAGE & UTILITIES
STA. 123+00 TO STA. 136+00

SCALE: 1"=50'

SHEET NO. 1 OF 6 SHEETS

STA. TO STA.

F.A.P. RTE.	SECTION	COUNTY	TOTAL SHEETS	SHEET NO.
99B	82-1R	ST. CLAIR	294	70
CONTRACT NO. 76C43				
FED. ROAD DIST. NO. ILLINOIS FED. AID PROJECT				