

**STANDARD ARROWS FOR INTERSTATE GUIDE SIGNS**

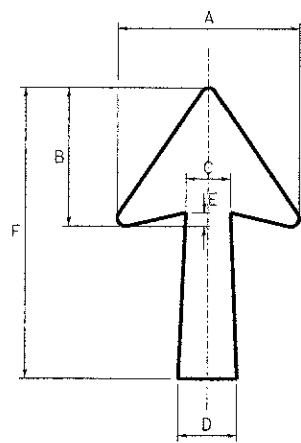

ARROW SYMBOL	A	B	C	D	E	F	R
24 1/4 x 15 1/8	15 1/8	11 9/16	3 3/4	5	1 5/16	24 1/4	13/16
29 1/4 x 18 1/4	18 1/4	14	4 1/2	6	1 1/2	29 1/4	3/4
35 5/8 x 22 1/4	22 1/4	17	5 3/8	7 1/8	1 3/4	35 5/8	1
18 1/4 x 11 1/4	11 1/4	8 3/4	3 1/8	3 7/8		18 1/4	

NOTE: D & F ARE RECOMMENDED DIMENSIONS. TAPER SHOULD BE HELD CONSTANT FOR LONGER OR SHORTER SHAFT LENGTHS

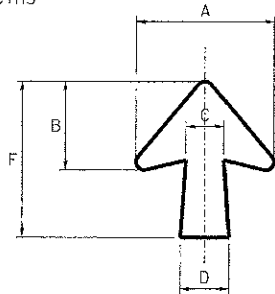

ARROW SYMBOL	A	B	C	D	E	F	R
17 1/4 x 14 1/4	14 1/4	9 13/16	3 3/8	4 1/2	15/16	17 1/4	3/4
20 1/4 x 17 1/4	17 1/4	11 3/4	4 3/8	5 5/8	1 1/2	20 1/4	
25 x 21 7/8	21 7/8	14 1/4	5	6 3/4	1 3/4	25	1
9 9/16 x 8 7/16	8 7/16	5 7/16	2 5/16	2 15/16		9 9/16	1/2

**DOWN ARROWS**

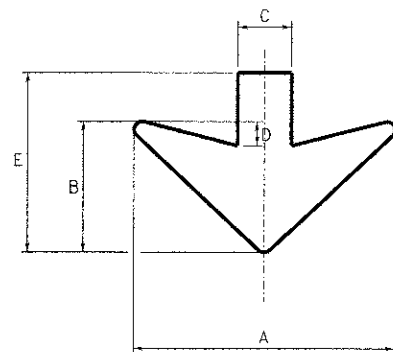

ARROW SYMBOL	A	B	C	D	E	F	R
16 1/2 x 24	24	12	5	1 1/2	16 1/2	3/4	
22 x 32	32	16	6 1/2	3	22	1	

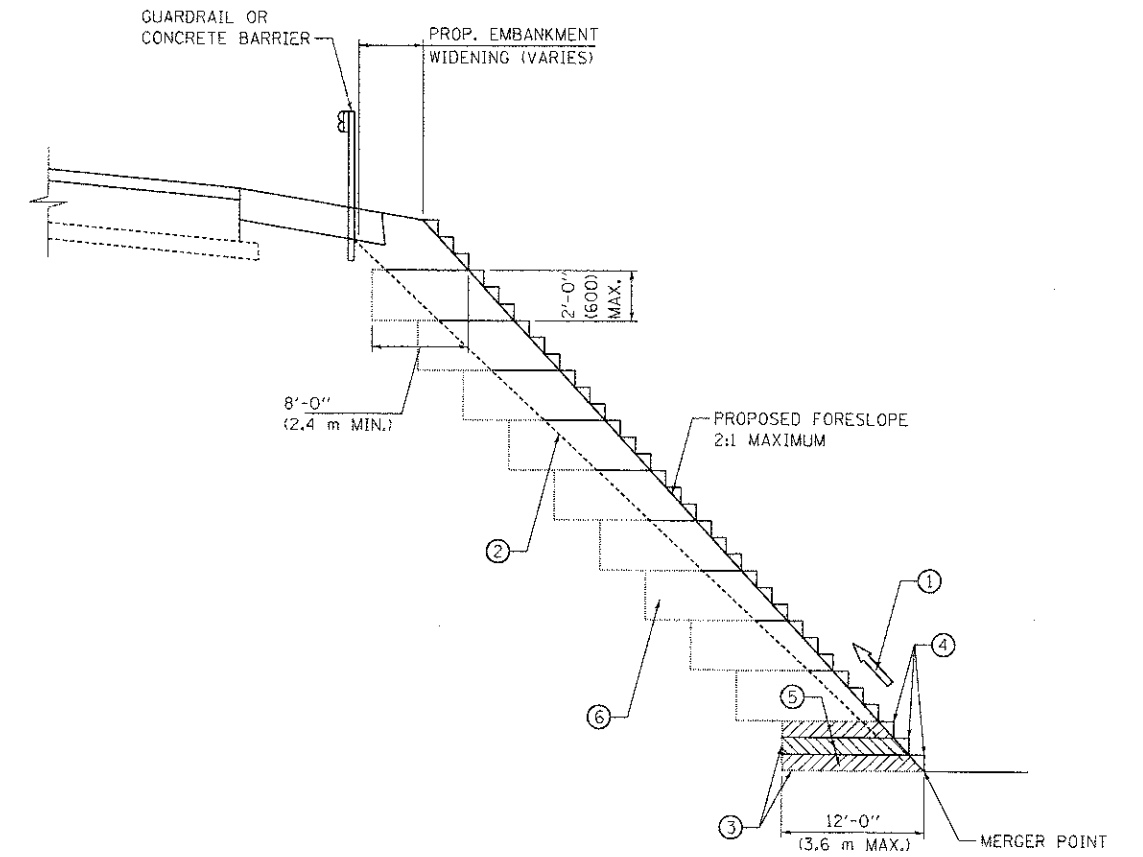

**TYPICAL BENCHING DETAIL FOR EMBANKMENT WIDENING**

**NOTES:**

- ① CONSTRUCT SUCCEEDING BENCH CUTS AND EMBANKMENT PLACEMENT AND COMPACTION FROM BOTTOM TO TOP IN STAIRSTEP FASHION.
- ② EXISTING FORESLOPE PREPARED IN ACCORDANCE WITH ARTICLE 205.03 OF THE STANDARD SPECIFICATIONS.
- ③ BENCH CUT EXISTING SLOPE TYPICAL FOR EACH STEP.
- ④ TRIM TO FINAL SLOPE.
- ⑤ EQUAL 8-INCH (200) LIFTS OF EMBANKMENT COMPACTED IN ACCORDANCE WITH ARTICLE 205.05 OF THE STANDARD SPECIFICATIONS.
- ⑥ EXCAVATION OF BENCH CUTS WITHIN EXISTING EMBANKMENT WILL BE PAID FOR AT THE CONTRACT UNIT PRICE PER CUBIC METER OR CUBIC YARD FOR "EARTH EXCAVATION". THIS PRICE WILL INCLUDE ALL LABOR AND MATERIAL, NO ADDITIONAL COMPENSATION WILL BE ALLOWED.
- ⑦ SLOPES SHALL BE BENCHED ACCORDING TO THIS DETAIL WHEN THE SLOPE IS STEEPER THAN 4:1 AND THE HEIGHT IS GREATER THAN 5' (1.5m).

ALL DIMENSIONS ARE IN INCHES (MILLIMETERS) UNLESS OTHERWISE SHOWN.

\SFS 0044 \MVA\VALT.D - TRANS.07.2202.28868 - 04\AC\CVIL\CD09.99 ALL CONTRACTS\CONNS\SHEETS CONTRACT 08\18\CONN-80-SHT-PYTD\DETAIL2.DGN  
 BONDHJLD  
 6-27-2012 9:53:57