 PAVEMENT REMOVAL

*MATCH EXISTING EDGE OF PAVEMENT ELEVATIONS

2 CENTER CURVE
45° RAD.
250' RAD.
12' OFFSET

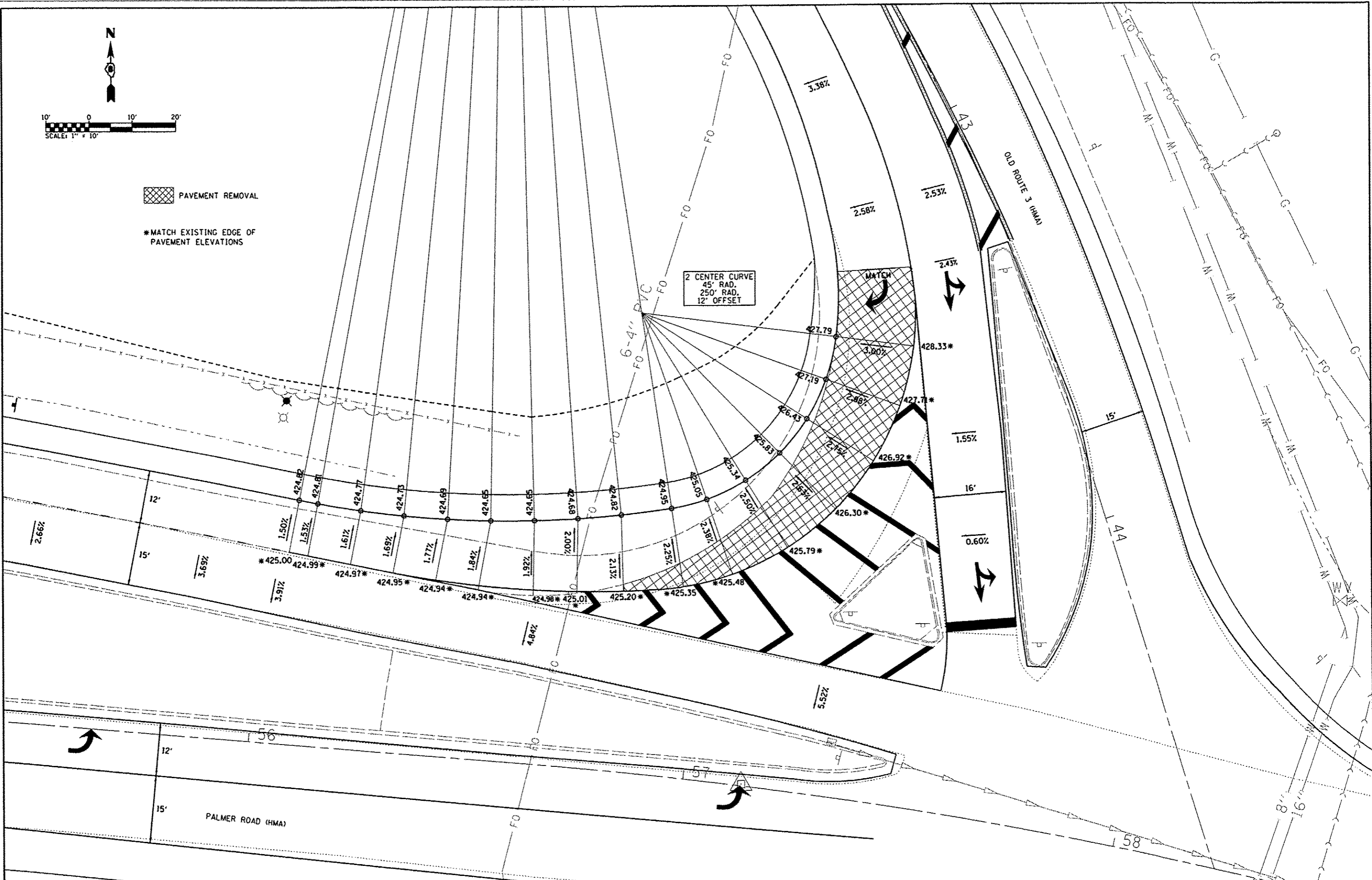

FILE NAME = 0810006-shr-inter-sap.dgn	USER NAME = default	DESIGNED -	REVISED -	STATE OF ILLINOIS DEPARTMENT OF TRANSPORTATION	INTERSECTION DETAIL SHEET		F.A.U. RTE.	SECTION	COUNTY	TOTAL SHEETS	SHEET NO.
	PLOT TIME = 1:53:25 PM	DRAWN -	REVISED -				9300	10-00048-01-PV	MONROE	33	18
	PLOT SCALE = 20.0000' / IN.	CHECKED -	REVISED -				CONTRACT NO. 97505				
	PLOT DATE = 7/18/2012	DATE -	REVISED -				ILLINOIS FED. AID PROJECT				
				SCALE: 1"=10'		SHEET 01 OF 01 SHEETS STA. TO STA.					