

PROPOSED TYPICAL SECTION

STATION 200+00.00 TO 201+29.16, MOEN AVENUE

ADDITIONAL NOTE:
 - THE LONGITUDINAL JOINT SEALANT SHALL BE PLACED UNDER THE SURFACE LIFT AND UNDER THE TOP BINDER LIFT. SEE SCHEDULE OF QUANTITIES SHEET 17 OF 17, SHEET 28 OF 344 FOR LOCATIONS.

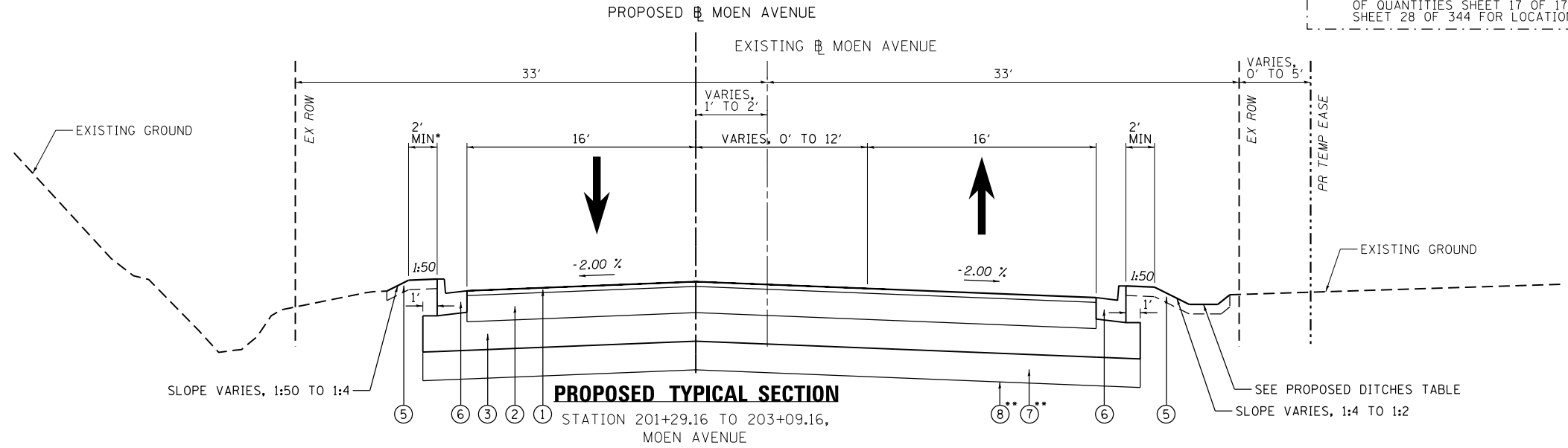

PROPOSED TYPICAL SECTION

STATION 201+29.16 TO 203+09.16, MOEN AVENUE

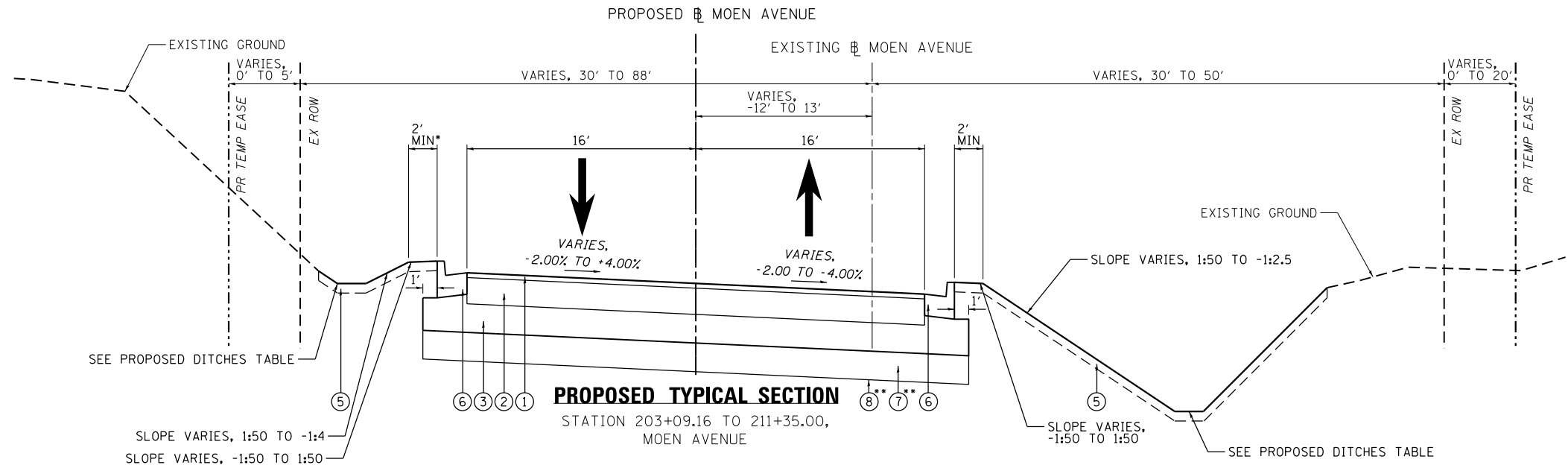

PROPOSED TYPICAL SECTION

STATION 203+09.16 TO 211+35.00, MOEN AVENUE

NOTES:

- FOR DETAILED INFORMATION AT SPECIFIC LOCATIONS, SEE THE CROSS SECTION SHEETS.
- GUARDRAIL IS PROPOSED FROM STATION 211+28.17 RT TO 216+79.44 RT.
- 2-FOOT SHELFF IS NOT PROVIDED ON LEFT SIDE OF ROADWAY FROM STA. 209+00.00 TO 209+50.00 AND FROM STA. 212+40.00 TO 212+80.00.
- ANTICIPATED UNDERCUT LOCATIONS FOUND IN UNDERCUT TABLE.

PROPOSED DITCHES

STATION RANGE	SIDE/LOCATION	FRONT SLOPE	BOTTOM WIDTH	BACK SLOPE
201+94.33 TO 209+24.58	RIGHT	1:4 TO 1:2	2' MIN.	1:3 TO 1:2
204+00.00 TO 207+94.88	LEFT	1:4	2' MIN.	1:6 TO 1:3
210+00.00 TO 211+25.00	LEFT	1:4	2' MIN.	1:3

HOT-MIX ASPHALT MIXTURE REQUIREMENTS

APPLICATION	MIXTURE TYPE	AIR VOIDS @ NDES
SHARED-USE PATH	2" HMA SURFACE COURSE, MIX "D", N50 (IL 9.5 MM)	4% @ 50 GYR
MOEN AVENUE/MOUND ROAD	2" POLY HMA SURF COURSE, SMA, N80 (IL 9.5 MM)	3.5% @ 80 GYR
	11" HMA BINDER COURSE, IL-19.0, N70	4% @ 70 GYR
DRIVEWAYS	2" HMA SURFACE COURSE, MIX "D", N50 (IL 9.5 MM)	4% @ 50 GYR
	6" HMA BINDER COURSE, IL-19.0, N50	4% @ 50 GYR
TEMPORARY PAVEMENT	4" HMA BINDER COURSE, IL-19.0, N70	4% @ 70 GYR
SHOULDERS	6" HMA BINDER COURSE, IL-19.0, N50	4% @ 50 GYR

- THE UNIT WEIGHT USED TO CALCULATE ALL HMA SURFACE MIXTURE QUANTITIES IS 112 LBS/ SQ YD/IN.
- THE "AC TYPE" FOR POLYMERIZED HMA MIXES SHALL BE "SBS/SBR PG 76-22" AND FOR NON-POLYMERIZED HMA, THE "AC TYPE" SHALL BE "PG 64-22" UNLESS MODIFIED BY DISTRICT ONE SPECIAL PROVISIONS.
- FOR HMA FULL DEPTH "AC TYPE" SEE SPECIAL PROVISIONS.
- FOR USE OF RECYCLED MATERIALS SEE SPECIAL PROVISIONS.

CONCRETE REQUIREMENTS

APPLICATION	MIXTURE TYPE
DRIVEWAYS	8" CLASS PV CONCRETE REINFORCED WITH (6"x6")-(#10x#10) WELDED WIRE MESH

PROPOSED UNDERCUTS

STATION RANGE	ESTIMATED UNDERCUT	GEOTEXTILE FABRIC UNDER AGGREGATE SUBGRADE BASE
200+00 TO 204+00	18"	YES

PROPOSED PAVEMENT LEGEND

- 2" POLYMERIZED HMA SURFACE COURSE, STONE MATRIX ASPHALT, 9.5, N80
- 11" HMA BINDER COURSE, IL-19.0, N70
- AGGREGATE SUBGRADE IMPROVEMENT 12"
- 8" AGGREGATE SHOULDER
- 6" TOPSOIL FURNISH AND PLACE
- COMBINATION CONCRETE CURB AND GUTTER, TYPE B-6.18
- AGGREGATE SUBGRADE IMPROVEMENT (TYPE, DEPTH, AND LOCATION DETERMINED BY ENGINEER)
- FABRIC FOR GROUND STABILIZATION (GEOTEXTILE FABRIC)

FILE = S:\PROJECTS\2016\1189J16-Rk_Moen\DESIGN\TRANS\CADD\Sheets\1189J16-shr-typical2.dgn

REVISION	DATE	BY	REMARKS
1	8-27-2018	JSH	ADDED LONGITUDINAL JOINT SEALANT NOTE

DRAWN JSH
 CHECKED GFS
 APPROVED GFS

STATE OF ILLINOIS
 DEPARTMENT OF TRANSPORTATION



TYPICAL SECTIONS - MOEN AVENUE
 SHEET 2 OF 3

STA. 200 + 00.00 TO 211 + 35.00

F.A.U. RTE.	SECTION	COUNTY	TOTAL SHEETS	SHEET NO.
3795	12-00029-00-PV	WILL	344	9

CONTRACT 61E00

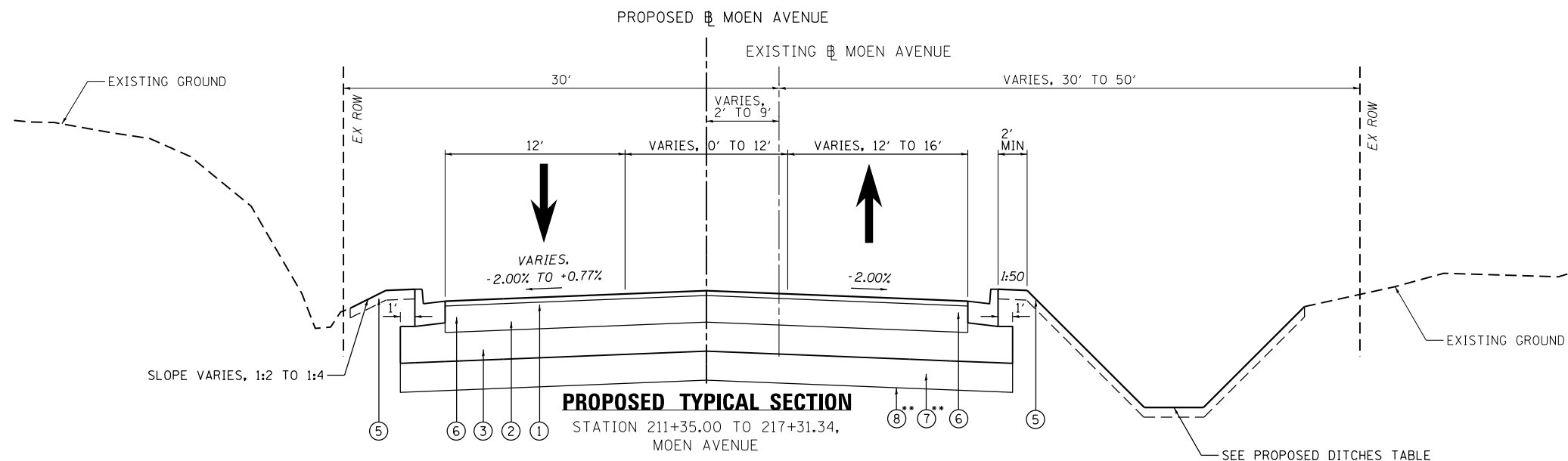

- NOTES:**
- FOR DETAILED INFORMATION AT SPECIFIC LOCATIONS, SEE THE CROSS SECTION SHEETS.
 - GUARDRAIL IS PROPOSED FROM STATION 211+28.17 RT TO 216+79.44 RT.
 - ** ANTICIPATED UNDERCUT LOCATIONS FOUND IN UNDERCUT TABLE.

PROPOSED DITCHES

STATION RANGE	SIDE/LOCATION	FRONT SLOPE	BOTTOM WIDTH	BACK SLOPE
211+50.00 TO 216+50.00	RIGHT	1:3 TO 1:2	2' MIN.	1:2.5 TO 1:2
216+78.00 TO 218+50.00	RIGHT	1:3	2' MIN.	1:3
218+00.00 TO 218+05.00	LEFT	1:4 TO 1:2	2' MIN.	1:50
220+00.00 TO 221+50.00	LEFT	1:3	2' MIN.	1:3 TO 1:2
219+40.81 TO 220+75.00	RIGHT	1:3	2' MIN.	1:3
222+50.00 TO 223+50.00	LEFT	1:2	2' MIN.	1:2
224+00.00 TO 228+00.00	LEFT	1:50 TO 1:2	2' MIN.	1:3 TO 1:2
223+75.35 TO 225+50.00	RIGHT	1:3 TO 1:2	2' MIN.	1:3
228+73.04 TO 230+60.00	LEFT	1:4	2' MIN.	1:3 TO 1:2
233+60.00 TO 233+90.00	RIGHT	1:3	2' MIN.	1:3
234+37.90 TO 234+50.00	RIGHT	1:3	2' MIN.	1:3
235+00.00 TO 235+50.00	LEFT	1:4	2' MIN.	1:3
237+81.31 TO 238+00.44	LEFT	1:2	3'	1:2
238+30.44 TO 238+80.00	LEFT	1:2	3' TO 5'	1:2
241+50.00 TO 242+50.00	RIGHT	1:4	2' MIN.	1:3
244+93.64 TO 245+70.00	RIGHT	1:3	2' MIN.	1:3
245+95.00 TO 246+74.90	LEFT	1:4 TO 1:2	2' MIN.	1:3 TO 1:2
245+95.00 TO 246+74.90	RIGHT	1:4	2' MIN.	1:3
247+50.00 TO 248+35.00	RIGHT	1:4	2' MIN.	1:3

PROPOSED UNDERCUTS

STATION RANGE	ESTIMATED UNDERCUT	GEOTEXTILE FABRIC UNDER AGGREGATE SUBGRADE BASE
216+00 TO 222+00	24"	YES
225+40 TO 228+50	24"	YES
228+50 TO 231+75	0"	YES
231+75 TO 234+75	6"	NO
237+00 TO 238+40	12"	YES
238+40 TO 239+50	24"	YES
244+25 TO 245+75	12"	NO
247+00 TO 249+65	24"	NO

ADDITIONAL NOTE:

- THE LONGITUDINAL JOINT SEALANT SHALL BE PLACED UNDER THE SURFACE LIFT AND UNDER THE TOP BINDER LIFT. SEE SCHEDULE OF QUANTITIES SHEET 17 OF 17, SHEET 28 OF 344 FOR LOCATIONS.

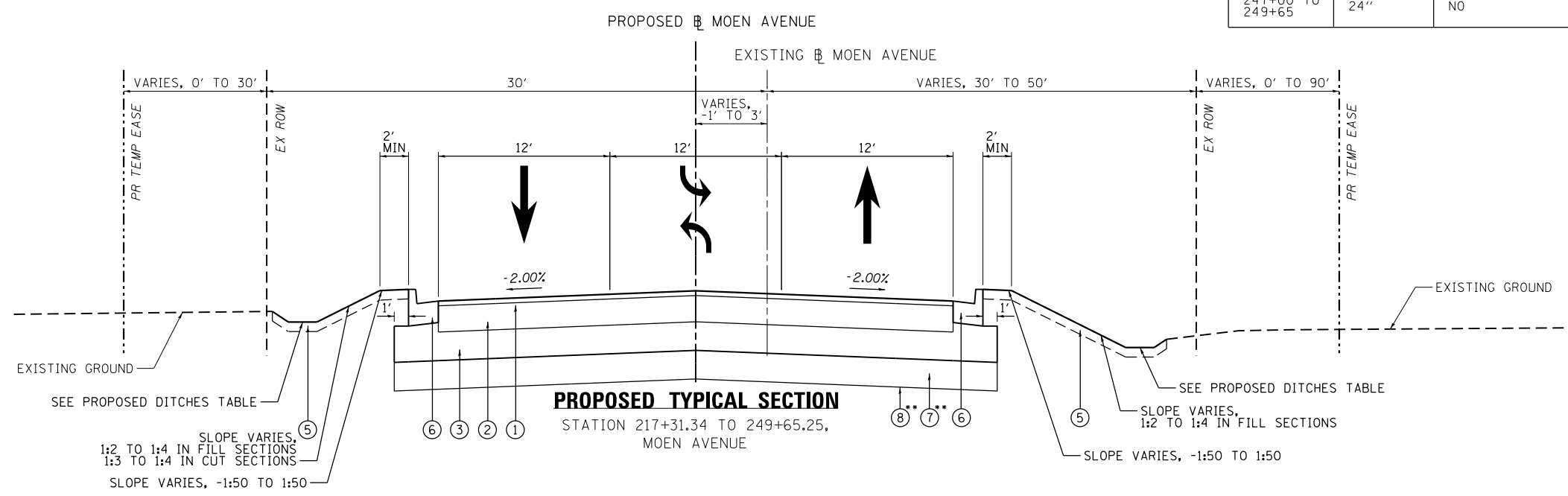

PROPOSED PAVEMENT LEGEND

- ① 2" POLYMERIZED HMA SURFACE COURSE, STONE MATRIX ASPHALT, 9.5, N80
- ② 11" HMA BINDER COURSE, IL-19.0, N70
- ③ AGGREGATE SUBGRADE IMPROVEMENT 12"
- ④ 8" AGGREGATE SHOULDER
- ⑤ 6" TOPSOIL FURNISH AND PLACE
- ⑥ COMBINATION CONCRETE CURB AND GUTTER, TYPE B-6.18
- ⑦ AGGREGATE SUBGRADE IMPROVEMENT (TYPE, DEPTH, AND LOCATION DETERMINED BY ENGINEER)
- ⑧ FABRIC FOR GROUND STABILIZATION (GEOTEXTILE FABRIC)

FILE = S:\PROJECTS\2016\1189J16_RK_Moen\DESIGN\TRANS\CADD\Sheets\1189J16-sht-typical3.dgn

REVISION	DATE	BY	REMARKS
1	8-27-2018	JSH	ADDED LONGITUDINAL JOINT SEALANT NOTE

STATE OF ILLINOIS
DEPARTMENT OF TRANSPORTATION

WILLETT HOFMANN & ASSOCIATES INC.
ENGINEERING ARCHITECTURE LAND SURVEYING
1000 ESSINGTON ROAD, JOLET, IL 60435
T: 315-729-2229 DESIGN FIRM: #184-000918

ROCKDALE
79 MOEN AVENUE
ROCKDALE, IL 60436

TYPICAL SECTIONS - MOEN AVENUE
SHEET 3 OF 3
STA. 211 + 35.00 TO 249 + 65.25

F.A.U. RTE.	SECTION	COUNTY	TOTAL SHEETS	SHEET NO.
3795	12-00029-00-PV	WILL	344	10

CONTRACT 61E00
WHA* 1189J16 | ILLINOIS

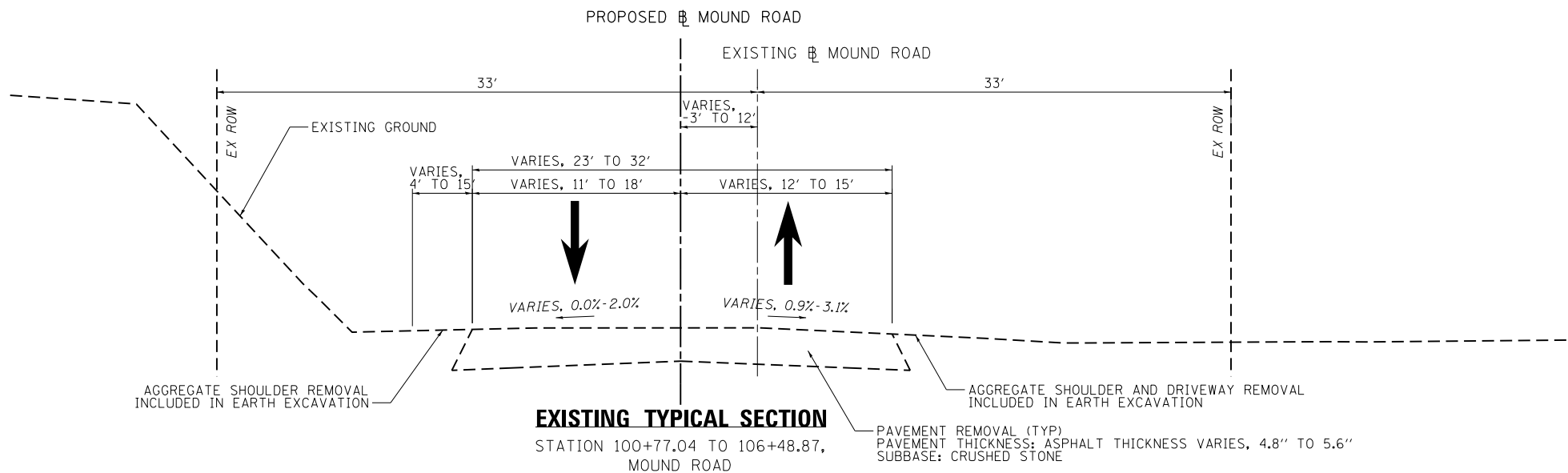

NOTES:

- *** AGGREGATE SHOULDER CONTINUES TO STA. 102+16.29, RT AND 106+06.33, LT.
- FOR DETAILED INFORMATION AT SPECIFIC LOCATIONS, SEE THE CROSS SECTION, AND PLAN AND PROFILE SHEETS.
- THE LONGITUDINAL JOINT SEALANT SHALL BE PLACED UNDER THE SURFACE LIFT AND UNDER THE TOP BINDER LIFT. SEE SCHEDULE OF QUANTITIES SHEET 17 OF 17, SHEET 28 OF 344 FOR LOCATIONS.

PROPOSED DITCHES

STATION RANGE	SIDE/LOCATION	FRONT SLOPE	BOTTOM WIDTH	BACK SLOPE
100+77.04 TO 105+84.77	LEFT	1:2	2' MIN.	1:2
100+77.04 TO 101+00.00	RIGHT	1:50	0'	1:6
103+50.00 TO 105+25.00	RIGHT	1:50 TO 1:4	2' MIN.	1:3

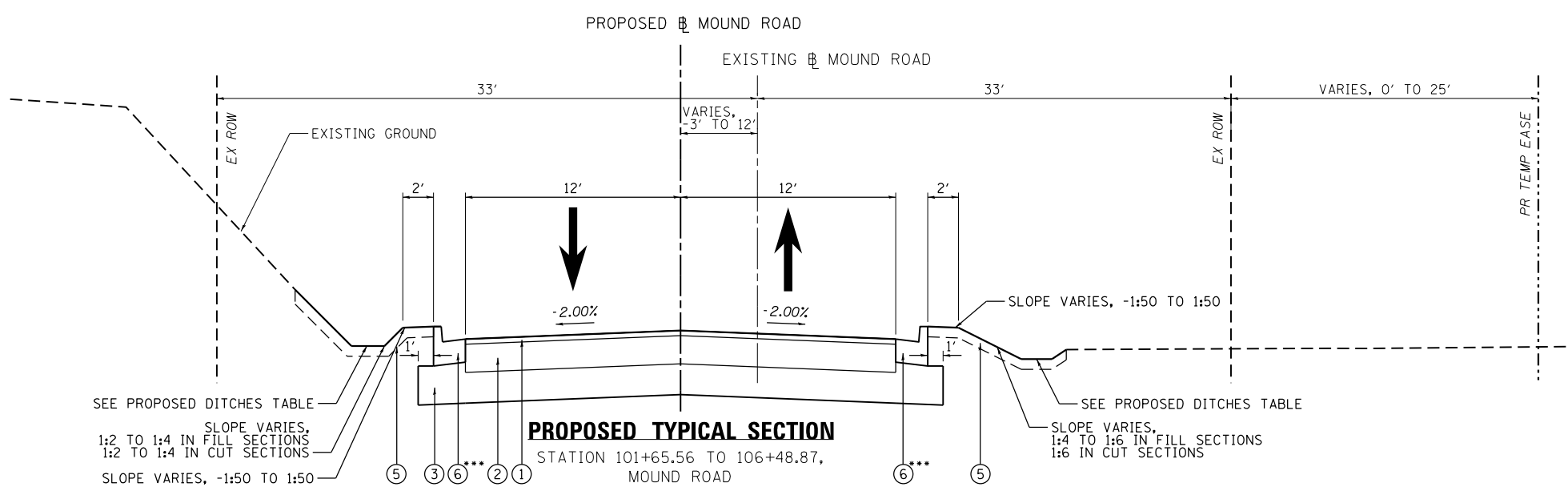
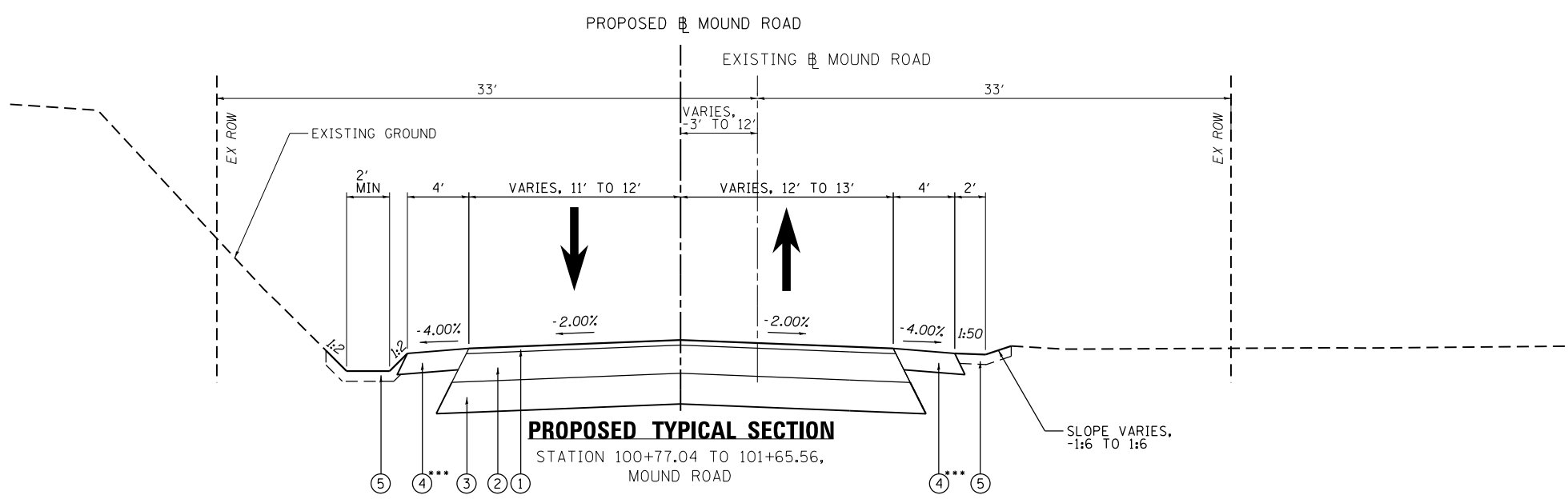

- PROPOSED PAVEMENT LEGEND**
- ① 2" POLYMERIZED HMA SURFACE COURSE, STONE MATRIX ASPHALT, 9.5, N80
 - ② 11" HMA BINDER COURSE, IL-19.0, N70
 - ③ AGGREGATE SUBGRADE IMPROVEMENT 12"
 - ④ 8" AGGREGATE SHOULDER
 - ⑤ 6" TOPSOIL FURNISH AND PLACE
 - ⑥ COMBINATION CONCRETE CURB AND GUTTER, TYPE B-6.18
 - ⑦ AGGREGATE SUBGRADE IMPROVEMENT (TYPE, DEPTH, AND LOCATION DETERMINED BY ENGINEER)
 - ⑧ FABRIC FOR GROUND STABILIZATION (GEOTEXTILE FABRIC)

FILE = S:\PROJECTS\2016\1189J16.RK.Moen\DESIGN\TRANS\CADD\Sheets\1189J16-sht-typical.dgn

REVISION	DATE	BY	REMARKS
1	8-27-2018	JSH	ADDED LONGITUDINAL JOINT SEALANT NOTE

DRAWN JSH
CHECKED GFS
APPROVED GFS

STATE OF ILLINOIS
DEPARTMENT OF TRANSPORTATION



79 MOEN AVENUE
ROCKDALE, IL 60436

TYPICAL SECTIONS - MOUND ROAD
SHEET 1 OF 1
STA. 100 + 77.04 TO 106 + 48.87

F.A.U. RTE.	SECTION	COUNTY	TOTAL SHEETS	SHEET NO.
3795	12-00029-00-PV	WILL	344	11
CONTRACT 61E00				
WHA* 1189J16	ILLINOIS			

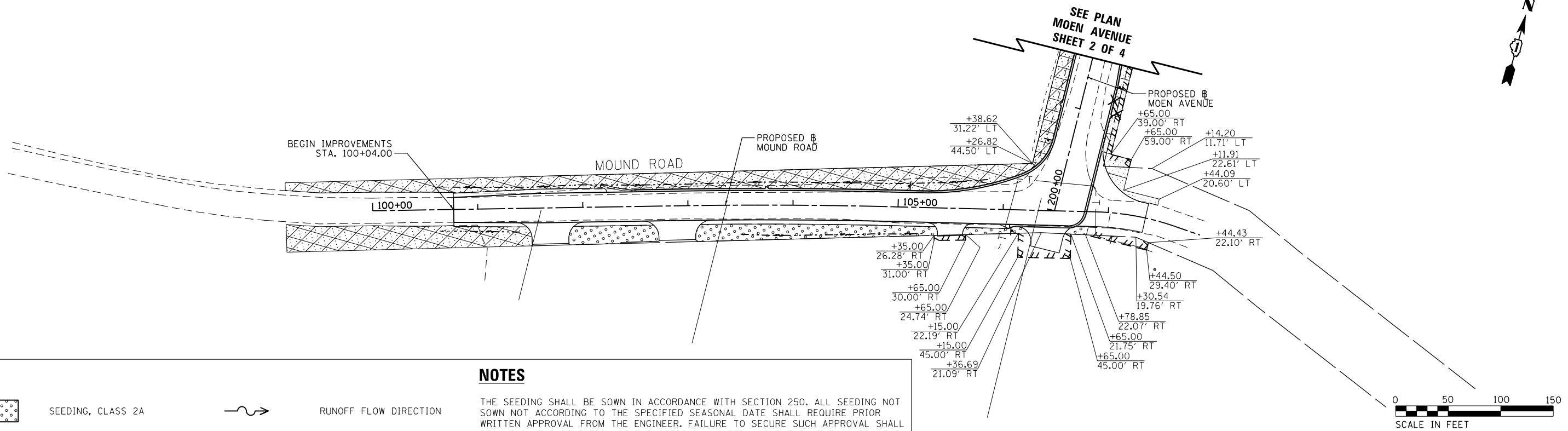

LEGEND

- SEEDING, CLASS 2A
- SEEDING, CLASS 4A
- SEEDING, CLASS 5A
- TREE REMOVAL
- RUNOFF FLOW DIRECTION
- TREE PROTECTION
- PROPOSED TREE

NOTES

THE SEEDING SHALL BE SOWN IN ACCORDANCE WITH SECTION 250. ALL SEEDING NOT SOWN NOT ACCORDING TO THE SPECIFIED SEASONAL DATE SHALL REQUIRE PRIOR WRITTEN APPROVAL FROM THE ENGINEER. FAILURE TO SECURE SUCH APPROVAL SHALL RESULT IN THE REJECTION OF THE SEEDING AND REPLACEMENT BY THE CONTRACTOR AT THEIR EXPENSE.

WOODY PLANTS SHALL BE PLANTED IN IN ACCORDANCE TO WITH SECTION 253. ALL PLANTING NOT ACCORDING TO THE SPECIFICATIONS SHALL REQUIRE PRIOR WRITTEN APPROVAL FROM THE ENGINEER. FAILURE TO SECURE SUCH APPROVAL SHALL RESULT IN THE REJECTION OF THE PLANTINGS AND REPLACEMENT BY THE CONTRACTOR AT THEIR EXPENSE.

TREE SCHEDULE

SCIENTIFIC NAME	COMMON NAME	SIZE	TOTAL
TILIA AMERICANA	AMERICA BASSWOOD	2.5" DIA.	10
CELTIS OCCIDENTALIS	HACKBERRY	2.5" DIA.	6
QUERCUS BICOLOR	SWAMP WHITE OAK	2.5" DIA.	3
BETULA NIGRA	RIVER BIRCH	6' HEIGHT	10
CRATAEGUS CRUSGALLI INERMIS	THORNLESS COCKSPUR HAWTHORN	2.0" DIA.	6

FILE = S:\PROJECTS\2016\1189J16.RK.Moen\DESIGN\TRANS\CADD\Sheets\1189J16-sht-1-landsc3.dgn

REVISION	DATE	BY	REMARKS
1	8-27-2018	JSH	ADDED MISSING SHEET TO PLAN SET

DRAWN	JSH
CHECKED	GFS
APPROVED	GFS

STATE OF ILLINOIS
DEPARTMENT OF TRANSPORTATION

WILLETT HOFMANN & ASSOCIATES INC.
ENGINEERING ARCHITECTURE LAND SURVEYING
1000 ESSINGTON ROAD, JOLIET, IL 60435
T: 315-729-2229 DESIGN FIRM: #184-000918

ROCKDALE
79 MOEN AVENUE
ROCKDALE, IL 60436

LANDSCAPING
MOUND ROAD PLAN SHEET - SHEET 3 OF 3

F.A.U. RTE.	SECTION	COUNTY	TOTAL SHEETS	SHEET NO.
3795	12-00029-00-PV	WILL	344	242
WHA* 1189J16 ILLINOIS			CONTRACT 61E00	