

CONTROL PT #1
(PK NAIL)
N10000.020
E10000.001
ELEV=97.17

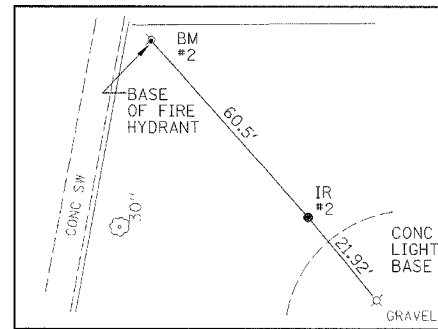

CONTROL PT #2
(IRON ROD)
N10752.413
E10020.798
ELEV=97.11

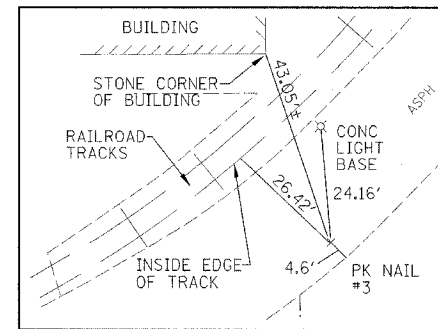

CONTROL PT #3
(PK NAIL)
N9989.810
E10421.806
ELEV=97.54

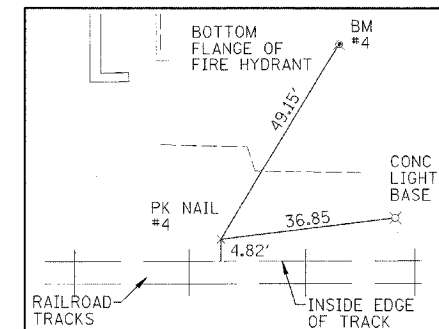

CONTROL PT #4
(PK NAIL)
N10248.978
E10165.146
ELEV=97.15

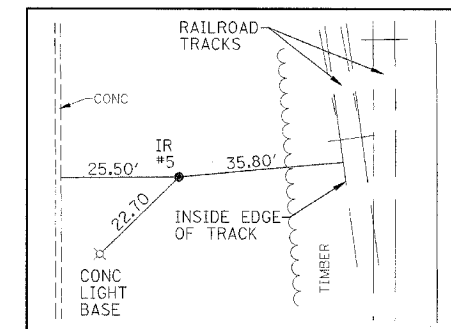

CONTROL PT #5
(IRON ROD)
N10271.111
E10439.198
ELEV=97.30

| BENCHMARK LOCATIONS | | |
|---------------------|--|----------------|
| NUMBER | DESCRIPTION | ELEVATION |
| ① | TOP FIRE HYDRANT NE CORNER OF E. 111TH ST & S. COTTAGE GROVE AVE | ASSUMED 100.00 |
| ② | TOP FIRE HYDRANT NW CORNER OF SITE (INSIDE FENCE) | 99.80 |
| ③ | TOP FIRE HYDRANT E SIDE NORTH BUILDING 150± S OF NE CORNER OF BUILDING | 100.34 |
| ④ | TOP FIRE HYDRANT 60'± E OF SE CORNER OF NORTH BUILDING | 100.25 |

GENERAL NOTES

- 1.) THE CONTRACTOR SHALL COMPLY WITH ALL APPLICABLE AND GENERAL CONDITIONS FOR BOTH THE ILLINOIS DEPARTMENT OF TRANSPORTATION (IDOT) AND THE CITY OF CHICAGO.
- 2.) THE CONTRACTOR SHALL OBTAIN ALL PERMITS NECESSARY TO COMPLETE THE WORK AND SHALL COORDINATE WITH BOTH IDOT AND THE APPROPRIATE DEPARTMENT WITH THE CITY OF CHICAGO.
- 3.) THE CONTRACTOR SHALL NOTIFY THE SITE MANAGER, MR. MIKE WAGENBACH, AT 773-660-2341, FORTY-EIGHT HOURS PRIOR TO MAKING ANY EXCAVATIONS ON THE PROJECT SITE. THE SITE MANAGER DESIRES TO OBSERVE ANY EXCAVATIONS AND DOCUMENT ANY ARTIFACTS UNCOVERED DURING SAME.

| BITUMINOUS TABLE | | | |
|---|---------|-----------------|---------|
| MIXTURE USE (S): | SURFACE | LEVELING BINDER | BINDER |
| PG | 58-22 | 58-22 | 58-22 |
| RAP % (MAX) | 15 | 25 | 30 |
| DESIGN AIR Voids | 4.2 | 4.2 | 4.2 |
| MIXTURE COMPOSITION (GRADATION MIXTURE) | IL 9.5 | IL 9.5 | IL 19.0 |
| FRICTION AGGREGATE | MIX C | N/A | N/A |
| 20 YEAR ESAL | N30 | N30 | N30 |

| APPLICATION RATES | |
|---|--------------|
| BITUMINOUS MATERIALS (PRIME COAT) MC-30 | 0.40 GAL/SY |
| BITUMINOUS MATERIALS (PRIME COAT) RC-70 | 0.10 GAL/SY |
| BITUMINOUS CONCRETE BINDER COURSE | 112 LB/IN/SY |
| BITUMINOUS CONCRETE SURFACE COURSE | 112 LB/IN/SY |
| GRANULAR MATERIALS | 2.05 TONS/CY |
| NITROGEN FERTILIZER NUTRIENT | 90 LB/ACRE |
| PHOSPHERUS FERTILIZER NUTRIENT | 90 LB/ACRE |
| POTASSIUM FERTILIZER NUTRIENT | 90 LB/ACRE |
| MULCH METHOD 1 | 2 TONS/ACRE |

| REVISIONS | |
|-----------|------|
| NAME | DATE |
| | |
| | |
| | |
| | |
| | |
| | |
| | |
| | |
| | |
| | |

ILLINOIS DEPARTMENT OF TRANSPORTATION
SURVEY TIES, BENCHMARKS
AND GENERAL NOTES
IDOT / IHPA
PULLMAN STATE HISTORIC SITE

SCALE: VERT.
HORIZ.
DATE: 11/08/05

DRAWN BY: DJM
CHECKED BY: PJM