

F.A.I. RTE.	SECTION	COUNTY	TOTAL SHEETS	SHEET NO.
90/94	•	COOK	312	58
STA. 4386+00 TO STA. 4410+00				
FED. ROAD DIST. NO. 1 ILLINOIS FED. AID PROJECT				
60A62 • (1919.15, 2021-922 PT1 & PT2) R-1				

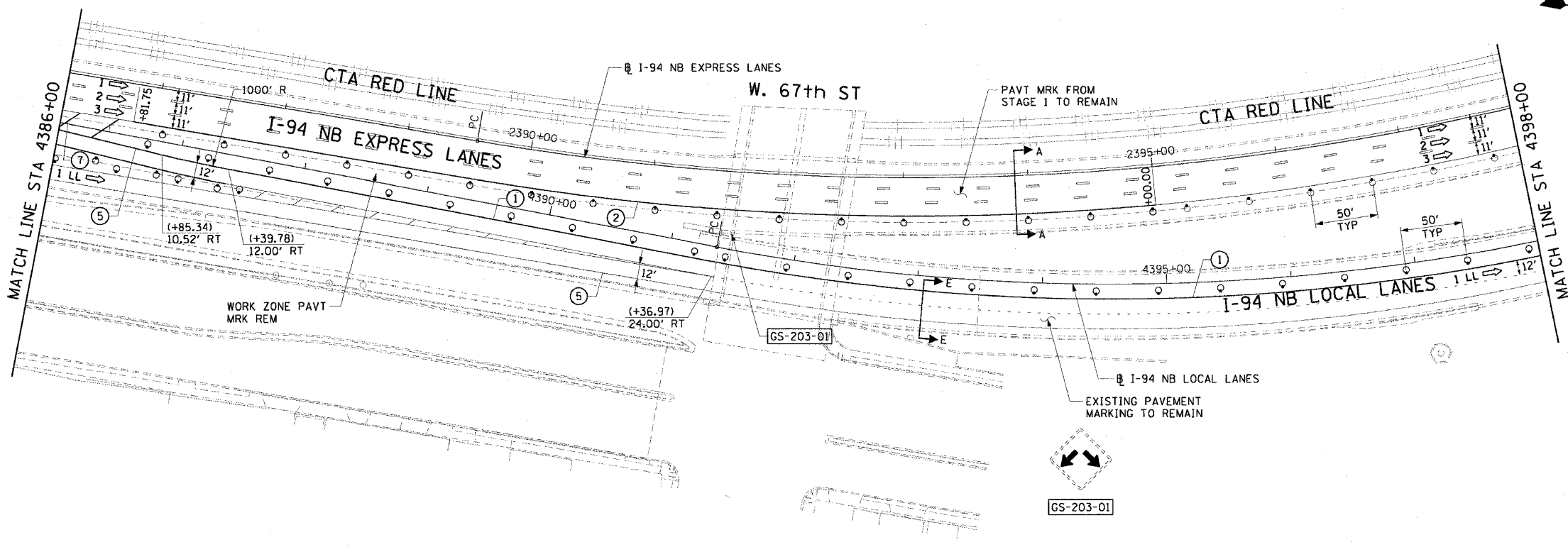

- LEGEND:**
- LANE NUMBER AND DIRECTION OF TRAFFIC
  - WORK AREA
  - TEMPORARY PAVEMENT
  - IMPACT ATTENUATORS, TEMPORARY (NON-REDIRECTIVE), TEST LEVEL 3
  - DRUM OR BARRICADE TYPE II WITH STEADY BURNING LIGHT
  - BARRICADE TYPE III
  - TEMPORARY CONCRETE BARRIER
  - LINE 4" (YELLOW EDGE)
  - LINE 4" (WHITE EDGE)
  - LINE 4" (SKIP DASH, 6' SKIP - 2' DASH, WHITE)
  - LINE 5" (SKIP DASH, 30' SKIP - 10' DASH, WHITE)
  - LINE 8" (WHITE GORE LINE)
  - LINE 8" (SKIP DASH, 12' SKIP - 3' DASH, WHITE)
  - LINE 12" (DIAGONAL, 30' C-C, WHITE)
  - LETTERS AND SYMBOLS
  - EXISTING OVERHEAD OR CANTILEVER SIGNS
  - EXISTING POST MOUNTED SIGNS
  - TEMPORARY SIGNS
- +XX.XX STATION PROVIDED FROM THE ± SB I-90/94 EXPRESS LANES  
 (+XX.XX) STATION PROVIDED FROM THE ± SB I-90/94 LOCAL LANES

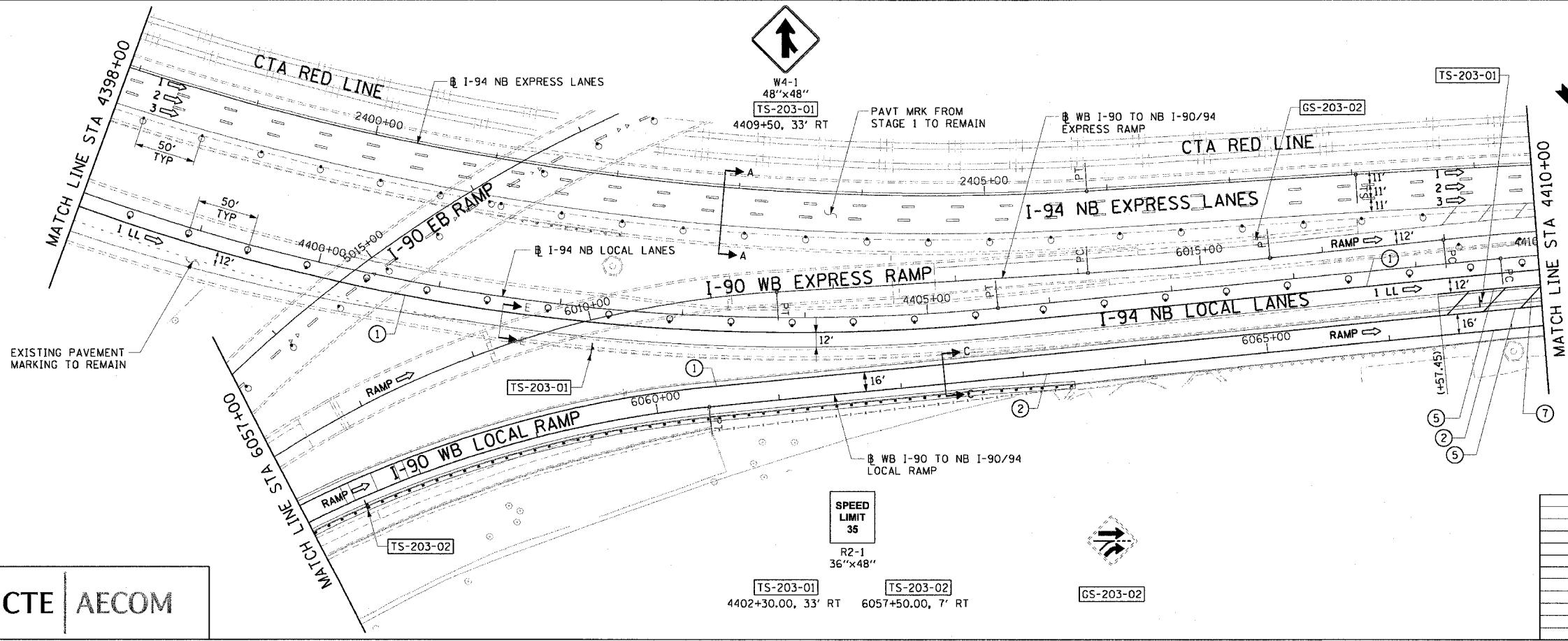

- NOTES:**
- SEE SHEET MOTTS-01 FOR TYPICAL SECTIONS.
  - SEE TEMPORARY SIGN PANEL SHEETS FOR DETAILS.

REVISIONS		DATE
NAME		

MOT-203

ILLINOIS DEPARTMENT OF TRANSPORTATION  
 F.A.I. 90/94 (DAN RYAN EXPRESSWAY)  
 63RD STREET TO GARFIELD BLVD (NB LOCAL LANES)

SUGGESTED STAGES OF CONSTRUCTION  
 AND TRAFFIC CONTROL  
 STAGE 2

SCALE: 1"=50'  
 DATE: June 9, 2006

DRAWN BY: PHP  
 CHECKED BY: RMG

**CTE AECOM**

**SPEED LIMIT 35**

R2-1  
36"x48"

**TS-203-01** 4402+30.00, 33' RT  
**TS-203-02** 6057+50.00, 7' RT

**GS-203-02**

P:\V4\468\468\I94-NB\chrt18 & 19\chrt18.ctb 18 & 19\chrt18.ctb 18 & 19\chrt18.ctb 18 & 19\chrt18.ctb