

F.A.I. RTE.	SECTION	COUNTY	TOTAL SHEETS	SHEET NO.
90/94	•	COOK	312	217
STA.		TO STA.		
FED. ROAD DIST. NO. 1		ILLINOIS FED. AID PROJECT		
60A62		• (1919.15, 2021-922 PT1 & PT2) R-1		

DOUBLE FACE CONCRETE BARRIER TRANSITION
N.T.S.

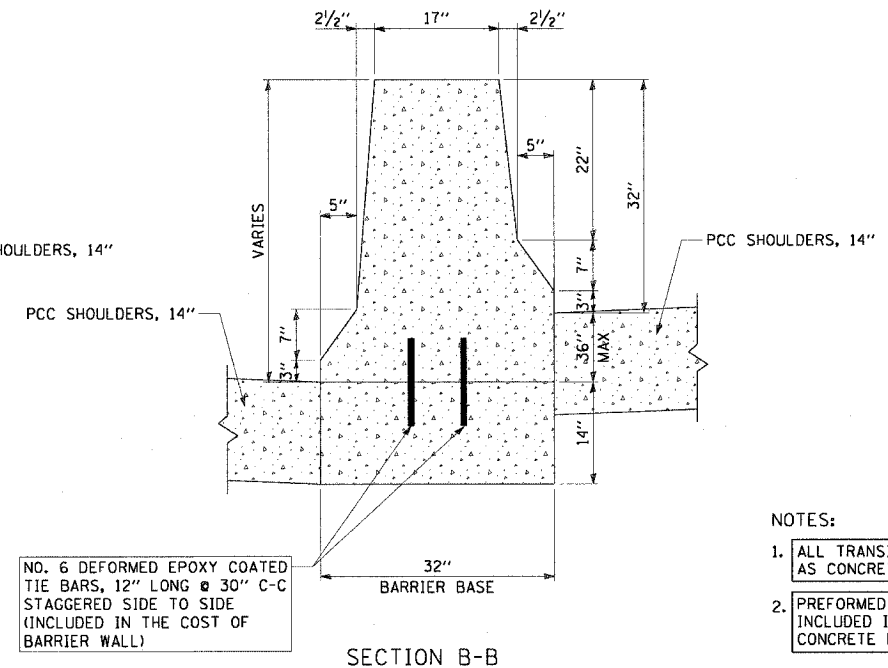
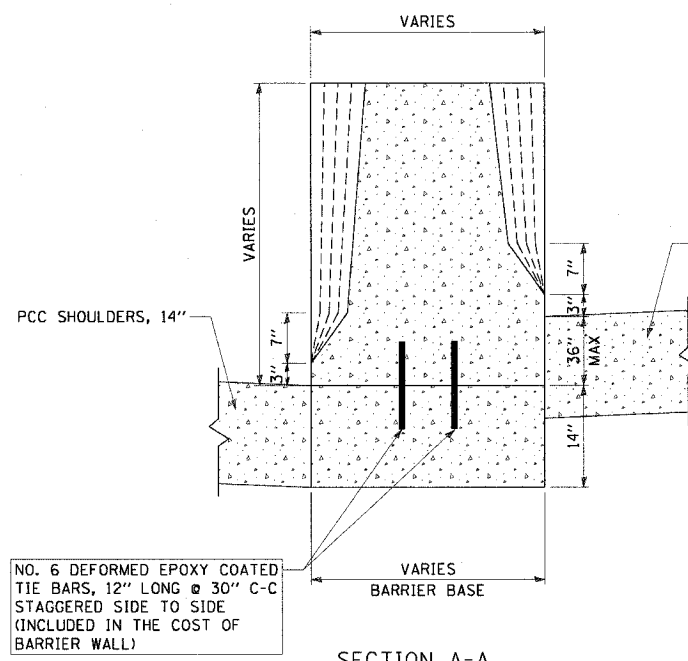
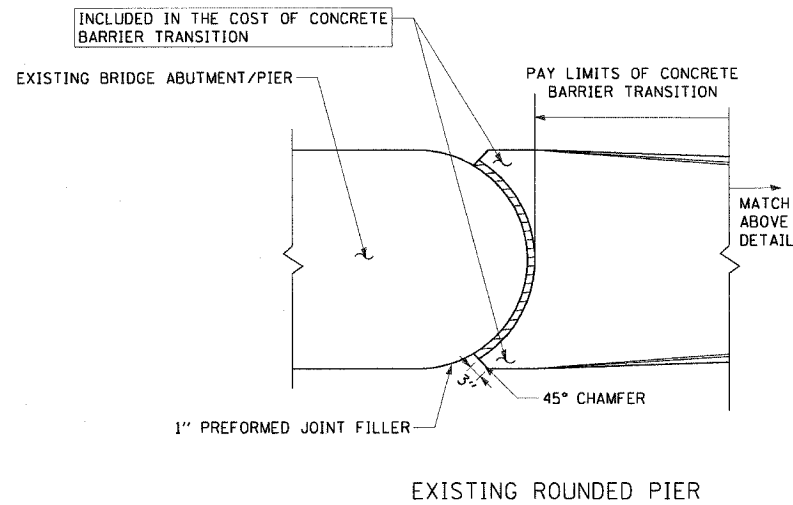
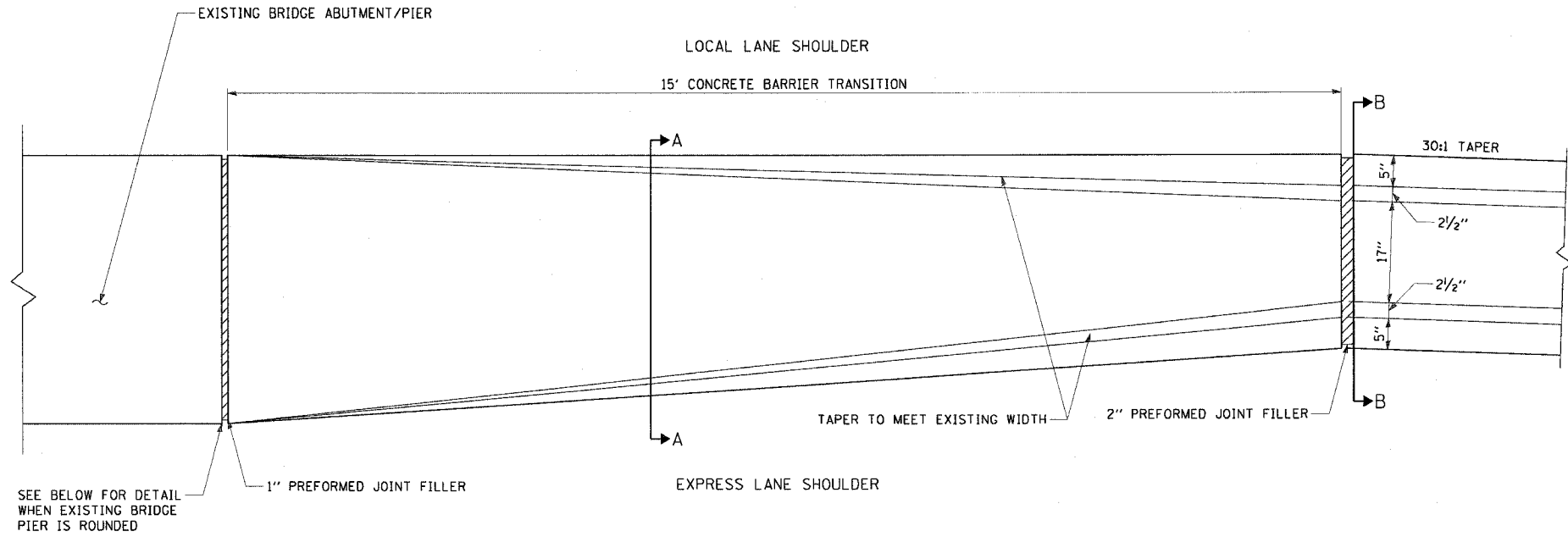

NOTES:

- ALL TRANSITIONS SHALL BE PAID FOR AS CONCRETE BARRIER TRANSITION
- PREFORMED JOINT FILLER SHALL BE INCLUDED IN THE COST OF THE CONCRETE BARRIER TRANSITION.

REVISIONS	
NAME	DATE

ILLINOIS DEPARTMENT OF TRANSPORTATION
F.A.I. 90/94 (DAN RYAN EXPRESSWAY)
63RD STREET TO GARFIELD BLVD (NB LOCAL LANES)

ROADWAY DETAILS
DOUBLE FACE CONCRETE BARRIER TRANSITION

SCALE: NONE
DATE: June 9, 2006

DRAWN BY: NJH
CHECKED BY: RMG

CTE | AECOM

RDT-10

9:33:50 AM 5/5/2006