

F.A.I. RTE.	SECTION	COUNTY	TOTAL SHEETS	SHEET NO.
90/94	*	COOK	247	161
STA.		TO STA.		
FED. ROAD DIST. NO. 1		ILLINOIS	FED. AID PROJECT	
60A63		• (1919.15, 2021-922 PT1 & PT2) R-2		

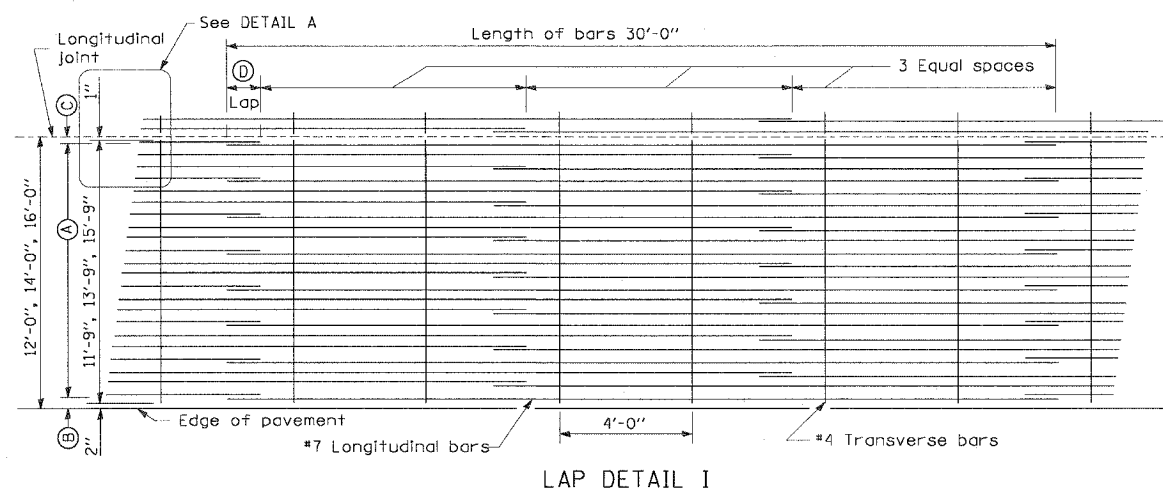

Pavement Width	Bar Size	Pavement Thickness	(A) (Approx. Spacing)	(B)	(C)	(D)
12 feet	#7	14"	23 spaces (24 bars) @ 6"	3 1/2"	3"	26"
14 feet	#7	14"	27 spaces (28 bars) @ 6"	3 1/2"	3"	26"
16 feet	#7	14"	31 spaces (32 bars) @ 6"	3 1/2"	3"	26"

1

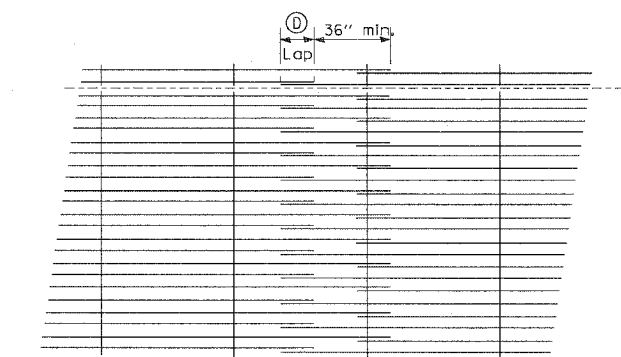
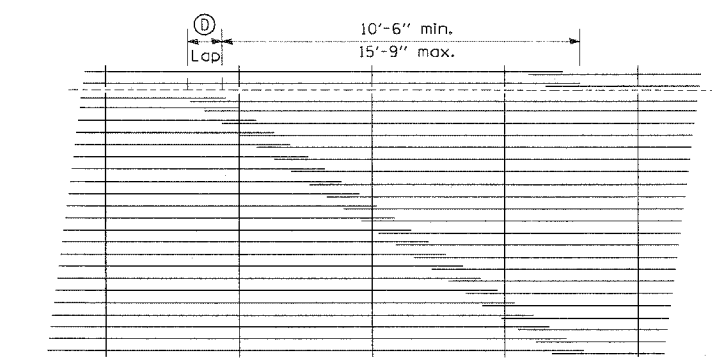
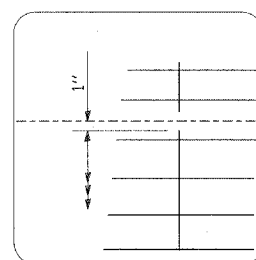

GENERAL NOTES

1. THE PAVEMENT REINFORCEMENT SHALL BE 4.5" FROM THE TOP OF PAVEMENT.
2. EXCEPT AS NOTED OR SHOWN, THE DIMENSIONS AND NOTES SPECIFIED FOR LAP DETAIL I ARE TYPICAL FOR LAP DETAIL II AND III.
3. THE (B) DIMENSION AND THE DISTANCE FROM THE END OF THE TRANSVERSE BAR TO THE EDGE OF PAVEMENT MAY BE INCREASED BY 1" FOR SLIP FORM PAVING.

RDT-1

REVISIONS	
NAME	DATE
ADDENDUM 1	7/27/06

ILLINOIS DEPARTMENT OF TRANSPORTATION
F.A.I. 90/94 (DAN RYAN EXPRESSWAY)
63RD STREET TO GARFIELD BLVD (SB LOCAL LANES)
ROADWAY DETAILS
EXTENDED LANE REINFORCEMENT FOR
CONTINUOUSLY REINFORCED PCC PAVEMENT

SCALE: NONE
DATE: June 9, 2006
DRAWN BY: NJH
CHECKED BY: RMG

CTE | AECOM

P:\P\0468\CIV\NB-Chrs 18 & 19\STP\Ch17 19ANRoadway Details\CIV\900215.rvt 10:55:45 AM 7/27/2006