

F.A.I. RTE.	SECTION	COUNTY	TOTAL SHEETS	SHEET NO.
90/94	*	COOK	247	132
STA. 3422+73.29 TO STA. 3423+91.19				
FED. ROAD DIST. NO. 1 ILLINOIS		FED. AID PROJECT		
60A63		(1919.15, 2021-922 PT1 & PT2) R-2		

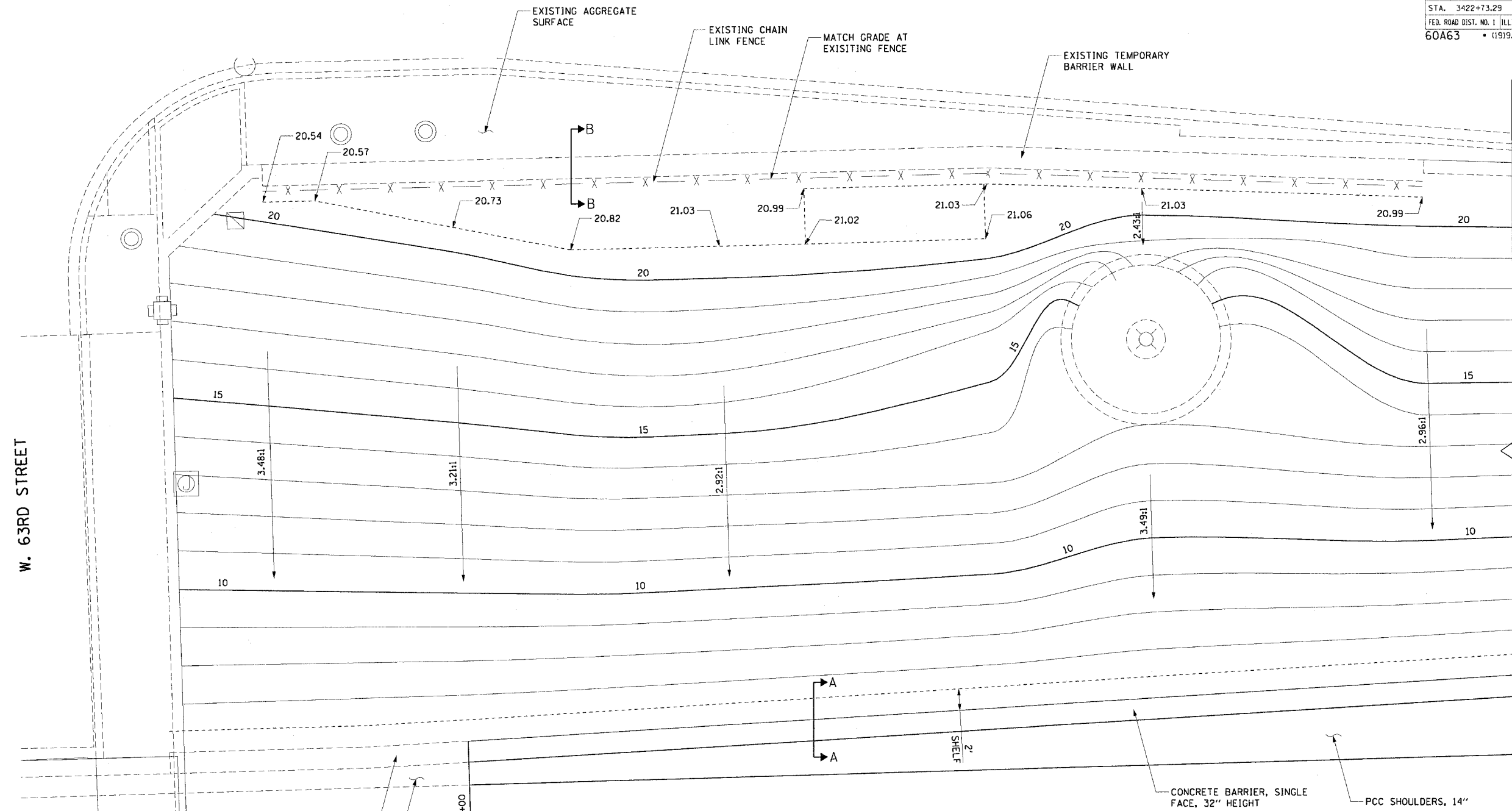

W. 63RD STREET

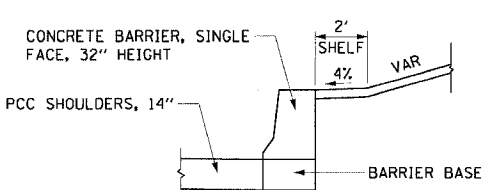

SECTION A-A

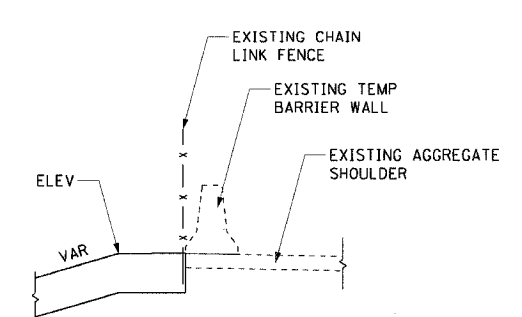

SECTION B-B

GRADING ELEVATIONS		
STATION	OFFSET	ELEV
3422+82.21	81.49' LT	20.54
3423+00.00	78.59' LT	20.73
3423+11.01	76.12' LT	20.82
3423+25.00	76.07' LT	21.03
3423+33.06	76.03' LT	21.02
3423+50.00	76.03' LT	21.06
3423+64.77	80.33' LT	21.03
3423+91.14	78.74' LT	20.94

NOTE:
ELEVATIONS ARE FOR FUTURE LOCATION OF FLUTED KNEE WALL CONSTRUCTED IN CONTRACT 62985.

REVISIONS	
NAME	DATE

GR-2
ILLINOIS DEPARTMENT OF TRANSPORTATION
F.A.I. 90/94 (DAN RYAN EXPRESSWAY)
63RD STREET TO GARFIELD BLVD (SB LOCAL LANES)
GRADING PLANS
SCALE: 1"=5'
DATE: June 9, 2006
DRAWN BY: NJH
CHECKED BY: XXX

CTE | AECOM

6/7/2006 10:34:44 PM P:\A\60A63\60A63.dwg\132.dwg