

SIGNAL CONSTRUCTION SEQUENCE

1. INSTALL TEMPORARY WOOD POLES, SPAN & TETHER WIRE SIGNAL HEADS, ELECTRIC CABLE.
2. TURN OFF SIGNAL, CONNECT TEMPORARY SPAN WIRE CABLE TO SIGNAL JUNCTION BOXES ON NORTH-WEST & SOUTHWEST LIGHT POLES. DISCONNECT & REMOVE SIGNAL CABLE FROM THE NORTHEAST AND SOUTHEAST JUNCTION BOXES, PULL CABLE INTO ADJACENT MANHOLES AND STORE FOR FUTURE REINSTALLATION. PLACE TEMPORARY SIGNALS INTO OPERATION WITH MODIFIED SEQUENCE OF OPERATION & SIGNAL TIMING. REMOVE LIGHT POLES, BRACKET ARMS LUMINAIRES, MAST ARMS, TRAFFIC & PEDESTRIAN SIGNALS IN THE NORTHEAST & SOUTHEAST QUADRANTS, STORE FOR FUTURE REINSTALLATION.
3. ADJUST MANHOLE FRAMES & LIDS IN THE NORTHEAST AND SOUTHEAST QUADRANTS FOR NEW APPROACH SLAB.
4. REINSTALL LIGHT POLES, BRACKET ARMS, LUMINAIRES, MAST ARMS, TRAFFIC AND PEDESTRIAN SIGNALS ON THE PRESERVED CONCRETE FOUNDATIONS IN THE NORTHEAST & SOUTHEAST QUADRANTS.
5. TURN OFF SIGNAL, DISCONNECT TEMPORARY SPAN WIRE ELECTRIC CABLE, RECONNECT ORIGINAL ELECTRIC CABLE STORED IN MANHOLES TO ORIGINAL LIGHTING & SIGNAL EQUIPMENT ON LIGHT POLES IN THE NORTHEAST & SOUTHEAST QUADRANTS. PLACE ORIGINAL SIGNAL SYSTEM BACK INTO OPERATION, WITH ORIGINAL SEQUENCE OF OPERATION AND SIGNAL TIMING.
6. REMOVE ALL TEMPORARY SIGNAL EQUIPMENT, INCLUDING TEMPORARY WOOD POLES, SPAN & TETHER WIRE, TEMPORARY ELECTRIC CABLE AND APPURTENANCES.

THIS CONSTRUCTION SEQUENCE SHALL NOT BE MODIFIED WITHOUT THE PRIOR APPROVAL OF THE ENGINEER.

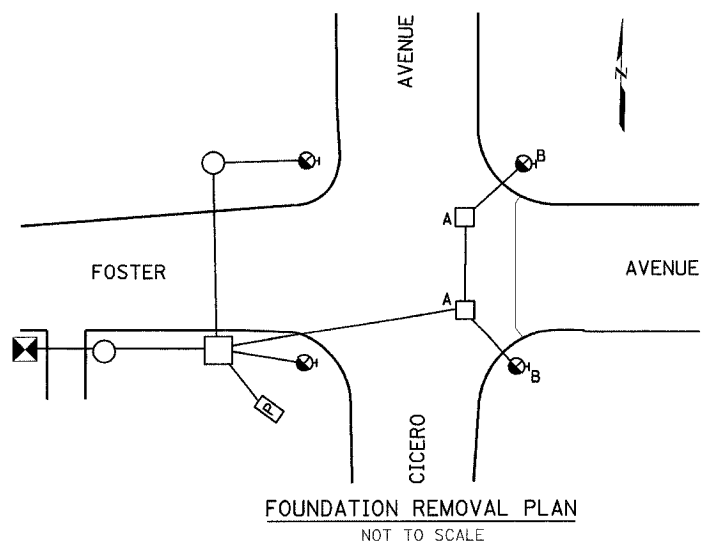
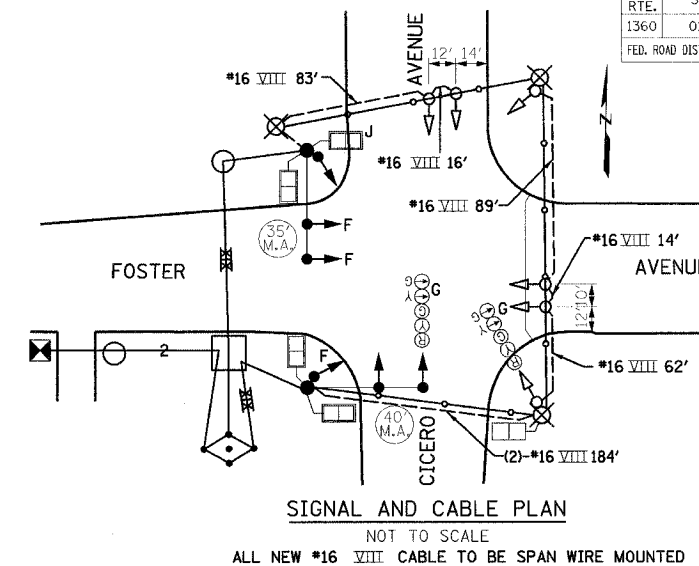
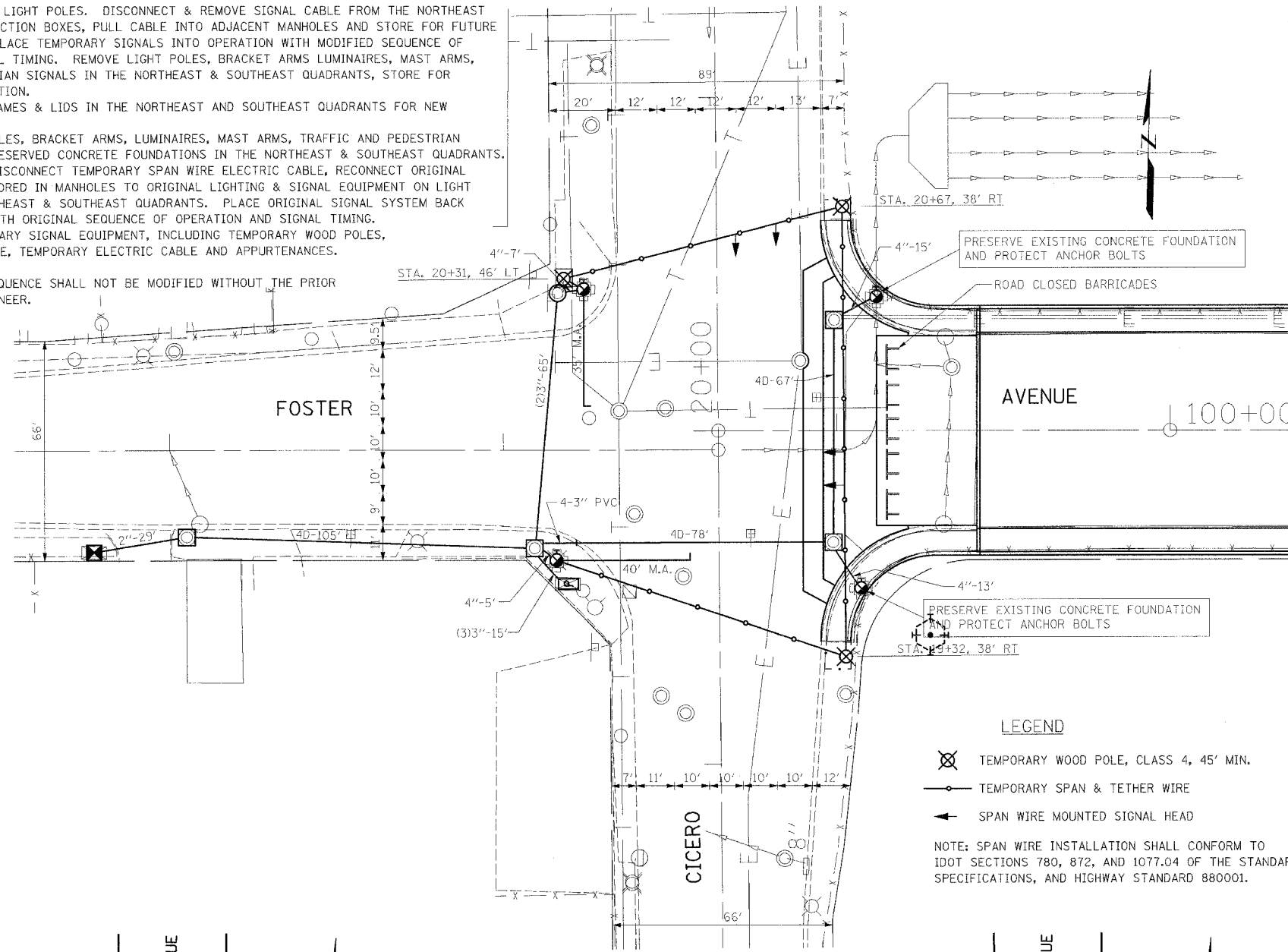

REMOVAL NOTES:

- A - ADJUST EXISTING MANHOLE FRAME & LID
 - B - PRESERVE EXISTING CONCRETE FOUNDATION AND PROTECT ANCHOR BOLTS
 - C - REMOVE EXISTING MAST ARM ASSEMBLY
 - D - REMOVE EXISTING SIGNAL HEADS
 - E - REMOVE EXISTING PEDESTRIAN HEADS
 - F - COVER AND DE-ENERGIZE WB SIGNAL HEAD DURING CONSTRUCTION
 - G - COVER AND DE-ENERGIZE SB TURN ARROWS DURING CONSTRUCTION.
 - H - PULL ELECTRICAL CABLE BACK TO MANHOLE, DE-ENERGIZE, STORE
 - J - COVER AND DE-ENERGIZE PEDESTRIAN SIGNAL HEAD
- ITEMS C,D,E; REMOVE AND STORE FOR REINSTALLATION

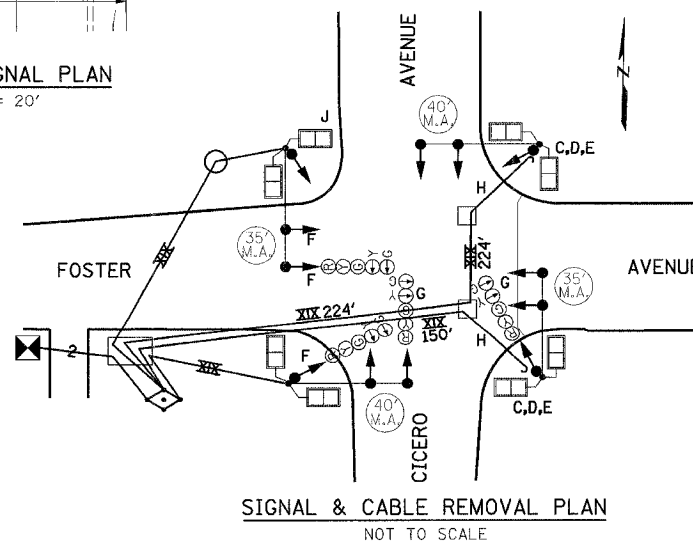

BILL OF MATERIAL		
TEMPORARY TRAFFIC SIGNAL INSTALLATION	UNIT	QTY
TEMPORARY WOOD POLE, 45 FT., CLASS 4	EACH	1
TEMPORARY WOOD POLE, 45 FT., CLASS 4, 15 FT. MAST ARM	EACH	2
CONDUIT ATTACHED TO STRUCTURE, 4" DIA., PVC	FOOT	30
SERVICE ENTRANCE ON POLE TOP, 2"	EACH	2
SIGNAL HD, POLYCARB., LED, 3-SECT., BRKT MNTD	EACH	1
SIGNAL HD, POLYCARB., LED, 3-SECT., SPAN WIRE MNTD	EACH	4
SIGNAL HEAD, POLYCARB., LED, 5-SECT., BRKT MNTD	EACH	1
PEDESTRIAN SIGNAL, POLYCARB., LED, 1-FACE, BRKT MNTD	EACH	1
SPAN WIRE AND TETHER WIRE	FOOT	333
HARNES CABLE, AERIAL SUSPENDED, NO. 16 8/C	FOOT	448
MODIFY EXISTING CONTROLLER	EACH	1
SPAN WIRE ACCESSORIES	EACH	1



Expires 11-30-2007

EJM ENGINEERING, INC.
411 South Wells Street Suite 800
Chicago, Illinois 60607

REVISIONS	
NAME	DATE

ILLINOIS DEPARTMENT OF TRANSPORTATION
FOSTER AVE. BRIDGE OVER I-94
 TEMPORARY TRAFFIC SIGNAL INSTALLATION
 N. CICERO AVENUE & W. FOSTER AVENUE
 DRAWING No. 12867 (TEMPORARY)

SCALE: AS NOTED
 DATE: JUNE 30, 2005
 DRAWN BY: PRK
 CHECKED BY: JM