

F.A.P. RTE.	SECTION	COUNTY	TOTAL SHEETS	SHEET NO.
307	2006-003 TS	COOK	63	44
STA.		TO STA.		
FED. ROAD DIST. NO.	ILLINOIS	FED. AID PROJECT		

CONTRACT NO. 60B13

TRAFFIC SIGNAL LEGEND

	PROPOSED	EXISTING
CONTROLLER CABINET		
RAILROAD CONTROL CABINET		
SERVICE INSTALLATION, (P) POLE OR (G) GROUND MOUNT		
TELEPHONE CONNECTION		
SIGNAL HEAD		
SIGNAL HEAD WITH BACKPLATE		
SIGNAL HEAD OPTICALLY PROGRAMMED		
SIGNAL HEAD PEDESTRIAN		
ILLUMINATED SIGN "NO LEFT TURN"		
ILLUMINATED SIGN "NO RIGHT TURN"		
SIGNAL POST		
WOOD POLE		
STEEL MAST ARM ASSEMBLY AND POLE		
ALUMINUM MAST ARM ASSEMBLY AND POLE		
STEEL COMBINATION MAST ARM ASSEMBLY AND POLE WITH LUMINAIRE		
JUNCTION BOX		
HANDHOLE		
HEAVY DUTY HANDHOLE		
DOUBLE HANDHOLE		
G.S. CONDUIT IN TRENCH OR PUSHED		
COMMON TRENCH	CT	
UNIT DUCT	UD	
PEDESTRIAN PUSHBUTTON DETECTOR		
DETECTOR LOOP, TYPE I		
PREFORMED DETECTOR LOOP		
MICROWAVE VEHICLE SENSOR		
VIDEO DETECTOR		
CLOSED CIRCUIT TV		
EMERGENCY VEHICLE SYSTEM DETECTOR		
CONFIRMATION BEACON		

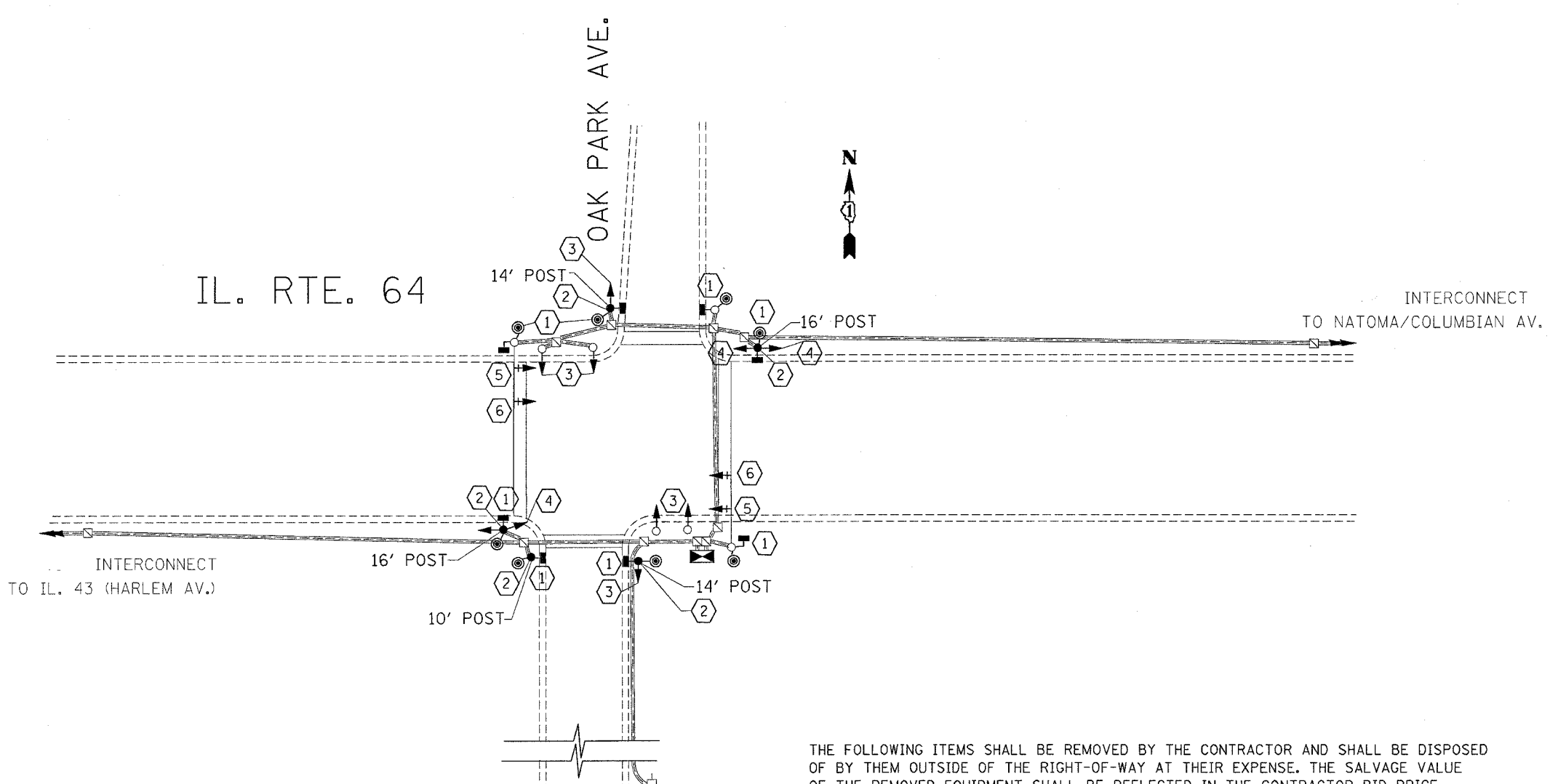

- ① REMOVE EXISTING PEDESTRIAN SIGNAL HEADS AND PUSH BUTTONS AND REPLACE WITH NEW L.E.D. SIGNAL HEADS AND PUSH BUTTONS
- ② REMOVE EXISTING SIGNAL POST AND REPLACE WITH NEW GALVANIZED SIGNAL POST USING EXISTING FOUNDATION.
- ③ REMOVE EXISTING 1-FACE, 3-SECTION SIGNAL HEAD AND REPLACE WITH NEW L.E.D. 12" 1-FACE, 3-SECTION SIGNAL HEAD.
- ④ REMOVE EXISTING 2-FACE, 1-3 SECTION, 1-5 SECTION SIGNAL HEAD AND REPLACE WITH NEW L.E.D. 12" 2-FACE, 1-3-SECTION, 1-5 SECTION SIGNAL HEAD.
- ⑤ REMOVE EXISTING 1-FACE, 3-SECTION SIGNAL HEAD MAST ARM MOUNTED AND REPLACE WITH NEW L.E.D. 1-FACE, 3-SECTION SIGNAL HEAD MAST ARM MOUNTED
- ⑥ REMOVE EXISTING 1-FACE, 5-SECTION SIGNAL HEAD MAST ARM MOUNTED AND REPLACE WITH NEW L.E.D. 1-FACE, 5-SECTION SIGNAL HEAD MAST ARM MOUNTED

- THE FOLLOWING ITEMS SHALL BE REMOVED BY THE CONTRACTOR AND SHALL BE DISPOSED OF BY THEM OUTSIDE OF THE RIGHT-OF-WAY AT THEIR EXPENSE. THE SALVAGE VALUE OF THE REMOVED EQUIPMENT SHALL BE REFLECTED IN THE CONTRACTOR BID PRICE.
- 6 EACH SIGNAL HEAD, 3-SECTION
 - 2 EACH SIGNAL HEAD, 3-SECTION MAST ARM MNTD.
 - 2 EACH SIGNAL HEAD, 5-SECTION, MAST ARM MNTD.
 - 2 EACH SIGNAL HEAD, 2 FACE, 1-3 SECTION, 1-5 SECTION
 - 8 EACH PEDESTRIAN PUSH-BUTTONS
 - 8 EACH PEDESTRIAN SIGNAL HEADS
 - 1 EACH 10' SIGNAL POST
 - 2 EACH 14' SIGNAL POSTS
 - 2 EACH 16' SIGNAL POSTS
 - 4 EACH BACKPLATE

RESTORATION OF WORK AREA, RESTORATION OF THE TRAFFIC SIGNAL WORK AREA SHALL BE INCLUDED IN THE RELATED PAY ITEMS SUCH AS FOUNDATION, CONDUIT, HANDHOLE, TRENCH AND BACKFILL, ETC. ALL ROADWAY SURFACES SUCH AS SHOULDERS, MEDIANS, SIDEWALKS, PAVEMENT, ETC. SHALL BE REPLACED IN KIND. ALL DAMAGE TO MOWED LAWNS SHALL BE REPLACED WITH AN APPROVED SOD AND ALL DAMAGE TO UNMOWED FIELDS SHALL BE SEEDED. RESTORATION OF THE WORK AREA SHALL BE INCIDENTAL TO THE CONTRACT WITHOUT ANY EXTRA COMPENSATION ALLOWED TO THE CONTRACTOR.

REVISIONS	
NAME	DATE

ILLINOIS DEPARTMENT OF TRANSPORTATION
TRAFFIC SIGNAL MODIFICATION
 ILL. RTE. 64 (NORTH AVE.) AT
 OAK PARK AVE.

SCALE: 1"=20'
 DATE 6/23/2006

DRAWN BY BCK
 DESIGNED BY BCK
 CHECKED BY DAD