

F.A.I. RTE.	SECTION	COUNTY	TOTAL SHEETS	SHEET NO.
55	2006-031 BY	WILL	137	41
STA.	TO STA.			
FED. ROAD DIST. NO.	ILLINOIS	FED. AID PROJECT		

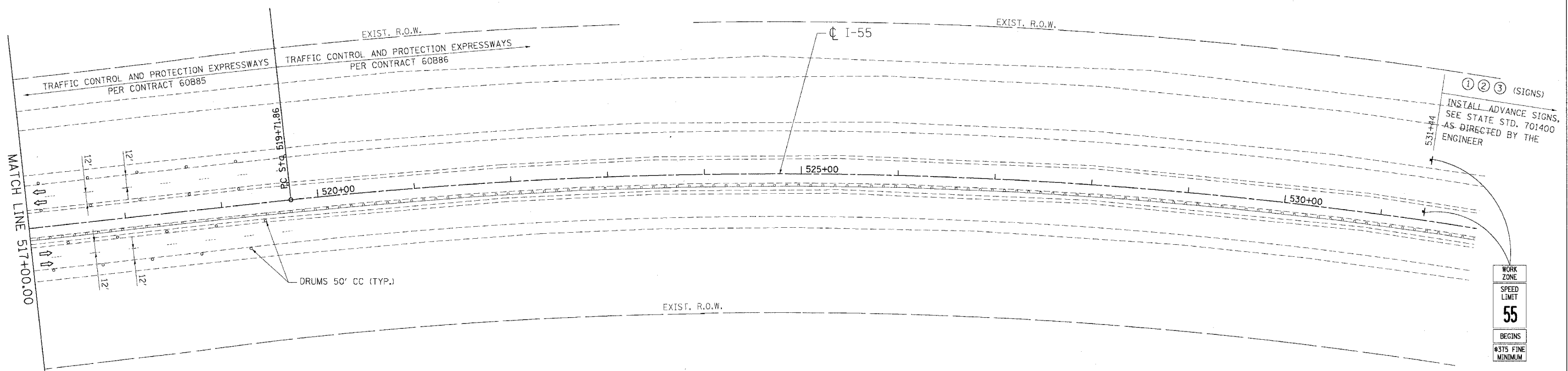
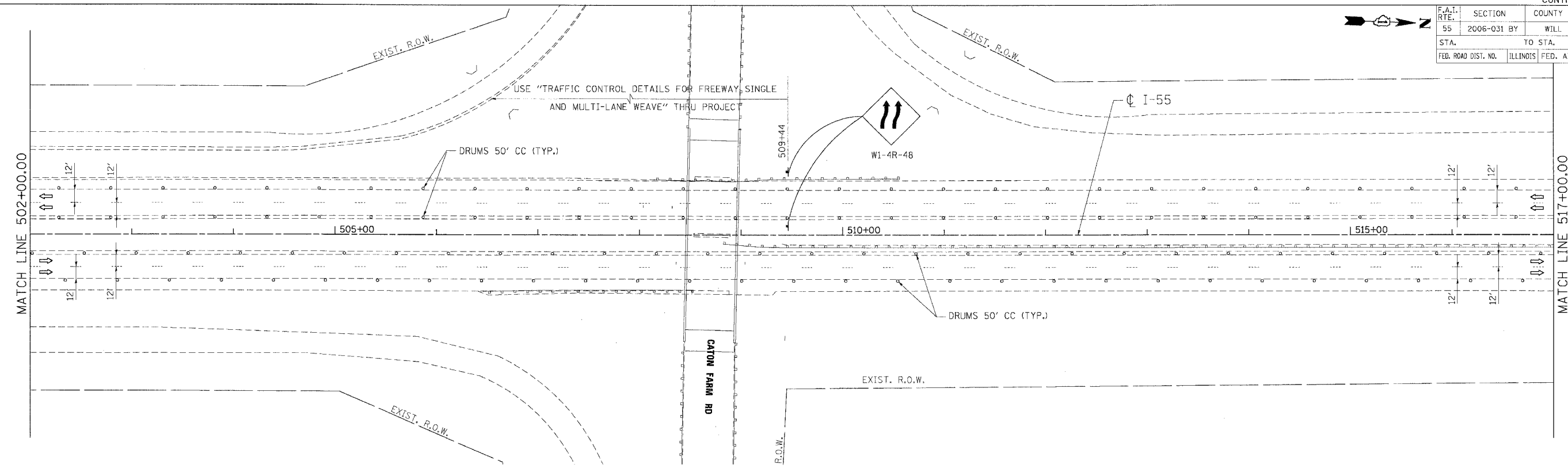

LEGEND

- WORK AREA
- DRUMS W/ MONO-DIRECTIONAL STEADY BURN LIGHT
- VERTICAL PANEL
- TEMPORARY CONC. BARRIER
- TRAFFIC FLOW
- BARRICADE, TYPE III WITH TWO FLASHING LIGHTS
- ① PVMT. MARKING TAPE, TYPE III, 4", YELLOW
- ② PVMT. MARKING TAPE, TYPE III, 4", WHITE
- ③ PVMT. MARKING TAPE, TYPE III, 5" (10' DASH 30' SKIP)
- ④ PVMT. MARKING TAPE, TYPE III, 4" WHITE (2' DASH 6' SKIP)

NOTE:

AFTER CONSTRUCTION OF THE CONCRETE BARRIER AND THE BASE COURSE FOR THE NEW INSIDE LANES AND SHOULDERS IS COMPLETED, THE TEMPORARY CONCRETE BARRIER SHALL BE REMOVED AND REPLACED WITH DRUMS WITH STEADY BURN LIGHTS AT THE SPACING SHOWN IN THE PLANS.

REVISIONS	
NAME	DATE

ILLINOIS DEPARTMENT OF TRANSPORTATION
 FAI ROUTE 55 (OVER CSX RR AND SUNNYLAND DRAIN)
 BRIDGE WIDENING

**STAGING AND TRAFFIC CONTROL
 FAI 55 - STAGE I
 STA. 502+00.00 TO STA. 532+00.00**

SCALE: 1"=50'
 DATE 07/07/06
 DRAWN BY FS
 CHECKED BY DDH

TENG ENGINEERS/ARCHITECTS/PLANNERS
 CHICAGO, ILLINOIS

PLOT DATE = 8/2/06
 FILE NAME = #FILE#
 USER NAME = #USER#
 N:\PROJECTS\60B85\DRAWINGS\60B85-031\60B85-031-41.DWG
 7/26/2006 10:28:45
 CAROLANZ - S:\DOCUMENTS\60B85\60B85-031\60B85-031-41.DWG
 N:\PROJECTS\60B85\DRAWINGS\60B85-031\60B85-031-41.DWG
 N:\PROJECTS\60B85\DRAWINGS\60B85-031\60B85-031-41.DWG
 N:\PROJECTS\60B85\DRAWINGS\60B85-031\60B85-031-41.DWG
 N:\PROJECTS\60B85\DRAWINGS\60B85-031\60B85-031-41.DWG