

F.A.I. RTE.	SECTION	COUNTY	TOTAL SHEETS	SHEET NO.
55	2006-031 BY	WILL	137	45
STA.		TO STA.		
FED. ROAD DIST. NO.		ILLINOIS		FED. AID PROJECT

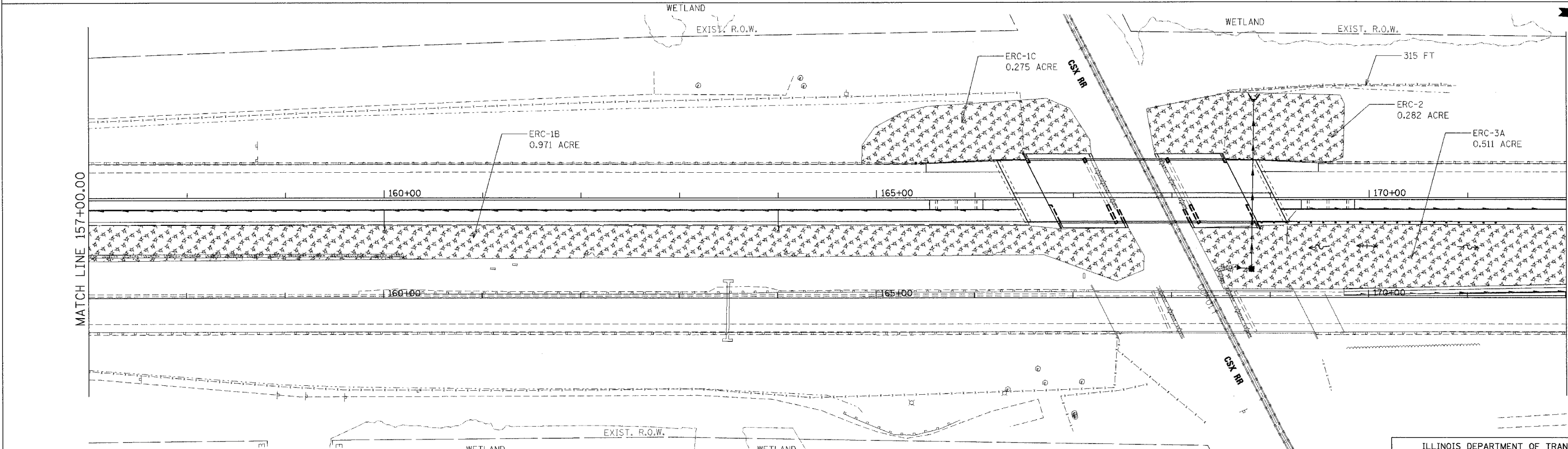
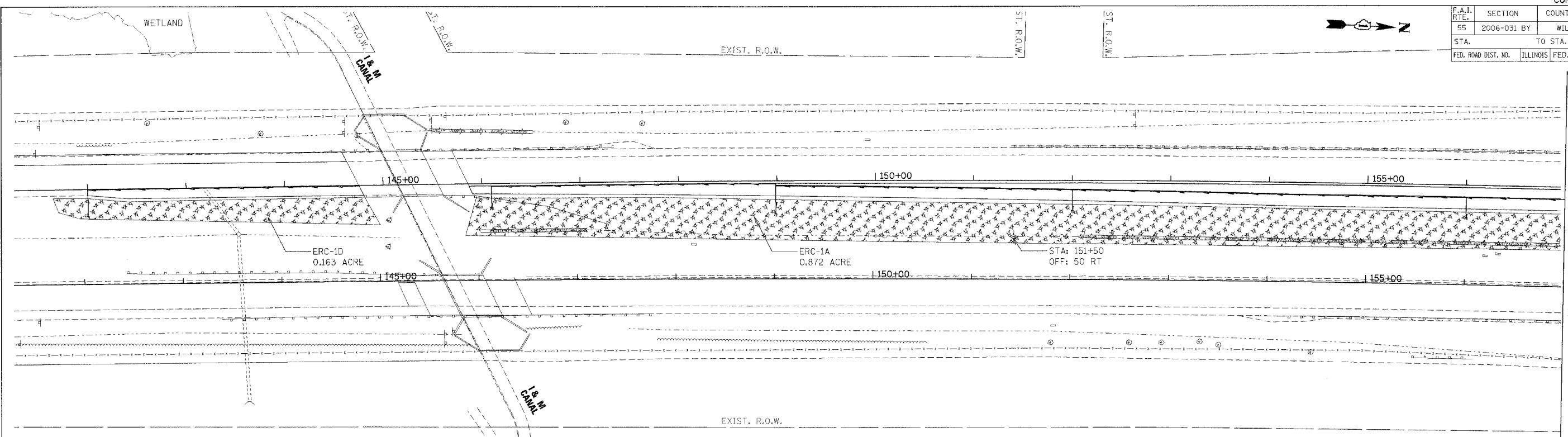
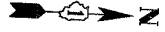

- LEGEND**
- INLET FILTERS
 - TEMPORARY DITCH CHECK
 - TEMPORARY EROSION CONTROL SEEDING AND MULCH METHOD 2
 - RIPRAP CLASS A3 & A4
 - TEMPORARY SILT FENCE

NOTES:

1. FOR PERMANENT STRUCTURE, PERMANENT PIPE, SEDIMENT CONTROL INLET FILTER AND RIPRAP INFORMATION, SEE DRAINAGE SCHEDULES I AND II.



DATE 06/22/2006
EXP. 11/30/2007

MORCOM, N.V., INC.
CONSULTING ENGINEERS
CHICAGO, ILLINOIS

REVISIONS	
NAME	DATE

ILLINOIS DEPARTMENT OF TRANSPORTATION
FAI ROUTE 55 (OVER CSX RR AND SUNNYLAND DRAIN)
BRIDGE WIDENING

**EROSION AND SEDIMENT CONTROL
FAI 55
STA. 141+25.00 TO STA. 172+00.00**

SCALE: 1"=50'
DATE 07/21/06
DRAWN BY SN
CHECKED BY TKL

TENG
TENG & ASSOCIATES, INC.
ENGINEERS/ARCHITECTS/PLANNERS
CHICAGO, ILLINOIS

PLOT DATE = 07/21/06
 FILE NAME = 07FILE4
 PLOT SCALE = 1"=50'
 USER NAME = 10USER