

F.A.I. RTE.	SECTION	COUNTY	TOTAL SHEETS	SHEET NO.
55	2006-031 BY	WILL.	137	51
STA. TO STA.		TO STA.		
FED. ROAD DIST. NO.		ILLINOIS	FED. AID PROJECT	

MATCH LINE 172+00.00

MATCH LINE 187+00.00

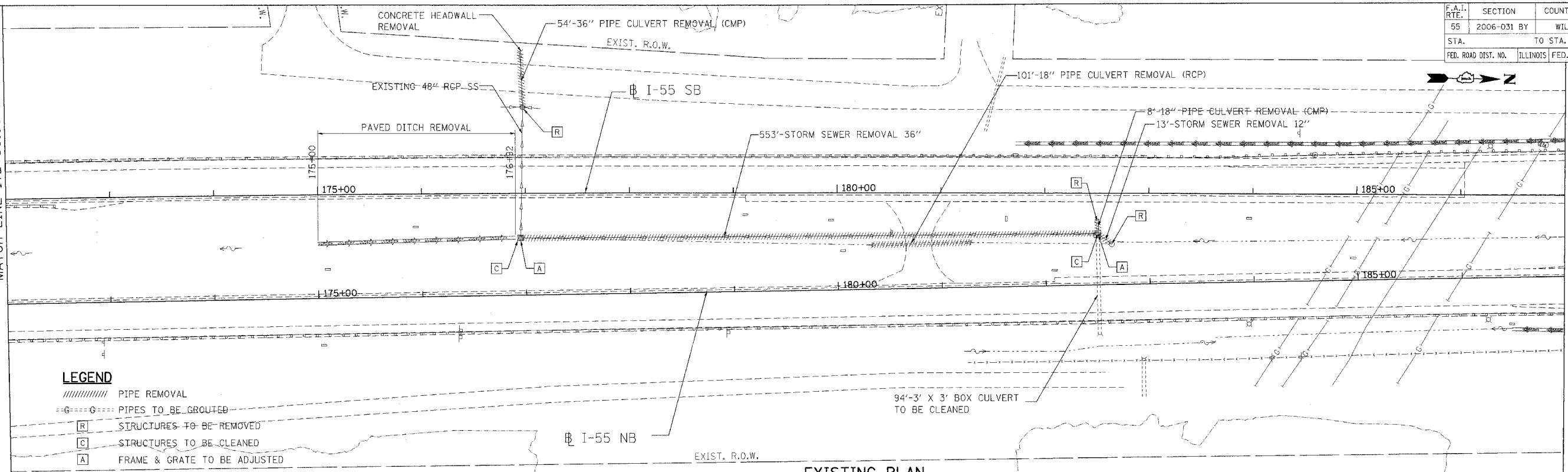

EXISTING PLAN

**LEGEND**

- ////// PIPE REMOVAL
- G- PIPES TO BE GROUTED
- [R] STRUCTURES TO BE REMOVED
- [C] STRUCTURES TO BE CLEANED
- [A] FRAME & GRATE TO BE ADJUSTED

MATCH LINE 172+00.00

MATCH LINE 187+00.00

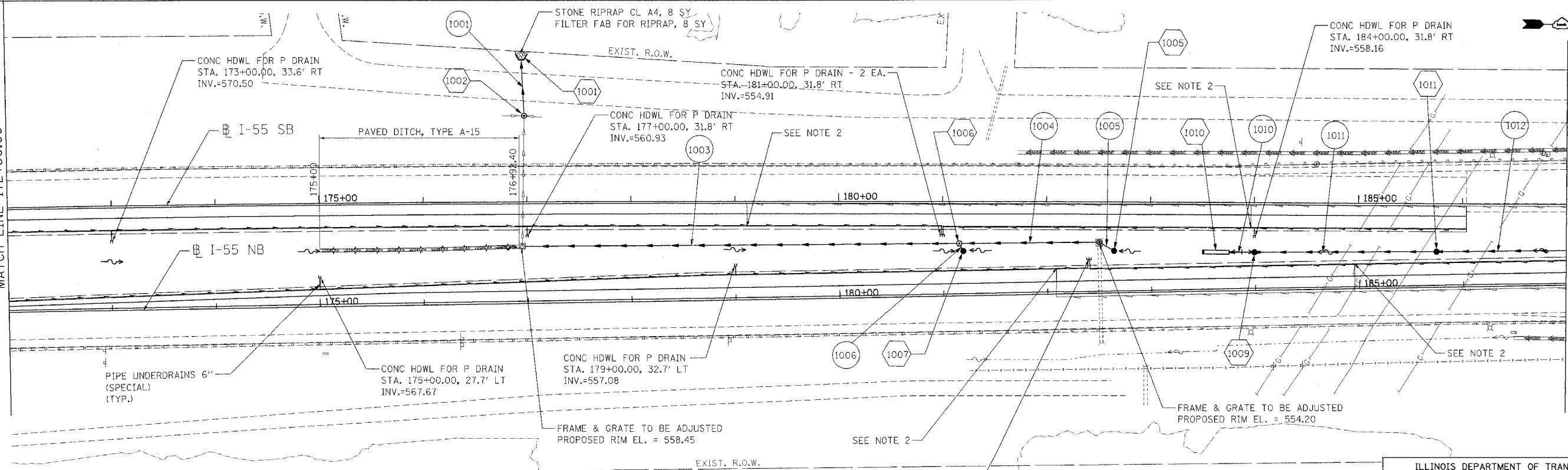

PROPOSED PLAN

**LEGEND**

- 1001 STRUCTURE NUMBER
- GR GRATING FOR STRUCTURE
- 1001 PIPE NUMBER
- STORM SEWER
- PROPOSED DITCH
- CATCH BASIN
- MANHOLE
- ▲ FLARED END SECTION
- HEADWALL
- PIPE UNDERDRAINS
- HEADWALL FOR PIPE UNDERDRAIN

**NOTES**

1. FOR STRUCTURE AND PIPE INFORMATION, SEE DRAINAGE SCHEDULES, SHEETS 53, 54.
2. "CONNECT EXISTING PIPE UNDERDRAIN 6" TO PROPOSED PIPE UNDERDRAINS 6". THE COST FOR MAKING THE CONNECTIONS USING APPROVED FITTINGS IS TO BE INCLUDED IN THE COST OF PIPE UNDERDRAINS 6" (SPECIAL), (TYPICAL).

REVISIONS	
NAME	DATE

ILLINOIS DEPARTMENT OF TRANSPORTATION  
 FAI ROUTE 55 (OVER CSX RR AND SUNNYLAND DRAIN)  
 BRIDGE WIDENING

**DRAINAGE AND UTILITY PLAN**  
**FAI 55**  
**STA. 172+00.00 TO STA. 187+00.00**

SCALE: 1"=50'  
 DATE 07/21/06  
 DRAWN BY MRK  
 CHECKED BY TKL

**TENG**  
 TENG & ASSOCIATES, INC.  
 ENGINEERS/ARCHITECTS/PLANNERS  
 CHICAGO, ILLINOIS

PLOT DATE = 08/07/06  
 FILE NAME = 081114  
 PLOT SCALE = 1"=50'  
 USER NAME = USER8