

F.A. RTE.	SECTION	COUNTY	TOTAL SHEETS	SHEET NO.
55	2006-032 BY	WILL	505	28
STA.	577+00	TO STA.	607+00	
FED. ROAD DIST. NO. 1	ILLINOIS	FED. AID PROJECT	ALIGN-03 OF 16	

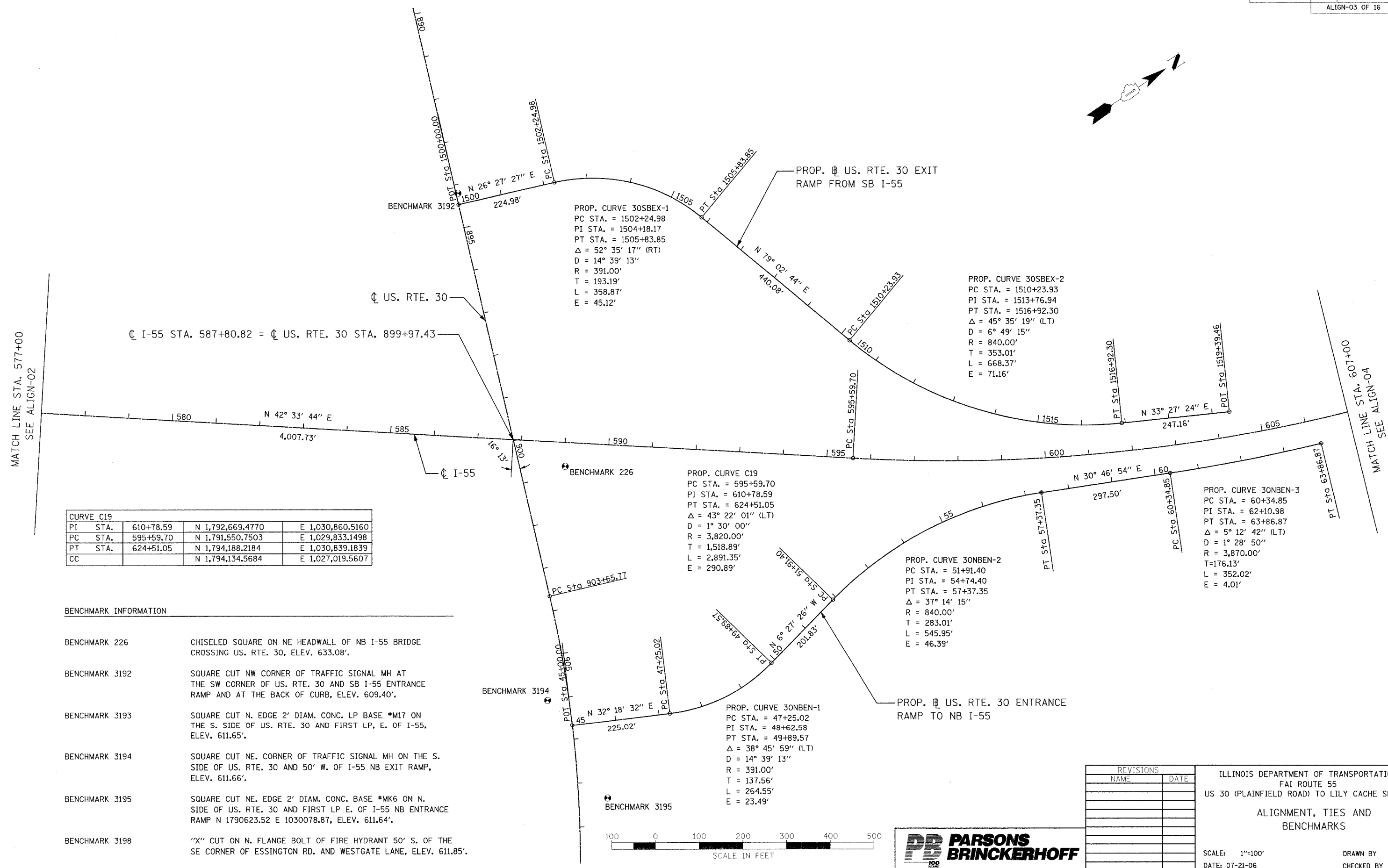

CURVE C19			
PI STA.	610+78.59	N 1,792,669.4770	E 1,030,860.5160
PC STA.	595+59.70	N 1,791,550.7503	E 1,029,833.1498
PT STA.	624+51.05	N 1,794,188.2184	E 1,030,839.1839
CC		N 1,794,134.5684	E 1,027,019.5607

BENCHMARK INFORMATION	
BENCHMARK 226	CHISELED SQUARE ON NE HEADWALL OF NB I-55 BRIDGE CROSSING US. RTE. 30, ELEV. 633.08'.
BENCHMARK 3192	SQUARE CUT NW CORNER OF TRAFFIC SIGNAL MH AT THE SW CORNER OF US. RTE. 30 AND SB I-55 ENTRANCE RAMP AND AT THE BACK OF CURB, ELEV. 609.40'.
BENCHMARK 3193	SQUARE CUT N. EDGE 2' DIAM. CONC. LP BASE *M17 ON THE S. SIDE OF US. RTE. 30 AND FIRST LP, E. OF I-55, ELEV. 611.65'.
BENCHMARK 3194	SQUARE CUT NE. CORNER OF TRAFFIC SIGNAL MH ON THE S. SIDE OF US. RTE. 30 AND 50' W. OF I-55 NB EXIT RAMP, ELEV. 611.66'.
BENCHMARK 3195	SQUARE CUT NE. EDGE 2' DIAM. CONC. BASE *MK6 ON N. SIDE OF US. RTE. 30 AND FIRST LP E. OF I-55 NB ENTRANCE RAMP N 1790623.52 E 1030078.87, ELEV. 611.64'.
BENCHMARK 3198	"X" CUT ON N. FLANGE BOLT OF FIRE HYDRANT 50' S. OF THE SE CORNER OF ESSINGTON RD. AND WESTGATE LANE, ELEV. 611.85'.

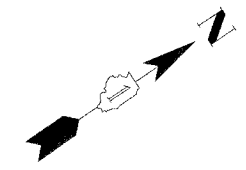
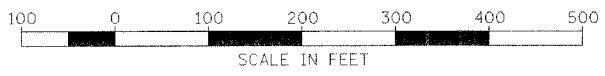

REVISIONS	
NAME	DATE

ILLINOIS DEPARTMENT OF TRANSPORTATION
 I-55 ROUTE 55
 US 30 (PLAINFIELD ROAD) TO LILY CACHE SLOUGH
 ALIGNMENT, TIES AND BENCHMARKS

SCALE: 1"=100'
 DATE: 07-21-06

DRAWN BY: ALR
 CHECKED BY: RH