

F.A. RTE.	SECTION	COUNTY	TOTAL SHEETS	SHEET NO.
55	2006-032 BY	WILL	505	37
STA. 847+00		TO STA. 877+00		
FED. ROAD DIST. NO.		ILLINOIS FED. AID PROJECT		
ALIGN-12 OF 16				

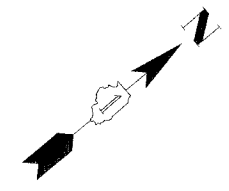

MATCH LINE STA. 847+00
SEE ALIGN-11

MATCHLINE STA. 877+00
SEE ALIGN-13

PROP. CURVE C22
 PC STA. = 868+86.37
 PI STA. = 876+59.44
 PT STA. = 884+30.18
 $\Delta = 7^\circ 41' 30''$ (RT)
 $D = 0^\circ 29' 54''$
 $R = 11,500.00'$
 $T = 773.07'$
 $L = 1,543.82'$
 $E = 25.95'$

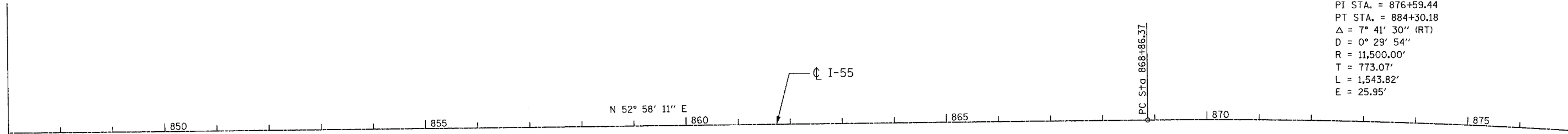

CURVE C22				
PI	STA.	876+59.44	N 1,815,725.0390	E 1,038,683.3400
PC	STA.	868+86.37	N 1,815,259.4686	E 1,038,066.1831
PT	STA.	884+30.18	N 1,816,103.8189	E 1,039,357.2571
CC			N 1,806,078.8034	E 1,044,991.8879

BENCHMARK DESCRIPTIONS

- BENCHMARK 215 SET REBAR +/- 2' NW OF EXISTING FENCE LINE, ELEV. 623.10'.
- BENCHMARK 216 SET REBAR +/- 5' SE OF EXISTING PAVEMENT, ELEV. 643.31'.
- BENCHMARK 225 SET REBAR +/- 2' NW OF EXISTING FENCE LINE, ELEV. 618.72'.

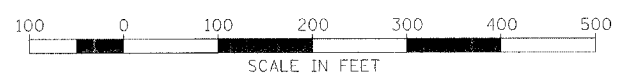

REVISIONS	
NAME	DATE

ILLINOIS DEPARTMENT OF TRANSPORTATION
 FAI ROUTE 55
 US 30 (PLAINFIELD ROAD) TO LILY CACHE SLOUGH
ALIGNMENT, TIES AND BENCHMARKS
 SCALE: 1"=100'
 DATE: 06-30-06
 DRAWN BY: ALR
 CHECKED BY: RH