

CONTRACT NO. 60B86

F.A.I. RTE.	SECTION	COUNTY	TOTAL SHEETS	SHEET NO.
55	2006-032 BY	WILL	505	54
STA.	TO STA.			
FED. ROAD DIST. NO.	ILLINOIS	FED. AID PROJECT		

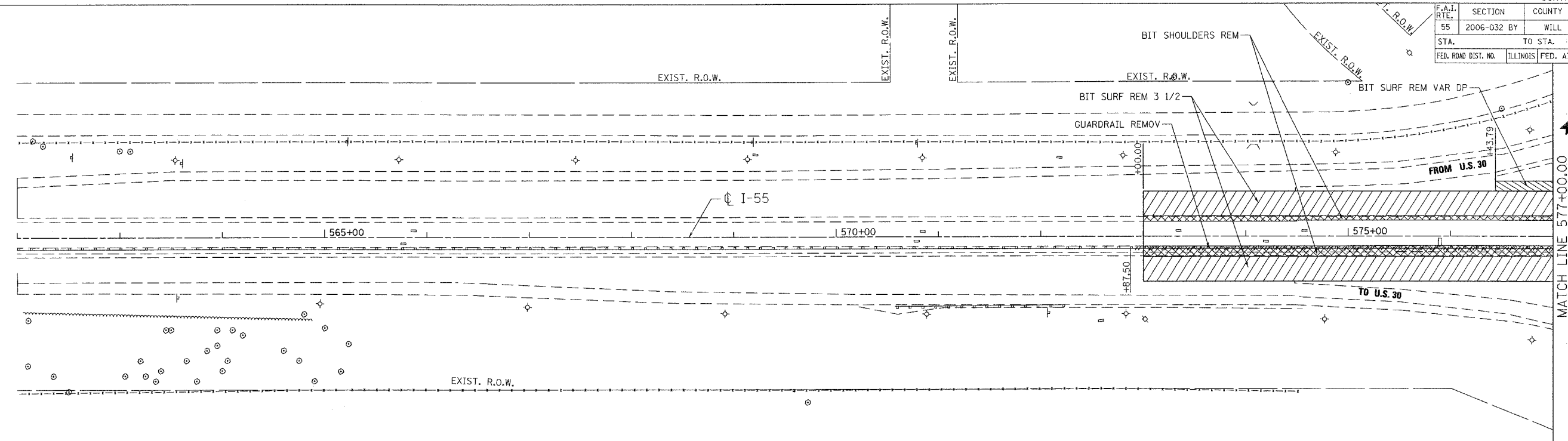

EXISTING PLAN

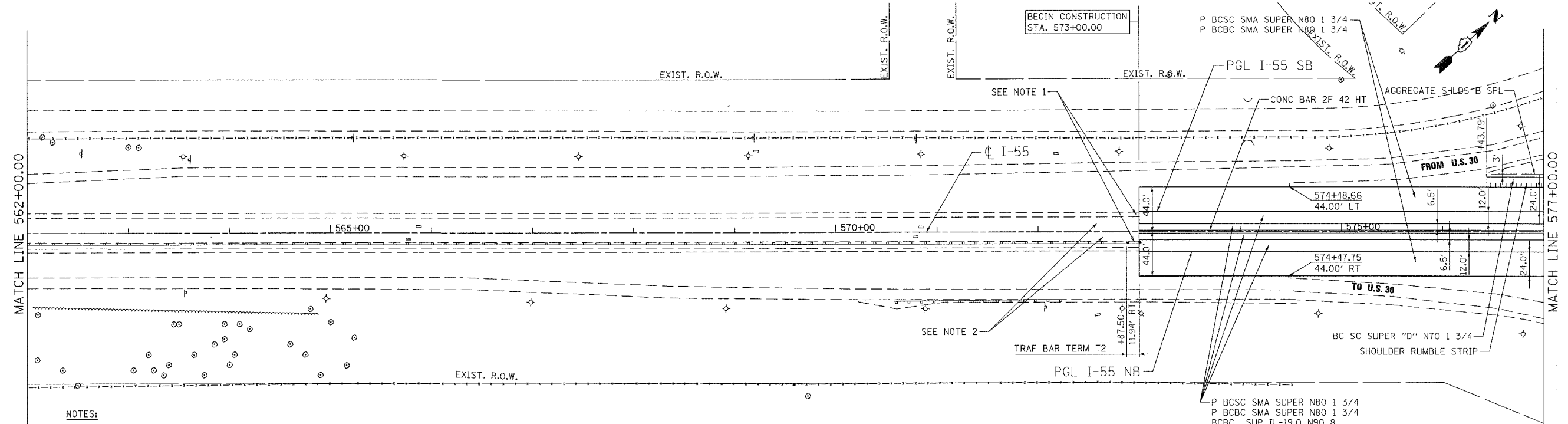

NOTES:

1. THE CONTRACTOR SHALL PLACE BITUMINOUS MATERIAL MEETING THE APPROVAL OF THE ENGINEER ON THE EXISTING SHOULDER TO TRANSITION FROM THE CROSS SLOPE OF THE PROPOSED PAVEMENT TO THE CROSS SLOPE OF THE EXISTING SHOULDER. THE COST OF THIS WORK SHALL BE INCLUDED IN THE CONTRACT UNIT PRICE FOR P BCSC SUPER "F" N90 1 3/4.
2. GRADE MEDIAN TO MATCH PROPOSED PAVEMENT, SHOULDERS, AND DRAINAGE STRUCTURES USING MAXIMUM LONGITUDINAL SLOPES OF 10:1 AND AS DIRECTED BY THE ENGINEER. SEE ALSO DRAINAGE AND UTILITY PLANS AND LANDSCAPING DETAILS.

PROPOSED PLAN

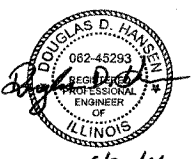

DATE 6/22/06
 EXP. 11/30/07

REVISIONS	NAME	DATE
6F		7/26/06

ILLINOIS DEPARTMENT OF TRANSPORTATION
 FAI ROUTE 55
 US 30 (PLAINFIELD ROAD) TO LILY CACHE SLOUGH

ROADWAY PLAN
FAI 55
STA. 562+00.00 TO STA. 577+00.00

SCALE: 1"=50'
 DATE 07/21/06
 DRAWN BY AG
 CHECKED BY DDH
TENG TENG & ASSOCIATES, INC.
 ENGINEERS/ARCHITECTS/PLANNERS
 CHICAGO, ILLINOIS

PLOT DATE = 07/21/06
 PLOT SCALE = 1"=50'
 USER NAME = USER
 \\A:\91408101\DRAWING\PROJECTS\062-45293\062-45293_SHT_54.dwg
 \\A:\91408101\DRAWING\PROJECTS\062-45293\062-45293_SHT_54.dwg
 \\A:\91408101\DRAWING\PROJECTS\062-45293\062-45293_SHT_54.dwg
 \\A:\91408101\DRAWING\PROJECTS\062-45293\062-45293_SHT_54.dwg