

F.A.P. RTE.	SECTION	COUNTY	TOTAL SHEETS	SHEET NO.
55	2006-032 BY	WILL	505	64
STA. 757+00		TO STA. 772+00		
FED. ROAD DIST. NO. 1		ILLINOIS FED. AID PROJECT		PLN-09 OF 11

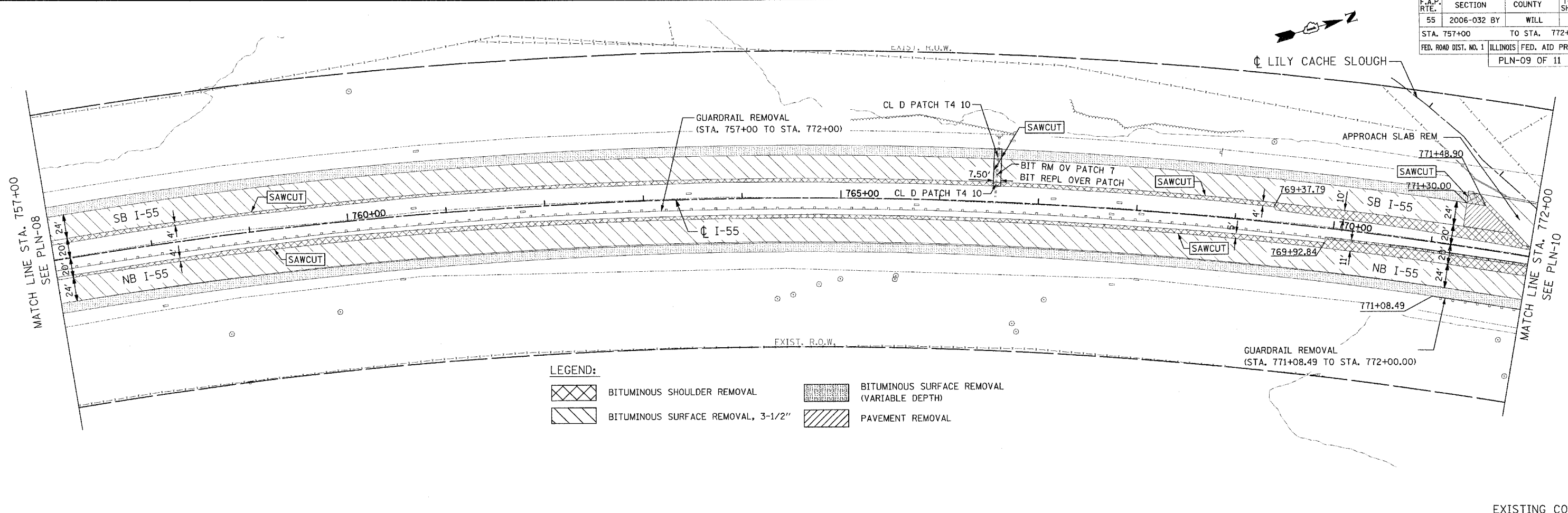

LEGEND:

	BITUMINOUS SHOULDER REMOVAL		BITUMINOUS SURFACE REMOVAL (VARIABLE DEPTH)
	BITUMINOUS SURFACE REMOVAL, 3-1/2"		PAVEMENT REMOVAL

EXISTING CONDITION

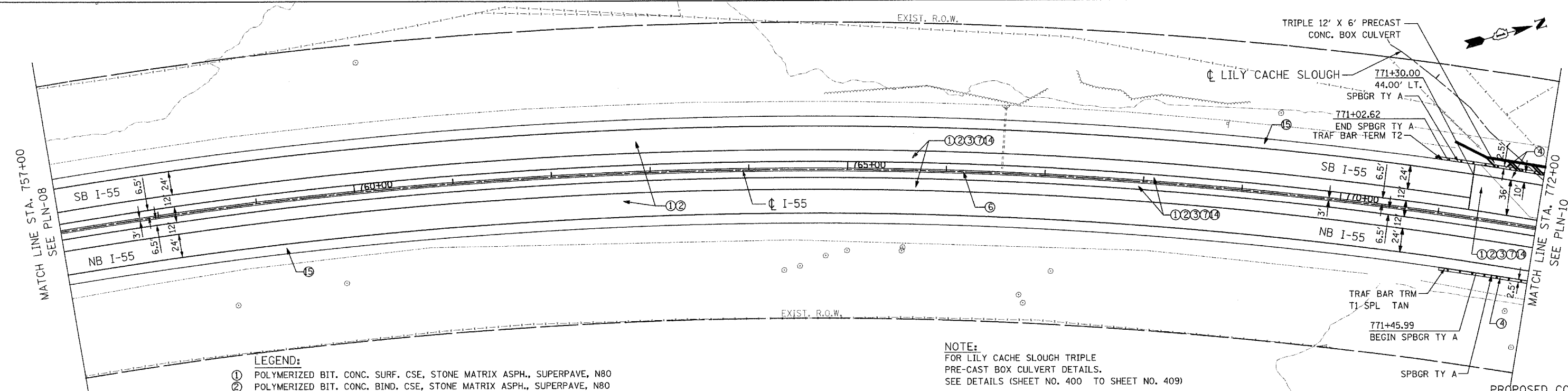

- LEGEND:**
- ① POLYMERIZED BIT. CONC. SURF. CSE, STONE MATRIX ASPH., SUPERPAVE, N80
 - ② POLYMERIZED BIT. CONC. BIND. CSE, STONE MATRIX ASPH., SUPERPAVE, N80
 - ③ BITUMINOUS CONCRETE BINDER COURSE, SUPERPAVE, IL-19, N90
 - ④ BITUMINOUS CONCRETE BINDER COURSE, SUPERPAVE, IL-19, N70
 - ⑤ P.C.C. BASE COURSE, 10-1/2"
 - ⑥ CONCRETE BARRIER DOUBLE FACE, 42" HEIGHT
 - ⑦ AGGREGATE SUBGRADE, 12"
 - ⑧ SUB-BASE GRANULAR MATERIAL, TYPE B, 6"
 - ⑨ BITUMINOUS BASE COURSE, SUPERPAVE, N50, 2-1/2"
 - ⑩ BITUMINOUS CONCRETE SURFACE COURSE, SUPERPAVE, MIX "D", N70

NOTE:
 FOR LILY CACHE SLOUGH TRIPLE PRE-CAST BOX CULVERT DETAILS. SEE DETAILS (SHEET NO. 400 TO SHEET NO. 409)

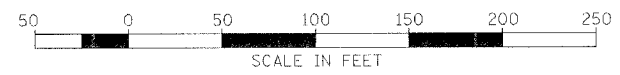

REVISIONS	
NAME	DATE
M. HALDEMAN	07/28/06

ILLINOIS DEPARTMENT OF TRANSPORTATION
 FAI ROUTE 55
 US 30 (PLAINFIELD ROAD) TO LILY CACHE SLOUGH
 EXISTING AND PROPOSED
 ROADWAY PLAN

SCALE: 1" = 50'
 DATE: 07-21-06
 DRAWN BY: ALR
 CHECKED BY: RH

FINAL