

F.A. RTE.	SECTION	COUNTY	TOTAL SHEETS	SHEET NO.
55	2006-032 BY	WILL	505	80
STA. 607+00	TO STA. 622+00	ILLINOIS	FED. AID PROJECT	

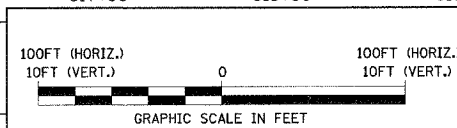
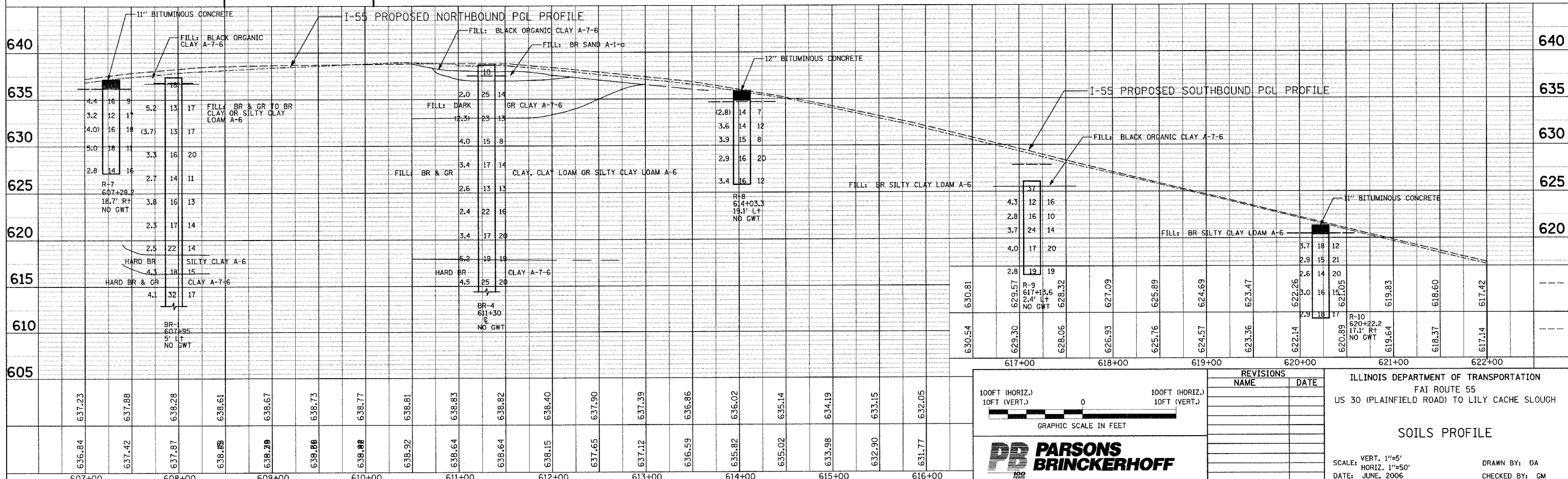
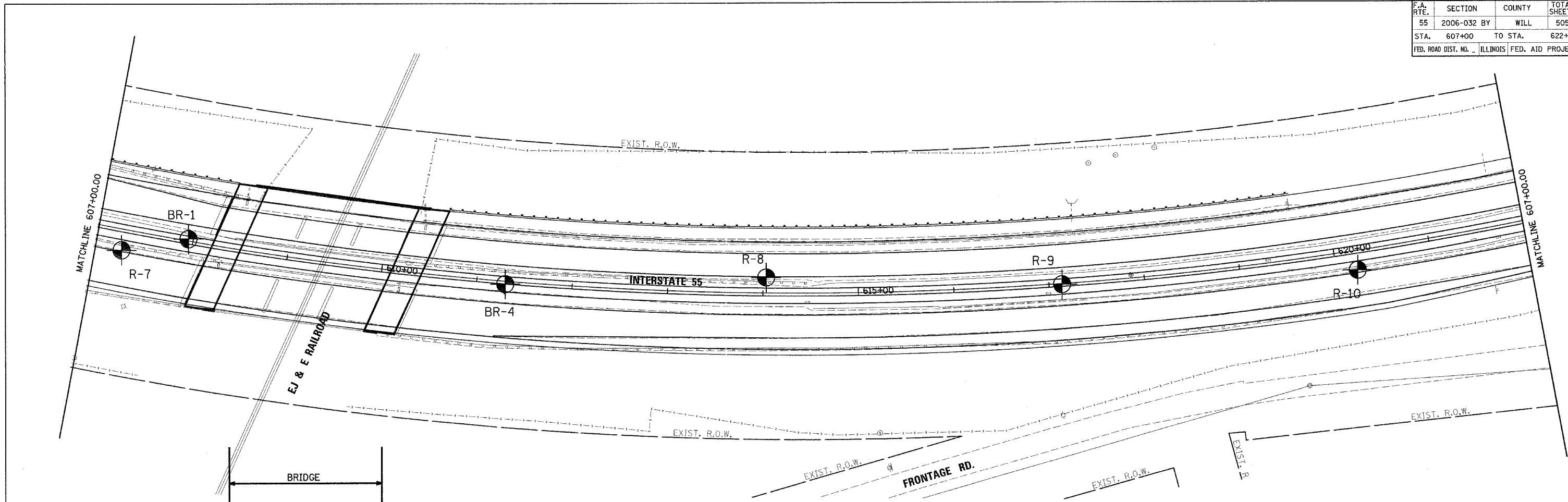

REVISIONS	
NAME	DATE

ILLINOIS DEPARTMENT OF TRANSPORTATION
 FAI ROUTE 55
 US 30 (PLAINFIELD ROAD) TO LILY CACHE SLOUGH

SOILS PROFILE

SCALE: VERT. 1"=5'
 HORIZ. 1"=50'
 DATE: JUNE, 2006

DRAWN BY: DA
 CHECKED BY: GM