

F.A. RTE.	SECTION	COUNTY	TOTAL SHEETS	SHEET NO.
55	2006-032 BY	WILL	505	91
STA. 772+00	TO STA. 787+00			
FED. ROAD DIST. NO. ILLINOIS FED. AID PROJECT				

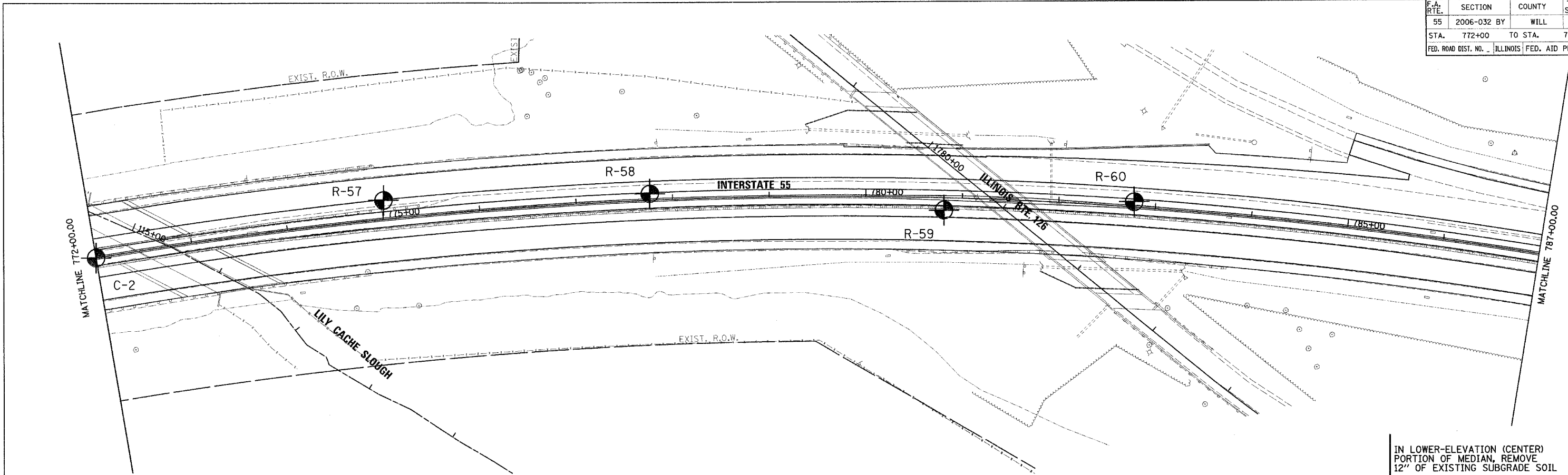

IN LOWER-ELEVATION (CENTER) PORTION OF MEDIAN, REMOVE 12" OF EXISTING SUBGRADE SOIL AND REPLACE WITH PGES TO BRIDGE UNDERLYING UNSTABLE SOILS

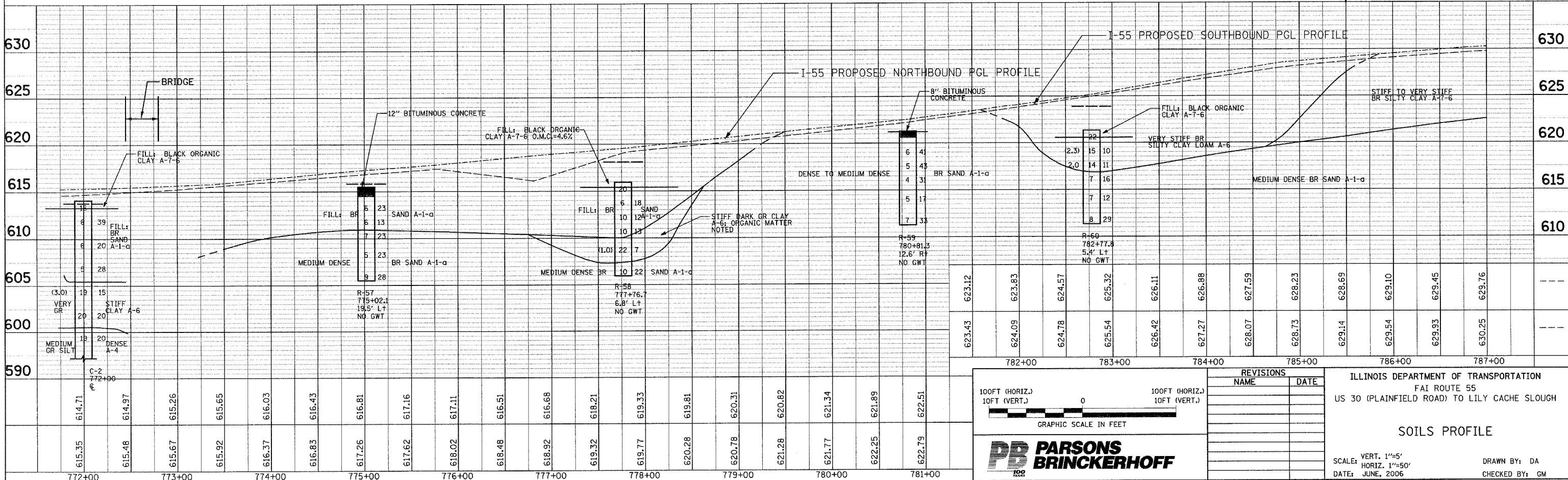

100FT (HORIZ.)
10FT (VERT.)

0

100FT (HORIZ.)
10FT (VERT.)

GRAPHIC SCALE IN FEET

PB PARSONS BRINCKERHOFF

REVISIONS	
NAME	DATE

ILLINOIS DEPARTMENT OF TRANSPORTATION
FAI ROUTE 55
US 30 (PLAINFIELD ROAD) TO LILY CACHE SLOUGH

SOILS PROFILE

SCALE: VERT. 1"=5'
HORIZ. 1"=50'
DATE: JUNE, 2006

DRAWN BY: DA
CHECKED BY: GM