

F.A.P. RTE.	SECTION	COUNTY	TOTAL SHEETS	SHEET NO.
55	2006-032 BY	WILL.	505	118
STA. 787+00		TO STA. 817+00		
FED. ROAD DIST. NO.		ILLINOIS FED. AID PROJECT		
MOTI-08 OF 08				

LEGEND

(A)(B)(C) SEE IDOT STANDARD 701400

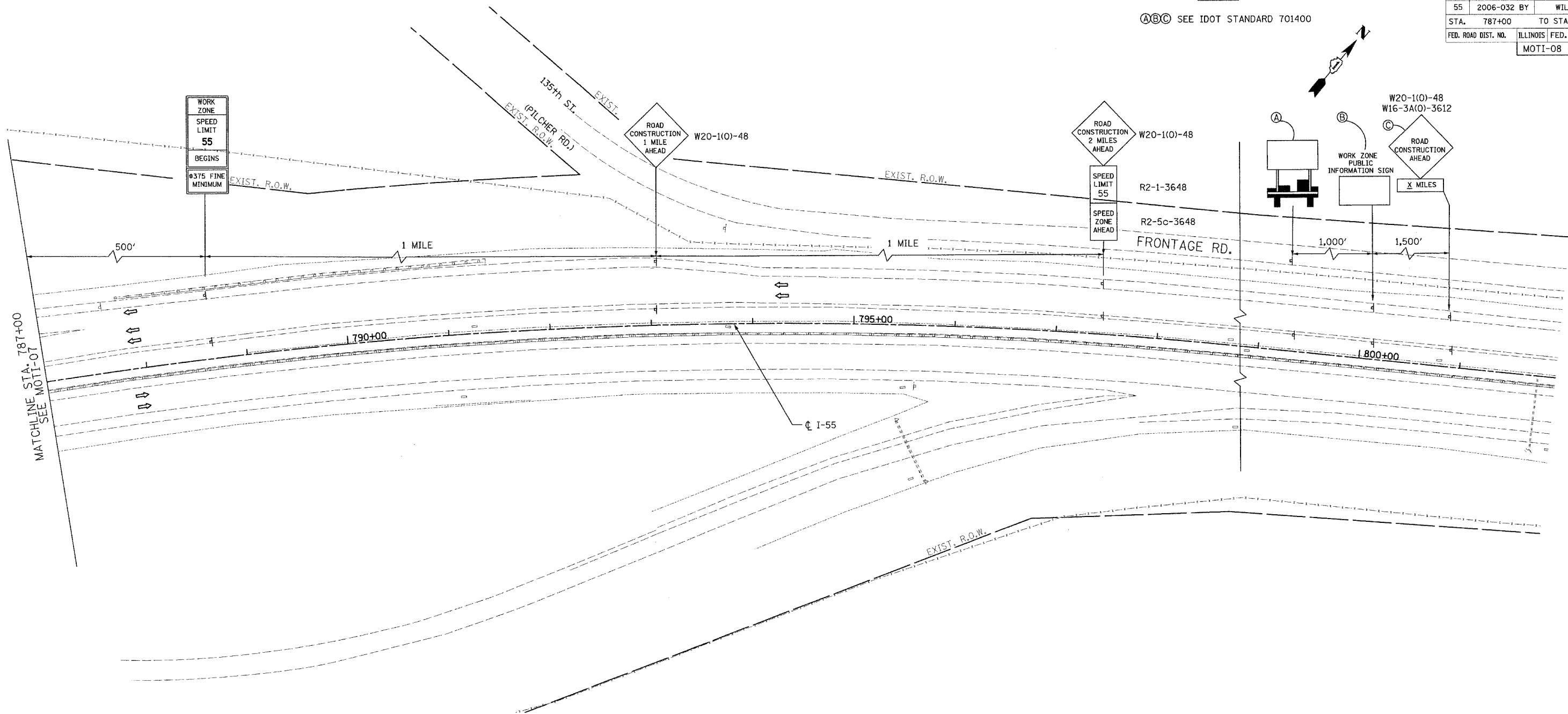

WORK ZONE
SPEED LIMIT
55
BEGINS
§375 FINE
MINIMUM

ROAD CONSTRUCTION
2 MILES
AHEAD
W20-1(O)-48
R2-1-3648
SPEED LIMIT
55
SPEED ZONE
AHEAD
R2-5c-3648

W20-1(O)-48
W16-3A(O)-3612

WORK ZONE
PUBLIC
INFORMATION SIGN

ROAD CONSTRUCTION
AHEAD
X MILES

MATCHLINE STA. 787+00
SEE MOTI-07

STAGE I

REVISIONS	
NAME	DATE

ILLINOIS DEPARTMENT OF TRANSPORTATION
FAI ROUTE 55
US 30 (PLAINFIELD ROAD) TO LILY CACHE SLOUGH
SUGGESTED STAGES OF CONSTRUCTION
AND TRAFFIC CONTROL
SCALE: 1" = 50'
DATE: 06-30-06
DRAWN BY: TJR
CHECKED BY: DM

