

F.A.I. RTE.	SECTION	COUNTY	TOTAL SHEETS	SHEET NO.
55	2006-032 BY	WILL	505	163
STA.		TO STA.		
FED. ROAD DIST. NO.		ILLINOIS	FED. AID PROJECT	

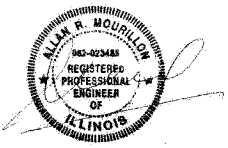
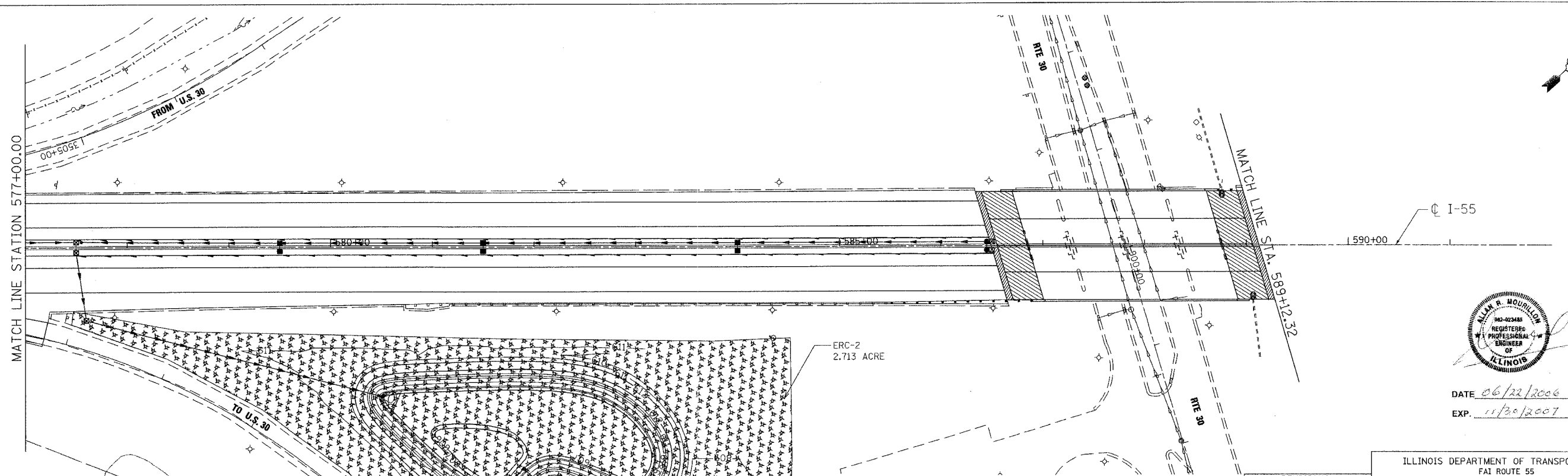
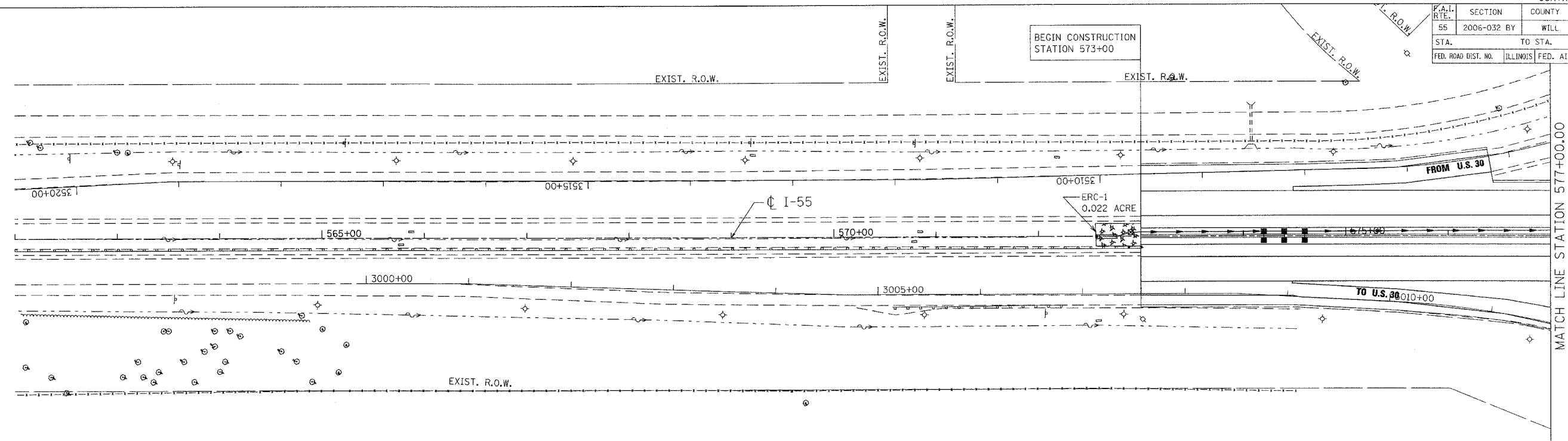

DATE 06/22/2006
 EXP. 11/30/2007

- LEGEND**
- ◆ INLET FILTERS
 - ◊ TEMPORARY DITCH CHECK
 - ▨ TEMPORARY EROSION CONTROL SEEDING AND MULCH METHOD 2
 - TEMPORARY SILT FENCE

NOTES:

1. FOR PERMANENT STRUCTURE, PERMANENT PIPE, SEDIMENT CONTROL INLET FILTER AND RIPRAP INFORMATION, SEE DRAINAGE SCHEDULES.
2. FOR ERC-2 DISTURBED AREA SEE EROSION AND SEDIMENT CONTROL, DETENTION BASIN. THE ACREAGE FOR ERC-2 (AS LISTED HERE) REPRESENTS THE WHOLE DISTURBED AREA.

REVISIONS	
NAME	DATE

MORCOM, N.V., INC.
 CONSULTING ENGINEERS
 CHICAGO, ILLINOIS

ILLINOIS DEPARTMENT OF TRANSPORTATION
 FAI ROUTE 55
 US 30 (PLAINFIELD ROAD) TO LILY CACHE SLOUGH
**EROSION AND SEDIMENT CONTROL
 FAI 55
 STA. 562+00.00 TO STA. 589+12.32**

SCALE: 1"=50'
 DATE 07/05/06
TENG
 TENG & ASSOCIATES, INC.
 ENGINEERS/ARCHITECTS/PLANNERS
 CHICAGO, ILLINOIS

DRAWN BY SN
 CHECKED BY TKL

FILE DATE = 06/22/06
 FILE NAME = 062206_150242
 PLOT SCALE = 1/4"=1'-0"
 PLOT NAME = 062206_150242
 USER NAME = AUBERS