

F.A.P. RTE.	SECTION	COUNTY	TOTAL SHEETS	SHEET NO.
55	2006-032 BY	WILL	#TOT#	256
STA. _____		TO STA. _____		
FED. ROAD DIST. NO. _____		ILLINOIS FED. AID PROJECT		
P-XX-XXX-XX				

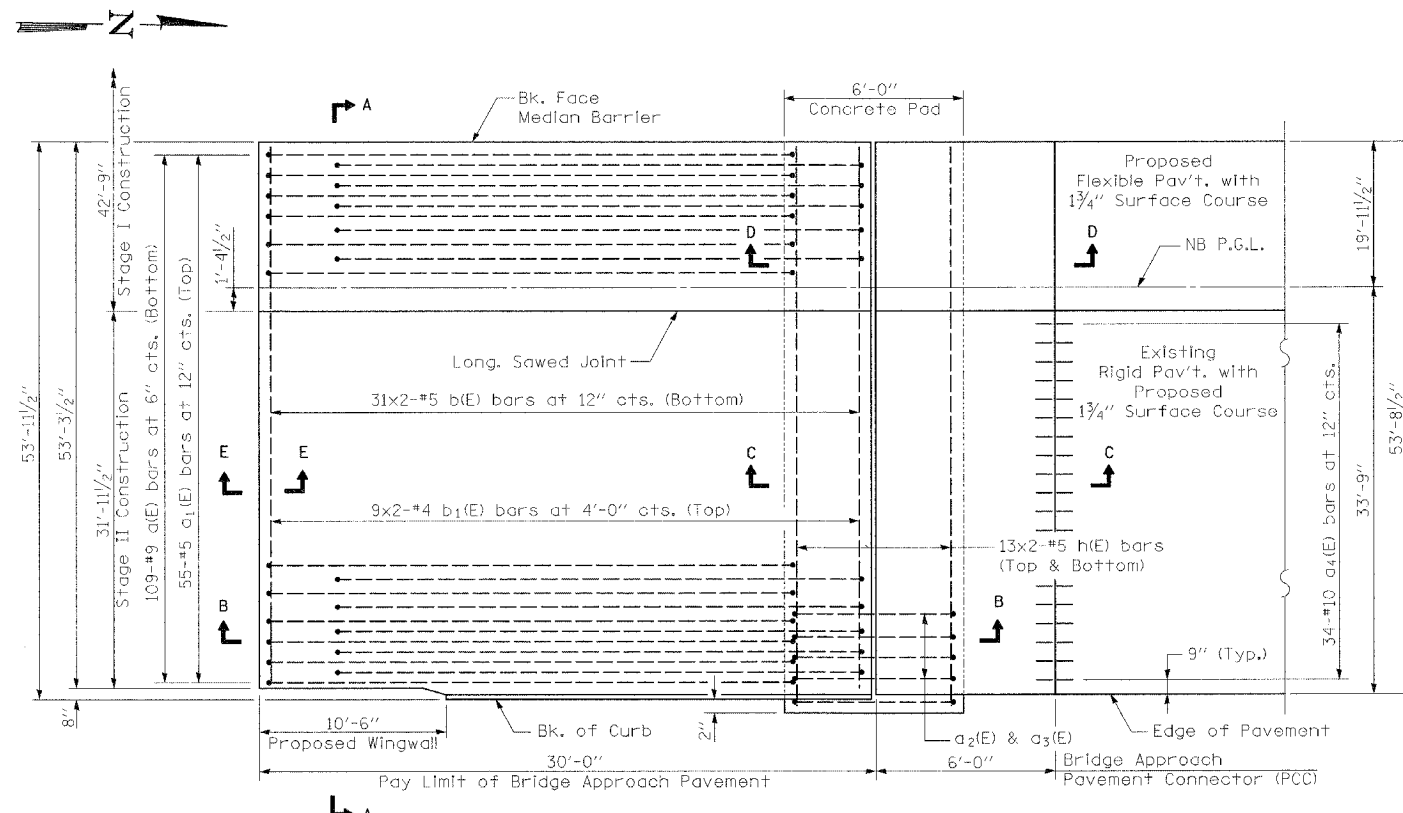

**I-55 OVER MS (ABANDONED) R.R. NB BRIDGE APPROACH PAVEMENT PLAN**  
 (See Section A-A for Dimensions not shown)  
 (North Approach End Shown, South Approach End Similar)

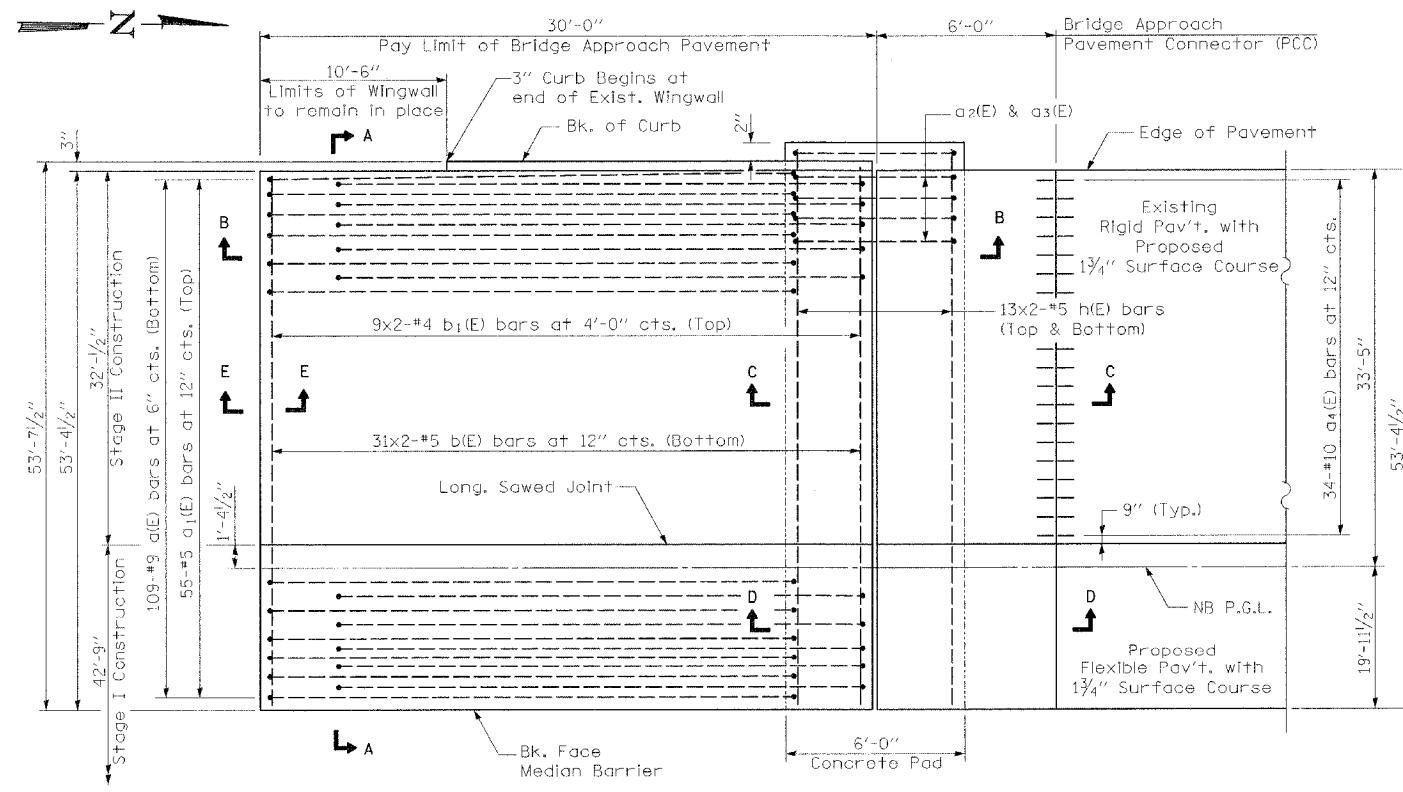

**I-55 OVER MS (ABANDONED) R.R. SB BRIDGE APPROACH PAVEMENT PLAN**  
 (See Section A-A for Dimensions not shown)  
 (North Approach End Shown, South Approach End Similar)

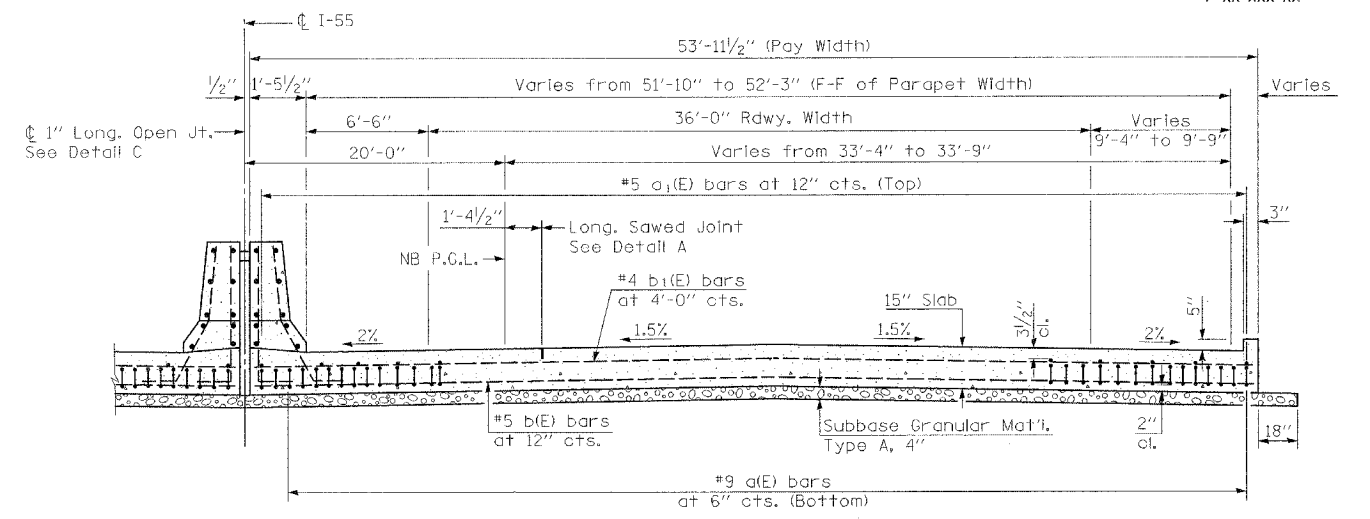

**SECTION A-A - NB BRIDGE APPROACH PAVEMENT**  
 (North Approach End Shown, South Approach End Similar)

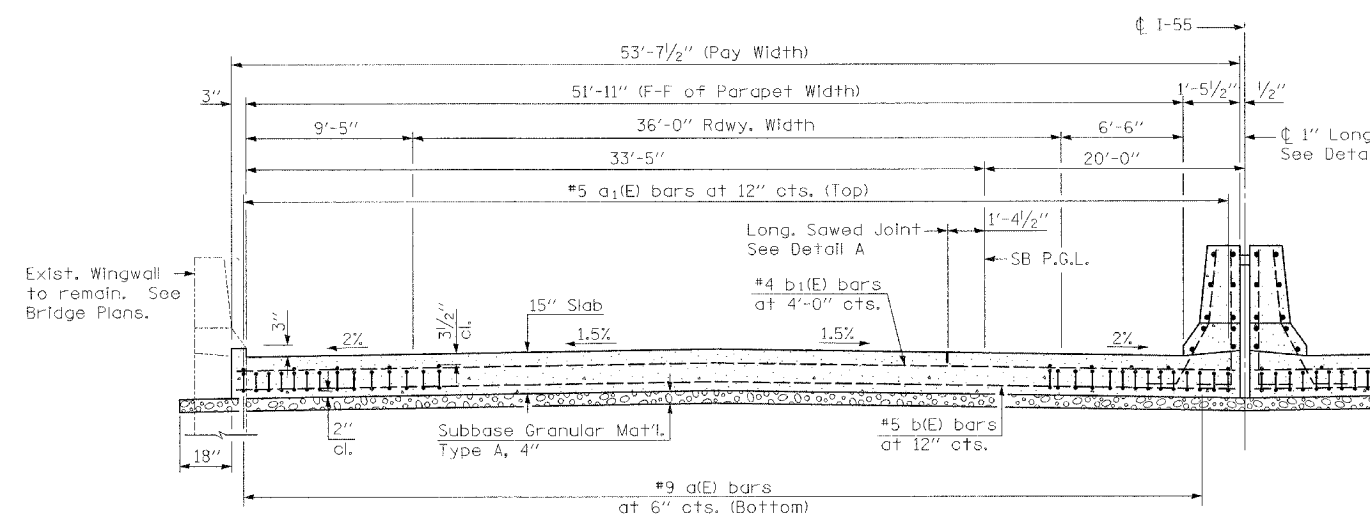

**SECTION A-A - SB BRIDGE APPROACH PAVEMENT**  
 (North Approach End Shown, South Approach End Similar)

**GENERAL NOTES**

- THICKNESS-"t"=Thickness of Pavement.
- For Profiles, see Roadway Plans.
- For Wingwall Details, See Bridge Plans.
- If two or more lane widths are poured at a time, a longitudinal sawed joint may be used at the lane edges. See Detail A.
- Reinforcement Bars designated "(E)" shall be Epoxy Coated.
- Approach Pavement Concrete Median Barriers shall be constructed and paid for in accordance with Sections 503 and 508 of the IDOT Standard Specifications.
- Protective Coat shall be applied to the Top and Traffic Faces of the Median Barriers.

**DESIGN STRESSES**

$f_y = 60,000$  P.S.I.  
 $f'_c = 3,500$  P.S.I.  
 $n = 8.5$

REVISIONS	
NAME	DATE

ILLINOIS DEPARTMENT OF TRANSPORTATION  
 FAI ROUTE 55  
 US 30 (PLAINFIELD ROAD) TO LILY CACHE SLOUGH  
 I-55 OVER MS (ABANDONED) R.R.  
 BRIDGE APPROACH PAVEMENT  
 PLAN & SECTIONS  
 STANDARD 420401 (SPECIAL)  
 SCALE: NONE DRAWN BY SBC  
 DATE: 06-30-06 CHECKED BY JQZ

