

STATE OF ILLINOIS
DEPARTMENT OF TRANSPORTATION

ROUTE NO.	SECTION	COUNTY	TOTAL SHEETS	SHEET NO.	SHEET NO. 6
FAI-55	**	WILL	505	379	16 SHEETS
FED. ROAD DIST. NO. 7	ILLINOIS	FED. AID PROJECT-			

** SECTION 2006-032 BY
CONTRACT NO. 60B86

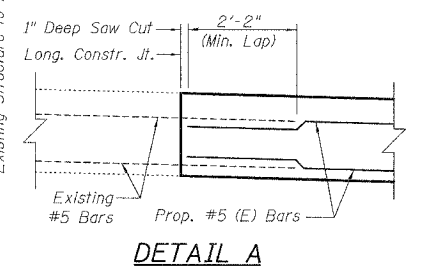
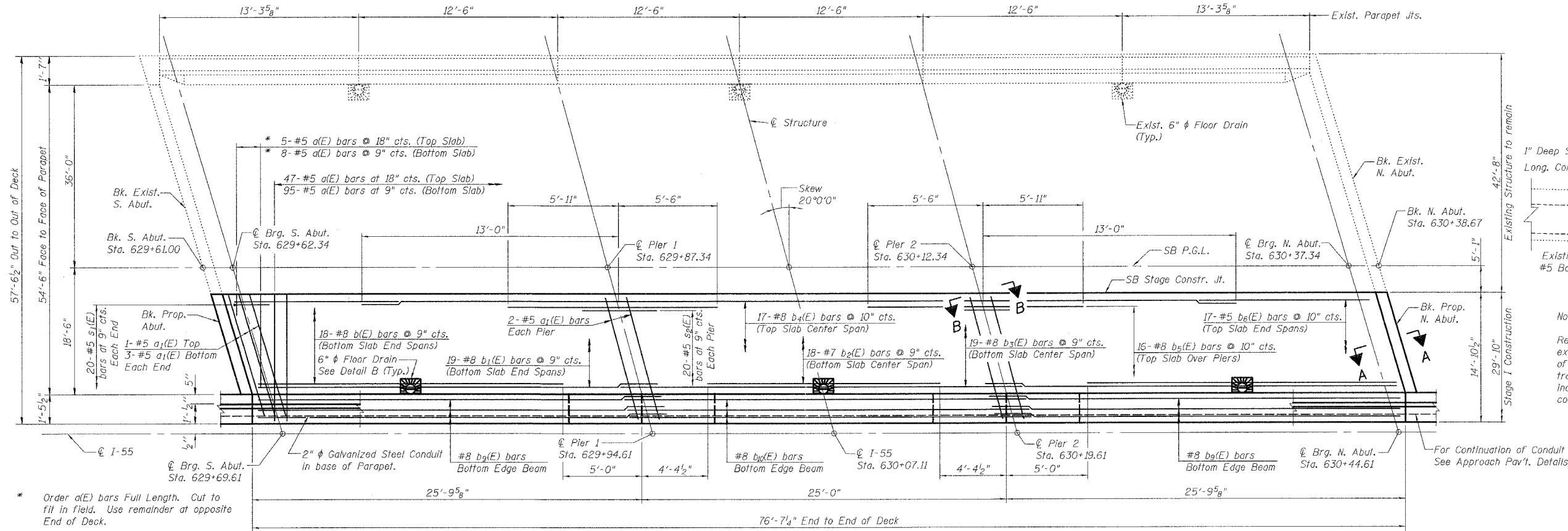

DETAIL A
Note:
Remove existing concrete to expose a minimum of 2'-2" of the existing top and bottom transverse bars which shall be incorporated into the new construction.

SB DECK PLAN

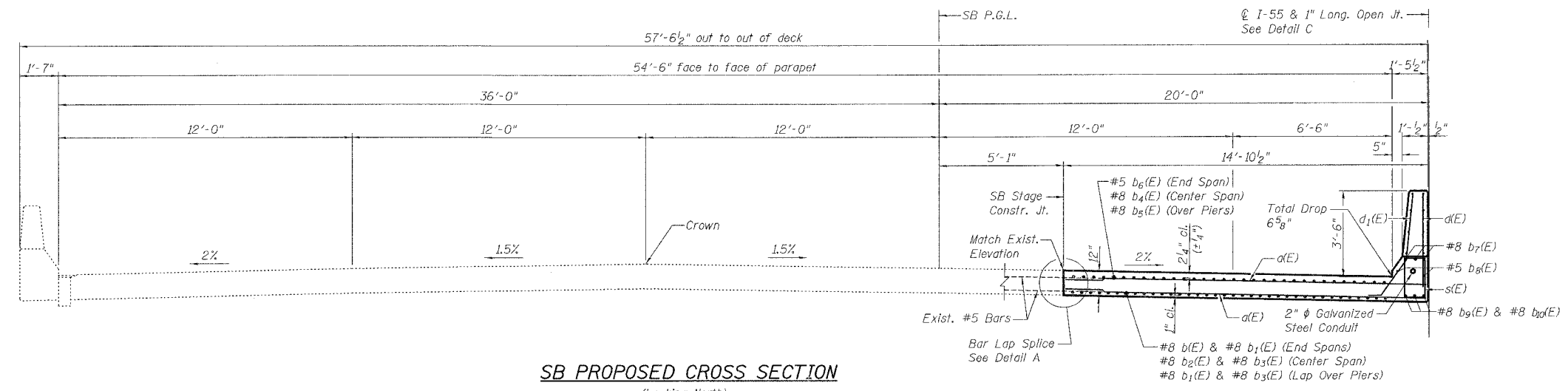

SB PROPOSED CROSS SECTION
(Looking North)

- Notes:
- See Sheet No. 8 for superstructure details, Parapet Reinforcement, and Bill of Material.
 - Reinforcement bars designated (E) shall be epoxy coated.
 - For Section A-A, Section B-B, & Detail C, see Sheet No. 8.
 - See Sheet No. 8 for 6" φ Floor Drain Details.
 - Work this sheet with Sheet Nos. 7 & 8.

DESIGNED	S.CHELBIAN
CHECKED	A.HAMMAD
DRAWN	S.CHELBIAN
CHECKED	J.GRAINAWI

Date: 6/30/2006



SB DECK PLAN AND SECTION
I-55 OVER MINK CREEK
FAI ROUTE 55-SEC. 2006-032 BY
WILL COUNTY
STA. 630+07.11
STRUCTURE NO. 099-4616 (SB)

6/30/2006 3:48:52 PM C:\16817\AS\StructCadd\Pre-Final\MINX CREEK\Final Bridge Contract\092206-09B86-000-000-006.dgn