

FINAL SURVEY SURVEYED BY DATE
 PLOTTED PLotted BY DATE
 NOTE BOOK NO. DATE
 AREAS CHECKED AREAS CHECKED

ORIGINAL SURVEY SURVEYED BY DATE
 PLOTTED PLotted BY DATE
 NOTE BOOK NO. DATE
 AREAS CHECKED AREAS CHECKED

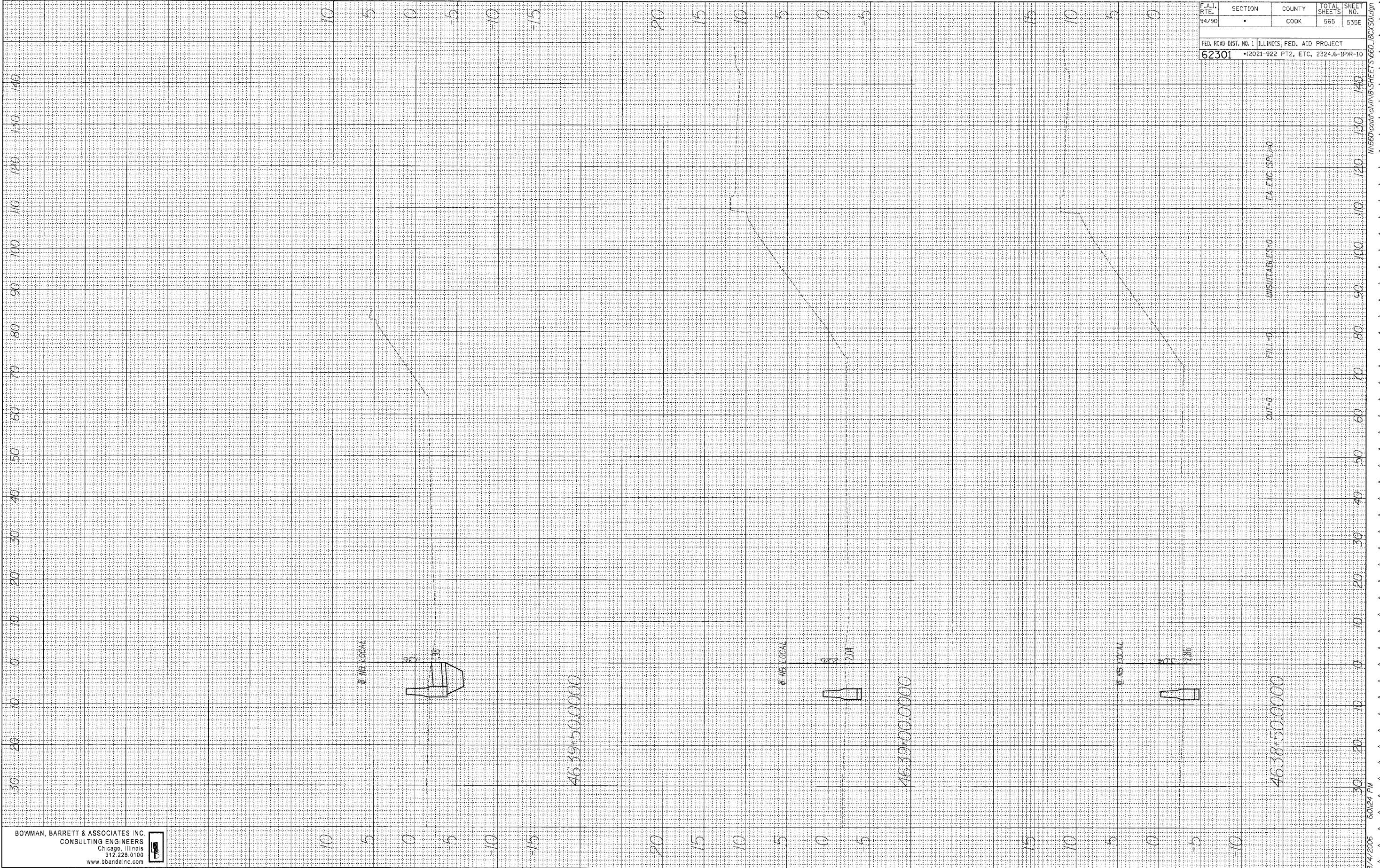

F.A.I. RTE.	SECTION	COUNTY	TOTAL SHEETS	SHEET NO.
94/90	•	COOK	565	535E

FED. ROAD DIST. NO. 1	ILLINOIS FED. AID PROJECT
62301	*I2021-922 PT2, ETC, 2324.6-IPR-10

BOWMAN, BARRETT & ASSOCIATES INC
 CONSULTING ENGINEERS
 Chicago, Illinois
 312.228.0100
 www.bbandainc.com



8/4/2006 6:01:24 PM W:\660\road\CHWING\62301\SHEET5 660_16C\501.dwg