

F.A.I. RTE.	SECTION	COUNTY	TOTAL SHEETS	SHEET NO.
90/94		COOK	588	361
STA.	TO STA.			
FED. ROAD DIST. NO. 1	ILLINOIS	FED. AID PROJECT		
62303	(2021-922 PT2 ETC 2324.6-1P) R-11			

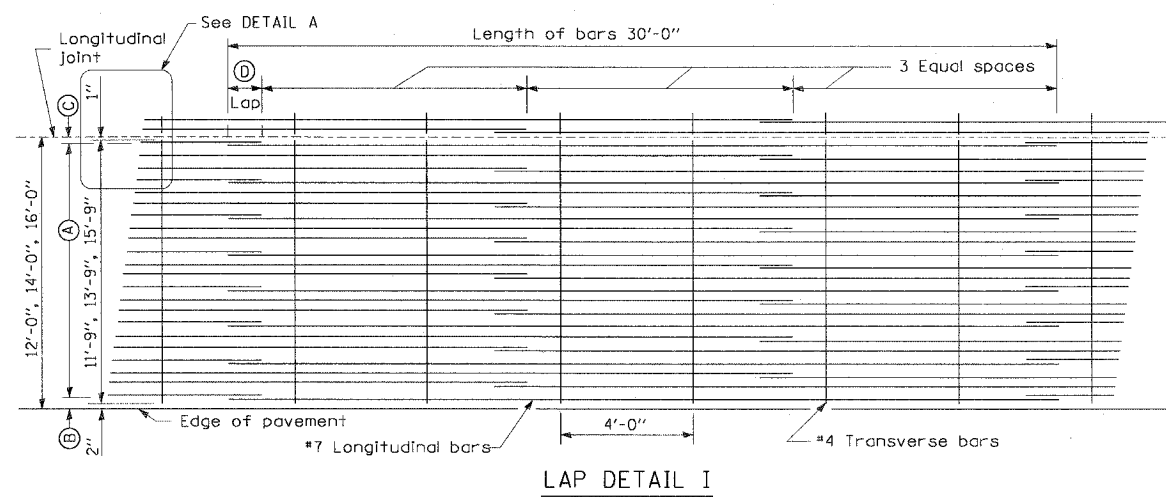

Pavement Width	Bar Size	Pavement Thickness	(A) (Approx. Spacing)	(B)	(C)	(D)
12 feet	#7	14"	23 spaces (24 bars) @ 6"	3 1/2"	3"	26"
14 feet	#7	14"	27 spaces (28 bars) @ 6"	3 1/2"	3"	26"
16 feet	#7	14"	31 spaces (32 bars) @ 6"	3 1/2"	3"	26"

1

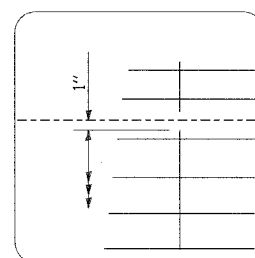

DETAIL A

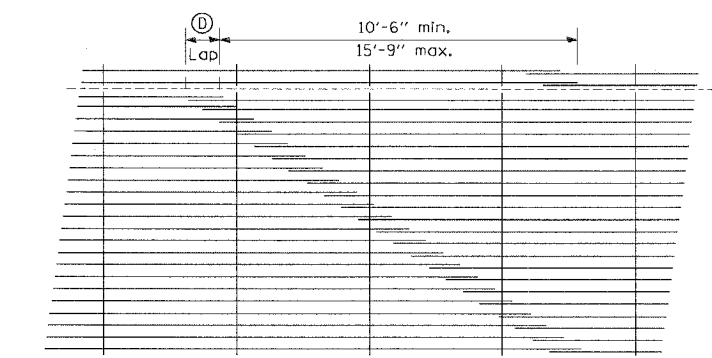

LAP DETAIL II

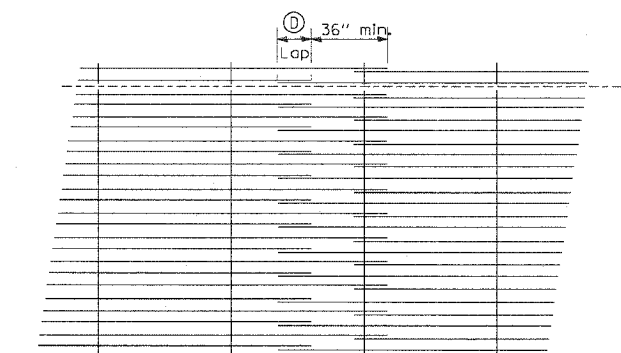

LAP DETAIL III

NOTES:

1. THE PAVEMENT REINFORCEMENT SHALL BE 4.5" FROM THE TOP OF PAVEMENT.
2. EXCEPT AS NOTED OR SHOWN, THE DIMENSIONS AND NOTES SPECIFIED FOR LAP DETAIL I ARE TYPICAL FOR LAP DETAIL II AND III.
3. THE (D) DIMENSION AND THE DISTANCE FROM THE END OF THE TRANSVERSE BAR TO THE EDGE OF PAVEMENT MAY BE INCREASED BY 1" FOR SLIP FORM PAVING.

CTE | AECOM

REVISIONS	
NAME	DATE
ADDENDUM 1	7/27/06

RDT-10
 ILLINOIS DEPARTMENT OF TRANSPORTATION
 F.A.I. 90/94 (DAN RYAN EXPRESSWAY)
 GARFIELD BLVD TO 31ST STREET (SB LOCAL LANES)
 ROADWAY DETAILS
 EXTENDED LANE REINFORCEMENT FOR
 CONTINUOUSLY REINFORCED PCC PAVEMENT
 SCALE: NONE
 DATE: June 9, 2006
 DRAWN BY: NJH
 CHECKED BY: RMG

F:\P\40666\CIVIL\CONTR 18 & 19\STAC\19\Freeway Details\MCD002A.SW 8:30:18 AM 7/29/2006