

F.A.S. RTE.	SECTION	COUNTY	TOTAL SHEETS	SHEET NO.
1671	.	DOUGLAS	181	19
STA.		TO STA.		
FED. ROAD DIST. NO.	ILLINOIS	FED. AID PROJECT		
• 144SBR-2 & 22VBR-1				

TIE POINTS

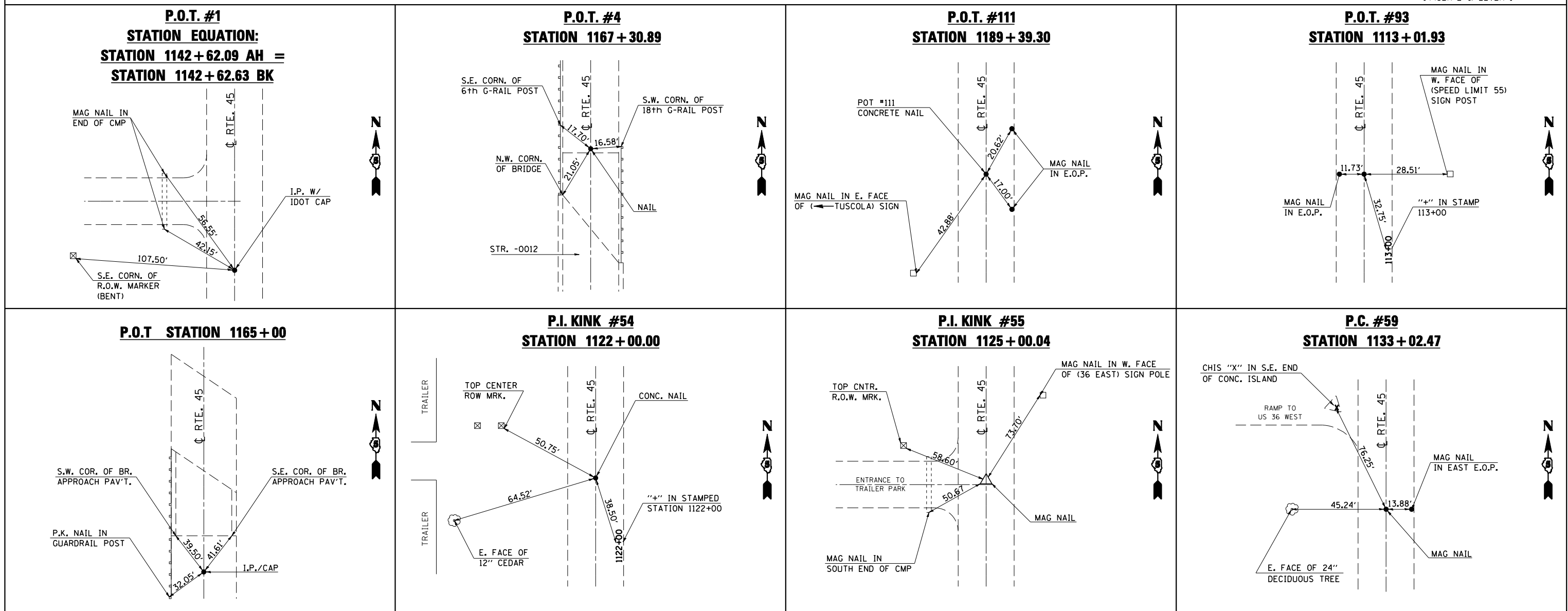

BENCHMARKS

- B.M. 4660-1** CHISELED SQUARE
 ON TOP OF S.E. WINGWALL OF BRIDGE.
 STATION 1150+88.42, 17.10' RT., ELEVATION 674.665
- B.M. 4660-2** CHISELED SQUARE
 ON TOP OF N.E. WINGWALL OF BRIDGE.
 STATION 1156+83.92, 17.02' RT., ELEVATION 680.865

ILLINOIS DEPARTMENT OF TRANSPORTATION
TIE POINTS & BENCHMARKS
 F.A.S. ROUTE 1671 (U.S. ROUTE 45)
 SECTION 144SBR-2 & 22VBR-1
 DOUGLAS COUNTY
Sheet 1 of 2

SCALE: NOT TO SCALE
 DATE: 06/09/06

DRAWN BY: B.B.P.
 CHECKED BY: C.R.G.

PLOT DATE = 7/10/2006
 FILE NAME = c:\projects\144SBR-2\144SBR-2.dgn
 USER NAME = pier_sonbr