

SEC. 33, T. 16 N., R. 8 E. OF THE 3rd P.M.

F.A.S. RTE.	SECTION	COUNTY	TOTAL SHEETS	SHEET NO.
1671	.	DOUGLAS	181	60
STA. 1157+50.00		TO STA. 1163+50.00		
FED. ROAD DIST. NO.		ILLINOIS FED. AID PROJECT		
• 144SBR-2 & 22VBR-1				

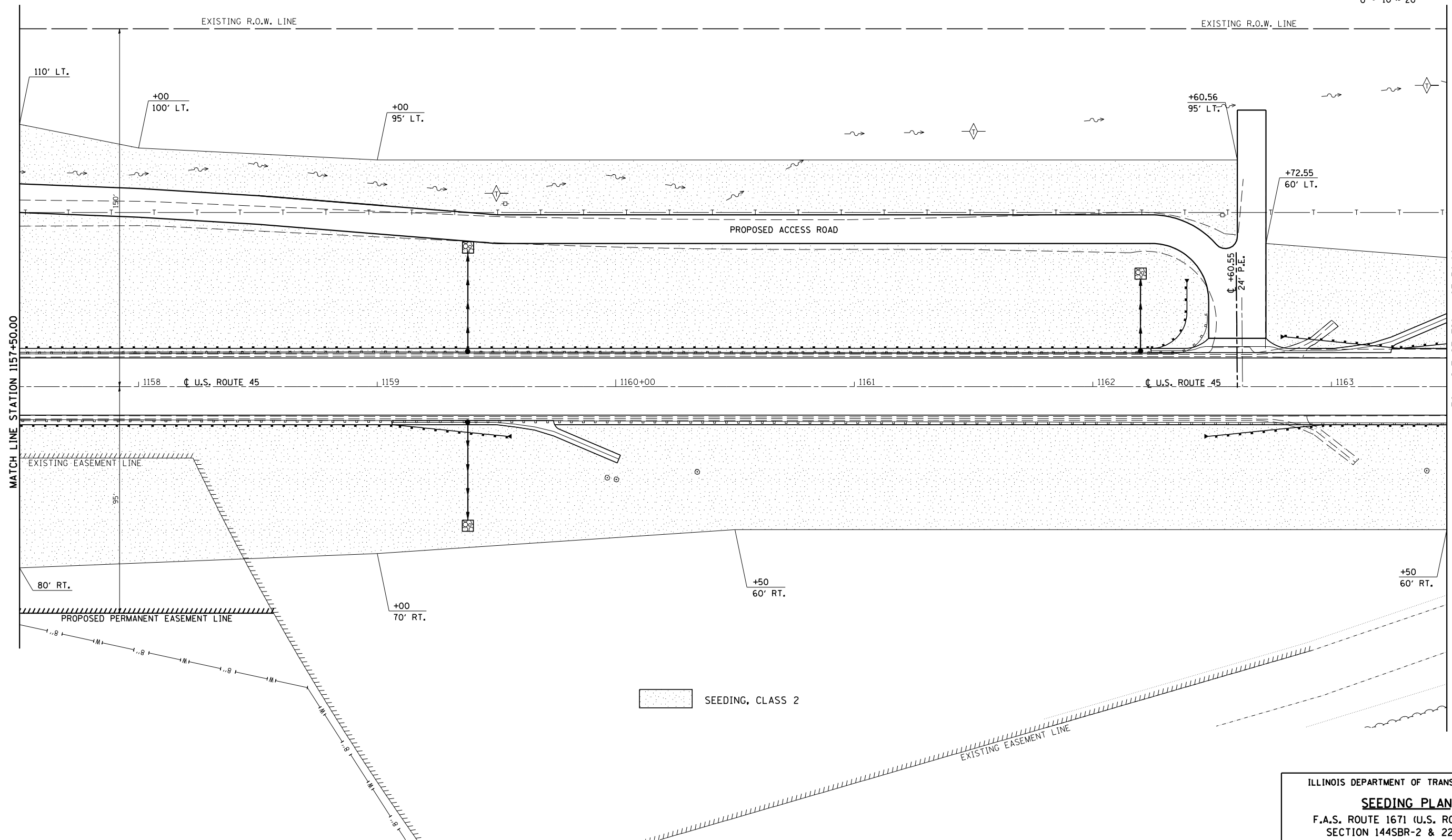
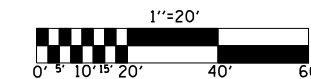

SEEDING, CLASS 2

SEC. 34, T. 16 N., R. 8 E. OF THE 3rd P.M.

PLOT DATE = 7/10/2006
 FILE NAME = G:\projects\144505202 (v8)\170258\landscpe.dgn
 USER NAME = cr@grg

ILLINOIS DEPARTMENT OF TRANSPORTATION
SEEDING PLAN
 F.A.S. ROUTE 1671 (U.S. ROUTE 45)
 SECTION 144SBR-2 & 22VBR-1
 DOUGLAS COUNTY

SCALE: 1" = 20'-0"
 DATE: 06/05/06

DRAWN BY: B.B.P.
 CHECKED BY: C.R.G.