

STATE OF ILLINOIS
DEPARTMENT OF TRANSPORTATION

ROUTE NO.	SECTION	COUNTY	TOTAL SHEETS	SHEET NO.
FAS 1671	**	DOUGLAS	181	75
FED. ROAD DIST. NO. 7	ILLINOIS	FED. AID PROJECT		

SHEET NO. 5
14 SHEETS

Contract #70258 **144SBR-2 & 22VBR-1

MIN. BAR LAP

#4 bar = 1'-8"

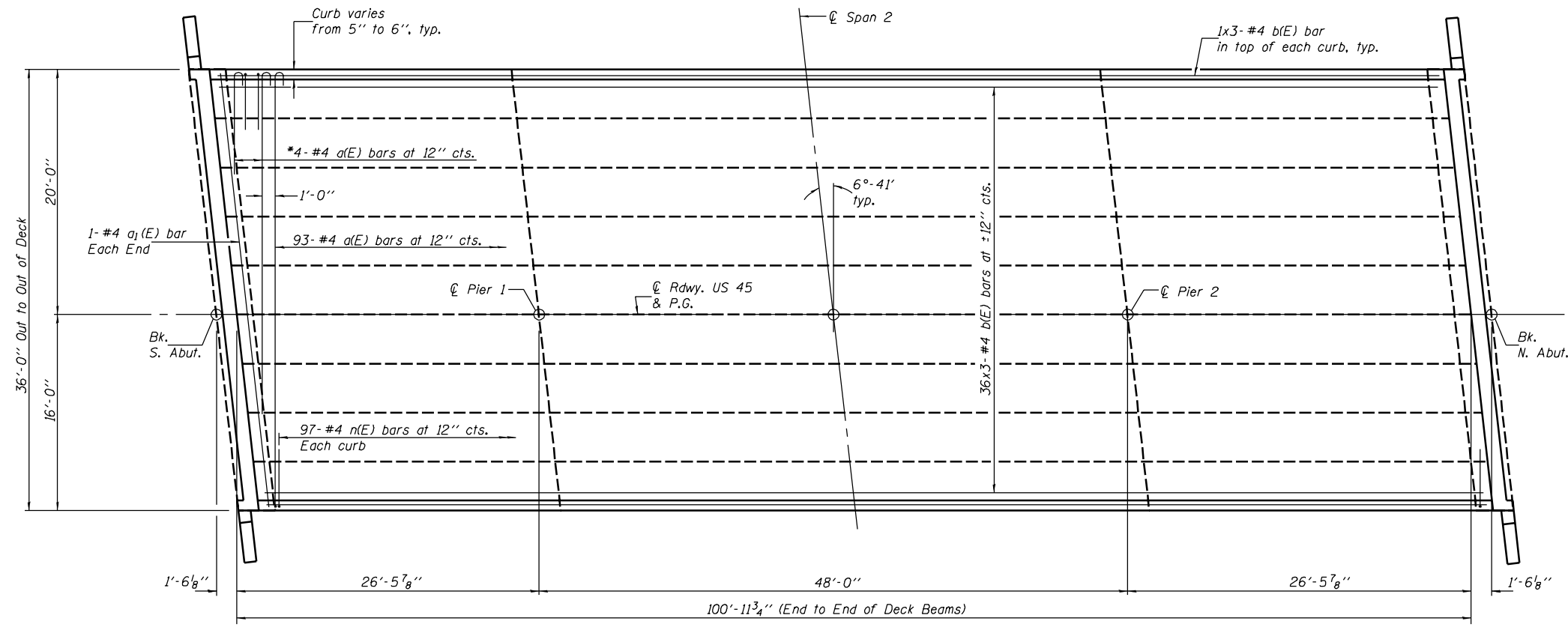

PLAN

*Order a(E) bars full length. Cut to fit skew and use remainder in opposite end.

Notes:
Reinforcement bars designated (E) shall be epoxy coated.
Bars indicated thus 35x3-#4 etc. indicates 35 lines of bars with 3 lengths per line.

DESIGNED	SMR
CHECKED	PRL
DRAWN	BECKY M. LEACH
CHECKED	SMR/PRL

August 4, 2006
 EXAMINED *Thomas J. Domagalaki*
 ENGINEER OF BRIDGE DESIGN
 PASSED *Ralph V. Anderson*
 ENGINEER OF BRIDGES AND STRUCTURES

SUPERSTRUCTURE
F.A.S. ROUTE 1671 - SECTION 144SBR-2
DOUGLAS COUNTY
STATION 1130+72.93
STRUCTURE NO. 021-0062