

F.A.P. RTE.	SECTION	COUNTY	TOTAL SHEETS	SHEET NO.
332	47BR-2	VERMILION	68	16
STA.		TO STA.		
FED. ROAD DIST. NO.	ILLINOIS	FED. AID PROJECT		

RELOCATE TEMPORARY CONCRETE BARRIER

STAGE	STATION	OFFSET	STATION	OFFSET	LENGTH (FOOT)
2	2519+00.37	RT. 8.79	2520+50.00	LT. 6.00	150.00
2	2520+50.00	LT. 6.00	2524+77.00	LT. 6.00	427.00
2	2524+77.00	LT. 6.00	2526+13.98	RT. 8.23	137.50
TOTAL					714.50
USE					715.00

TEMPORARY RUMBLE STRIP

STAGE	LOCATION	EACH
2	2510+37.59 RT.	1
2	2505+37.59 RT.	1
2	2500+37.59 RT.	1
TOTAL		3

STAGE II CONSTRUCTION

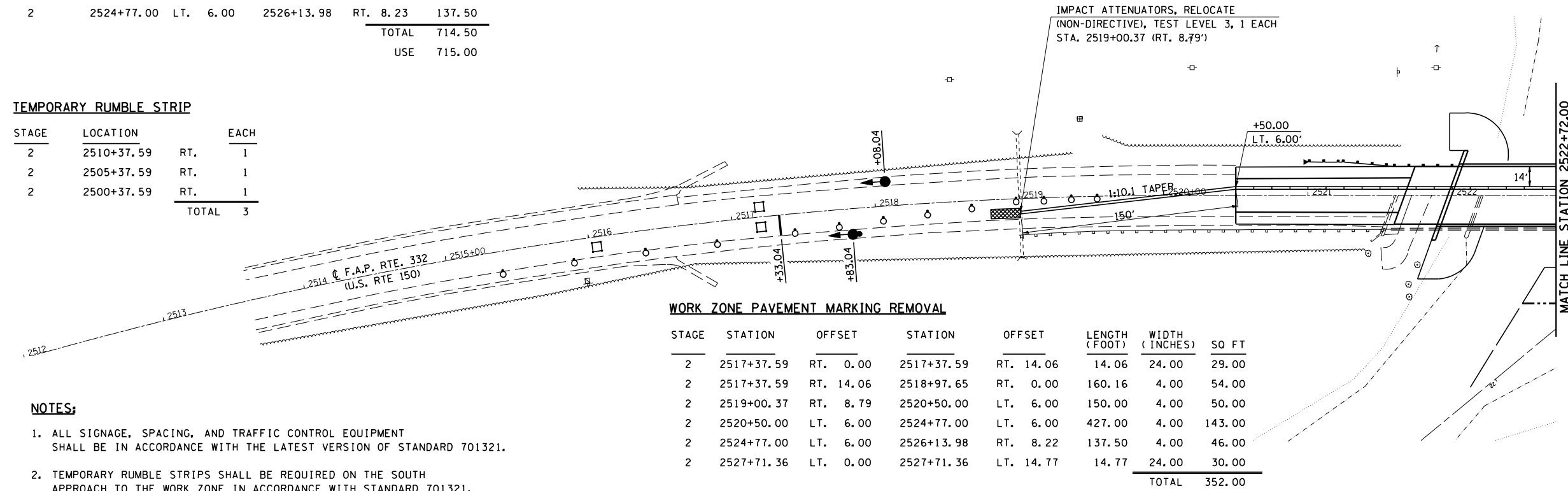

WORK ZONE PAVEMENT MARKING REMOVAL

STAGE	STATION	OFFSET	STATION	OFFSET	LENGTH (FOOT)	WIDTH (INCHES)	50 FT
2	2517+37.59	RT. 0.00	2517+37.59	RT. 14.06	14.06	24.00	29.00
2	2517+37.59	RT. 14.06	2518+97.65	RT. 0.00	160.16	4.00	54.00
2	2519+00.37	RT. 8.79	2520+50.00	LT. 6.00	150.00	4.00	50.00
2	2520+50.00	LT. 6.00	2524+77.00	LT. 6.00	427.00	4.00	143.00
2	2524+77.00	LT. 6.00	2526+13.98	RT. 8.22	137.50	4.00	46.00
2	2527+71.36	LT. 0.00	2527+71.36	LT. 14.77	14.77	24.00	30.00
TOTAL							352.00

NOTES:

- ALL SIGNAGE, SPACING, AND TRAFFIC CONTROL EQUIPMENT SHALL BE IN ACCORDANCE WITH THE LATEST VERSION OF STANDARD 701321.
- TEMPORARY RUMBLE STRIPS SHALL BE REQUIRED ON THE SOUTH APPROACH TO THE WORK ZONE IN ACCORDANCE WITH STANDARD 701321.
- ALL TEMPORARY BRIDGE TRAFFIC SIGNALS FOR STAGE I AND II WILL BE MEASURED AS 1 UNIT.

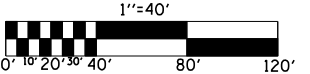

LEGEND

- RELOCATE TEMPORARY CONCRETE BARRIER
- IMPACT ATTENUATORS, TEMPORARY (NON-REDIRECTIVE), TEST LEVEL 3
- TEMPORARY BRIDGE TRAFFIC SIGNALS
- DRUM WITH STEADY BURNING LIGHT
- STOP BAR

STAGE II CONSTRUCTION

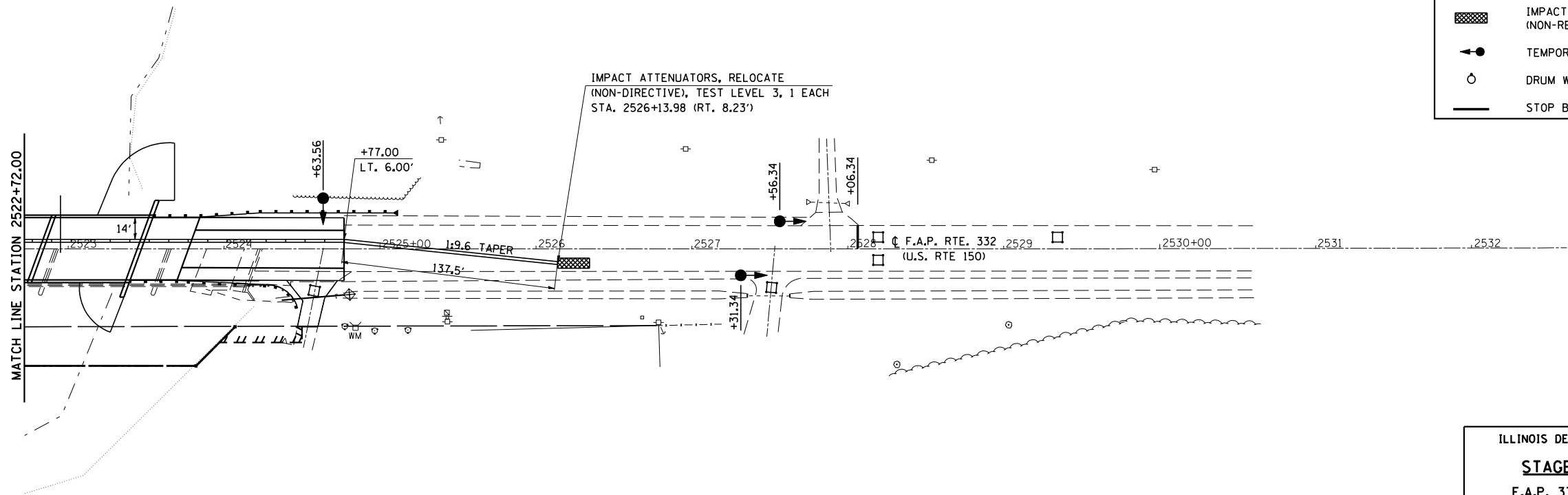

LEGEND

- RELOCATE TEMPORARY CONCRETE BARRIER
- IMPACT ATTENUATORS, TEMPORARY (NON-REDIRECTIVE), TEST LEVEL 3
- TEMPORARY BRIDGE TRAFFIC SIGNALS
- DRUM WITH STEADY BURNING LIGHT
- STOP BAR

PLOT DATE = 6/30/2006
 FILE NAME = c:\p\projects\view\506004 (v8)\70420staging.dgn
 SCALE = 84.7093 / IN.
 USER NAME = rnelsonr

ILLINOIS DEPARTMENT OF TRANSPORTATION
STAGE II CONSTRUCTION
 F.A.P. 332 (U.S. ROUTE 150/IL 1)
 SECTION 47BR-2
 VERMILION COUNTY

SCALE: 1" = 40'
 DATE: 04/18/06

DRAWN BY: B.B.P.
 CHECKED BY: R.M.N.