

RESIDENTIAL
SUBDIVISION

FAP RTE.	SECTION	COUNTY	TOTAL SHEETS	SHEET NO.
348	04-00040-00-LS	COOK	31	5
F.H.W.A. REG.		ILLINOIS	PROJECT: F-0348(028)	
CONTRACT NUMBER 83863				

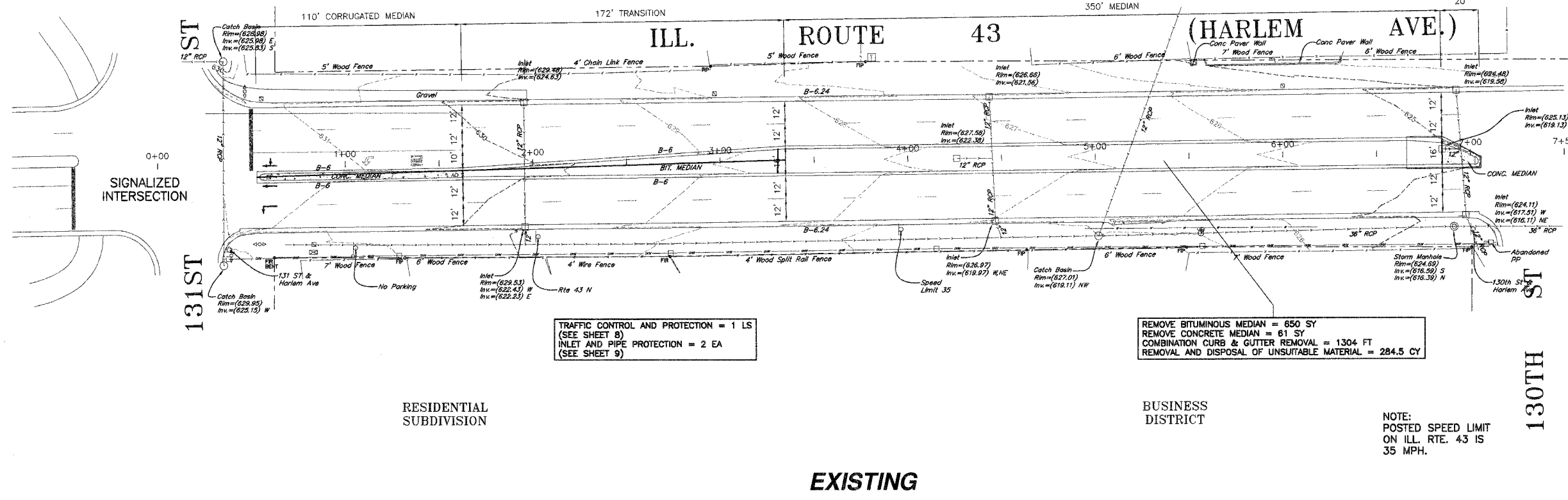

EXISTING

RESIDENTIAL
SUBDIVISION

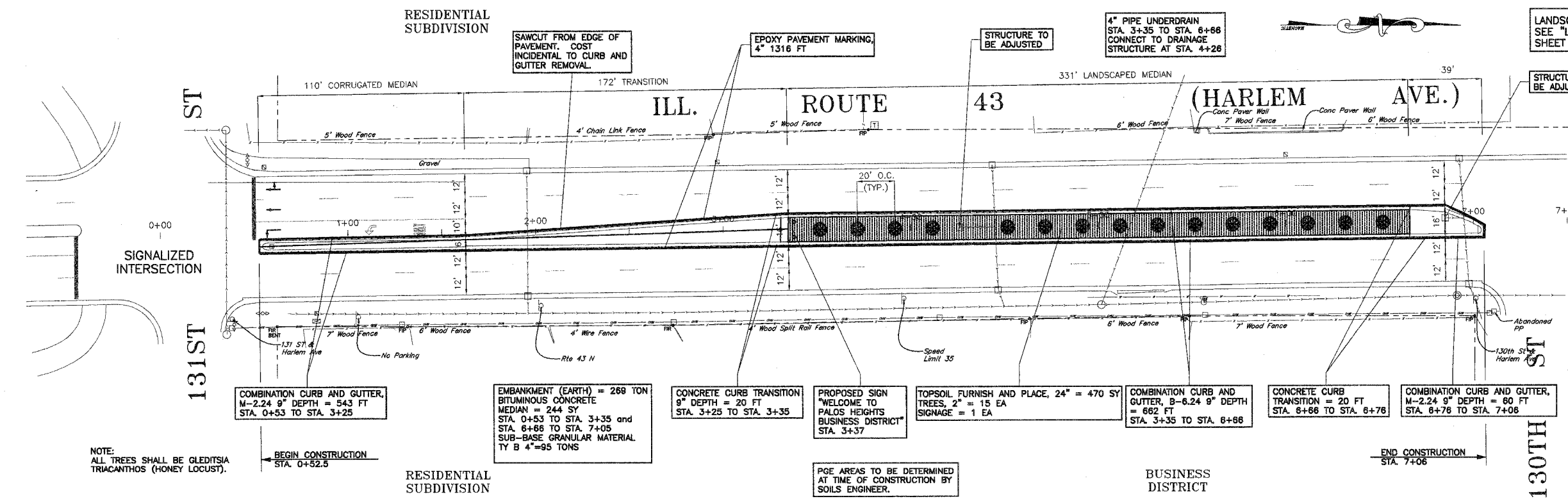

PROPOSED

ALL COMBINATION CURB & GUTTER (B-6.24, M-2.24, TRANSITION CURB) SHALL BE TIED INTO EXISTING ADJACENT PAVEMENT WITH NO. 6 EPOXY COATED TIE BARS. ALL COSTS INCIDENTAL.

MORRIS ENGINEERING, INC.
 5100 S. LINCOLN SUITE 100 LISLE, ILLINOIS 60532
 PHONE: (630)271-0770 EMAIL: ECIVIL.COM
 DWG LOCATION: H:\04-PH\3004\PLANS-ENG\REV-1
 DRAWN BY: CJS/CMM FLD. BK. / PG. NO. :
 COMPLETION DATE: 4/26/06 JOB NO.: 04-PH-3004

HARLEM AVENUE MEDIAN IMPROVEMENTS
HARLEM AVENUE BETWEEN 130TH AND 131ST PLANS - STA. 0+00 TO STA. 7+50

DATE	REVISIONS	BY	SHEET
1 8/1/06	PER IDOT 5/18/06	OSC	5 OF 31 SHEETS
2 8/8/06	PER IDOT 8/8/06	OSC/cmm	
3			

PLT DATE: AUG. 08, 2006
 FILENAME: H:\04-PH\3004\PLANS-ENG\REV-1\AS-130TH.DWG