

FAU RTE	SECTION	COUNTY	TOTAL SHEETS	SHEET NO.
(75TH ST)1691	05-00014-00-RS	COOK	18	1
(RIVER RD)1692				
F.H.W.A. REG.	ILLINOIS	PROJECT M-8003(570)		

STATE OF ILLINOIS
DEPARTMENT OF TRANSPORTATION
DIVISION OF HIGHWAYS
**PLANS FOR PROPOSED
FEDERAL AID URBAN PROJECT**

F.A.U. RTE.1691 (75th STREET)
WILLOW SPRINGS ROAD (FAU 2697) TO SANTA FE DRIVE (FAU 2719)
AND
F.A.U. RTE.1692 (RIVER ROAD)
I-55 (FAI 55) TO EAST TERMINUS
L.A.P.P. RESURFACING
FEDERAL PROJECT M-8003(570)
M.F.T. SECTION NO. 05-00014-00-RS
VILLAGE OF HODGKINS
COOK COUNTY
JOB NO. C-91-145-06



- INDEX OF SHEETS**
- COVER SHEET, INDEX OF SHEETS, LOCATION MAP, INDEX OF STATE STANDARDS
 - GENERAL NOTES AND SUMMARY OF QUANTITIES
 - TYPICAL CROSS SECTIONS, PAVEMENT DESIGN, BIT. MIXTURES REQUIREMENT
 - 5.) PLAN: 75th STREET (RESURFACING)
 - 8.) PLAN: RIVER ROAD (RESURFACING)
 - 10.) PLAN: 75th STREET (PAVEMENT MARKING & SIGNING)
 - DISTRICT ONE TYPICAL PAVEMENT MARKINGS
 - TEMPORARY PAVEMENT MARKING LETTERS AND SYMBOLS
 - TRAFFIC CONTROL AND PROTECTION FOR SIDEROADS, INTERSECTIONS, AND DRIVEWAYS
 - TRAFFIC CONTROL AND PROTECTION AT TURN BAYS (TO REMAIN OPEN TO TRAFFIC)
 - CURB OR CURB AND GUTTER REMOVAL AND REPLACEMENT
 - FRAMES AND LIDS ADJUSTMENTS WITH MILLING
 - BUTT JOINT AND BITUMINOUS TAPER DETAILS
 - PAVEMENT PATCHING FOR BITUMINOUS SURFACED PAVEMENT

STATE STANDARDS

000001-04	STANDARDS SYMBOLS, ABBREVIATIONS, AND PATTERNS
442201-01	CLASS C AND D PATCHES
606001-02	CONCRETE CURB AND COMBINATION CONCRETE CURB & GUTTER
604001-02	FRAME & LIDS, TYPE 1
701501-03	URBAN LANE CLOSURE, 2 L, 2 W UNDIVIDED
702001-06	TRAFFIC CONTROL DEVICES
780001-01	TYPICAL PAVEMENT MARKINGS
886001	DETECTOR LOOP INSTALLATIONS

FEDERAL-AID DESIGN ENGINEER: ABIGAIL BRINKS (847)705-4233
CONSULTANT: FRANK NOVOTNY AND ASSOCIATES, INC. (630)887-8640

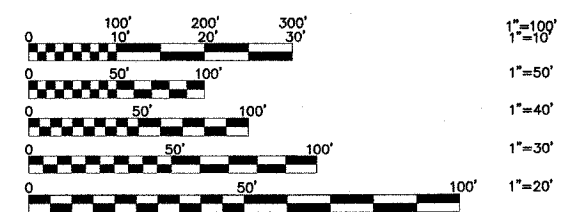

FULL SIZE PLANS HAVE BEEN PREPARED USING STANDARD ENGINEERING SCALES. REDUCED SIZED PLANS WILL NOT CONFORM TO STANDARD SCALES. IN MAKING MEASUREMENTS ON REDUCED PLANS, THE ABOVE SCALES MAY BE USED.

LOCATION MAP

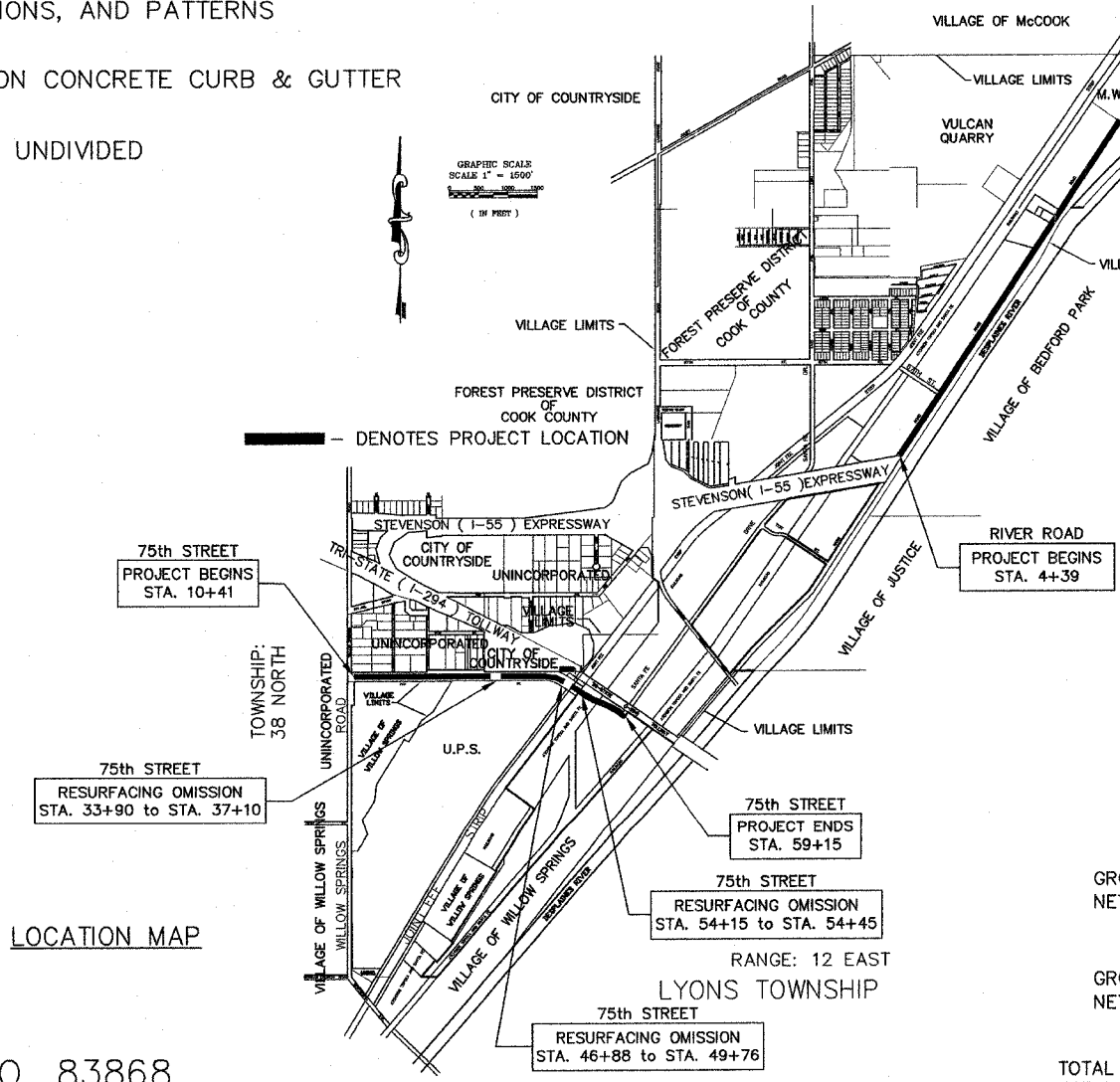

RIVER ROAD
ADT = 1,000
POSTED SPEED LIMIT = 25 MPH
DESIGN SPEED LIMIT = 30 MPH

75TH STREET
ADT = 6,000
POSTED SPEED LIMIT = 25 MPH
DESIGN SPEED LIMIT = 30 MPH

PROJECT LOCATED IN THE
VILLAGE OF HODGKINS

LENGTH OF PROJECT

(75th STREET)
GROSS LENGTH = 4,874 FT. (0.923 miles)
NET LENGTH = 4,236 FT. (0.802 miles)

(RIVER ROAD)
GROSS LENGTH = 6,487 FT. (1.229 miles)
NET LENGTH = 6,487 FT. (1.229 miles)

TOTAL GROSS LENGTH = 11,361 FT. (2.152 miles)
TOTAL NET LENGTH = 10,723 FT. (2.031 miles)

REVISIONS				
NO.	BY	DATE	DESCRIPTION	
1	THK	3-29-06	IDOT - DISTRICT 1	
2	THK	4-13-06	IDOT - DISTRICT 1	
3	JLC	6-27-06	IDOT - DISTRICT 1	

CONTRACT NO. 83868

STATE OF ILLINOIS
DEPARTMENT OF TRANSPORTATION

APPROVED _____ JULY 11, 2006 _____
LOCAL AGENCY OFFICIAL

PASSED _____ JULY 18, 2006 _____
ENGINEER OF LOCAL ROADS & STREETS

SIGNED _____ JULY 18, 2006 _____
DEPUTY DIRECTOR OF HIGHWAYS, REGION ENGINEER

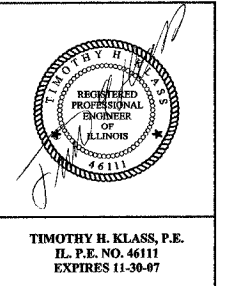
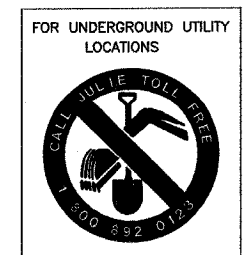

PRINTED BY THE AUTHORITY OF THE
STATE OF ILLINOIS

FNA JOB # 05084

GENERAL CONSTRUCTION NOTES PAVING AND STORM SEWERS

SPECIFICATIONS

THE LATEST EDITIONS OF THE "STANDARD SPECIFICATIONS FOR ROAD AND BRIDGE CONSTRUCTION", THE "SUPPLEMENTAL SPECIFICATIONS AND RECURRING SPECIAL PROVISIONS", PREPARED BY THE ILLINOIS DEPARTMENT OF TRANSPORTATION AND THE "MANUAL OF UNIFORM TRAFFIC CONTROL DEVICES" SHALL GOVERN ALL WORK ASSOCIATED WITH THIS PROJECT. THE "STANDARD SPECIFICATIONS FOR WATER AND SEWER MAIN CONSTRUCTION IN ILLINOIS" MAY GOVERN OTHER WORK ON THIS PROJECT AS INDICATED BY REFERENCE.

CARE IN EXCAVATION

CARE SHALL BE EXERCISED BY THE CONTRACTOR IN CARRYING OUT EARTH AND/OR TRENCHING OPERATIONS SO THAT LOCAL SERVICES, WATER VALVES, MANHOLES, CATCH BASINS, INLETS, BUFFALO BOXES, AND OTHER STRUCTURES ARE NOT DAMAGED OR REMOVED. ANY DAMAGE DONE BY THE CONTRACTOR, WHETHER THE STRUCTURE OR SERVICE IS VISIBLE AT THE GROUND SURFACE OR NOT, SHALL BE REPAIRED OR REPLACED BY THE CONTRACTOR AS REQUIRED BY THE ENGINEER AT THE CONTRACTOR'S EXPENSE, AND NO ADDITIONAL COMPENSATION WILL BE ALLOWED.

NOTIFICATION OF PUBLIC UTILITIES

PRIOR TO STARTING CONSTRUCTION, THE CONTRACTOR SHALL NOTIFY THE OFFICIALS OF THE PUBLIC WORKS DEPARTMENT OF THE LOCAL MUNICIPALITY, J.U.L.I.E. AT 1-800-892-0123, AND OTHER PUBLIC AND PRIVATE UTILITIES SO THAT ARRANGEMENTS CAN BE MADE TO LOCATE THEIR VARIOUS FACILITIES WITHIN THE LIMITS OF CONSTRUCTION UNDER THIS CONTRACT, AS WELL AS TO PROVIDE ADEQUATE PROTECTION AND INSPECTION THERETO. IT SHALL BE THIS CONTRACTOR'S RESPONSIBILITY TO DETERMINE THE ACTUAL LOCATION OF ALL SUCH FACILITIES IN THE FIELD.

TRAFFIC CONTROL DEVICES

BARRICADES AND WARNING SIGNS SHALL BE PROVIDED IN ACCORDANCE WITH ARTICLE 107.14 OF THE "STANDARD SPECIFICATIONS FOR ROAD AND BRIDGE CONSTRUCTION". ADEQUATE LIGHTING SHALL BE MAINTAINED FROM DUSK TO DAWN AT ALL LOCATIONS WHERE CONSTRUCTION OPERATIONS WARRANT, OR AS DESIGNATED BY THE ENGINEER.

EXCAVATED MATERIALS

THE WASTE OBTAINED FROM EARTH OR TRENCH EXCAVATION INCLUDED UNDER THIS CONTRACT SHALL NOT BE DISPOSED OF BY THE CONTRACTOR UNTIL PERMISSION IS RECEIVED FROM THE OWNER SINCE THEY MAY REQUIRE THE CONTRACTOR TO DISPOSE OF THIS MATERIAL AT LOCATIONS AS DESIGNATED. THE CONTRACT UNIT PRICE BIDS FOR EARTH EXCAVATION SHALL INCLUDE DISPOSAL OF WASTE MATERIALS AS MAY OR MAY NOT BE DESIGNATED ABOVE, AND NO ADDITIONAL COMPENSATION WILL BE ALLOWED. THEREFORE, AS A PROVISION OF THIS CONTRACT, THE CONTRACTOR WILL BE REQUIRED TO DISPOSE OF ALL SURPLUS TRENCH SPOIL MATERIALS OFF THE SITE AS WORK PROGRESSES. THE TEMPORARY STOCKPILING OF THIS MATERIAL ON THE PROJECT SITE WILL NOT BE ALLOWED.

PROTECTION OF SIGNS AND PROPERTY

ALL TRAFFIC SIGNS, STREET SIGNS, ETC., THAT INTERFERE WITH THE CONSTRUCTION OPERATIONS SHALL BE REMOVED AND PLACED AT NEW LOCATIONS AS DESIGNATED BY THE ENGINEER. THIS WORK SHALL BE CONSIDERED INCIDENTAL TO THE CONTRACT, AND NO ADDITIONAL COMPENSATION WILL BE ALLOWED. IN ADDITION, ALL MAIL BOXES THAT INTERFERE WITH CONSTRUCTION SHALL BE SIMILARLY RELOCATED AT NO ADDITIONAL COST IN ACCORDANCE WITH ARTICLES 107.20 AND 107.21 OF THE "STANDARD SPECIFICATIONS FOR ROAD AND BRIDGE CONSTRUCTION".

SUPERINTENDENCE

SPECIAL ATTENTION IS DRAWN TO ARTICLE 105.06 OF THE "STANDARD SPECIFICATIONS FOR ROAD AND BRIDGE CONSTRUCTION" WHICH REQUIRES THE CONTRACTOR TO HAVE A COMPETENT SUPERINTENDENT ON THE PROJECT SITE AT ALL TIMES, IRRESPECTIVE OF THE AMOUNT OF WORK SUBLET. THE SUPERINTENDENT SHALL BE CAPABLE OF READING AND UNDERSTANDING THE PLANS AND SPECIFICATIONS, SHALL HAVE FULL AUTHORITY TO EXECUTE ORDERS TO EXPEDITE THE PROJECT AND SHALL BE RESPONSIBLE FOR SCHEDULING AND HAVING CONTROL OF ALL THE WORK AS THE AGENT OF THE GENERAL CONTRACTOR. FAILURE TO COMPLY WITH THIS PROVISION WILL RESULT IN A SUSPENSION OF WORK AS PROVIDED IN ARTICLE 108.07.

SAWING EXISTING IMPROVEMENTS

ALL PERMANENT TYPE PAVEMENTS OR OTHER PERMANENT IMPROVEMENTS WHICH ABOUT THE PROPOSED IMPROVEMENT AND MUST BE REMOVED, SHALL BE SAWED AS DIRECTED PRIOR TO REMOVAL. ALL ITEMS SO REMOVED SHALL BE REPLACED WITH SIMILAR CONSTRUCTION MATERIALS TO THEIR ORIGINAL CONDITION OR BETTER. PAYMENT FOR SAWING SHALL BE INCLUDED IN THE COST FOR THE REMOVAL OF EACH ITEM, AND REPLACEMENT WILL BE PAID FOR UNDER THE RESPECTIVE ITEMS IN THE CONTRACT UNLESS OTHERWISE INDICATED. SAW CUTTING FOR PATCHES WILL BE INCIDENTAL TO THE PATCHING ITEM.

CONSTRUCTION LAYOUT STAKES

THE CONTRACTOR SHALL PROVIDE THE ENGINEER WITH WOODEN STAKES OR OTHER LAYOUT MATERIALS FOR LAYOUT OF THE LINES AND GRADES OF THE PROJECT. FAILURE TO PROVIDE STAKES IN A TIMELY MANNER WILL RESULT IN A DELAY IN STAKEOUT WHICH WILL BE APPLICABLE AGAINST THE TIME LIMIT FOR COMPLETION SHOWN IN THE PROJECT SPECIFICATIONS. LINE AND GRADE WILL BE ESTABLISHED BY THE ENGINEER AT REGULAR INTERVALS ON PERMANENTLY PAVED SURFACES, SIDEWALKS OR STAKES AT THE ENGINEER'S OPTION, ALL WITHIN THE PUBLIC RIGHT-OF-WAY AND SHALL BE TRANSFERRED BY THE CONTRACTOR TO THE ACTUAL LINE OF CONSTRUCTION.

PROJECT SAFETY

BARRICADES: THE CONTRACTOR SHALL PROVIDE AND INSTALL TWO (2) WEIGHTED SAND BAGS ON EACH TYPE I OR TYPE II BARRICADE USED- ONE (1) WEIGHTED SAND BAG ACROSS EACH BOTTOM RAIL.

WHEN MILLED PAVEMENT IS OPEN TO TRAFFIC THE MAXIMUM GRADE DIFFERENTIAL BETWEEN PASSES OF THE MILLING MACHINE SHALL NOT EXCEED 40 MM (1-1/2 INCHES) WHERE THE SPEED LIMIT IS 80 KM/H (45 MPH) OR LESS AND 25 MM (1 INCH) WHERE THE SPEED LIMIT IS GREATER THAN 80 KM/H (45 MPH). WITH WRITTEN APPROVAL FROM THE ENGINEER, A MAXIMUM GRADE DIFFERENTIAL OF 75 MM (3 INCHES) MAY BE ALLOWED IF THE EDGE OF THE MILLING IS SLOPED A MINIMUM 1:3 (V:H).

BUTT JOINTS WILL BE INSTALLED AT THE ENDS OF ALL RESURFACING (WHERE RESURFACING MEETS EXISTING PAVEMENT), IN ACCORDANCE WITH THE "BUTT JOINT AND BITUMINOUS TAPER DETAILS" SHEET INCLUDED IN THE PLANS, UNLESS OTHERWISE SPECIFIED.

THE CONTRACTOR SHALL COMPLY WITH AND OBSERVE THE RULES AND REGULATIONS OF O.S.H.A. AND APPROPRIATE AUTHORITIES REGARDING SAFETY PROVISIONS. THE CONTRACTOR, ENGINEER, AND OWNER SHALL EACH BE RESPONSIBLE FOR THEIR OWN RESPECTIVE AGENTS AND EMPLOYEES.

THE ENGINEER AND OWNER ARE NOT RESPONSIBLE FOR THE CONSTRUCTION MEANS, METHODS, TECHNIQUES, SEQUENCES OR PROCEDURES, TIME OF PERFORMANCE, PROGRAMS, OR FOR ANY SAFETY PRECAUTIONS USED BY THE CONTRACTOR. THE CONTRACTOR IS SOLELY RESPONSIBLE FOR EXECUTION OF HIS WORK IN ACCORDANCE WITH THE DOCUMENTS AND SPECIFICATIONS.

ALL ITEMS ASSOCIATED WITH CURB AND GUTTER, DRIVEWAYS AND PATCHING WILL NOT EXCEED THE QUANTITIES LISTED IN THE SUMMARY OF QUANTITIES.

FAU RTE	SECTION	COUNTY	TOTAL SHEETS	SHEET NO.
(75TH ST)1691	05-00014-00-RS	COOK	18	2
(RIVER RD)1692				
F.H.W.A. REG.	ILLINOIS	PROJECT	M-8003(570)	

CONTRACT NO. 83868

SUMMARY OF QUANTITIES

Code No	Description	Unit	Total		
			Quantity	75th Street	River Road
			I000		
20101400	Nitrogen Fertilizer Nutrient	Pound	3	1.74	1.66
20101500	Phosphorus Fertilizer Nutrient	Pound	3	1.74	1.66
20101600	Potassium Fertilizer Nutrient	Pound	3	1.74	1.66
20200100	Earth Excavation	CY YD	27	14	13
21101615	Topsoil Furnish and Place, 4"	SQ YD	235	120	115
25200110	Sodding, Salt Tolerant	SQ YD	235	120	115
25200200	Supplemental Watering	UNIT	10	5	5
40600200	Bituminous Materials (Prime Coat)	TON	18	8	10
40600300	Aggregate (Prime Coat)	TON	42	19	23
42300400	Portland Cement Concrete Driveway Pavement, 8"	SQ YD	126	46	80
44000200	Driveway Pavement Removal	SQ YD	298	151	147
44201744	Class D Patching, Type I, 9"	SQ YD	5	5	0
44201753	Class D Patching, Type II, 9"	SQ YD	34	22	12
44201757	Class D Patching, Type IV, 9"	SQ YD	483	100	383
60250200	Catch Basins to be Adjusted	EACH	8	8	0
60255600	Manhole to be Adjusted, (Special)	EACH	8	0	8
60260100	Inlets to be Adjusted	EACH	9	9	0
60266800	Valve Boxes to be Adjusted	EACH	5	5	0
67100100	Mobilization	L SUM	1	0.5	0.5
70102620	Traffic Control and Protection, Standard 701501	L SUM	1	0.5	0.5
70300100	Short-Term Pavement Marking	FOOT	955	955	0
78000100	Thermoplastic Pavement Marking-Letters & Symbols	SQ FT	523	523	0
78000200	Thermoplastic Pavement Marking-Line 4"	FOOT	15490	15490	0
78000400	Thermoplastic Pavement Marking-Line 6"	FOOT	1568	1568	0
78000600	Thermoplastic Pavement Marking-Line 12"	FOOT	572	572	0
78000650	Thermoplastic Pavement Marking-Line 24"	FOOT	168	168	0
78001100	Paint Pavement Marking-Letters & Symbols	SQ FT	252	252	0
78001110	Paint Pavement Marking-Line 4"	FOOT	1288	1288	0
78001130	Paint Pavement Marking-Line 6"	FOOT	1764	1764	0
78001150	Paint Pavement Marking-Line 12"	FOOT	28	28	0
78001180	Paint Pavement Marking-Line 24"	FOOT	352	352	0
88600600	Detector Loop Replacement	FOOT	389	389	0
X3550100	Bituminous Base Course, Superpave, 4"	SQ YD	172	105	67
X4066414	Bituminous Concrete Surface Course, Superpave, Mixture "C", N50	TON	2780	19	2761
X4066424	Bituminous Concrete Surface Course, Superpave, Mixture "D", N50	TON	1967	1967	0
X4066614	Bituminous Concrete Binder Course, Superpave, IL-19.0, N50	TON	2528	2528	0
X4067100	Polymerized Leveling Binder (Machine Method), Superpave, IL-4.75, N50	TON	1131	0	1131
X4409410	Bituminous Surface Removal, 2 1/4"	SQ YD	22901	0	22901
X4409423	Bituminous Surface Removal, 3 3/4"	SQ YD	18729	18729	0
XX003560	Curb and Gutter Removal and Replacement	FOOT	1151	489	662
Z0048665	Railroad Protective Liability Insurance	L SUM	1	1	0

* SPECIALTY ITEMS

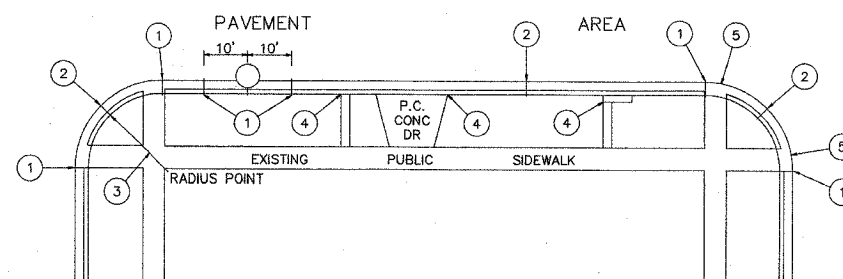

- EXPANSION JOINTS AT TANGENT POINTS AND 150 FOOT INTERVALS, CONSISTING OF ONE INCH PREMOLDED JOINT FILLER MATERIAL WITH #8 DOWEL BARS, 18" IN LENGTH, GREASED, PROVIDE EXPANSION CAP ON ONE END. ALSO CONSTRUCT THIS JOINT TEN FEET EACH SIDE OF PROPOSED UNDERGROUND STRUCTURE.
- CONTRACTION JOINTS AT TWENTY-FIVE FOOT INTERVALS AND AT THE CENTER OF RETURNS.
- ALL RADII SHALL BE 25 FEET TO THE BACK OF CURB UNLESS OTHERWISE DIRECTED BY THE ENGINEER.
- LONGITUDINAL EXPANSION JOINT CONSISTING OF ONE INCH PREMOLDED JOINT FILLER.
- DEPRESS CURB AT LOCATIONS WHERE PUBLIC WALKS INTERSECT CURB LINE AT STREET INTERSECTIONS, ALLEYS, AND OTHER LOCATIONS AS DIRECTED, FOR THE CONSTRUCTION OF RAMPED SIDEWALKS FOR ACCESS BY THE HANDICAPPED.

JOINT DETAILS



Frank Novotny & Associates, Inc.

Civil Engineers/Municipal Consultants
825 Midway Drive ♦ Willowbrook, IL ♦ 60527 ♦ Telephone: (630) 887-8640 ♦ Fax: (630) 887-0132
Illinois Professional Design Firm No. 184-000928

PROJECT
VILLAGE OF HODGKINS, ILLINOIS
75th STREET & RIVER ROAD RESURFACING
M.F.T. SECTION NO. 05-00014-00-RS

R E V I S I O N S			
NO.	BY	DATE	DESCRIPTION
1	THK	3-29-06	IDOT - LOCAL ROADS
2	THK	4-13-06	IDOT - DISTRICT 1
3	JLC	6-27-06	IDOT - DISTRICT 1

GENERAL NOTES
SUMMARY OF QUANTITIES

PROJECT NO. 05084	SCALE NONE	SHEET 2
DRAWN/DESIGNED JEP/THK	DATE NOV., 2005	OF 18
CHECKED/APPROVED THK/JLC	FIELD BOOK NO. FILE	SHEETS

FAU RTE	SECTION	COUNTY	TOTAL SHEETS	SHEET NO.
(75TH ST)1691	05-00014-00-RS	COOK	18	3
(RIVER RD)1692				
F.H.W.A. REG.	ILLINOIS	PROJECT M-8003(570)		

CONTRACT NO. 83868

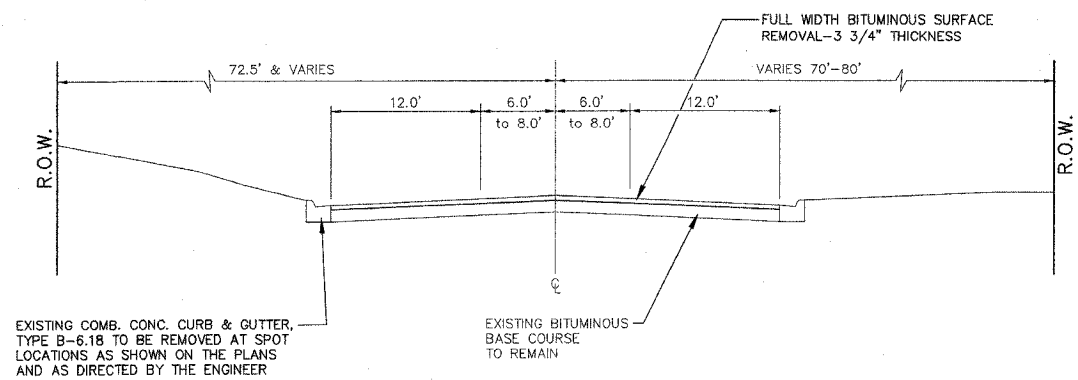

EXISTING TYPICAL CROSS SECTION
(75th STREET)

STA 10+41 TO STA 59+15
RESURFACING OMISSION 33+90 TO 37+10
RESURFACING OMISSION 46+88 TO 49+76
RESURFACING OMISSION 54+15 TO 54+45

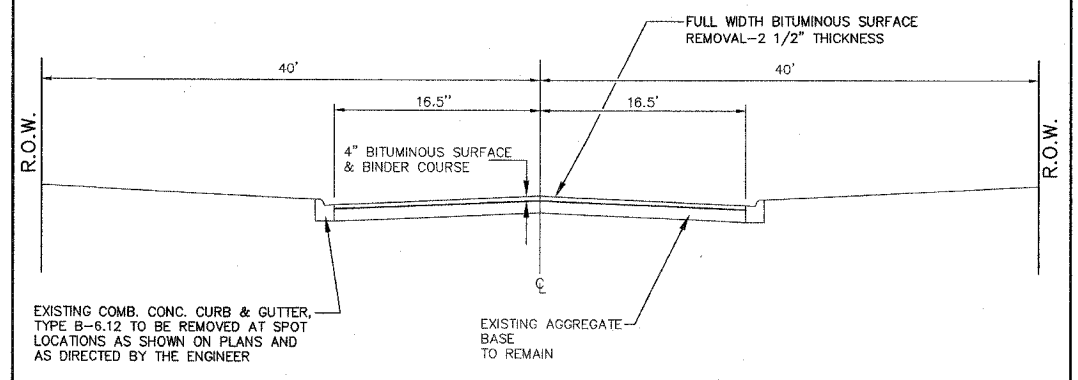

EXISTING TYPICAL CROSS SECTION
(RIVER ROAD)

STA 4+39 TO STA 69+26

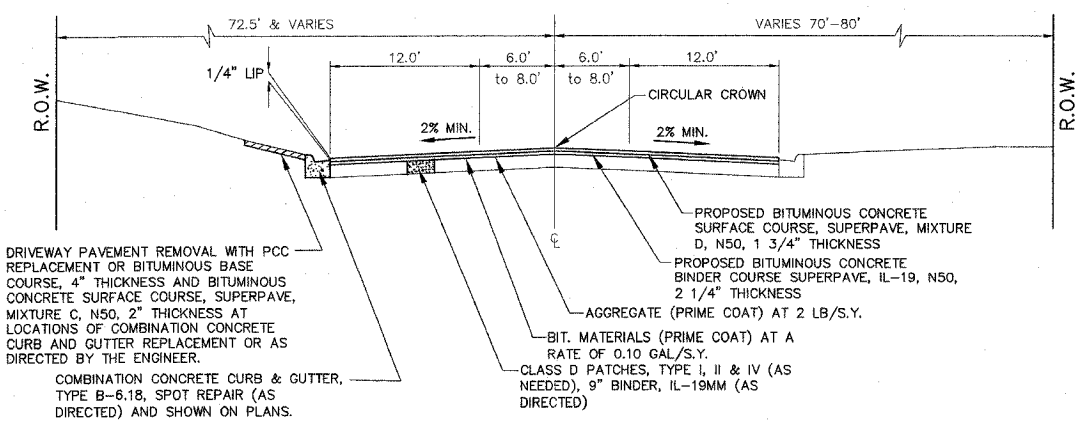

PROPOSED TYPICAL CROSS SECTION
(75th STREET)

STA 10+41 TO STA 59+15
RESURFACING OMISSION 33+90 TO 37+10
RESURFACING OMISSION 46+88 TO 49+76
RESURFACING OMISSION 54+15 TO 54+45

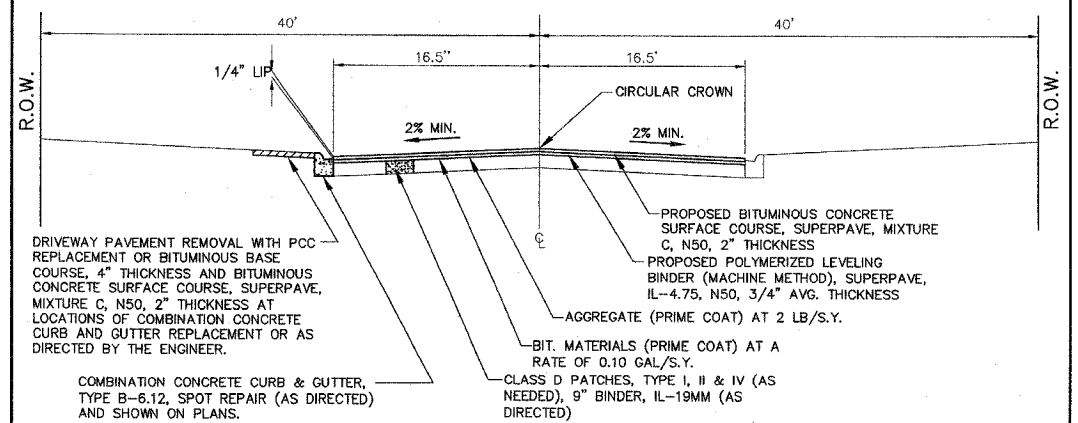

PROPOSED TYPICAL CROSS SECTION
(RIVER ROAD)

STA 4+39 TO STA 69+26

BITUMINOUS MIXTURE REQUIREMENT

ITEM	AC TYPE	VOIDS	UNIT WEIGHT LBS/SQ YD/IN	RAP %
75TH STREET				
BITUMINOUS CONCRETE SURFACE COURSE, SUPERPAVE, MIXTURE D, N50, 1 3/4" THICKNESS	PG 64-22	4% @ 50 GYR	112	15
BITUMINOUS CONCRETE BINDER COURSE, SUPERPAVE, IL-19, N50, 2 1/4" THICKNESS	PG 58-22	4% @ 50 GYR	112	25
RIVER ROAD				
BITUMINOUS CONCRETE SURFACE COURSE, SUPERPAVE, MIXTURE C, N50, 2" THICKNESS	PG 64-22	4% @ 50 GYR	112	15
POLYMERIZED LEVELING BINDER (MACHINE METHOD), SUPERPAVE, IL-4.75, N50, 3/4" THICKNESS	SBS/SBR PG 76-28	2.5% @ 50 GYR	105	0
BITUMINOUS PATCHING				
CLASS D PATCHES, TYPE I,II&IV (AS NEEDED), 9" BINDER, IL-19MM	PG 64-22	4% @ 70 GYR	112	15
BITUMINOUS DRIVEWAY REPAIR				
BITUMINOUS CONCRETE SURFACE COURSE, SUPERPAVE, MIXTURE C, N50, 2" THICKNESS	PG 64-22	4% @ 50 GYR	112	15
BITUMINOUS BASE COURSE, SUPERPAVE, 4" THICKNESS	PG 58-22	2% @ 50 GYR	112	50

BITUMINOUS MATERIALS (PRIME COAT) WILL BE PAID FOR BY THE TON.

BITUMINOUS MATERIALS (PRIME COAT) WILL BE PAID FOR BY THE TON.

REVISIONS			
NO.	BY	DATE	DESCRIPTION
1	THK	3-29-06	IDOT - LOCAL ROADS
2	THK	4-13-06	IDOT - DISTRICT 1
3	JLC	6-27-06	IDOT - DISTRICT 1

TYPICAL CROSS SECTIONS

PROJECT NO. 05084	SCALE NONE	SHEET 3 OF 18 SHEETS
DRAWN/DESIGNED JEP/THK	DATE NOV., 2005	
CHECKED/APPROVED THK/JLC	FIELD BOOK NO. FILE	

FAU RTE	SECTION	COUNTY	TOTAL SHEETS	SHEET NO.
(75TH ST)1691	05-00014-00-RS	COOK	18	4
(RIVER RD)1692				
F.H.W.A. REG.	ILLINOIS	PROJECT M-8003(570)		

CONTRACT NO. 83868

WILLOW SPRINGS ROAD

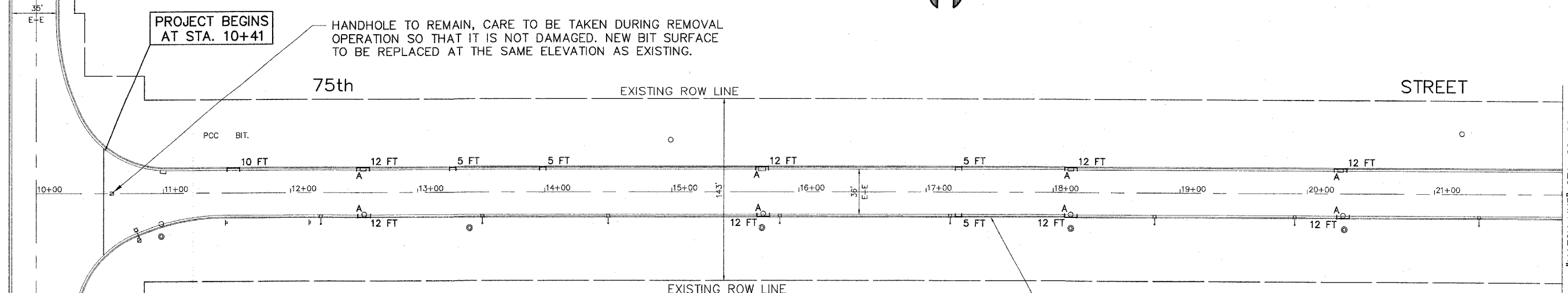

IMPORTANT!
 FULL SIZE PLANS HAVE BEEN PREPARED USING STANDARD ENGINEERING SCALES. REDUCED SIZED PLANS WILL NOT CONFORM TO STANDARD SCALES INDICATED IN TITLE BLOCK.

- LEGEND**
- DENOTES CLASS D PAVEMENT PATCHING, 9"
 - DENOTES DRIVEWAY PAVEMENT REMOVAL AND BITUMINOUS BASE COURSE, SUPERPAVE, 4" THICKNESS AND BITUMINOUS CONCRETE SURFACE COURSE, SUPERPAVE, MIXTURE C, N50, 2" THICKNESS REPLACEMENT
 - DENOTES DRIVEWAY PAVEMENT REMOVAL AND PCC REPLACEMENT (AS NOTED)

FOR CONTINUATION SEE ABOVE RIGHT

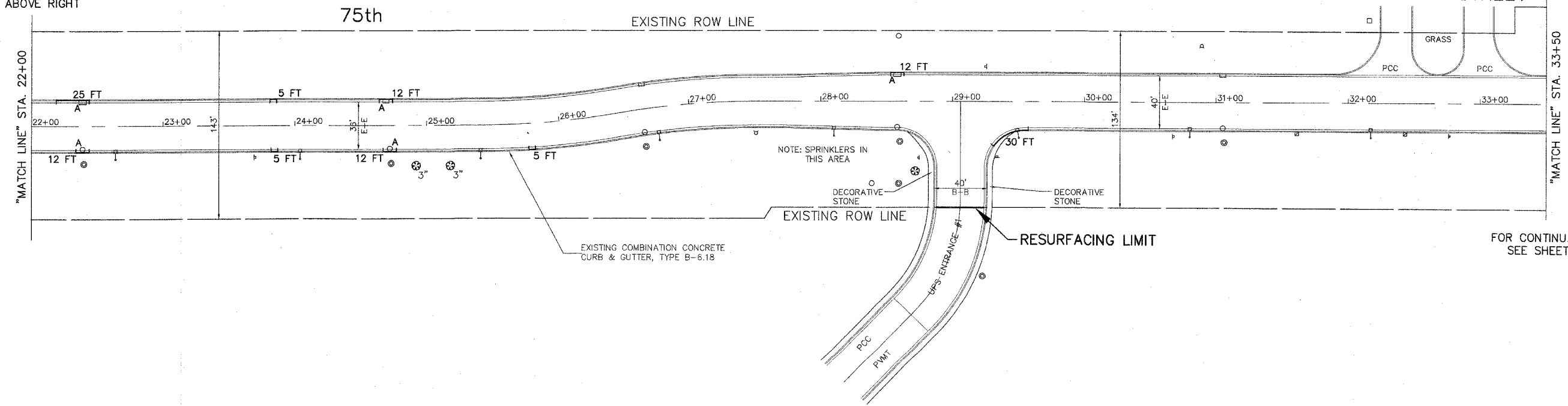

FOR CONTINUATION SEE SHEET 5

REVISIONS			
NO.	BY	DATE	DESCRIPTION
1	THK	3-29-06	IDOT - DISTRICT 1
2	THK	4-13-06	IDOT - DISTRICT 1
3	JLC	6-27-06	IDOT - DISTRICT 1

FAU RTE	SECTION	COUNTY	TOTAL SHEETS	SHEET NO.
(75TH ST)1691	05-00014-00-RS	COOK	18	5
(RIVER RD)1692				
F.H.W.A. REG.	ILLINOIS	PROJECT M-8003(570)		

CONTRACT NO. 83868

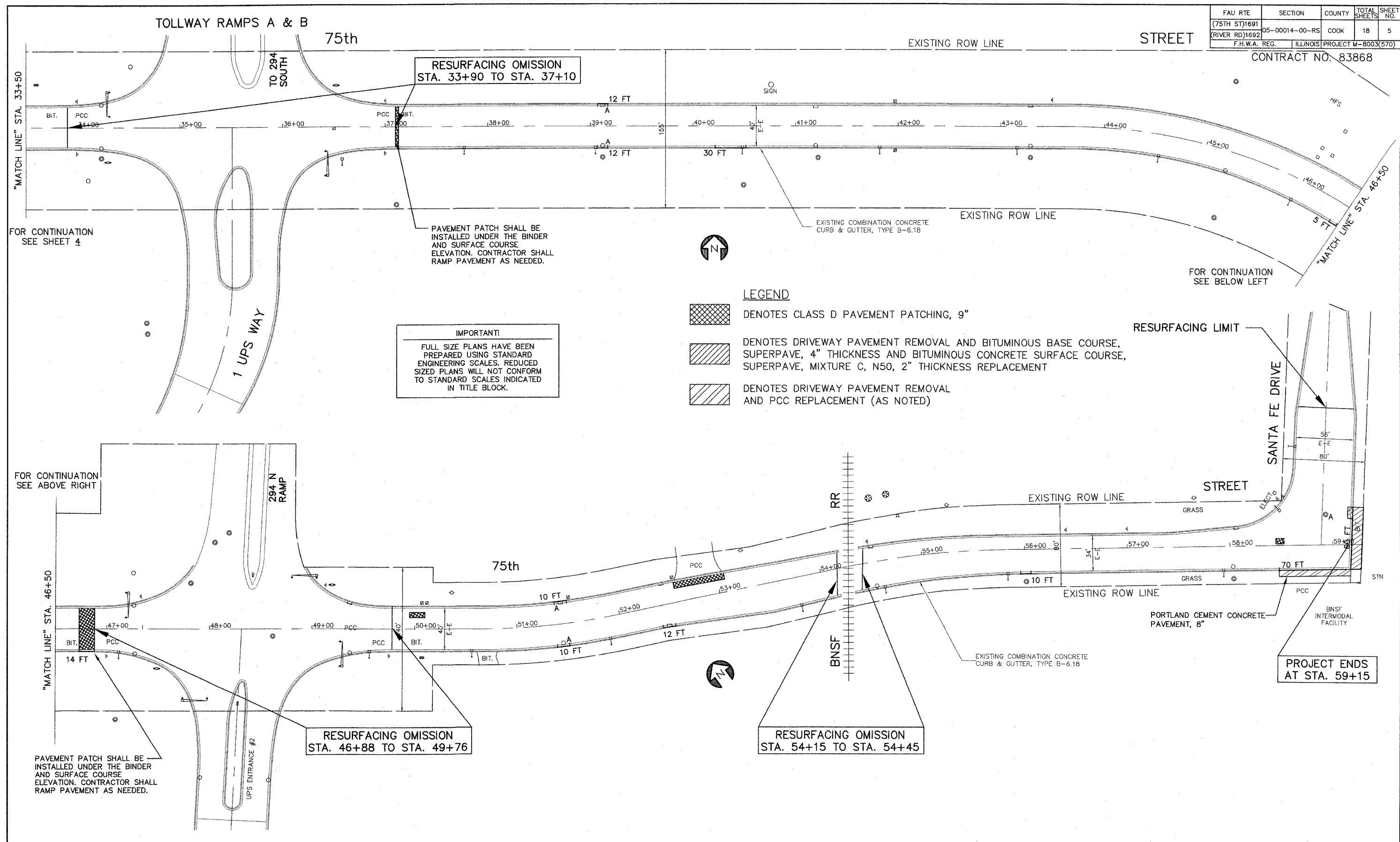

IMPORTANT!
 FULL SIZE PLANS HAVE BEEN PREPARED USING STANDARD ENGINEERING SCALES. REDUCED SIZED PLANS WILL NOT CONFORM TO STANDARD SCALES INDICATED IN TITLE BLOCK.

- LEGEND**
- DENOTES CLASS D PAVEMENT PATCHING, 9"
 - DENOTES DRIVEWAY PAVEMENT REMOVAL AND BITUMINOUS BASE COURSE, SUPERPAVE, 4" THICKNESS AND BITUMINOUS CONCRETE SURFACE COURSE, SUPERPAVE, MIXTURE C, N50, 2" THICKNESS REPLACEMENT
 - DENOTES DRIVEWAY PAVEMENT REMOVAL AND PCC REPLACEMENT (AS NOTED)

FOR CONTINUATION SEE ABOVE RIGHT

"MATCH LINE" STA. 46+50

RESURFACING OMISSION
 STA. 46+88 TO STA. 49+76

RESURFACING OMISSION
 STA. 54+15 TO STA. 54+45

PROJECT ENDS
 AT STA. 59+15

Frank Novotny & Associates, Inc.
 Civil Engineers/Municipal Consultants
 825 Midway Drive ♦ Willowbrook, IL ♦ 60527 ♦ Telephone: (630) 887-8640 ♦ Fax: (630) 887-0132
 Illinois Professional Design Firm No. 184-000928

PROJECT
 VILLAGE OF HODGKINS, ILLINOIS
 75th STREET & RIVER ROAD RESURFACING
 M.F.T. SECTION NO. 05-00014-00-RS

REVISIONS			
NO.	BY	DATE	DESCRIPTION
1	THK	3-29-06	IDOT - DISTRICT 1
2	THK	4-13-06	IDOT - DISTRICT 1
3	JLC	6-27-06	IDOT - DISTRICT 1

PLAN SHEET
 75TH STREET-
 STA. 33+50
 to SANTA FE DRIVE

PROJECT NO. 05084	SCALE 1"=40'	SHEET 5
DRAWN/DESIGNED JEP/THK	DATE NOV., 2005	OF 18
CHECKED/APPROVED CJA/JLC	FIELD BOOK NO. FILE	SHEETS

FAU RTE	SECTION	COUNTY	TOTAL SHEETS	SHEET NO.
(75TH ST)1691	05-00014-00-RS	COOK	18	6
(RIVER RD)1692				
F.H.W.A. REG.	ILLINOIS	PROJECT M-8003(570)		

CONTRACT NO. 83868



STEVENSON (I-55)
EXPRESSWAY
(OVERPASS)

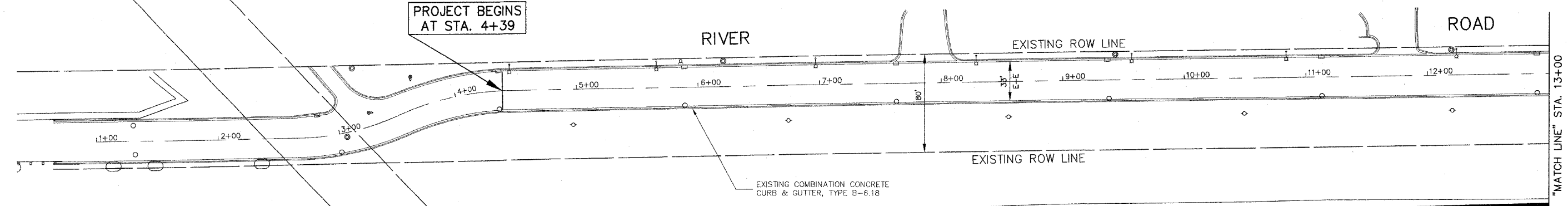

PROJECT BEGINS
AT STA. 4+39



DESPLAINES RIVER SHORELINE

FOR CONTINUATION
SEE BELOW LEFT

LEGEND

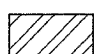
-  DENOTES CLASS D PAVEMENT PATCHING, 9"
-  DENOTES DRIVEWAY PAVEMENT REMOVAL AND BITUMINOUS BASE COURSE, SUPERPAVE, 4" THICKNESS AND BITUMINOUS CONCRETE SURFACE COURSE, SUPERPAVE, MIXTURE C, N50, 2" THICKNESS REPLACEMENT
-  DENOTES DRIVEWAY PAVEMENT REMOVAL AND PCC REPLACEMENT (AS NOTED)

IMPORTANT!
FULL SIZE PLANS HAVE BEEN
PREPARED USING STANDARD
ENGINEERING SCALES. REDUCED
SIZED PLANS WILL NOT CONFORM
TO STANDARD SCALES INDICATED
IN TITLE BLOCK.

HODGKINS VILLAGE LIMITS
(TYPICAL)



FOR CONTINUATION
SEE ABOVE RIGHT

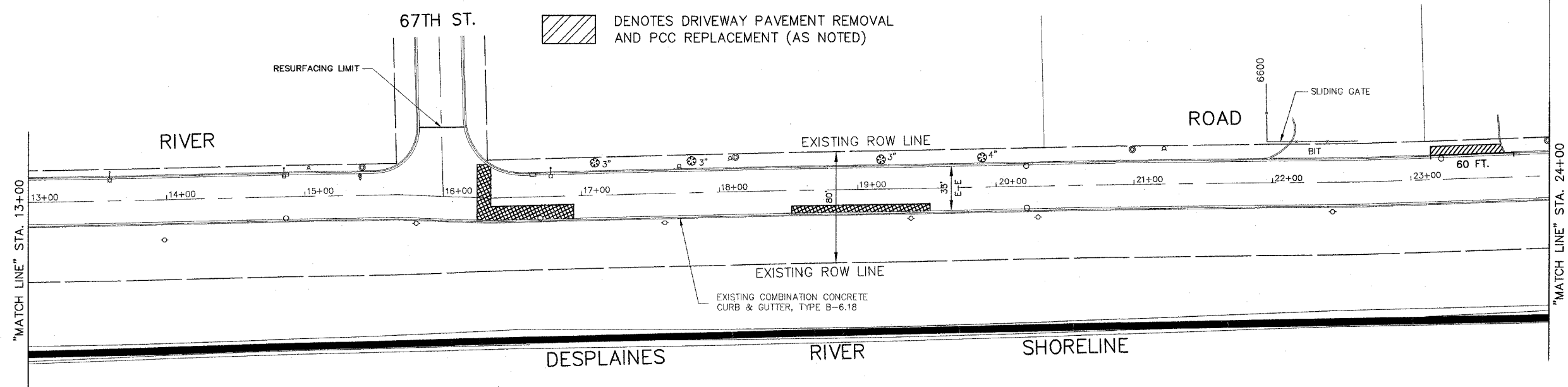

"MATCH LINE" STA. 13+00

"MATCH LINE" STA. 24+00

FOR CONTINUATION
SEE SHEET Z

Frank Novotny & Associates, Inc.
Civil Engineers/
Municipal Consultants
825 Midway Drive • Willowbrook, IL • 60527 • Telephone: (630) 887-8640 • Fax: (630) 887-0132
Illinois Professional Design Firm No. 184-000928

PROJECT
VILLAGE OF HODGKINS, ILLINOIS
75th STREET & RIVER ROAD RESURFACING
M.F.T. SECTION NO. 05-00014-00-RS

REVISIONS			
NO.	BY	DATE	DESCRIPTION
1	THK	3-29-06	IDOT - DISTRICT 1
2	THK	4-13-06	IDOT - DISTRICT 1
3	JLC	6-27-06	IDOT - DISTRICT 1

PLAN SHEET
RIVER ROAD-
STEVENSON EXPRESSWAY
to STA. 24+00

PROJECT NO. 05084	SCALE 1"=40'
DRAWN/DESIGNED JEP/THK	DATE NOV., 2005
CHECKED/APPROVED CJA/JLC	FIELD BOOK NO. FILE

SHEET
6
OF
18
SHEETS

FAU RTE	SECTION	COUNTY	TOTAL SHEETS	SHEET NO.
(75TH ST)1691			18	7
(RIVER RD)1692	05-00014-00-RS	COOK		
F.H.W.A. REG.	ILLINOIS	PROJECT	M-8003(570)	

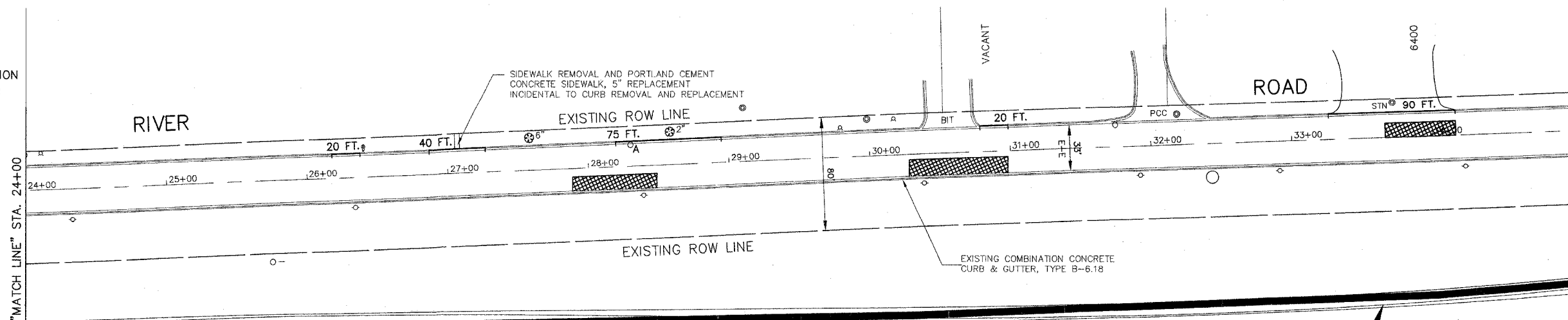

CONTRACT NO. 83868

FOR CONTINUATION
SEE SHEET 6



FOR CONTINUATION
SEE BELOW LEFT

LEGEND

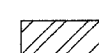
-  DENOTES CLASS D PAVEMENT PATCHING, 9"
-  DENOTES DRIVEWAY PAVEMENT REMOVAL AND BITUMINOUS BASE COURSE, SUPERPAVE, 4" THICKNESS AND BITUMINOUS CONCRETE SURFACE COURSE, SUPERPAVE, MIXTURE C, N50, 2" THICKNESS REPLACEMENT
-  DENOTES DRIVEWAY PAVEMENT REMOVAL AND PCC REPLACEMENT (AS NOTED)

IMPORTANT!
FULL SIZE PLANS HAVE BEEN PREPARED USING STANDARD ENGINEERING SCALES. REDUCED SIZED PLANS WILL NOT CONFORM TO STANDARD SCALES INDICATED IN TITLE BLOCK.

HODGKINS VILLAGE LIMITS (TYPICAL)

FOR CONTINUATION
SEE ABOVE RIGHT

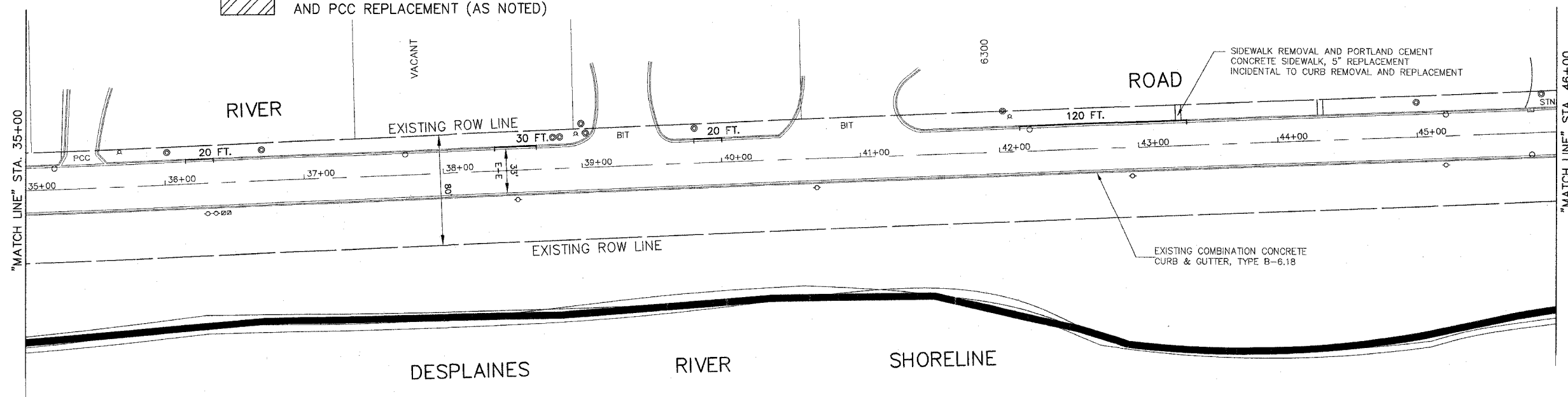

FOR CONTINUATION
SEE SHEET 8

Frank Novotny & Associates, Inc.
Civil Engineers/
Municipal Consultants
825 Midway Drive ♦ Willowbrook, IL ♦ 60527 ♦ Telephone: (630) 887-8640 ♦ Fax: (630) 887-0132
Illinois Professional Design Firm No. 184-000928

PROJECT
VILLAGE OF HODGKINS, ILLINOIS
75th STREET & RIVER ROAD RESURFACING
M.F.T. SECTION NO. 05-00014-00-RS

REVISIONS			
NO.	BY	DATE	DESCRIPTION
1	THK	3-29-06	IDOT - DISTRICT 1
2	THK	4-13-06	IDOT - DISTRICT 1
3	JLC	6-27-06	IDOT - DISTRICT 1

PLAN SHEET
RIVER ROAD-
STA. 24+00 to
STA. 46+00

PROJECT NO. 05084	SCALE 1"=40'	SHEET 7
DRAWN/DESIGNED JEP/THK	DATE NOV., 2005	OF 18
CHECKED/APPROVED CJA/JLC	FIELD BOOK NO. FILE	SHEETS

FAU RTE	SECTION	COUNTY	TOTAL SHEETS	SHEET NO.
(75TH ST)1691 (RIVER RD)1692	05-00014-00-RS	COOK	18	8
F.H.W.A. REG.	ILLINOIS PROJECT M-8003(570)			

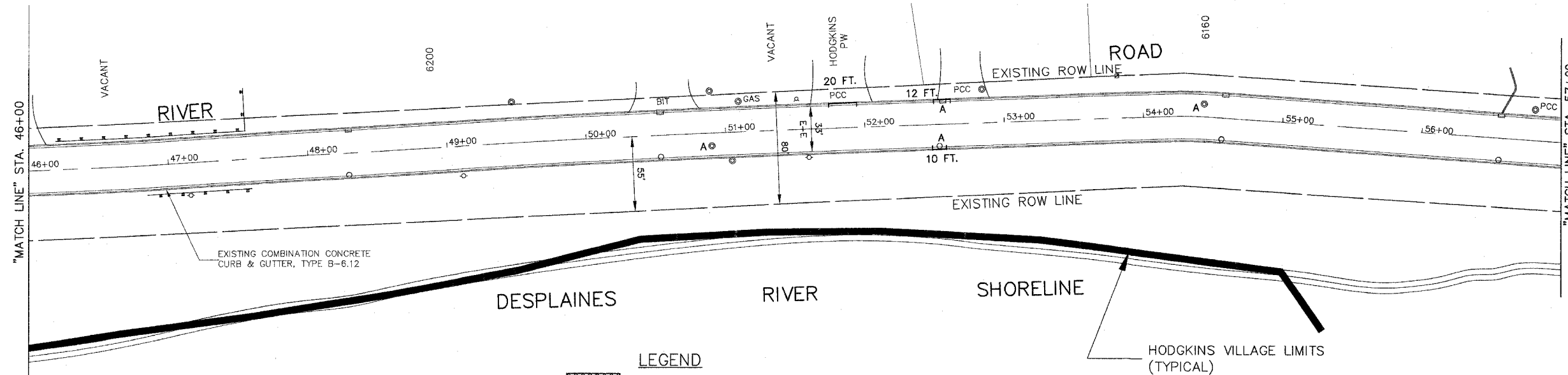

CONTRACT NO. 83868

FOR CONTINUATION
SEE SHEET Z



FOR CONTINUATION
SEE BELOW LEFT

IMPORTANT!
FULL SIZE PLANS HAVE BEEN PREPARED USING STANDARD ENGINEERING SCALES. REDUCED SIZED PLANS WILL NOT CONFORM TO STANDARD SCALES INDICATED IN TITLE BLOCK.

- LEGEND**
-  DENOTES CLASS D PAVEMENT PATCHING, 9"
 -  DENOTES DRIVEWAY PAVEMENT REMOVAL AND BITUMINOUS BASE COURSE, SUPERPAVE, 4" THICKNESS AND BITUMINOUS CONCRETE SURFACE COURSE, SUPERPAVE, MIXTURE C, N50, 2" THICKNESS REPLACEMENT
 -  DENOTES DRIVEWAY PAVEMENT REMOVAL AND PCC REPLACEMENT (AS NOTED)

FOR CONTINUATION
SEE ABOVE RIGHT

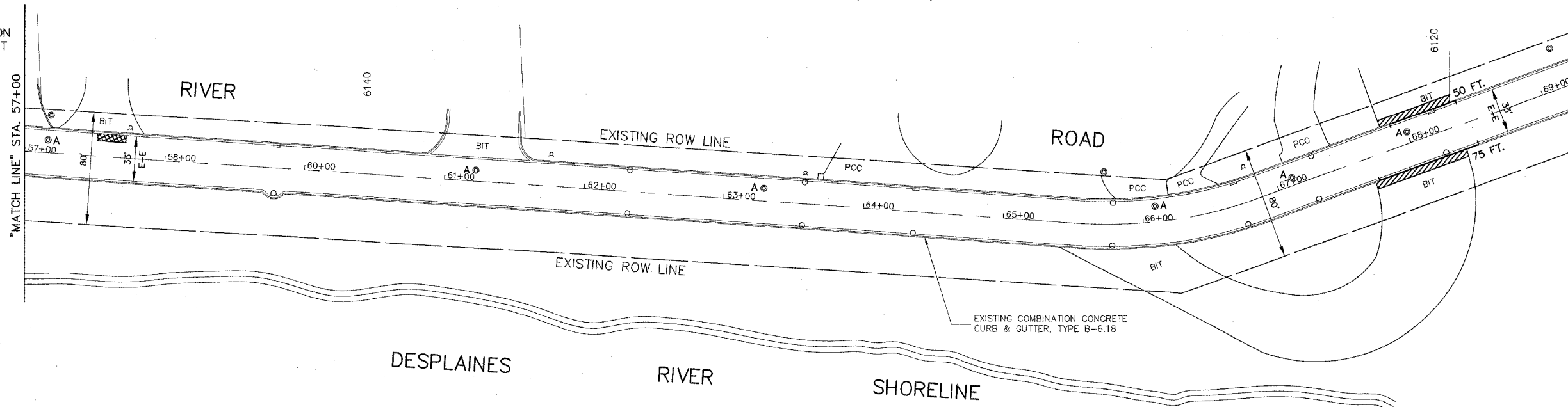

**PROJECT ENDS
AT STA. 69+26**

Frank Novotny & Associates, Inc.
Civil Engineers/
Municipal Consultants
825 Midway Drive ♦ Willowbrook, IL ♦ 60527 ♦ Telephone: (630) 887-8640 ♦ Fax: (630) 887-0132
Illinois Professional Design Firm No. 184-000928

PROJECT VILLAGE OF HODGKINS, ILLINOIS
75th STREET & RIVER ROAD RESURFACING
M.F.T. SECTION NO. 05-00014-00-RS

REVISIONS		
NO.	BY	DATE
1	THK	3-29-06
2	THK	4-13-06
3	JLC	6-27-06

PLAN SHEET
RIVER ROAD-
STA. 46+00 to STA. 69+29
(MWRDGC ROW LINE)

PROJECT NO. 05084	SCALE 1"=40'	SHEET 8
DRAWN/DESIGNED JEP/THK	DATE NOV., 2005	OF 18
CHECKED/APPROVED CJA/JLC	FIELD BOOK NO. FILE	SHEETS

FAU RTE	SECTION	COUNTY	TOTAL SHEETS	SHEET NO.
(75TH ST)1691	05-00014-00-RS	COOK	18	9
(RIVER RD)1692				
F.H.W.A. REG.	ILLINOIS	PROJECT M-8003(570)		

CONTRACT NO. 83868

WILLOW SPRINGS ROAD

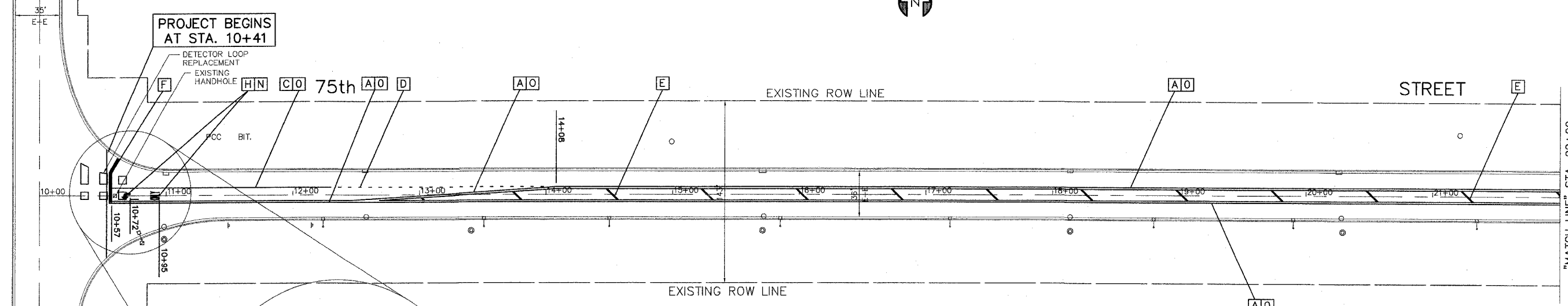

PROJECT BEGINS AT STA. 10+41

THERMOPLASTIC STRIPING CODE

- A DOUBLE SOLID YELLOW THERMOPLASTIC PAVEMENT MARKING - CENTERLINE 4" .11"O/C
- B SOLID WHITE THERMOPLASTIC PAVEMENT MARKING - LINE 6" (EDGE LINE)
- C SOLID WHITE THERMOPLASTIC PAVEMENT MARKING - LINE 6" (LANE LINE)
- D SOLID WHITE THERMOPLASTIC PAVEMENT MARKING - LINE 6", 2' DASH 6' SKIP (LANE LINE)
- E SOLID YELLOW THERMOPLASTIC PAVEMENT MARKING - LINE 12" (DIAGONALS)
- F SOLID WHITE THERMOPLASTIC PAVEMENT MARKING - LINE 24" (STOP BAR)
- G SOLID WHITE THERMOPLASTIC PAVEMENT MARKING - LINE 24" (RAILROAD WARNING & TRANSVERSE LINE)
- H SOLID WHITE THERMOPLASTIC PAVEMENT MARKING - LETTERS & SYMBOLS

PAINT STRIPING CODE

- I PAINT PAVEMENT MARKING - LETTERS & SYMBOLS
- J SOLID WHITE PAINT PAVEMENT MARKING - LINE 4"
- K SOLID WHITE PAINT PAVEMENT MARKING - LINE 6"
- L SOLID WHITE PAINT PAVEMENT MARKING - LINE 12"
- M SOLID WHITE PAINT PAVEMENT MARKING - LINE 24"

SHORT TERM STRIPING CODE

- N SHORT TERM PAVEMENT MARKING - LETTERS & SYMBOLS
- O SHORT TERM PAVEMENT MARKING - LINE 4", 2' DASH 40' SKIP

FOR CONTINUATION SEE BELOW LEFT

FOR CONTINUATION SEE ABOVE RIGHT

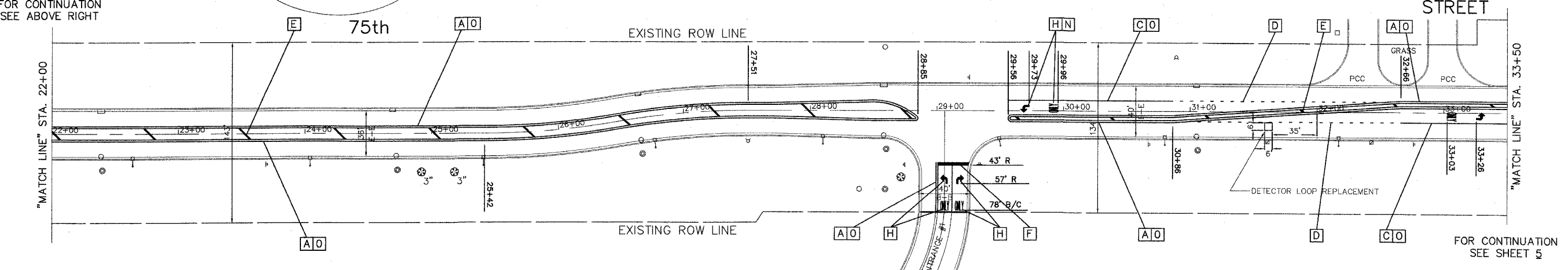

IMPORTANT!
FULL SIZE PLANS HAVE BEEN PREPARED USING STANDARD ENGINEERING SCALES. REDUCED SIZED PLANS WILL NOT CONFORM TO STANDARD SCALES INDICATED IN TITLE BLOCK.

FOR CONTINUATION SEE SHEET 5

Frank Novotny & Associates, Inc.
Civil Engineers/Municipal Consultants
825 Midway Drive • Willowbrook, IL • 60527 • Telephone: (630) 887-8640 • Fax: (630) 887-0132
Illinois Professional Design Firm No. 184-000928

PROJECT VILLAGE OF HODGKINS, ILLINOIS
75th STREET & RIVER ROAD RESURFACING
M.F.T. SECTION NO. 05-00014-00-RS

REVISIONS			
NO.	BY	DATE	DESCRIPTION
1	THK	3-29-06	IDOT - DISTRICT 1
2	THK	4-13-06	IDOT - DISTRICT 1

PAVEMENT MARKING AND DETECTOR LOOP REPLACEMENT
75TH STREET - WILLOW SPRINGS ROAD to STA. 33+50

PROJECT NO. 05084	SCALE 1"=40'
DRAWN/DESIGNED JEP/THK	DATE NOV., 2005
CHECKED/APPROVED CJA/JLC	FIELD BOOK NO. FILE

SHEET 9 OF 18 SHEETS

FAU RTE	SECTION	COUNTY	TOTAL SHEETS	SHEET NO.
(75TH ST)1691	05-00014-00-RS	COOK	18	10
(RIVER RD)1692				
F.H.W.A. REG.	ILLINOIS	PROJECT M-8003(570)		

CONTRACT NO. 83868

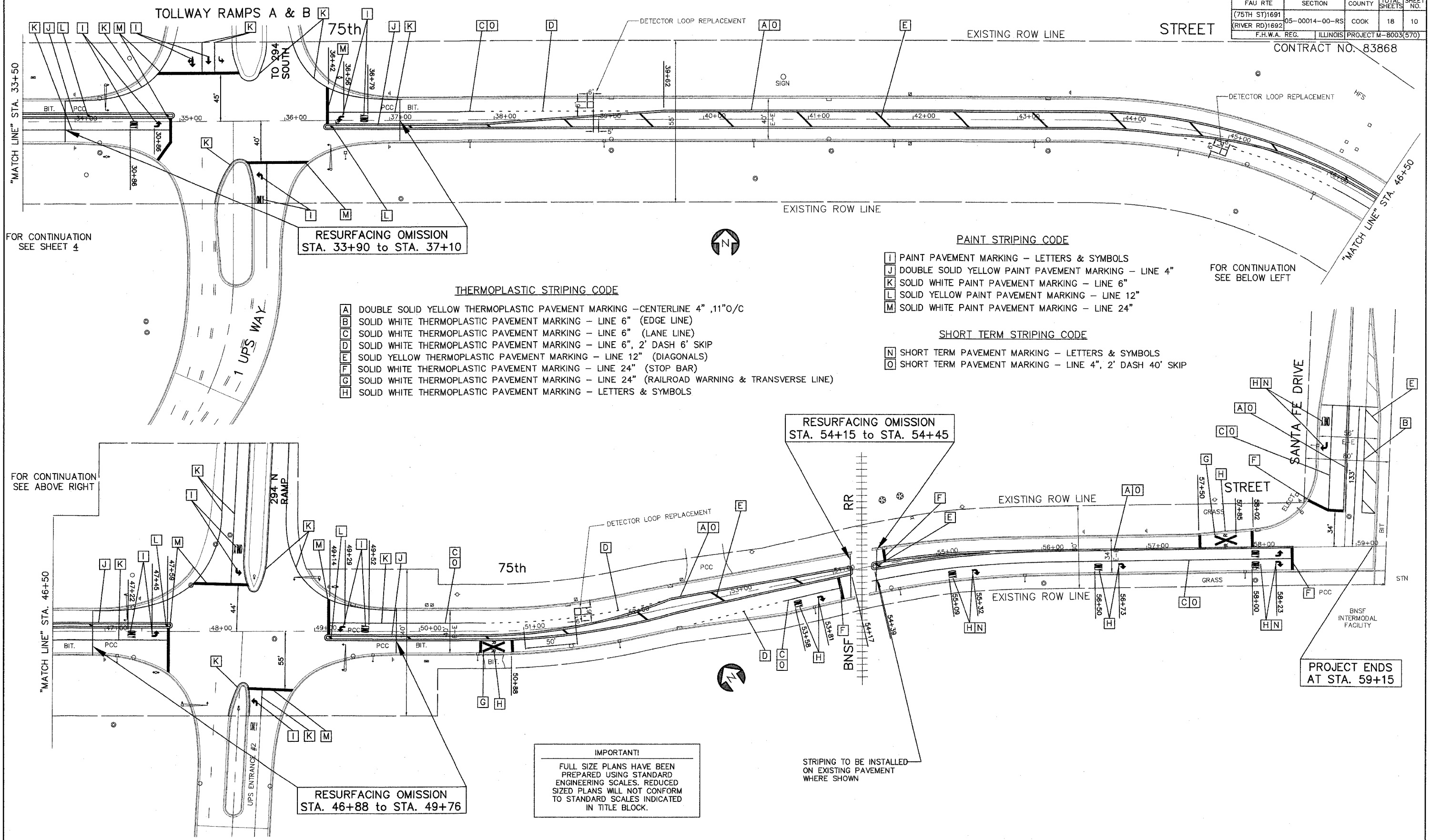

RESURFACING OMISSION
STA. 33+90 to STA. 37+10

RESURFACING OMISSION
STA. 54+15 to STA. 54+45

RESURFACING OMISSION
STA. 46+88 to STA. 49+76

- THERMOPLASTIC STRIPING CODE**
- A DOUBLE SOLID YELLOW THERMOPLASTIC PAVEMENT MARKING - CENTERLINE 4" ,11"O/C
 - B SOLID WHITE THERMOPLASTIC PAVEMENT MARKING - LINE 6" (EDGE LINE)
 - C SOLID WHITE THERMOPLASTIC PAVEMENT MARKING - LINE 6" (LANE LINE)
 - D SOLID WHITE THERMOPLASTIC PAVEMENT MARKING - LINE 6", 2' DASH 6' SKIP
 - E SOLID YELLOW THERMOPLASTIC PAVEMENT MARKING - LINE 12" (DIAGONALS)
 - F SOLID WHITE THERMOPLASTIC PAVEMENT MARKING - LINE 24" (STOP BAR)
 - G SOLID WHITE THERMOPLASTIC PAVEMENT MARKING - LINE 24" (RAILROAD WARNING & TRANSVERSE LINE)
 - H SOLID WHITE THERMOPLASTIC PAVEMENT MARKING - LETTERS & SYMBOLS

- PAINT STRIPING CODE**
- I PAINT PAVEMENT MARKING - LETTERS & SYMBOLS
 - J DOUBLE SOLID YELLOW PAINT PAVEMENT MARKING - LINE 4"
 - K SOLID WHITE PAINT PAVEMENT MARKING - LINE 6"
 - L SOLID YELLOW PAINT PAVEMENT MARKING - LINE 12"
 - M SOLID WHITE PAINT PAVEMENT MARKING - LINE 24"

- SHORT TERM STRIPING CODE**
- N SHORT TERM PAVEMENT MARKING - LETTERS & SYMBOLS
 - O SHORT TERM PAVEMENT MARKING - LINE 4", 2' DASH 40' SKIP

IMPORTANT!
FULL SIZE PLANS HAVE BEEN PREPARED USING STANDARD ENGINEERING SCALES. REDUCED SIZED PLANS WILL NOT CONFORM TO STANDARD SCALES INDICATED IN TITLE BLOCK.

STRIPING TO BE INSTALLED ON EXISTING PAVEMENT WHERE SHOWN

FOR CONTINUATION
SEE SHEET 4

FOR CONTINUATION
SEE BELOW LEFT

FOR CONTINUATION
SEE ABOVE RIGHT

PROJECT ENDS
AT STA. 59+15

Frank Novotny & Associates, Inc.
Civil Engineers/
Municipal Consultants
825 Midway Drive ♦ Willowbrook, IL ♦ 60527 ♦ Telephone: (630) 887-8640 ♦ Fax: (630) 887-0132
Illinois Professional Design Firm No. 184-000928

PROJECT VILLAGE OF HODGKINS, ILLINOIS
75th STREET & RIVER ROAD RESURFACING
M.F.T. SECTION NO. 05-00014-00-RS

REVISIONS			
NO.	BY	DATE	DESCRIPTION
1	THK	3-29-06	IDOT - DISTRICT 1
2	THK	4-13-06	IDOT - DISTRICT 1

PAVEMENT MARKING AND
DETECTOR LOOP REPLACEMENT
75TH STREET -
STA. 33+50
to SANTA FE DRIVE

PROJECT NO. 05084	SCALE 1"=40'	SHEET 10
DRAWN/DESIGNED JEP/THK	DATE NOV., 2005	OF 18
CHECKED/APPROVED CJA/JLC	FIELD BOOK NO. FILE	SHEETS

FAU RTE	SECTION	COUNTY	TOTAL SHEETS	SHEET NO.
(75TH ST)1691	05-00014-00-RS	COOK	18	11
(RIVER RD)1692				
F.H.W.A. REG.	ILLINOIS PROJECT	M-8003(570)		

CONTRACT NO. 83868

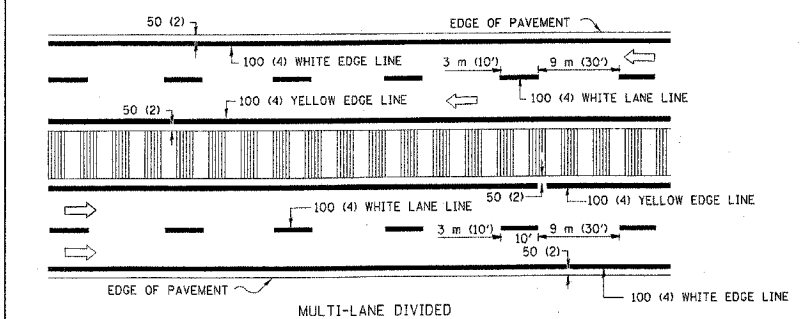
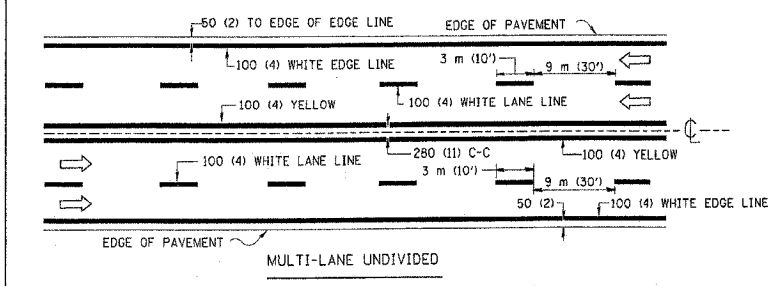
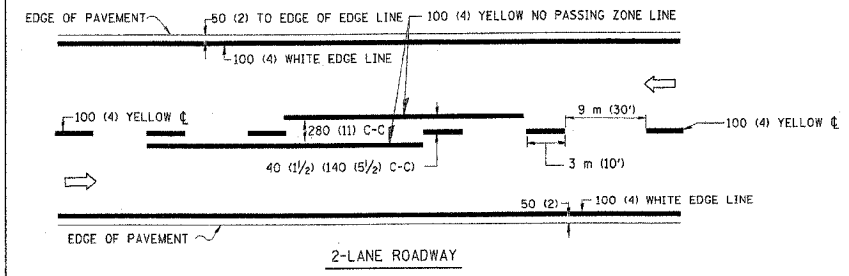

NOTE: MEDIANS WITH BARRIER CURB DO NOT REQUIRE AN EDGE LINE

TYPICAL LANE AND EDGE LINE MARKING

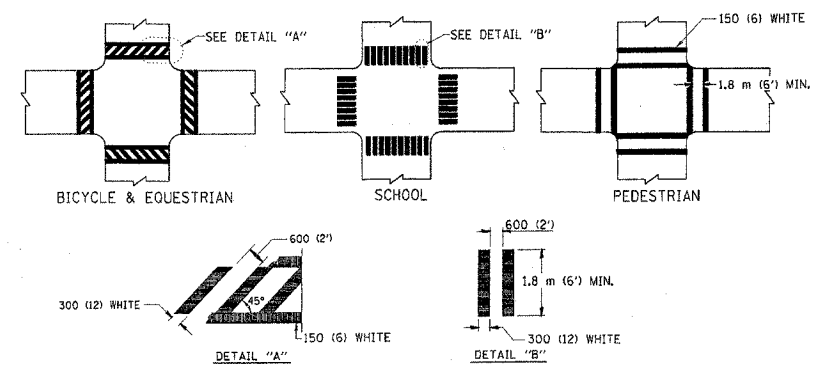

TYPICAL CROSSWALK MARKING

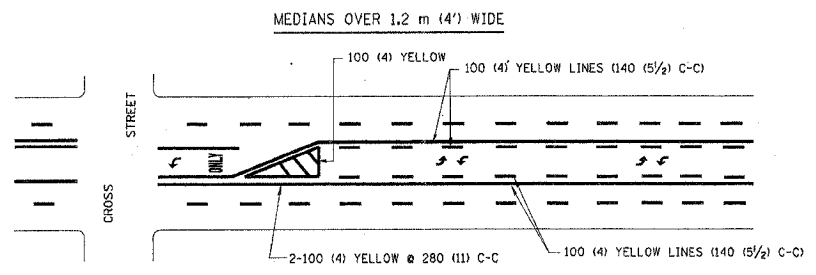
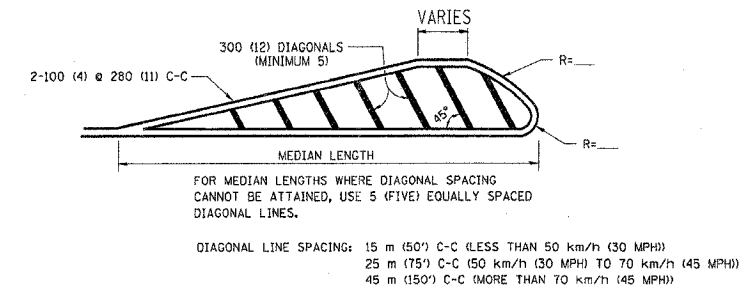
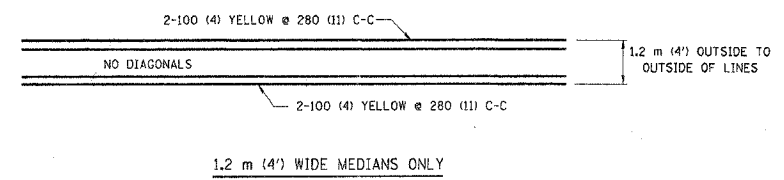

A MINIMUM OF TWO PAIRS OF TURN ARROWS SHALL BE USED, WHITE IN COLOR. ADDITIONAL PAIRS SHALL BE PLACED AT 60 m (200') TO 90 m (300') INTERVALS.

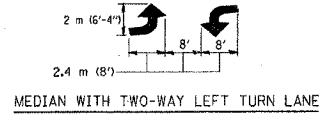

TYPICAL PAINTED MEDIAN MARKING

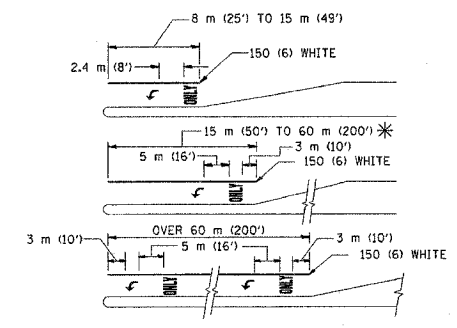

FULL SIZE LETTERS 2.4 m (8') AND ARROWS SHALL BE USED.
AREA = 1.5 m² (15.6 SQ. FT.) ONLY AREA = 1.9 m² (20.8 SQ. FT.)

* TURN LANES IN EXCESS OF 120 m (400') IN LENGTH MAY HAVE AN ADDITIONAL SET OF ARROW - "ONLY" INSTALLED MIDWAY BETWEEN THE OTHER TWO SETS OF ARROW - "ONLY".

TYPICAL LEFT (OR RIGHT) TURN LANE

TYPICAL TURN LANE MARKING

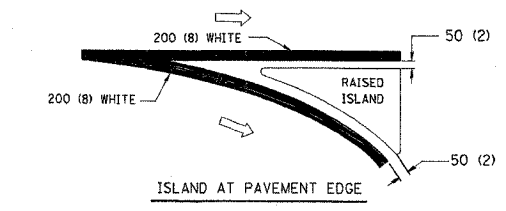
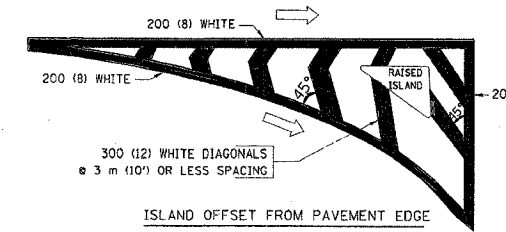

TYPICAL ISLAND MARKING

TYPE OF MARKING	WIDTH OF LINE	PATTERN	COLOR	SPACING / REMARKS
CENTERLINE ON 2 LANE PAVEMENT	100 (4)	SKIP-DASH	YELLOW	3 m (10') LINE WITH 9 m (30') SPACE
CENTERLINE ON MULTI-LANE UNDIVIDED PAVEMENT	2 @ 100 (4)	SOLID	YELLOW	280 (11) C-C
NO PASSING ZONE LINES: FOR ONE DIRECTION FOR BOTH DIRECTIONS	100 (4) 2 @ 100 (4)	SOLID SOLID	YELLOW YELLOW	140 (5 1/2) C-C FROM SKIP-DASH CENTERLINE 280 (11) C-C OMIT SKIP-DASH CENTERLINE BETWEEN
LANE LINES	100 (4) 125 (5) ON FREEWAYS	SKIP-DASH SKIP-DASH	WHITE WHITE	3 m (10') LINE WITH 9 m (30') SPACE
DOTTED LINES (EXTENSIONS OF CENTER, LANE OR TURN LANE MARKINGS)	SAME AS LINE BEING EXTENDED	SKIP-DASH	SAME AS LINE BEING EXTENDED	600 (2') LINE WITH 1.8 m (6') SPACE
EDGE LINES	100 (4)	SOLID	YELLOW-LEFT WHITE-RIGHT	OUTLINE MOUNTABLE MEDIANS IN YELLOW; EDGE LINES ARE NOT USED NEXT TO BARRIER CURB
TURN LANE MARKINGS	150 (6) LINE; FULL SIZE LETTERS & SYMBOLS (2.4 m (8'))	SOLID	WHITE	SEE TYPICAL TURN LANE MARKING DETAIL
TWO WAY LEFT TURN MARKING	2 @ 100 (4) EACH DIRECTION 2.4 m (8') LEFT ARROW	SKIP-DASH AND SOLID IN PAIRS	YELLOW WHITE	3 m (10') LINE WITH 9 m (30') SPACE FOR SKIP-DASH; 140 (5 1/2) C-C BETWEEN SOLID LINE AND SKIP-DASH LINE SEE TYPICAL TWO-WAY LEFT TURN MARKING DETAIL
CROSSWALK LINES (PEDESTRIAN) A. DIAGONALS (BIKE & EQUESTRIAN) B. LONGITUDINAL BARS (SCHOOL)	2 @ 150 (6) 300 (12) @ 45° 300 (12) @ 90°	SOLID SOLID SOLID	WHITE WHITE WHITE	NOT LESS THAN 1.8 m (6') APART 600 (2') APART SEE TYPICAL CROSSWALK MARKING DETAILS.
STOP LINES	600 (24)	SOLID	WHITE	PLACE 1.2 m (4') IN ADVANCE OF AND PARALLEL TO CROSSWALK, IF PRESENT. OTHERWISE, PLACE AT DESIRED STOPPING POINT, PARALLEL TO CROSSROAD CENTERLINE, WHERE POSSIBLE
PAINTED MEDIANS	2 @ 100 (4) WITH 300 (12) DIAGONALS @ 45° NO DIAGONALS USED FOR 1.2 m (4') WIDE MEDIANS	SOLID	YELLOW; TWO WAY TRAFFIC WHITE; ONE WAY TRAFFIC	280 (11) C-C FOR THE DOUBLE LINE SEE TYPICAL PAINTED MEDIAN MARKING.
GORE MARKING AND CHANNELIZING LINES	200 (8) WITH 300 (12) DIAGONALS @ 45°	SOLID	WHITE	DIAGONALS: 4.5 m (15') C-C (LESS THAN 50 km/h (30 MPH)) 6 m (20') C-C (50 km/h (30 MPH) TO 70 km/h (45 MPH)) 9 m (30') C-C (OVER 70 km/h (45 MPH))
RAILROAD CROSSING	600 (24) TRANSVERSE LINES; "RR" IS 1.8 m (6') LETTERS; 400 (16) LINE FOR "X"	SOLID	WHITE	SEE STATE STANDARD 780001 AREA OF: "R"=0.33m ² (3.6 SQ. FT.) EACH "X"=5.0 m ² (54.0 SQ. FT.)
SHOULDER DIAGONALS	300 (12) @ 45°	SOLID	WHITE - RIGHT YELLOW - LEFT	15 m (50') C-C (LESS THAN 50 km/h (30 MPH)) 25 m (75') C-C (50 km/h (30 MPH) TO 70 km/h (45 MPH)) 45 m (150') C-C (OVER 70 km/h (45 MPH))

FOR FURTHER DETAILS ON PAVEMENT MARKING REFER TO STANDARD SPECIFICATIONS FOR ROAD AND BRIDGE CONSTRUCTION ADOPTED JANUARY 1, 1997 AND STATE STANDARD 780001.

	LARGE SIZE	SMALL SIZE
THROUGH ARROW	1.07 (11.5)	0.60 (6.5)
LEFT OF RIGHT ARROW	1.47 (15.6)	0.60 (6.5)
COMBINATION LEFT (RIGHT) AND THROUGH ARROW	2.42 (26.0)	1.37 (14.7)
RAILROAD "R"	0.33 (3.6)	-
RAILROAD "X"	5.02(54.0)	-
HANDICAPPED SYMBOL	0.43 (4.8)	-

REVISIONS	
NAME	DATE
EVERS	03-19-90
T. RAMMACHER	10-27-94
ALEX HOUSEH	10-09-96
ALEX HOUSEH	10-17-96
T. RAMMACHER	01-06-00

All dimensions are in millimeters (inches) unless otherwise shown.

ILLINOIS DEPARTMENT OF TRANSPORTATION
DISTRICT ONE
TYPICAL PAVEMENT MARKINGS

SCALE: NONE
DATE 2/2/01
DRAWN BY CAOD
CHECKED BY

TC-13

Frank Novotny & Associates, Inc.
Civil Engineers/Municipal Consultants
825 Midway Drive ♦ Willowbrook, IL ♦ 60527 ♦ Telephone: (630) 887-8640 ♦ Fax: (630) 887-0132
Illinois Professional Design Firm No. 184-000928

PROJECT
VILLAGE OF HODGKINS, ILLINOIS
75th STREET & RIVER ROAD RESURFACING
M.F.T. SECTION NO. 05-00014-00-RS

REVISIONS			
NO.	BY	DATE	DESCRIPTION
1	THK	3-29-06	IDOT - DISTRICT 1
2	THK	4-13-06	IDOT - DISTRICT 1

PAVEMENT MARKING STANDARDS

PROJECT NO. 05084	SCALE NONE	SHEET 11
DRAWN/DESIGNED JEP/THK	DATE NOV., 2005	OF 18
CHECKED/APPROVED THK/JLC	FIELD BOOK NO. FILE	SHEETS

FAU RTE	SECTION	COUNTY	TOTAL SHEETS	SHEET NO.
(75TH ST)1691	05-00014-00-RS	COOK	18	12
(RIVER RD)1692				
F.H.W.A. REG.		ILLINOIS	PROJECT M-8003(570)	

CONTRACT NO. 83868

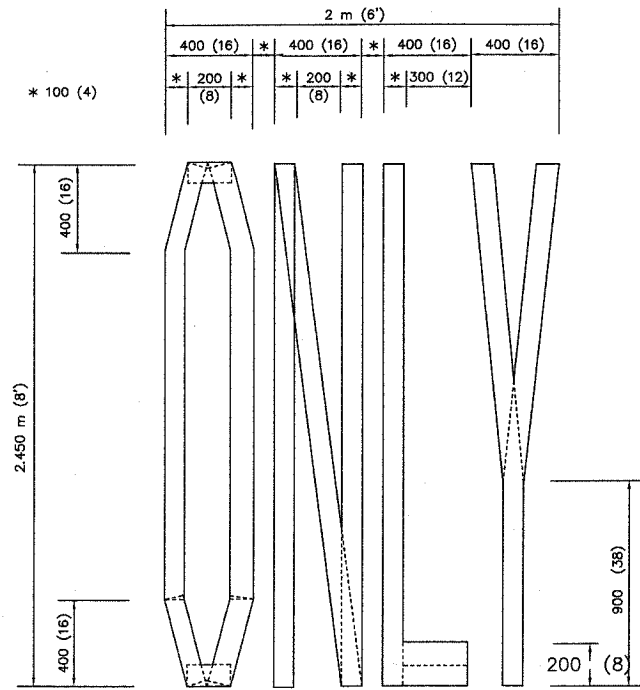

QUANTITY
 100 (4) LINE = 19.7 m (641.1 ft.)
 1.97 sq. m (21.1 sq. ft.)

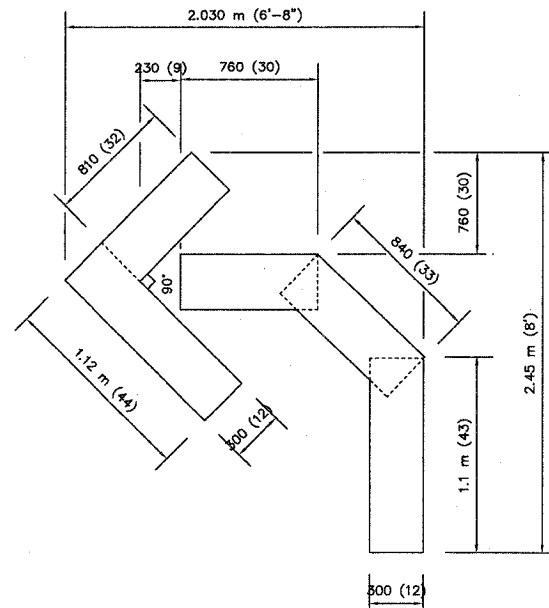

QUANTITY
 100 (4) LINE = 13.9 m (45.5 ft.)
 1.39 sq. m (15.2 sq. ft.)

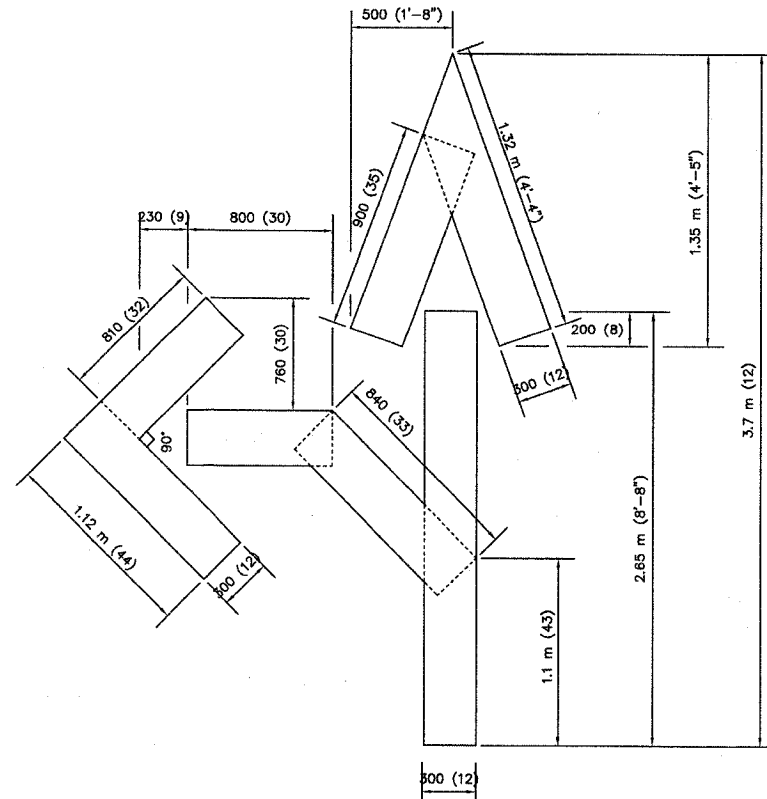

QUANTITY
 100 (4) LINE = 25.3 m (82.5 ft.)
 2.53 sq. m (27.5 sq. ft.)

All dimensions are in millimeters (inches)
 unless otherwise shown

ILLINOIS DEPARTMENT OF TRANSPORTATION
 TEMPORARY PAVEMENT MARKING
 LETTERS AND SYMBOLS

REVISIONS		
NO.	BY	DATE
1	THK	3-29-06
2	THK	4-13-06

SCALE: NONE
 DATE 08/19/99
 DRAWN BY CADD
 CHECKED BY

REVISIONS			
NO.	BY	DATE	DESCRIPTION
1	THK	3-29-06	IDOT - DISTRICT 1
2	THK	4-13-06	IDOT - DISTRICT 1

FAU RTE	SECTION	COUNTY	TOTAL SHEETS	SHEET NO.
(75TH ST)1691	05-00014-00-RS	COOK	18	13
(RIVER RD)1692				
F.H.W.A. REG.	ILLINOIS	PROJECT	M-8003(570)	

CONTRACT NO. 83868

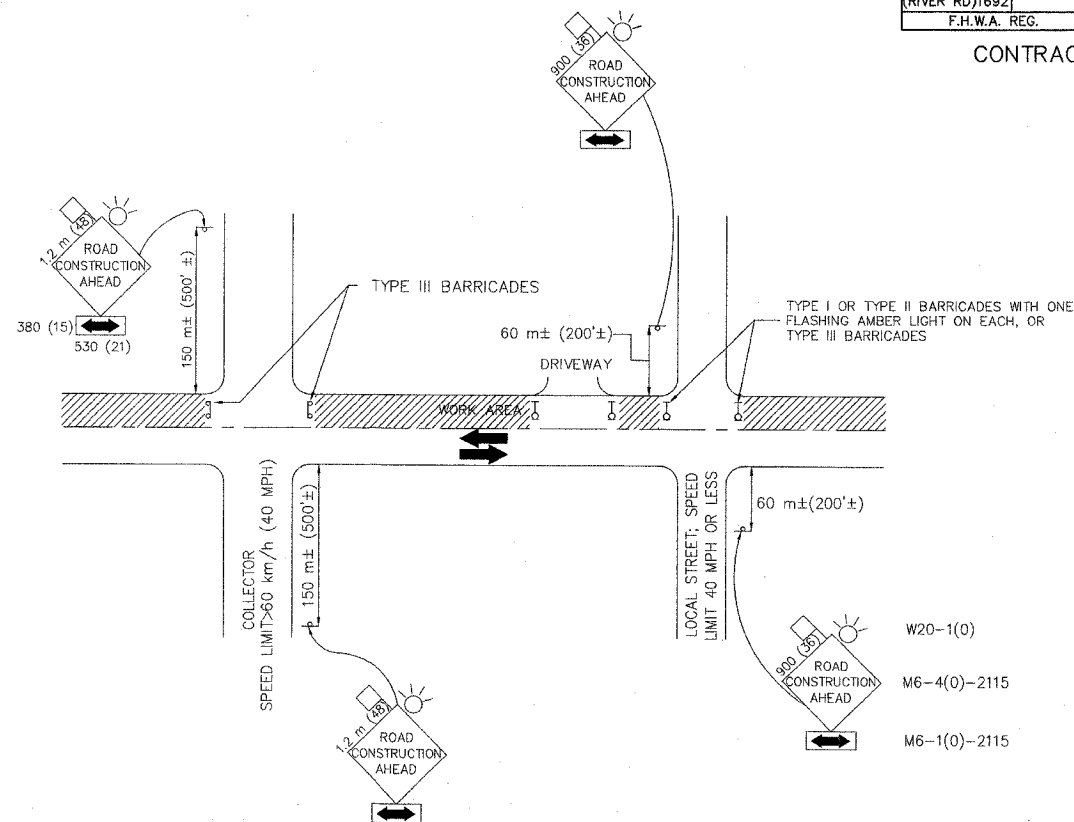

TRAFFIC CONTROL AND PROTECTION FOR SIDE ROADS, INTERSECTIONS, AND DRIVEWAYS

NOTES:

A. FOR NO LANE RESTRICTION ON THE SIDE ROAD OR DRIVEWAYS

- SIDE ROAD WITH A SPEED LIMIT OF 60 km/h (40 MPH) OR LESS AS SHOWN ON THE DRAWING AND AS DIRECTED BY THE ENGINEER:
 - ONE **ROAD CONSTRUCTION AHEAD** SIGN 900x900 (36x36) WITH A FLASHER AND FLAG MOUNTED ON IT APPROXIMATELY 60 m (200') IN ADVANCE OF THE MAIN ROUTE.
 - THE CLOSED PORTION OF THE MAIN ROUTE SHALL BE PROTECTED BY BLOCKING WITH TYPE I, TYPE II OR TYPE III BARRICADES, 1/3 OF THE CROSS SECTION OF THE CLOSED PORTION.
- SIDE ROAD WITH A SPEED LIMIT GREATER THAN 60 km/h (40 MPH) AS SHOWN ON THE DRAWING AND AS DIRECTED BY THE ENGINEER:
 - ONE **ROAD CONSTRUCTION AHEAD** SIGN 1.2 m x 1.2 m (48x48) WITH A FLASHER MOUNTED ON IT APPROXIMATELY 150 m (500') IN ADVANCE OF THE MAIN ROUTE.
 - THE CLOSED PORTION OF THE MAIN ROUTE SHALL BE PROTECTED BY BLOCKING WITH TYPE III BARRICADES, 1/2 OF THE CROSS SECTION OF THE CLOSED PORTION.
- WHEN THE SIDE ROAD LIES BETWEEN THE BEGINNING OF THE MAINLINE SIGNING AND THE WORK ZONE. A SINGLE HEADED ARROW (M6-1) SHALL BE USED IN LIEU OF THE DOUBLE HEADED ARROW (M6-4).

B. FOR A LANE CLOSURE ON A SIDE ROAD OR DRIVEWAY:

- USE APPLICABLE PORTIONS OF THE TYPICAL APPLICATION OF TRAFFIC CONTROL DEVICES (STD. 701501, STD. 701606 OR THE APPROPRIATE STANDARD). THE SPACING OF SIGNS AND BARRICADES SHALL BE ADJUSTED FOR FIELD CONDITIONS AS DIRECTED BY THE ENGINEER. THE DIRECTIONAL ARROW SHALL BE COVERED OR REMOVED WHEN NO LONGER CONSISTENT WITH THE SIDE ROAD LANE CLOSURE.
- ADVANCE WARNING SIGNS ARE TO BE OMITTED ON DRIVEWAY UNLESS OTHERWISE NOTED.
 - THE TRAFFIC CONTROL AND PROTECTION FOR SIDE ROADS, INTERSECTIONS, AND DRIVEWAYS SHALL BE INCLUDED IN THE COST OF SPECIFIED TRAFFIC CONTROL STANDARDS OR ITEMS.

All dimensions are in millimeters (inches) unless otherwise shown

ILLINOIS DEPARTMENT OF TRANSPORTATION

TRAFFIC CONTROL & PROTECTION FOR SIDE ROADS, INTERSECTIONS, & DRIVEWAYS

SCALE: NONE DRAWN BY CADD
DATE 08/19/99 CHECKED BY

REVISIONS	
NO.	DATE
1	6/89
T. RAMMACHER	09/08/94
J. OBERLE	10/18/95
A. HOUSEH	03/06/96
A. HOUSEH	10/15/98

Frank Novotny & Associates, Inc.
Civil Engineers/Municipal Consultants
825 Midway Drive • Willowbrook, IL • 60527 • Telephone: (630) 887-8640 • Fax: (630) 887-0132
Illinois Professional Design Firm No. 184-000928

PROJECT VILLAGE OF HODGKINS, ILLINOIS
75th STREET & RIVER ROAD RESURFACING
M.F.T. SECTION NO. 05-00014-00-RS

REVISIONS			
NO.	BY	DATE	DESCRIPTION
1	THK	3-29-06	IDOT - DISTRICT 1
2	THK	4-13-06	IDOT - DISTRICT 1

TRAFFIC CONTROL & PROTECTION FOR SIDE ROADS, INTERSECTIONS, & DRIVEWAYS

PROJECT NO. 05084	SCALE NONE	SHEET 13
DRAWN/DESIGNED JEP/THK	DATE NOV., 2005	OF 18
CHECKED/APPROVED THK/JLC	FIELD BOOK NO. FILE	SHEETS

FAU RTE	SECTION	COUNTY	TOTAL SHEETS	SHEET NO.
(75TH ST)1691 (RIVER RD)1692	05-00014-00-RS	COOK	18	14
F.H.W.A. REG.		ILLINOIS	PROJECT M-8003(570)	

CONTRACT NO. 83868

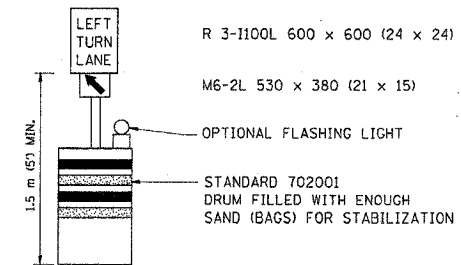
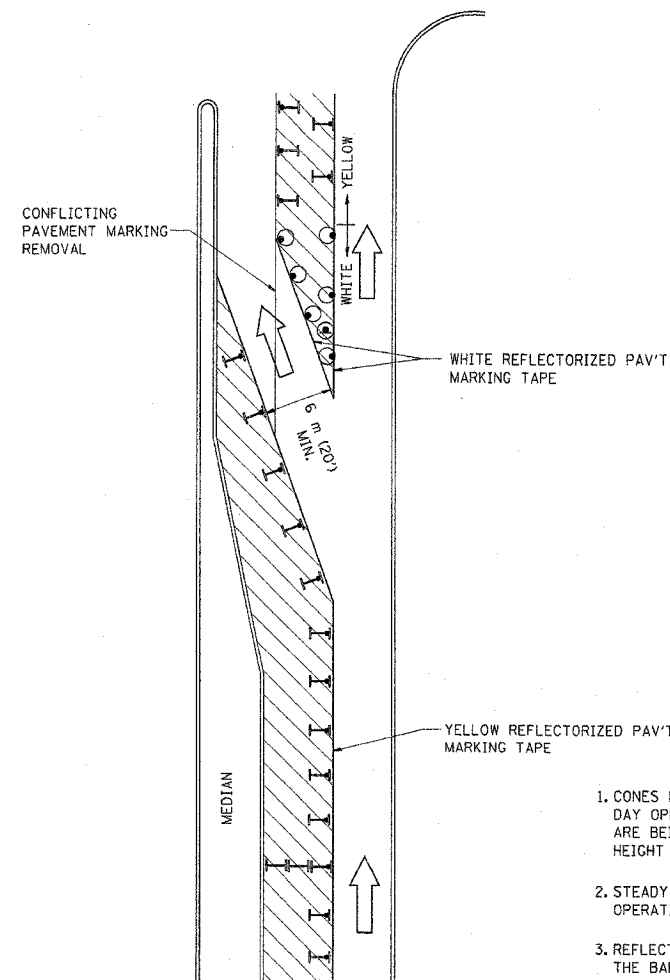

GENERAL NOTES

1. CONES MAY BE SUBSTITUTED FOR BARRICADES OR DRUMS AT HALF THE SPACING DURING DAY OPERATIONS. CONES SHALL BE A MINIMUM OF 710 (28) IN HEIGHT. WHEN CONES ARE BEING USED, THE "LEFT TURN LANE" SIGN MAY BE SKID MOUNTED AT A MINIMUM HEIGHT OF 1.5 m (5').
2. STEADY BURNING LIGHTS WILL NOT BE REQUIRED ON BARRICADES OR DRUMS FOR DAY OPERATIONS. ALL LIGHTS SHALL BE MONODIRECTIONAL.
3. REFLECTORIZED TEMPORARY PAVEMENT MARKING TAPE SHALL BE PLACED THROUGHOUT THE BARRICADED AREA OF EACH TURN BAY WHERE THE CLOSURE TIME IS GREATER THAN FOURTEEN DAYS.
4. THIS APPLICATION ALSO APPLIES WHEN WORK IS BEING PERFORMED IN THE RIGHT LANE(S) AND THE RIGHT TURN BAY IS TO REMAIN OPEN. UNDER THIS CONDITION, "RIGHT TURN LANE" R3-100 600 x 600 (24 x 24) AND M6-2R 530 x 380 (21 x 15) SHALL BE USED.
5. THESE CONTROLS SHALL SUPPLEMENT MAINLINE TRAFFIC CONTROL FOR LANE CLOSURES.
6. LONGITUDINAL DIMENSIONS MAY BE ADJUSTED TO FIT FIELD CONDITIONS.
7. FORM BT 725 IS REQUIRED.
8. TRAFFIC CONTROL AND PROTECTION AT TURN BAYS (TO REMAIN OPEN TO TRAFFIC) SHALL BE INCLUDED IN THE COST SPECIFIED TRAFFIC CONTROL STANDARDS OR ITEMS.

LEGEND

- WORK AREA
- LANE OPEN TO TRAFFIC
- TYPE I OR II BARRICADE WITH STEADY BURN LIGHT
- DRUM WITH STEADY BURN LIGHT
- DRUM WITH SIGN (WITH OPTIONAL FLASHING LIGHT) SEE DETAIL
- TYPE I OR II CHECK BARRICADE WITH FLASHING LIGHT

All dimensions are in millimeters (inches) unless otherwise shown.

ILLINOIS DEPARTMENT OF TRANSPORTATION
TRAFFIC CONTROL AND PROTECTION
AT TURN BAYS
(TO REMAIN OPEN TO TRAFFIC)

REVISIONS	
NO.	DATE
T. RAMMACHER	09/08/94
A. HOUSEH	11/07/95
A. HOUSEH	10/12/96
T. RAMMACHER	01/06/00

SCALE: NONE
DATE: 2/2/01

DRAWN BY: LHA
CHECKED BY: LHA

TC-14

F:\Feb 2 11:03:1 2001
\\diceddl\projects\diststd\vc14.dgn LV:35
V1=TC14

REVISIONS			
NO.	BY	DATE	DESCRIPTION
1	THK	3-29-06	IDOT - DISTRICT 1
2	THK	4-13-06	IDOT - DISTRICT 1

PROJECT NO. 05084	SCALE NONE
DRAWN/DESIGNED JFP/JLC	DATE NOV., 2005
CHECKED/APPROVED JLC	FIELD BOOK NO. FILE

FAU RTE	SECTION	COUNTY	TOTAL SHEETS	SHEET NO.
(75TH ST)1691	05-00014-00-RS	COOK	18	15
(RIVER RD)1692				
F.H.W.A. REG.	ILLINOIS PROJECT M-8003(570)			

CONTRACT NO. 83868

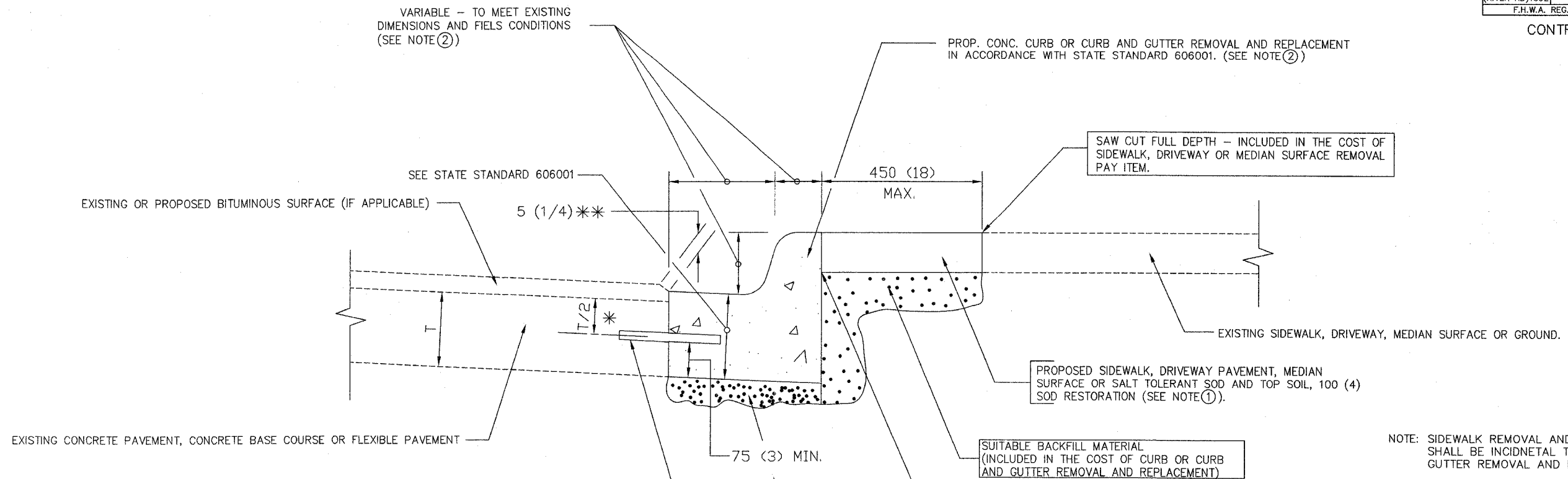

- * 75 (3) MINIMUM FROM TOP AND BOTTOM OF THE CONCRETE PAVEMENT OR BASE COURSE.
- * * IF THE FINAL SURFACE OF THE PAVEMENT IS CONCRETE, THE GUTTER IS TO BE FLUSH WITH THE PAVEMENT.

NOTE: ① DRIVEWAY PAVEMENT OR MEDIAN SURFACE SHALL BE SIMILAR TO THE MATERIAL BEING REMOVED AND WILL BE PAID FOR SEPARATELY.

~~SALT TOLERANT SOD (AND) TOP SOIL, 100 (4) RESTORATION WILL NOT BE PAID FOR SEPARATELY, BUT SHALL BE INCLUDED IN THE COST OF CURB OR CURB AND GUTTER REMOVAL AND REPLACEMENT.~~

- ② CURB OR CURB AND GUTTER REPLACEMENT SHALL MATCH THE SHARE OF THE EXISTING CURB OR CURB AND GUTTER UNLESS OTHERWISE SPECIFIED.
- ③ FOR CURB OR CURB AND GUTTER REMOVAL AND REPLACEMENT ADJACENT TO FLEXIBLE PAVEMENT DELETE EPOXY COATED TIE BARS.
- ④ LONGITUDINAL BARS IF ENCOUNTERED IN THE EXISTING CURB OR CURB AND GUTTER, ARE NOT TO BE REPLACE. CUTTING AND REMOVING LONGITUDINAL BARS SHALL BE INCLUDED IN THE COST OF CURB OR CURB AND GUTTER REMOVAL AND REPLACEMENT.
- ⑤ THE COST OF BITUMINOUS SURFACE REMOVAL IN THE EXISTING GUTTER FLAG SHALL BE INCLUDED IN THE COST OF THE CURB AND GUTTER REMOVAL AND REPLACEMENT.

UNSUITABLE SUB-BASE MATERIAL TO BE REMOVED, IF DIRECTED BY THE ENGINEER, SHALL BE REPLACE WITH EITHER SUB-BASE GRANULAR MATERIAL, TYPE B OR ADDITIONAL THICKNESS OF CONCRETE.

REMOVAL AND REPLACEMENT 100 (4) OR LESS IS INCLUDED IN THE COST OF CURB AND CURB AND GUTTER REMOVAL AND REPLACEMENT.

REMOVAL AND REPLACEMENT IN EXCESS OF 100 (4) WILL BE PAID FOR IN ACCORDANCE WITH ARTICLE 109.04 OF THE STANDARD SPECIFICATIONS.

PROPOSED NO. 20 (NO. 6) EPOXY COATED TIE BARS 600 (24) LONG AT 600 (24) CENTERS WILL NOT BE PAID FOR SEPARATELY. DELETE EPOXY COATED TIE BARS IF EXISTING TIE BARS ARE USUABLE AS DETERMINED BY THE ENGINEER. (SEE NOTE ③).

BASIS OF PAYMENT:

THIS WORK WILL BE PAID FOR AT THE CONTRACT PRICE PER METER (FOOT) FOR "CURB REMOVAL AND REPLACEMENT" OR "COMBINATION CONCRETE CURB AND GUTTER REMOVAL AND REPLACEMENT".

NOTE: SIDEWALK REMOVAL AND REPLACEMENT SHALL BE INCIDENTAL TO CURB AND GUTTER REMOVAL AND REPLACEMENT

All dimensions are in millimeters (inches) unless otherwise shown

CURB OR CURB AND GUTTER REMOVAL AND REPLACEMENT

REVISIONS	
NAME	DATE
M. DE YONG	05/28/91
A. HOUSEH	03/11/94
R. SHAH	02/24/95
R. SHAH	03/02/95
R. SHAH	08/19/95
R. SHAH	09/12/95
R. SHAH	09/19/96
R. SHAH	10/03/96
A. ABBAS	03/21/97

ILLINOIS DEPARTMENT OF TRANSPORTATION
CURB OR CURB AND GUTTER
REMOVAL & REPLACEMENT

SCALE: NONE
DATE 08/19/99

DRAWN BY CADD
CHECKED BY

REVISIONS			
NO.	BY	DATE	DESCRIPTION
1	THK	3-29-06	IDOT - DISTRICT 1
2	THK	4-13-06	IDOT - DISTRICT 1

FAU RTE	SECTION	COUNTY	TOTAL SHEETS	SHEET NO.
(75TH ST)1691	05-00014-00-RS	COOK	18	16
(RIVER RD)1692				
F.H.W.A. REG.		ILLINOIS PROJECT M-8003(570)		

CONTRACT NO. 83868

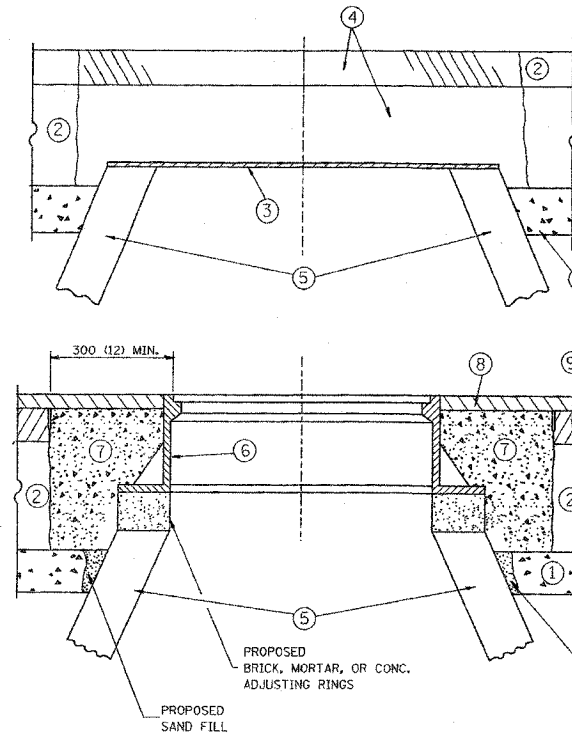

CONSTRUCTION PROCEDURES

STAGE 1 (BEFORE PAVEMENT MILLING)

- A) REMOVE A MINIMUM OF 300 (12) OF THE PAVEMENT FROM AROUND THE STRUCTURE.
- B) REMOVE THE EXISTING FRAME AND LID FROM THE STRUCTURE.
- C) COVER THE STRUCTURE OPENING WITH A 900 (36) DIAMETER METAL PLATE.
- D) BACKFILL WITH CRUSHED STONE AND A MINIMUM 40 (1 1/2) THICK BITUMINOUS MATERIAL APPROVED BY THE ENGINEER.

STAGE 2 (AFTER PAVEMENT MILLING)

- A) REMOVE THE BITUMINOUS MATERIAL AND CRUSHED STONE.
- B) INSTALL THE FRAME AND LID; ADJUST THE FRAME TO ITS FINAL SURFACE ELEVATION.
- C) THE SURROUNDING SPACE SHALL BE FILLED WITH CLASS S1 CONCRETE, OR BITUMINOUS CONCRETE SURFACE OR BINDER COURSE MATERIAL TO THE ELEVATION OF THE SURFACE OF THE EXISTING BASE COURSE OR THE BINDER COURSE.

THE PROCEDURE EXPLAINED ABOVE SHALL CONFORM TO THE APPLICABLE PORTIONS OF SECTIONS 553, 406, 602, AND 603 OF THE STANDARD SPECIFICATIONS.

LEGEND

- ① SUB-BASE GRANULAR MATERIAL
- ② EXISTING PAVEMENT
- ③ 900 (36) DIAMETER METAL PLATE
- ④ PROPOSED CRUSHED STONE AND BITUMINOUS MATERIAL
- ⑤ EXISTING STRUCTURE
- ⑥ FRAME AND LID (SEE NOTES)
- ⑦ CLASS S1 CONCRETE, BITUMINOUS CONCRETE SURFACE OR BINDER COURSE MATERIAL
- ⑧ PROPOSED BITUMINOUS CONCRETE SURFACE COURSE
- ⑨ PROPOSED BITUMINOUS CONCRETE BINDER COURSE

NOTES:

EXISTING BROKEN FRAMES AND LIDS SHALL BE REMOVED AND DISPOSED OF BY THE CONTRACTOR AND SHALL BE REPLACED AS DIRECTED BY THE ENGINEER. REPLACEMENT FRAMES AND LIDS WILL BE PAID FOR IN ACCORDANCE WITH ARTICLE 109.04 OF THE STANDARD SPECIFICATIONS UNLESS A SEPARATE PAY ITEM HAS BEEN PROVIDED.

IF THE EXISTING LIDS ARE OPEN, THE FRAME WILL BE ADJUSTED TO THE ELEVATION OF THE MILLED PAVEMENT SURFACE PRIOR TO THE MILLING OPERATION. THE FRAME WILL NOT BE REMOVED AND COVERED BY THE METAL PLATE.

CITY OF CHICAGO CASTINGS ARE THE PROPERTY OF THE CITY AND THE CONTRACTOR SHALL NOTIFY THE CITY FOR REMOVAL AND DISPOSITION OF THE CASTINGS.

THE METAL PLATE USED TO COVER THE STRUCTURE SHALL REMAIN THE PROPERTY OF THE CONTRACTOR.

WHEN STRUCTURES ARE TO BE RECONSTRUCTED, THE LOWERING AND RAISING OF THE FRAMES AND LIDS WILL NOT BE PAID FOR SEPARATELY BUT WILL BE INCLUDED IN THE COST OF THE RECONSTRUCTION PAY ITEM.

LOCATION OF STRUCTURES:

THE CONTRACTOR WILL BE REQUIRED TO KEEP A RECORD OF THE LOCATIONS OF THE BURIED STRUCTURES ACCORDING TO THE STATION AND DISTANCE LEFT OR RIGHT OF THE CENTERLINE OF PAVEMENT. UPON COMPLETION OF THE WORK, THE CONTRACTOR WILL DELIVER THE RECORD TO THE ENGINEER.

BASIS OF PAYMENT: FRAMES AND LIDS TO BE ADJUSTED, SPECIAL EACH

NEW FRAMES AND LIDS, WHEN SPECIFIED, WILL BE PAID FOR SEPARATELY.

DETAILS FOR FRAMES AND LIDS ADJUSTMENT WITH MILLING

ALL DIMENSIONS ARE IN MILLIMETERS (INCHES) UNLESS OTHERWISE SHOWN

ILLINOIS DEPARTMENT OF TRANSPORTATION
DETAILS FOR FRAMES AND LIDS ADJUSTMENT WITH MILLING

REVISIONS	
NO.	DATE
R. SHAH	10/25/94
R. SHAH	01/30/95
R. SHAH	03/10/95
A. ABBAS	03/21/97

SCALE: NONE
 DATE: 08/19/99
 DRAWN BY: [blank]
 CHECKED BY: [blank]

BD600-03 (BD-8)

Thu Aug 19 07:22:58 1999
 c:\projects\diststd\bd08.dgn LV:35
 VI-B08

REVISIONS			
NO.	BY	DATE	DESCRIPTION
1	THK	3-29-06	IDOT - DISTRICT 1
2	THK	4-13-06	IDOT - DISTRICT 1

FAU RTE	SECTION	COUNTY	TOTAL SHEETS	SHEET NO.
(75TH ST)1691	05-00014-00-RS	COOK	18	17
(RIVER RD)1692				
F.H.W.A. REG.	ILLINOIS	PROJECT M-8003(570)		

CONTRACT NO. 83868

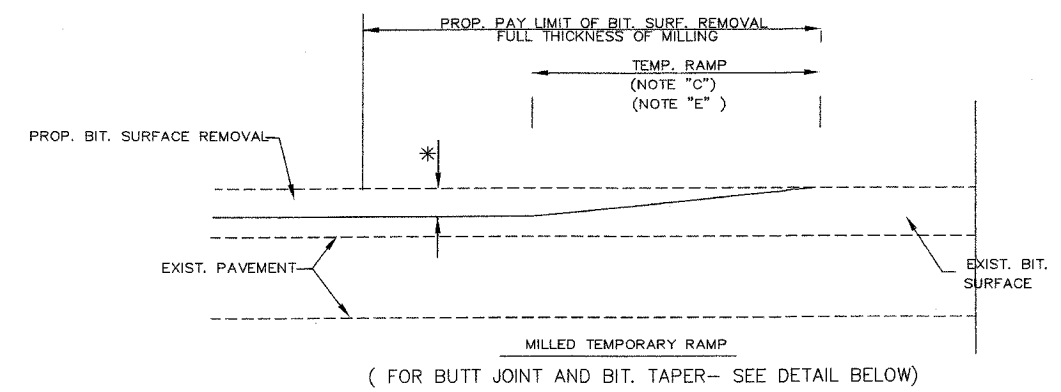

OPTION 1

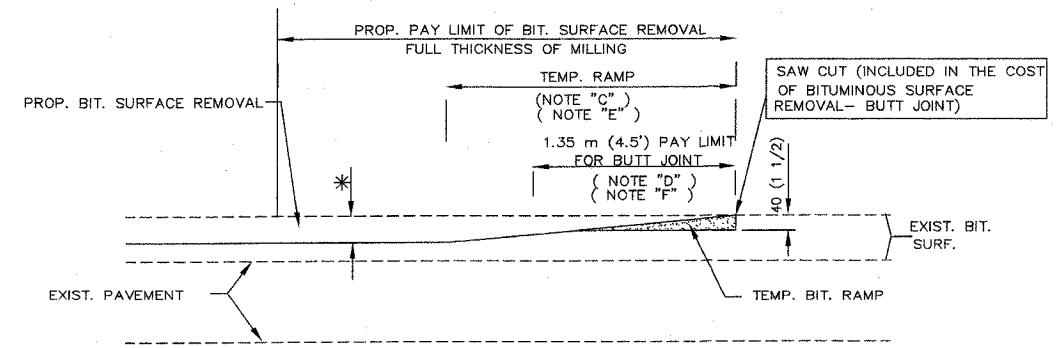

BITUMINOUS CONSTRUCTED TEMPORARY RAMP
(FOR BUTT JOINT AND BIT. TAPER- SEE DETAIL BELOW)

OPTION 2

TYPICAL TEMPORARY RAMP

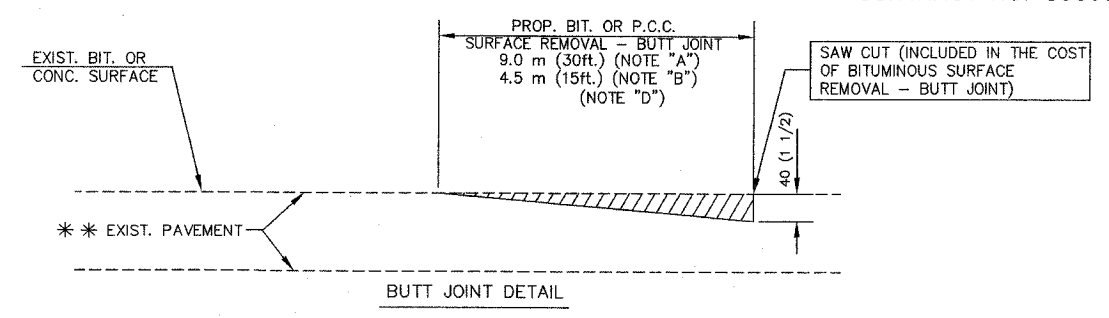

BUTT JOINT DETAIL

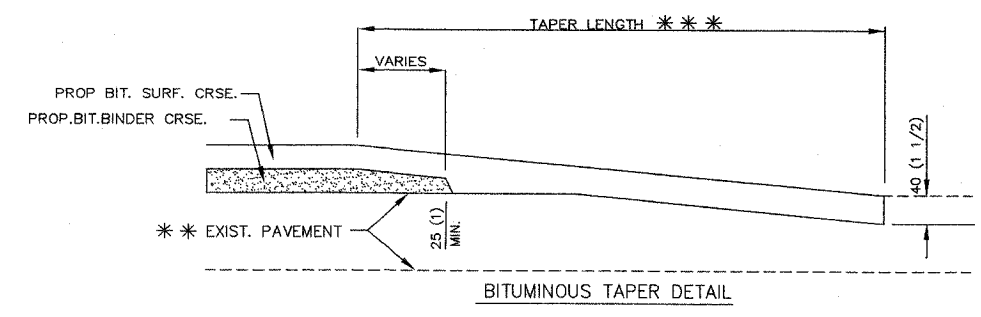

BITUMINOUS TAPER DETAIL

TYPICAL BUTT JOINT AND BITUMINOUS TAPER
FOR RESURFACING ONLY

*** PC CONCRETE, BITUMINOUS OR BITUMINOUS RESURFACED PAVEMENT.

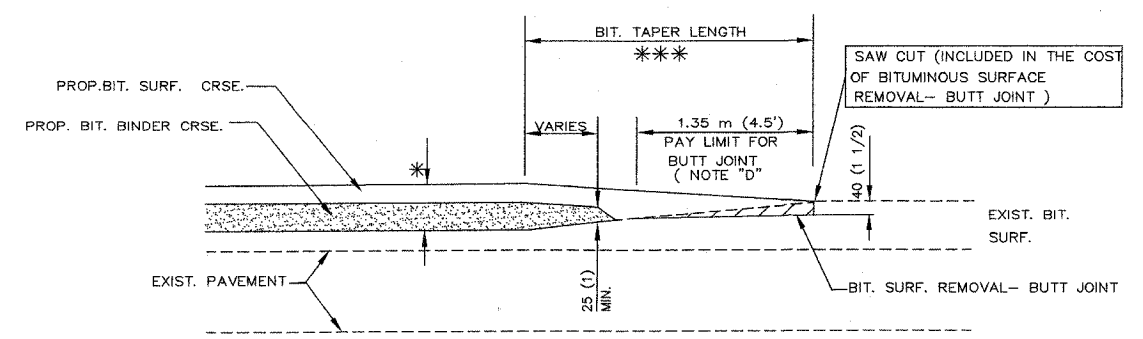

BUTT JOINT AND BITUMINOUS TAPER

TYPICAL BUTT JOINT AND BITUMINOUS TAPER
FOR MILLING AND RESURFACING

NOTES

- A: MAINLINE ROADWAY AND MAJOR SIDE ROADS.
- B: MINOR SIDE ROADS.
- C: THE TEMP. RAMP SHALL BE CONSTRUCTED IMMEDIATELY UPON REMOVAL OF THE EXISTING BITUMINOUS SURFACE.
- D: THE BUTT JOINT SHALL BE CONSTRUCTED IMMEDIATELY PRIOR TO PLACING THE PROPOSED BITUMINOUS SURFACES.
- E: TAPER THE TEMP. RAMP AT THE RATE OF 900 (3 ft.) PER INCH OF MILLING THICKNESS
- F: INSTALLATION AND REMOVAL OF THE 1.35m (4.5') TEMP. BIT. RAMP WILL BE PAID AS "BITUMINOUS SURFACE REMOVAL - BUTT JOINT".
- G: SEE ARTICLE 406.18 AND 406.24 OF THE STANDARD SPECIFICATIONS FOR "BITUMINOUS AND PCC SURFACE REMOVAL - BUTT JOINT".

* SEE TYPICAL SECTIONS FOR MILLING THICKNESS.
*** 6.1 m (20') PER 25 (1) RESURFACING (NOTE "A")
3.0 m (10') PER 25 (1) RESURFACING (NOTE "B")

All dimensions are in millimeters (inches) unless otherwise shown

BASIS OF PAYMENT:
THE BUTT JOINT WILL BE PAID FOR PER SQUARE METER (SQUARE YARD.) AS "BITUMINOUS SURFACE REMOVAL - BUTT JOINT" OR AS "PORTLAND CEMENT CONCRETE SURFACE REMOVAL - BUTT JOINT".

REVISIONS	
NO.	DATE
M. DE YONG	6-13-90
M. DE YONG	7-3-90
M. DE YONG	3-27-92
R. SHAH	09/09/94
R. SHAH	10/25/94
A. ABBAS	03/21/97

ILLINOIS DEPARTMENT OF TRANSPORTATION
BUTT JOINT AND BITUMINOUS TAPER DETAILS
SCALE: NONE
DATE 08/19/99
DRAWN BY CADD
CHECKED BY

REVISIONS			
NO.	BY	DATE	DESCRIPTION
1	THK	3-29-06	IDOT - DISTRICT 1
2	THK	4-13-06	IDOT - DISTRICT 1

FAU RTE	SECTION	COUNTY	TOTAL SHEETS	SHEET NO.
(75TH ST)1691 (RIVER RD)1692	05-00014-00-RS	COOK	18	18
F.H.W.A. REG.		ILLINOIS PROJECT M-8003(570)		

CONTRACT NO. 83868

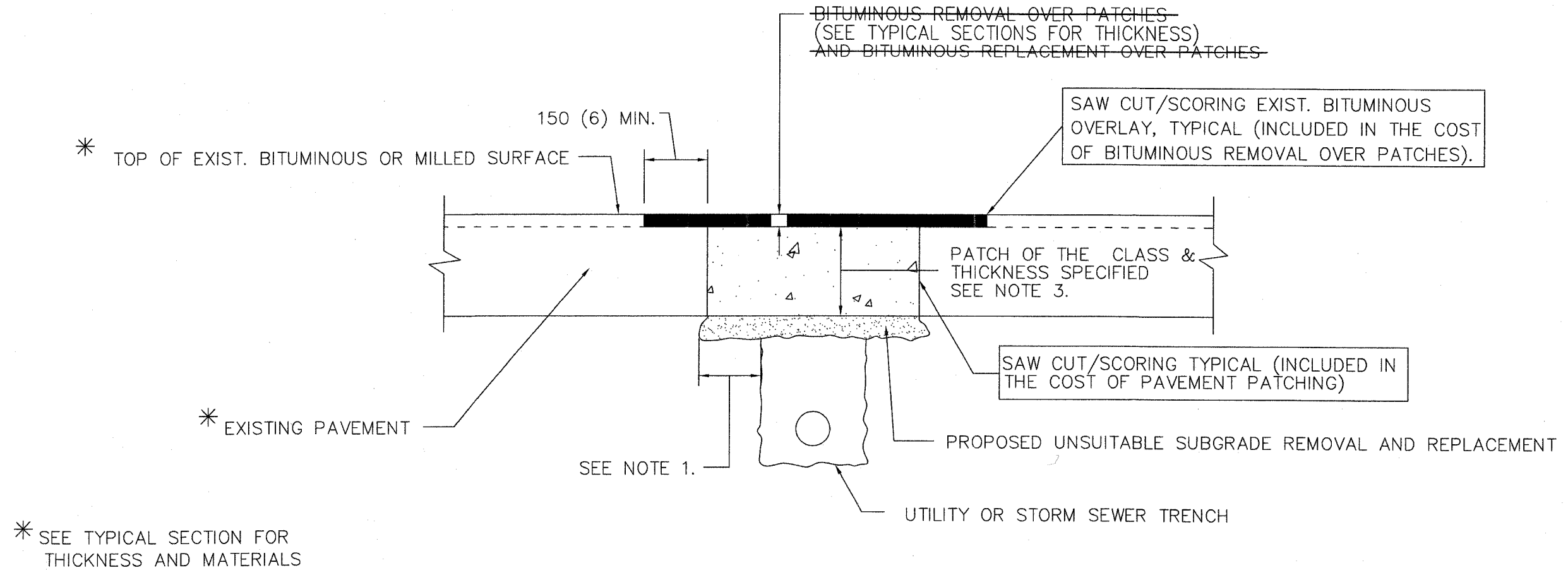

NOTES:

1. THE WIDTH OF THE FULL DEPTH PATCH OVER A TRENCH SHALL BE 300 (12) WIDER ON EACH SIDE OF THE TRENCH.
2. FOR METHOD OF MEASUREMENT AND BASIS OF PAYMENT, SEE SPECIAL PROVISION "PATCHING WITH BITUMINOUS OVERLAY REMOVAL".
3. THE BASE COURSE PATCHING SHALL BE CONSTRUCTED PER THE REQUIREMENTS OF ARTICLE 442 OF THE STANDARD SPECIFICATIONS AND ALL REQUIREMENTS OF STANDARDS 442001-01, 442101-01, 442201 ARE APPLICABLE BASED ON THE CLASS OF PATCH SPECIFIED.

SEQUENCE OF CONSTRUCTION

1. REMOVE THE EXISTING BITUMINOUS MATERIAL OVER THE AREA TO BE PATCHED
2. REMOVE AND REPLACE FULL DEPTH PATCHES
3. REPLACE BITUMINOUS MATERIAL OVER THE AREA TO BE PATCHED

All dimensions are in millimeters (inches) unless otherwise shown

REVISIONS		REVISIONS	
NO.	DATE	NAME	DATE
R. SHAH	10/25/94	ART ABBAS	04/27/98
R. SHAH	01/14/95		
R. SHAH	03/23/95		
R. SHAH	04/24/95		
A. HOUSEH	03/15/96		
A. ABBAS	03/21/97		
A. ABBAS	01/20/98		

ILLINOIS DEPARTMENT OF TRANSPORTATION
PAVEMENT PATCHING FOR BITUMINOUS SURFACED PAVEMENT
 SCALE: NONE DRAWN BY CADD
 DATE 08/19/99 CHECKED BY

REVISIONS			
NO.	BY	DATE	DESCRIPTION
1	THK	3-29-06	IDOT - DISTRICT 1
2	THK	4-13-06	IDOT - DISTRICT 1