

Xrefs:
C-RP
C-TP
PLAN-E
TITLE-E
C-ROW

FAU	SECTION	COUNTY	TOTAL SHEETS	SHEET NO
8075	03-00167-04-FP	SANGAMON	109	35
STA.	TO STA.			
FED. ROAD DIST. NO.	ILLINOIS	FED. AID PROJECT		

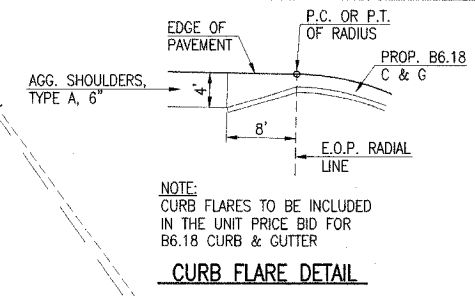
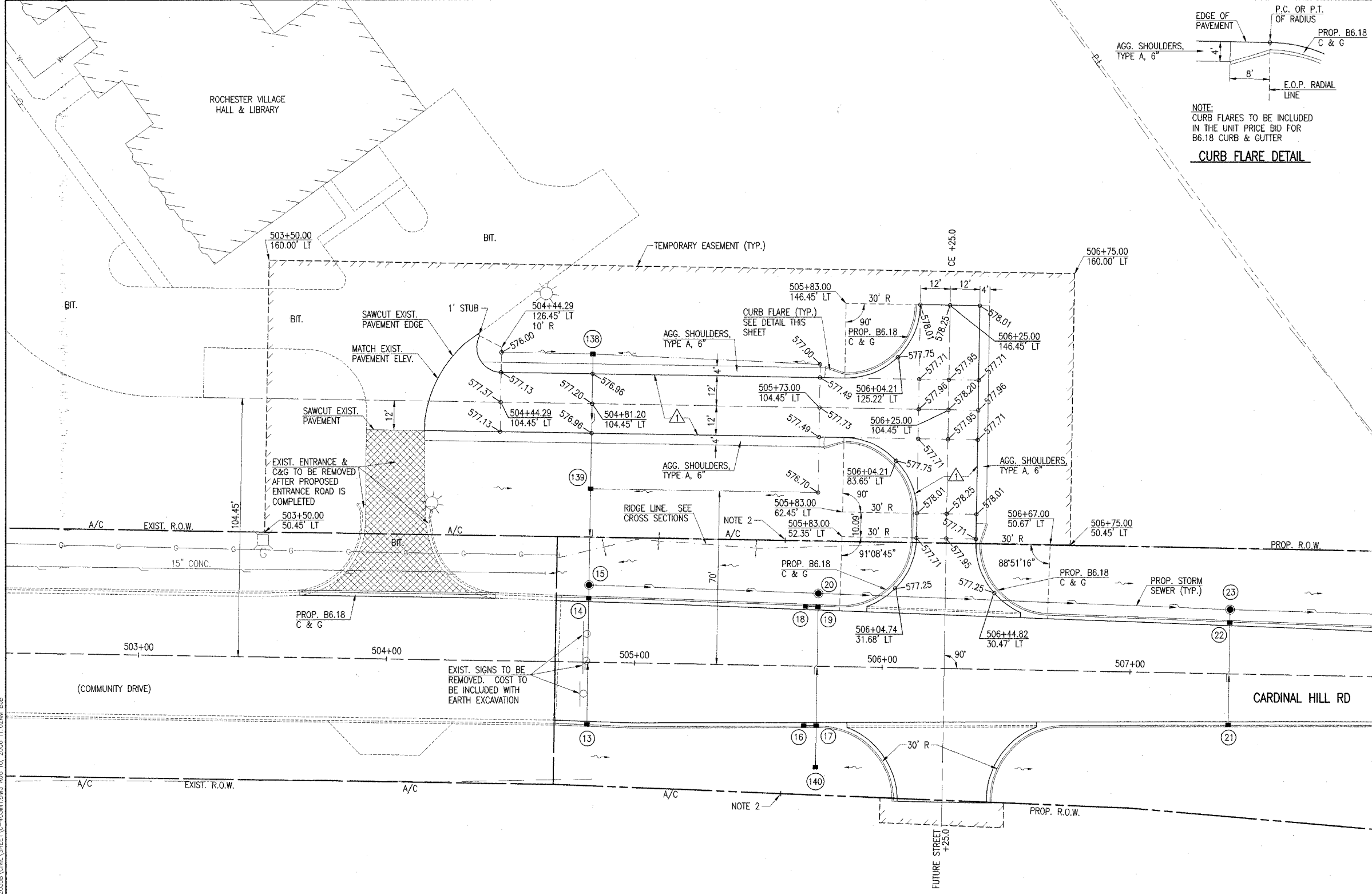

1 1/2" BIT. CONC. SURFACE COURSE, SUPERPAVE, MIX "C" N50 ON 4 1/2" BIT. CONC. BINDER COURSE, SUPERPAVE, IL 19.0 N50

- NOTE:
- ALL DIMENSIONS ARE GIVEN TO EDGE OF PAVEMENT UNLESS OTHERWISE NOTED.
 - ACCESS CONTROL ENDS AT STA 505+60.00, 50.45' LT & 51.71' RT.
 - A/C = ACCESS CONTROL
 - SEE DRAINAGE SCHEDULE FOR STORM SEWER AND STRUCTURE INFORMATION.

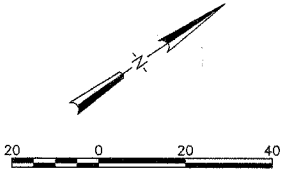

INTERSECTION DETAILS
VILLAGE ENTRANCE ROAD
 SEC. 03-00167-04-FP
CARDINAL HILL ROAD (C.H. 37)
 SANGAMON COUNTY

HANSON
Hanson Professional Services Inc.
 1826 South Sixth Street, Springfield, IL 62763
 Registration No. 184-091084
 © Copyright Hanson Professional Services Inc. 2006

JOB NO.
03S2035B

DATE
6/21/06

LAYOUT 3/15/04
 DRAWN 7/22/04
 REVIEWED 7/21/04
 3:03:00BBS\03S2035B\CIVIL\SHEET\C-40\PRINTING AUG 10, 2006 11:02AM BJB