

Xrefs:
PLAN-E
C-RP
C-TP
TITLE-E
C-ROW

FAU RITE.	SECTION	COUNTY	TOTAL SHEETS	SHEET NO.
8075	03-00167-04-FP	SANGAMON	109	42
STA.	TO STA.			
FED. ROAD DIST. NO.	ILLINOIS	FED. AID PROJECT		

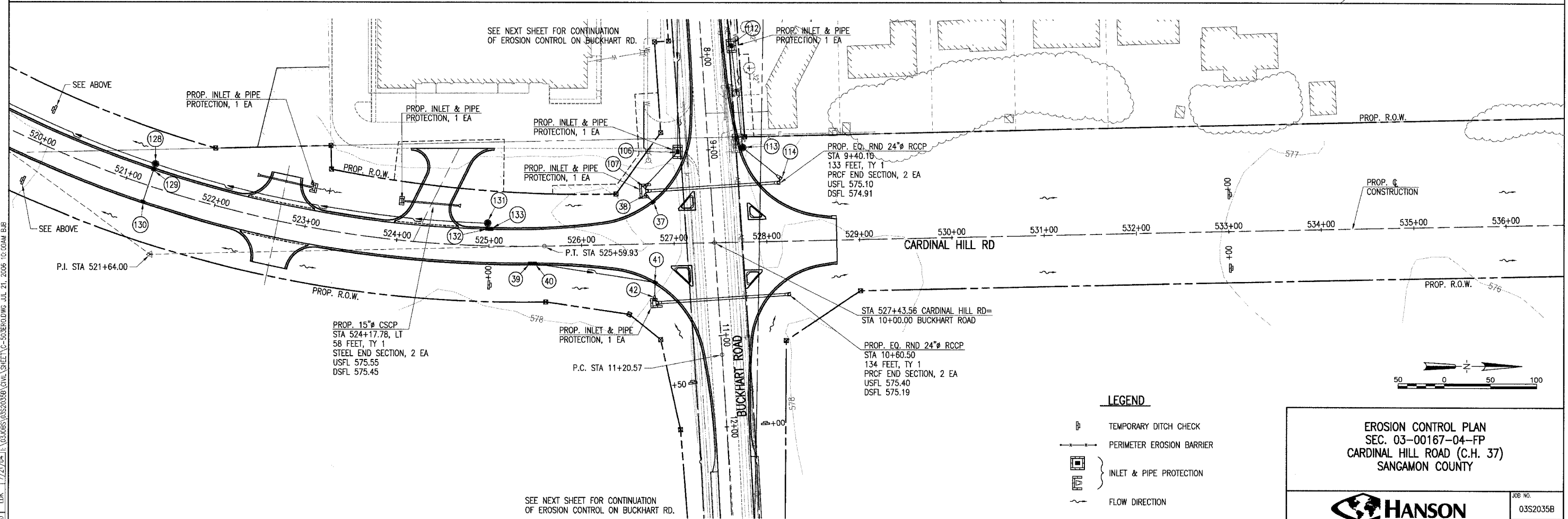
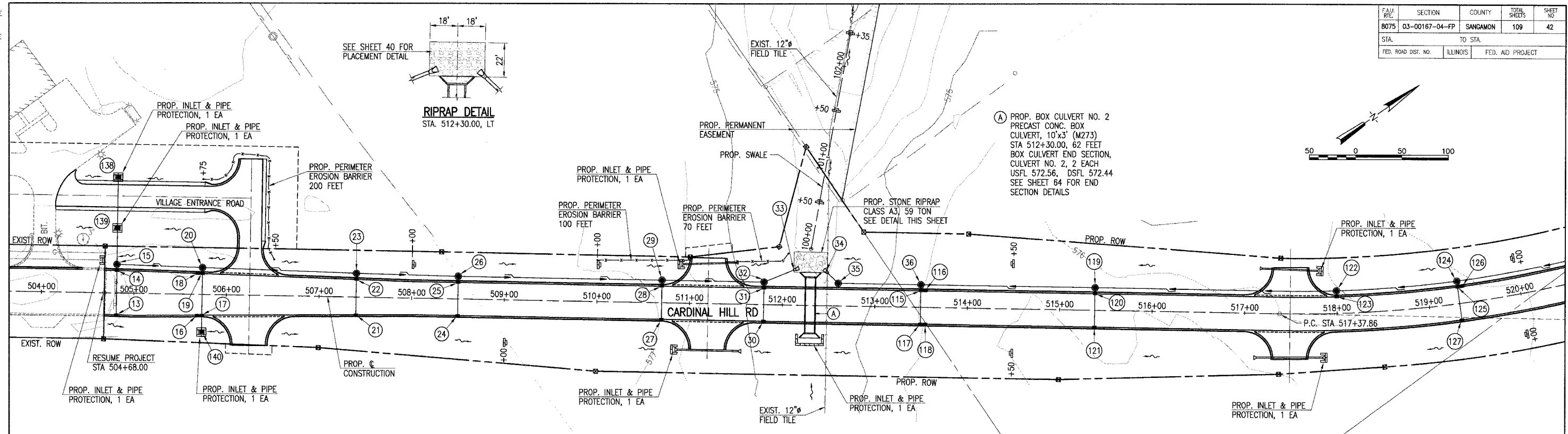

LEGEND

- TEMPORARY DITCH CHECK
- PERIMETER EROSION BARRIER
- INLET & PIPE PROTECTION
- FLOW DIRECTION

EROSION CONTROL PLAN
 SEC. 03-00167-04-FP
 CARDINAL HILL ROAD (C.H. 37)
 SANGAMON COUNTY

JOB NO.
03S20358

DATE
6/21/06



LAYOUT 3/15/04
DRAWN 7/22/04
REVIEWED 1/22/06
03S20358 CIVIL SHEET C-502ERODWG JUL 21, 2006 10:00AM BAR

SEE NEXT SHEET FOR CONTINUATION OF EROSION CONTROL ON BUCKHART RD.

SEE NEXT SHEET FOR CONTINUATION OF EROSION CONTROL ON BUCKHART RD.

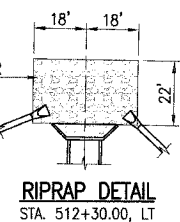

PROP. BOX CULVERT NO. 2
 PRECAST CONC. BOX
 CULVERT, 10'x3' (M273)
 STA 512+30.00, 62 FEET
 BOX CULVERT END SECTION,
 CULVERT NO. 2, 2 EACH
 USFL 572.56, DSFL 572.44
 SEE SHEET 84 FOR END
 SECTION DETAILS

PROP. EQ. RND 24" RCCP
 STA 9+40.18,
 133 FEET, TY 1
 PRCF END SECTION, 2 EA
 USFL 575.10
 DSFL 574.91

PROP. 15" CSCP
 STA 524+17.78, LT
 58 FEET, TY 1
 STEEL END SECTION, 2 EA
 USFL 575.55
 DSFL 575.45

PROP. EQ. RND 24" RCCP
 STA 10+60.50
 134 FEET, TY 1
 PRCF END SECTION, 2 EA
 USFL 575.40
 DSFL 575.19