

F.A.U. RTE.	SECTION	COUNTY	TOTAL SHEETS	SHEET NO.
8075	03-00167-04-FP	SANGAMON	109	63
STA.	TO STA.			
FED. ROAD DIST. NO.	ILLINOIS	FED. AID PROJECT		

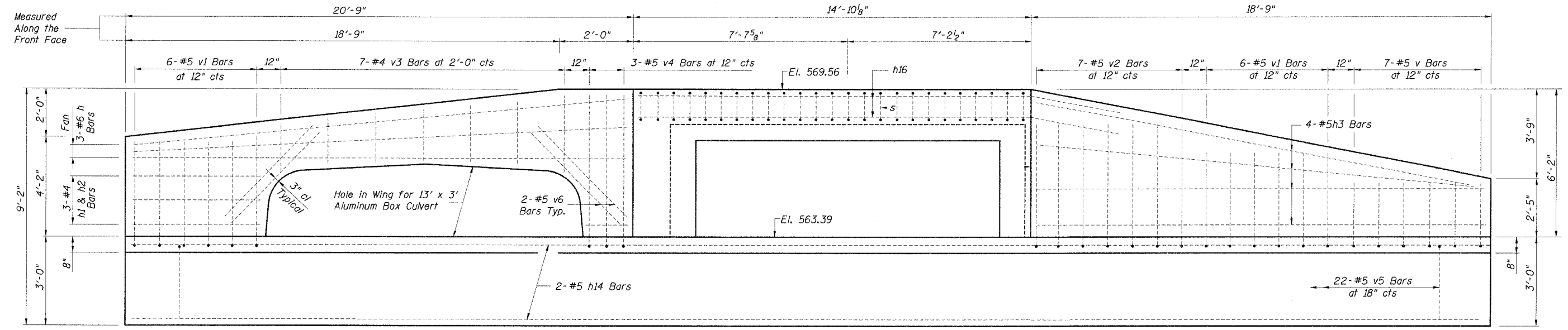

END VIEW

REINFORCEMENT TABLE
(One End Section)

Bar	No.	Size	Length	Shape
b	4	#5	8'-3"	—
b1	4	#5	6'-3"	—
b2	4	#5	4'-3"	—
h	3	#6	20'-0"	—
h1	3	#4	5'-3"	—
h2	3	#4	1'-9"	—
h3	4	#5	18'-3"	—
h4	4	#5	8'-6"	—
h5	3	#5	14'-6"	—
h6	7	#5	20'-0"	—
h7	2	#5	11'-6"	—
h8	2	#5	5'-3"	—
h9	2	#5	30'-0"	—
h10	2	#5	25'-6"	—
h11	2	#5	21'-6"	—
h12	2	#5	17'-3"	—
h13	3	#5	13'-6"	—
h14	2	#5	35'-9"	—
h15	2	#6	17'-0"	—
h16	2	#6	18'-0"	—
v	6	#5	4'-9"	—
v1	20	#5	6'-0"	—
v2	7	#5	7'-2"	—
v3	7	#4	2'-0"	—
v4	3	#5	8'-5"	—
v5	22	#5	5'-6"	—
v6	4	#5	5'-3"	—
v7	7	#5	3'-10"	—
v8	2	#5	6'-4"	—
v9	4	#5	7'-4"	—
v10	1	#5	5'-7"	—
v11	1	#5	4'-7"	—
s	25	#4	4'-5"	□
u	4	#5	18'-2"	—

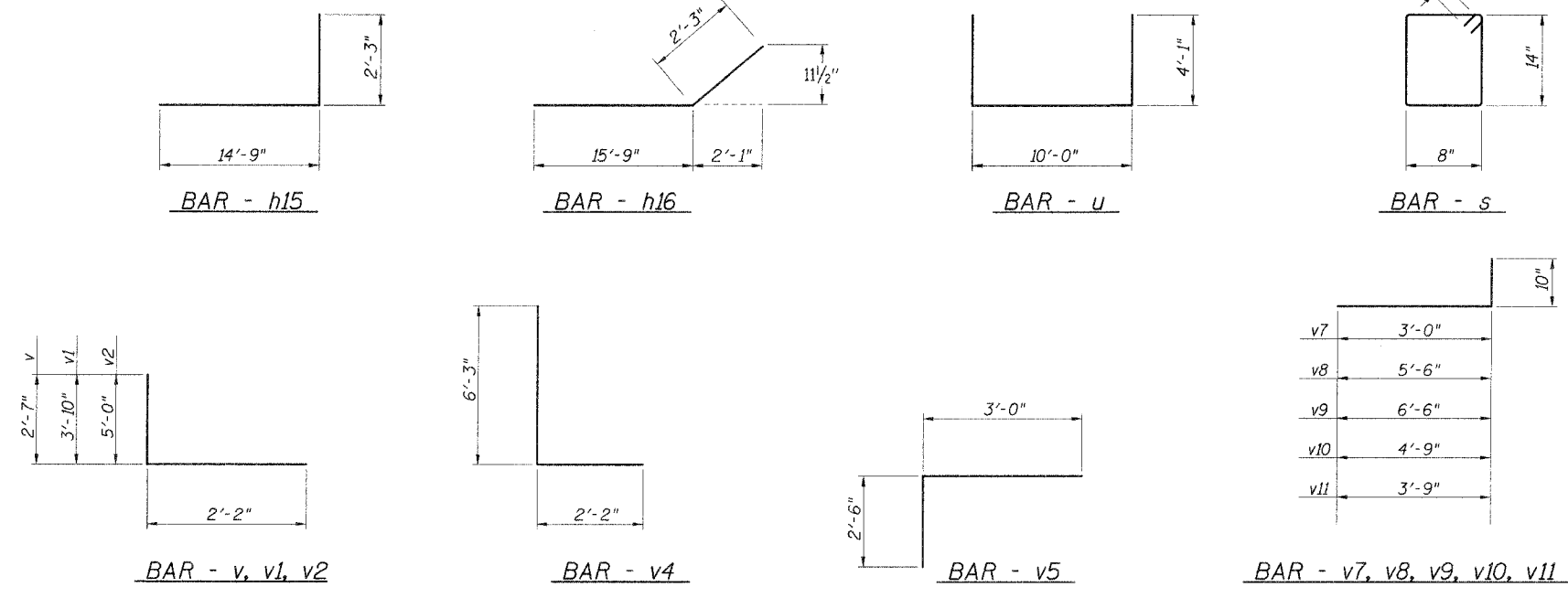

REINFORCED CONCRETE END SECTION
FOR PRECAST BOX CULVERT NO. 1
48" HIGH x 96" WIDE
STATION 468+05.77 (DOWNSTREAM)

HANSON
Hanson Professional Services Inc.

DATE: 6/21/06

LAYOUT: TEM 6/06/06
DRAWN: C.L.G. 6/07/06
REVIEWED: W.P.T. 6/08/06
NO. 03-00167-04-FP-Structural-End-Culvert-Station-468+05.77.dgn