

ROUTE	SECTION	COUNTY	TOTAL SHEETS	SHEET NO.
FAS 1857	03-00070-00-BR	MONROE	11	2
ILLINOIS			FEDERAL AID PROJECT	
CONTRACT NO. 97285				

**GENERAL NOTES**

Existing utilities shown are located from surface observations or information provided by the respective utilities and must be considered approximate. There may be others, the exact location of which are unknown and not shown. The Contractor will be responsible for notifying the respective utilities before work is begun. Field markings of underground utilities may be obtained by providing a minimum of 48 hours advance notice through the J.U.L.I.E. system by calling 1-800-892-0123 or by direct contact with non-members of J.U.L.I.E.

The Contractor shall protect and carefully preserve all property markers and monuments until the owner and an authorized surveyor, or agent, has witnessed or otherwise referenced their location.

The Contractor shall confine his operations to the area located within the construction limit lines, shown on the plans. Any area disturbed beyond these limits shall be restored to its original condition at the Contractor's expense.

The following items and approximate quantities are included in order to establish a unit cost for work which may be required to construct this section. The actual quantity of each item shall be determined by the Engineer in the field.

Temporary Aggregate: 100 ton  
(Used to maintain access for residents located within the project limits)

Traffic control and protection and proper barricades shall be maintained by the Contractor.

It shall be the responsibility of the Contractor for implementation and maintenance of erosion control in accordance with the I.E.P.A. Standard Specifications for soil erosion and sediment control, latest edition and as directed by the Engineer and as shown on the plans.

End sections to be added to ends of pipes are not included in the pipe length.

Topsoil stripped from areas disturbed by grading activities shall be stockpiled and used for final grading and seed bed preparation.

Centerline profiles refer to the finished surface.

All construction shall be in accordance with Illinois Department of Transportation Standard Specifications for Road and Bridge Construction, January 1, 2002, and the latest Supplemental Specifications and Recurring Special Provisions.

All earth surfaces disturbed during construction operations shall be seeded and mulched upon completion of all grading operations.

See cross sections for variable earth slopes and special ditch elevations.

See plan and profile sheet for R.O.W. widths.

Factors used for quantity calculations are as follows:

Aggregate = 2.05 Ton/Cu. Yd.  
Bituminous Concrete = 0.056 Ton/Sq. Yd./Inch

Any facilities or appurtenances which are the property of any public utility located within the limits of construction shall be relocated or adjusted by their respective owners. The Contractor shall notify and cooperate with the owners of any such facility in their removal and rearrangement operations in order that these operations and the construction of this project may progress in a reasonable manner.

The Contractor shall remove, maintain in a temporary location and permanently reset all mailboxes and traffic signs which interfere with construction operations in accordance with Articles 107.19 and 107.22 of the "Standard Specifications for Road and Bridge Construction".

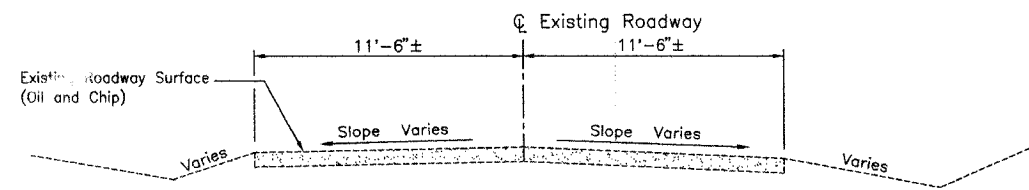

**TYPICAL SECTION EXISTING C.H. 3 (BLUFF ROAD)**

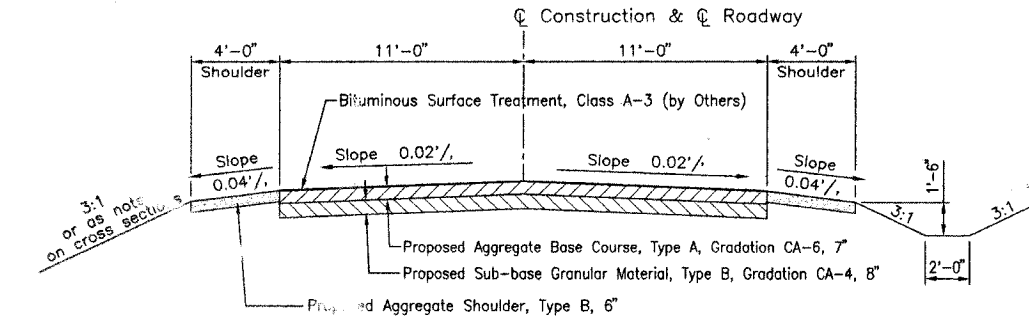

**TYPICAL SECTION PROPOSED C.H. 3 (BLUFF ROAD)**

Sta. 3+00.00 to Sta. 3+12.52  
Sta. 8+12.57 to Sta. 8+33.82  
Sta. 9+56.18 to Sta. 9+90.95  
Sta. 15+39.32 to Sta. 16+08.00

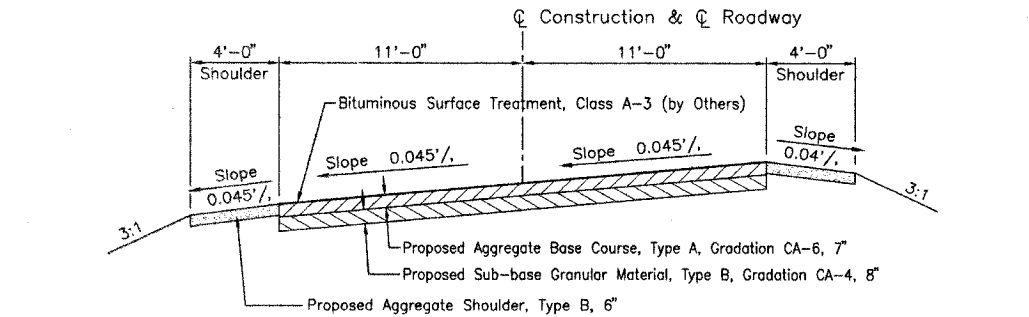

**CURVE #1**

**SUPERELEVATION LEFT PROPOSED ROADWAY TYPICAL SECTION**

Station 4+62.52 to Sta. 6+62.57  
Note: Superelevation Attainment:  
Sta. 3+12.52 to Sta. 4+62.52  
Sta. 6+62.57 to Sta. 8+12.57

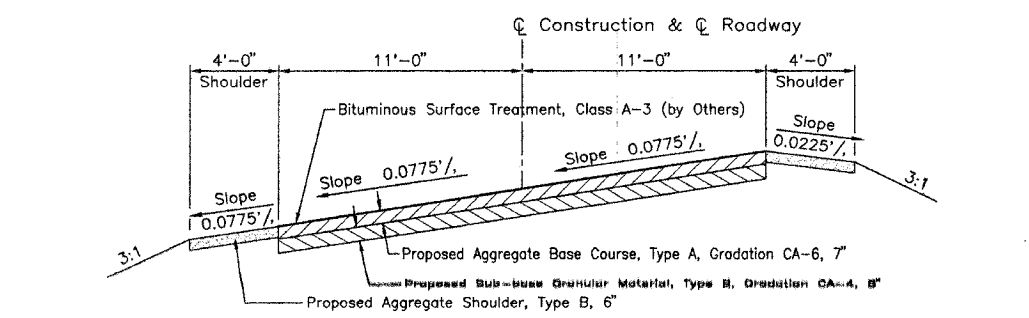

**CURVE #2**

**SUPERELEVATION LEFT PROPOSED ROADWAY TYPICAL SECTION**

Station 11+76.95 to Sta. 13+53.32  
Note: Superelevation Attainment:  
Sta. 9+90.95 to Sta. 11+76.95  
Sta. 13+53.32 to Sta. 15+39.32

Note: Warp Cross Section to Match Existing at Termini:  
Sta. 3+00.00 to Sta. 3+50.00  
Sta. 15+58.00 to Sta. 16+08.00

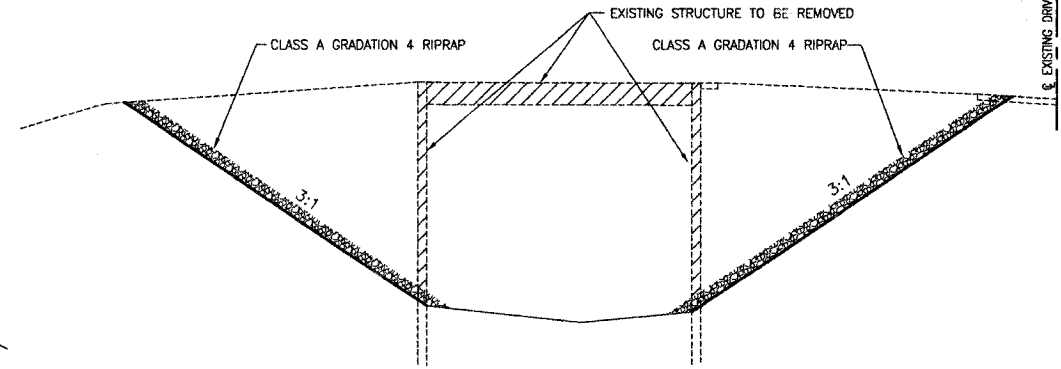

**TYPICAL SECTION THRU EXISTING BRIDGE**

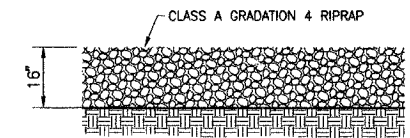

**TYPICAL RIPRAP SECTION**

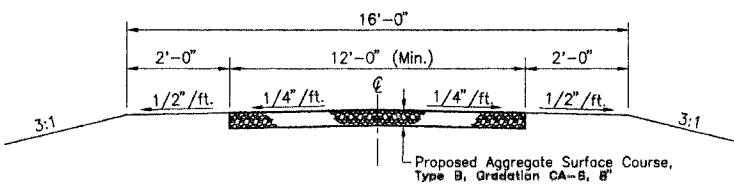

**PROPOSED 12' WIDE DRIVEWAY**

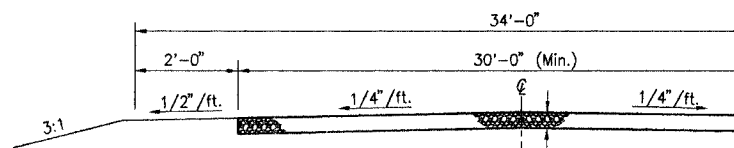

**PROPOSED 30' WIDE ENTRANCE**

Location				Bridge Sta. 8+33.82 - 9+56.18	Road Sta. 3+00.00 - 8+33.82 9+56.18 - 16+08.00
Code No.	Item	Unit	Quantity	Construct. Type Code	FD00
20200100	EARTH EXCAVATION	CU YD	702	-	702
20300100	CHANNEL EXCAVATION	CU YD	800	800	-
20400800	FURNISHED EXCAVATION	CU YD	5873	-	5873
20800150	TRENCH BACKFILL	CU YD	45	-	45
21400100	GRADING AND SHAPING DITCHES	FOOT	96	-	96
25001000	SEEDING, CLASS 2 (SPECIAL)	ACRE	0.94	-	0.94
25100630	EROSION CONTROL BLANKET	SQ YD	440	-	440
28000250	TEMPORARY EROSION CONTROL SEEDING	POUND	470	-	470
28000300	TEMPORARY DITCH CHECKS	EACH	6	-	6
28000400	PERIMETER EROSION BARRIER	FOOT	2121	-	2121
28000500	INLET AND PIPE PROTECTION	EACH	1	-	1
28100707	STONE DUMPED RIPRAP, CLASS A4	SQ YD	1906	-	1906
28400105	GABION REMOVAL	CU YD	75	-	75
* 31101800	SUB-BASE GRANULAR MATERIAL, TYPE B 8"	SQ YD	2900	-	2900
* 31200300	STABILIZED SUB-BASE (VARIABLE DEPTH)	TON	40	40	-
* 35100600	AGGREGATE BASE COURSE, TYPE A 7"	SQ YD	2900	-	2900
* 40200800	AGGREGATE SURFACE COURSE, TYPE B	TON	235	-	235
* 44000100	PAVEMENT REMOVAL	SQ YD	3603	-	3603
* 48101200	AGGREGATE SHOULDERS, TYPE B	TON	361	-	361
50100100	REMOVAL OF EXISTING STRUCTURES	EACH	1	1	-
50105210	REMOVE EXISTING CULVERTS	FOOT	42	-	42
50300225	CONCRETE STRUCTURES	CU YD	52	52	-
50400405	PRECAST PRESTRESSED CONCRETE DECK BEAMS (21" DEPTH)	SQ FT	3360	3360	-
50800105	REINFORCEMENT BARS	POUND	5740	5740	-
50900205	STEEL RAILING, TYPE S1	FOOT	246	246	-
51201600	FURNISHING STEEL PILES HP12X53	FOOT	1050	1050	-
51202700	DRIVING STEEL PILES	FOOT	1050	1050	-
51203600	TEST PILE STEEL HP12X53	EACH	1	1	-
51204315	CONCRETE ENCASEMENT	CU YD	22.6	22.6	-
51500100	NAME PLATES	EACH	1	1	-
54200220	PIPE CULVERTS, CLASS C, TYPE 1 15"	FOOT	115	-	115
54215550	METAL END SECTIONS 15"	EACH	2	-	2
58100200	WATERPROOFING MEMBRANE SYSTEM	SQ YD	375	375	-
58300100	PORTLAND CEMENT MORTAR FAIRING COURSE	FOOT	720	720	-
* 63000000	STEEL PLATE BEAM GUARD RAIL, TYPE A	FOOT	375	-	375
* 63100075	TRAFFIC BARRIER TERMINAL, TYPE 5A	EACH	4	-	4
63200310	GUARDRAIL REMOVAL	FOOT	113	-	113
67100100	MOBILIZATION	L SUM	1	-	1
70101700	TRAFFIC CONTROL AND PROTECTION	L SUM	1	-	1
* LR631020	TRAFFIC BARRIER TERMINAL, TYPE 1	EACH	4	-	4
* X4066414	BITUMINOUS CONCRETE SURFACE COURSE, SUPERPAVE, MIX 'C', N50	TON	63	63	-
XX000372	TEMPORARY AGGREGATE	TON	100	-	100

\*SPECIALTY ITEMS

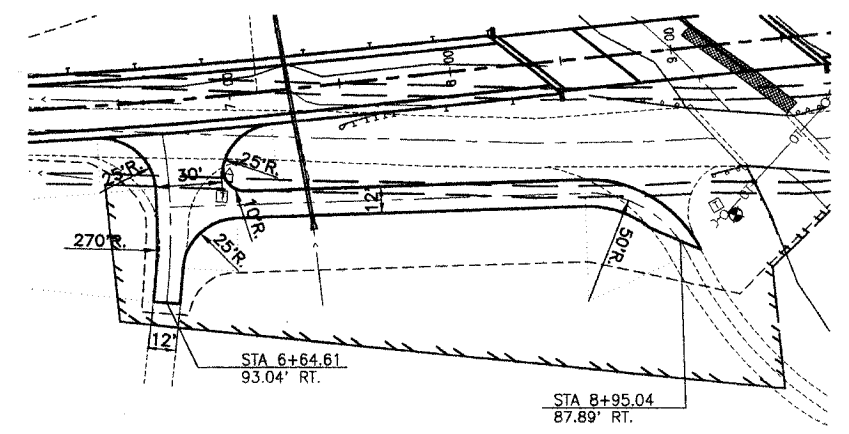

**DRIVEWAY DETAIL**

**SUMMARY OF QUANTITIES AND TYPICAL SECTIONS PROPOSED BRIDGE CARRYING FAS 1857 OVER MONROE CITY CREEK SECTION 03-00070-00-BR MONROE COUNTY, ILLINOIS**