

CODE NO.	ITEM	UNIT	RURAL 100% STATE TOTAL QUANTITY	CONSTRUCTION CODE	
				ROADWAY	BOX CULVERT
				0004 S.N.	0004
67100100	MOBILIZATION	LSUM	1	1	
* 78001100	PAINT PAVEMENT MARKING - LETTERS AND SYMBOLS	SQ FT	43	43	
* 78001110	PAINT PAVEMENT MARKING - LINE 4"	FOOT	11780	11780	
* 78001130	PAINT PAVEMENT MARKING - LINE 6"	FOOT	1316	1316	
* 78009004	MODIFIED URETHANE PAVEMENT MARKING - LINE 4"	FOOT	6701	6701	
* 78009024	MODIFIED URETHANE PAVEMENT MARKING - LINE 24"	FOOT	29	29	
X0327879	PAVEMENT MARKING REMOVAL - GRINDING	SQ FT	4009	4009	
* LRG31020	TRAFFIC BARRIER TERMINAL, TYPE 1	EACH	2	2	
X0301797	GATE REMOVAL	EACH	1	1	
X0322128	MEMBRANE WATERPROOFING FOR BURIED STRUCTURES	SQ YD	142		142
X0323013	TUBULAR STEEL GATE	EACH	1	1	
X0327308	PARKING LOT SEAL COAT	GALLON	6709	6709	
X2020410	EARTH EXCAVATION (SPECIAL)	CU YD	4.7	4.7	
X7010216	TRAFFIC CONTROL AND PROTECTION, (SPECIAL)	LSUM	1	1	



* SPECIALTY ITEM

CODE NO.	ITEM	UNIT	RURAL 100% STATE TOTAL QUANTITY	CONSTRUCTION CODE	
				ROADWAY	BOX CULVERT
				0004 S.N.	0004
Z0013798	CONSTRUCTION LAYOUT	LSUM	1	1	
Z0023602	GRANULAR CULVERT BACKFILL	CU YD	57		57
* Z0054517	ROCK FILL - FOUNDATION	TON	150		150
Z0077900	WOOD POST AND RAIL FENCE	FOOT	105.5	105.5	
X7011006	TRAFFIC CONTROL AND PROTECTION FOR TEMPORARY DETOUR	EACH	1	1	

S

REV. 9-13-2017

REV



MISCELLANEOUS ITEMS SCHEDULE

STA.	STA.	TREE REMOV 6-15 (UNIT)	TREE REMOV OVER 15 (UNIT)	TOPSOIL FURN & PLACE, VAR DEPTH (SQ YD)	PCC SIDEWALK 5" (SQ FT)	DETECTABLE WARNINGS (SQ FT)	NON-BLOCKED SPBGR (FOOT)	TRAF BAR TERM T1 (EACH)	GATE REMOVAL (EACH)	TUB STEEL GATE (EACH)	EARTH EXCAVATION SPL (CU YD)	WD POST & RAIL FENCE (FOOT)
100+16.50 RT & LT	to 101+17.63 RT & LT			47						1		
101+09.00, 20.0' LT	to 101+11.50, 24.5' RT											53.5
101+10.00, 18.5' LT	to 101+63.50, 19.7' LT				387.3							
101+11.40, 12.5' LT	to 101+72.50, 17.4' LT										1.0	
101+11.60, 12.3' LT	to 101+21.63, 12.5' LT					10						
101+11.90, 13.0' LT	to 101+16.90, 13.0' LT											52
101+13.00, 23.0' RT	to 101+65.00, 22.0' RT										0.8	
101+13.60, 16.9' RT	to 101+21.63, 16.6' RT				326.5				1			
101+13.90, 16.6' RT	to 101+64.10, 15.7' RT											
101+15.00, 18.0' RT	to 101+15.00, 14.0' LT					13						
101+14.40, 17.1' RT	to 101+17.40, 17.0' RT		18									
101+49.00, 20.0' LT		8										
101+53.00, 26.0' RT											1.1	
101+53.88, 13.3' RT	to 101+64.10, 15.7' RT										1.8	
101+53.88, 13.3' LT	to 101+72.50, 17.4' LT											
101+53.88 RT & LT	to 105+75.00 RT & LT			188								
101+57.00, 13.8' LT	to 101+63.10, 13.9' LT					12						
101+58.65, 16.3' RT	to 101+63.65, 16.2' RT					10						
101+62.00, 26.0' RT		8										
105+75.00 RT & LT	to 117+13.00 RT & LT			506								
107+50.00, 14.8' LT	to 113+00.00, 13.5' LT						550	2				
VISITOR CENTER												
		16	18	741	713.8	45	550	2	1	1	4.7	105.5

PAVEMENT MARKING SCHEDULE

STA.	STA.	PAINT PVT MARK LET & SYM (SQ FT)	PAINT PVT MARK LINE 4" (FOOT)	PAINT PVT MARK LINE 6" (FOOT)	MOD URETH PM LINE 4 (FOOT)	MOD URETH PM LINE 24 (FOOT)	PAVMT MRKG REM GRIND (SQ FT)
100+04.60, 65.0' RT	to 100+76.00, 18.20' RT	78001100	78001110	78001130	78009004	78009024	X0327979
100+16.50, 50.50, 64.0' LT	to 105+75.00, 12.0' LT				95		
100+40.00, 2.5' RT	to 100+40.00, 28.0' LT				558.5	29	
100+40.00	to 102+20.00				360		
101+13.00, 15.3' RT	to 105+38.00, 12.0' RT				425		
102+20.00 RT & LT	to 104+00.00 RT & LT				360		
104+00.00	to 105+75.00				350		
105+75.00 RT & LT	to 117+13.00 RT & LT				2,276		
105+75.00	to 117+13.00 CENTERLINE				2,276		
125+50.00	to 129+10.00		90				36
125+50.00	to 129+10.00		720				240
127+45.00	to 128+86.00		300				111
127+77.00, 12.5' LT	to 129+10.00, 13.0' LT		232				86
129+10.00, 13.0' LT	to 129+26.00, 13.0' LT		20				
129+10.00	to 137+96.00		1,994				680
VISITOR CENTER PARKING LOT							
	BAY "A"	6.2	518	188			173
	BAY "B"	18.6	1,104	564			368
	BAY "C"	18.6	1,104	564			368
	BAY "D"		1,152				384
	BAY "E"		1,152				384
	BAY "F"		1,186				411
	BAY "G"		1,152				384
	BAY "H"		1,056				384
TOTAL =		43	11,780	1,316	6,701	29	4,009

PAVING SCHEDULE

STA.	STA.	AGG BASE CSE B (TON)	BIT MATLS (PRIME COAT) (POUND)	BIT MATLS (TACK COAT) (POUND)	LEV BIND HM N50 (TON)	LEV BIND MM N50 (TON)	HMA SURF REM BUTT JT (SQ YD)	HMA SURF CSE, MIX "C", N50 (TON)	HMA SURF REM 3/4 (SQ YD)	CL D PATCH T3 10 (SQ YD)	CRACK FILLING (POUND)	COMB CC&G TB6.24 (FOOT)	PARK LOT SEAL CT (GALLON)
100+10.60	to 100+25.60						172.5						
100+10.60	to 101+21.63			467		32		59					
100+82.50	to 101+08.10	RT					36						
101+21.63	to 101+53.88	39	194	58		8		7					
101+17.40, 10' LT	to 101+56.60, 10.7' LT											39.2	
101+17.80, 14' RT	to 101+58.00, 13.2' RT											40.2	
101+53.88	to 105+75.00			903		62		112					
102+40.00	to 102+55.00						63						
102+40.00	to 105+75.00							1,017					
105+38.00, 11.3' RT	to 106+03.00, 11.3' RT						66	272	3,144				
105+75.00	to 117+13.00			2188		150							
116+98.00	to 117+13.00						48						
125+50.00	to 129+10.00										430		432
129+10.00	to 137+96.00										1060		509
VISITOR CENTER PARKING LOT AS NEEDED										24			
ENTIRE PROJECT					20	252	386	450	4,161	74	11,490	79.4	6,709

DRAINAGE SCHEDULE

STA.	STA.	METAL END SEC 18" (EACH)	METAL END SEC 24" (EACH)	INSERT CULV LINER 24" (FOOT)	INSERT CULV LINER 48" (FOOT)
110+60.39, 28' RT		1			
110+60.39, 28' LT		1			
112+25.00, 37' LT			1		
112+79.50, 32' RT			1		
110+60.39, 28' RT	to 110+60.39, 28' LT			56	
112+25.00, 37' LT	to 112+79.50, 32' RT				88
TOTAL =		2	2	56	88

REV. 9-13-2017

DATE	
BY	
REVISIONS	
PLANNED	
ALIGNED	
CHECKED	
NO. _____	
NOTE BOOK	
NO. _____	
DATE	

DATE	
BY	
REVISIONS	
PLANNED	
ALIGNED	
CHECKED	
NO. _____	
NOTE BOOK	
NO. _____	
DATE	

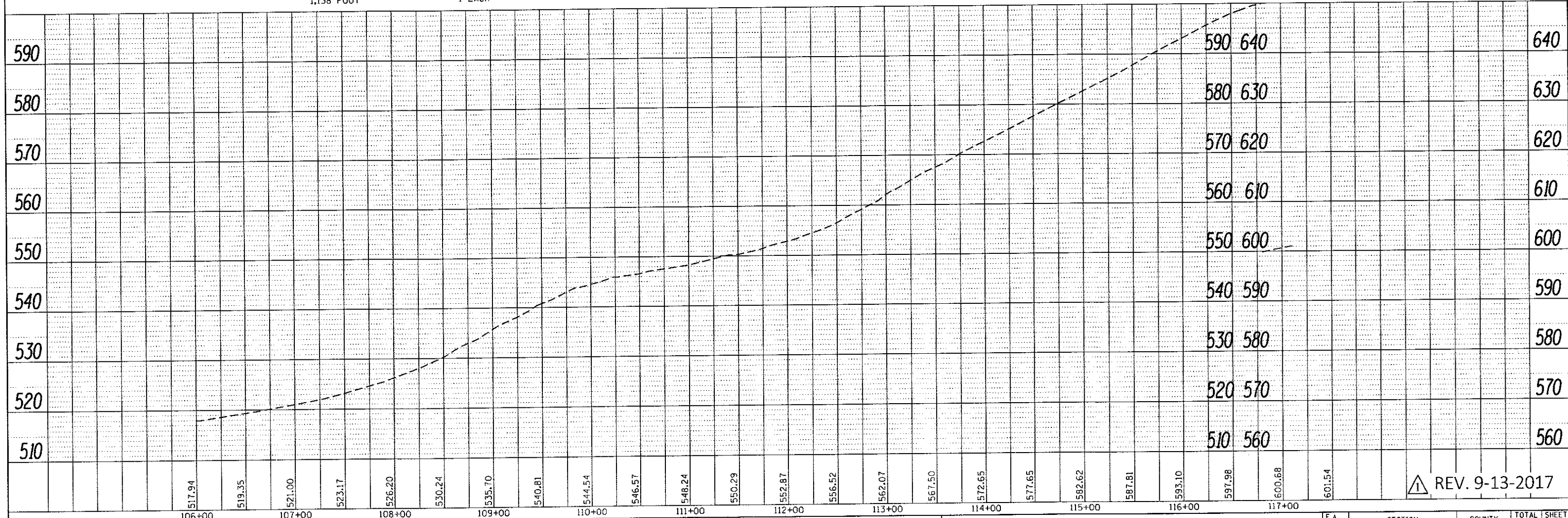
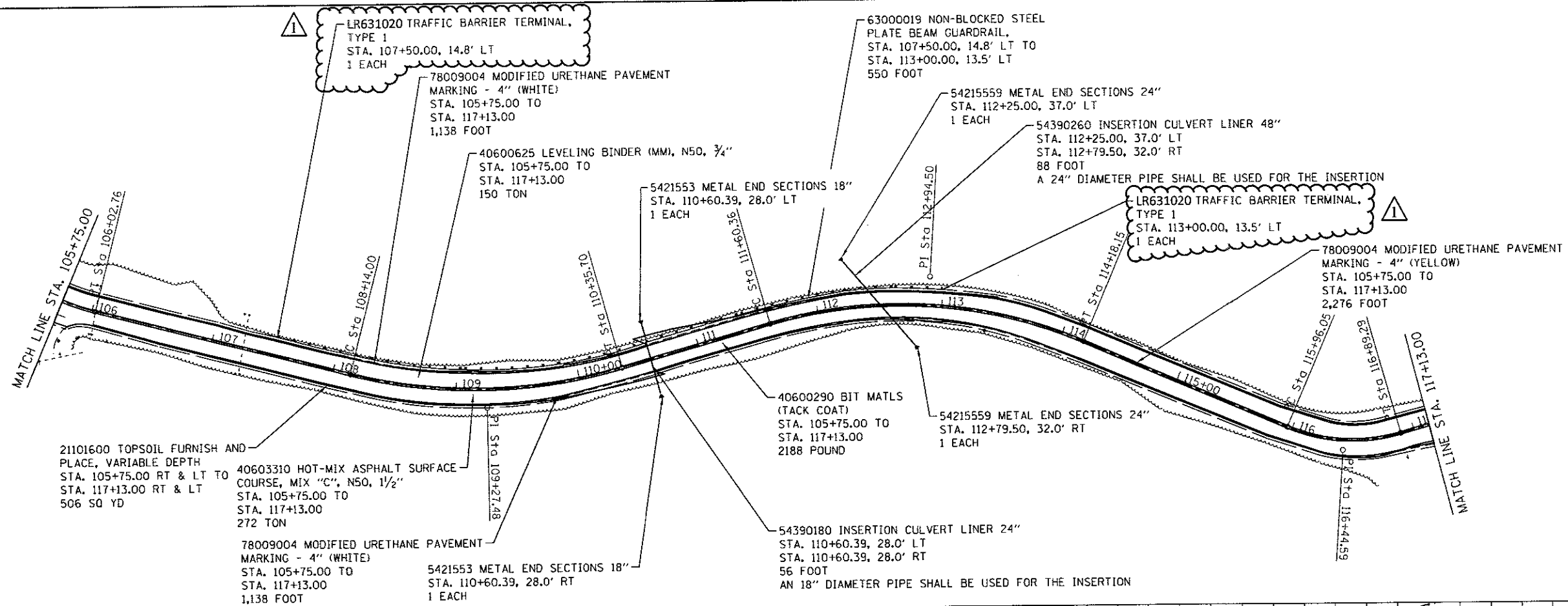

FILE NAME = D:\46900-sh015-planprofile-proposed.dgn	USER NAME = stevek	DESIGNED - R.H.D.	REVISED -	STATE OF ILLINOIS DEPARTMENT OF TRANSPORTATION	MAIN ENTRANCE ROAD PROPOSED PLAN/PROFILE LINCOLN'S NEW SALEM STATE HISTORIC SITE		F.A. RTE.	SECTION	COUNTY	TOTAL SHEETS	SHEET NO.
Default	PLOT SCALE = 1/80.0000" = 1' in.	DRAWN - S.D.K.	REVISED -		SCALE: 1"=50'	SHEET 2 OF 4 SHEETS	STA. _____ TO STA. _____	PARK ROADS 2018-01	MENARD	31	15
	PLOT DATE = 7/21/2017	CHECKED - R.H.D.	REVISED -								
		DATE - 5/17/17	REVISED -								

REV. 9-13-2017

