

- NOTES:**
1. TRAFFIC CONTROL SHALL BE ERECTED AS SHOWN AND ACCORDING TO "TRAFFIC CONTROL AND PROTECTION, STANDARD 701321 (SPECIAL)".
 2. SEE SPECIAL PROVISIONS FOR ADDITIONAL TRAFFIC CONTROL REQUIREMENTS.
 3. COORDINATE LOCATION OF SIGNALS WITH FINAL WORK AS DIRECTED BY THE ENGINEER.
 4. ADDITIONAL SIGNAGE FOR ENTRANCES AND ADVANCE WIDTH RESTRICTION WARNING SHALL BE INCLUDED IN THE COST OF STANDARD 701321 (SPECIAL).
 5. THE DIMENSION SHOWN ON THE WIDTH RESTRICTION SIGN (W12-I102(O)-48) SHOWN ON STANDARD 701321 AND ON THE ADVANCE WARNING SIGN (W12-I103) SHOWN BELOW, SHALL BE 12'-0" FOR STAGE I CONSTRUCTION AND 11'-6" FOR STAGE II CONSTRUCTION.
 6. SEE STANDARD 701321 (SPECIAL) FOR COMPLETION OF STAGE CONSTRUCTION SIGNING AND ADVANCE DETECTOR LOOP PLACEMENT NOT SHOWN.
 7. ALL TRAFFIC SIGNALS SHOWN ARE INCLUDED IN TEMPORARY BRIDGE TRAFFIC SIGNALS - 1 EACH.
 8. THE ADDITIONAL DETECTOR LOOPS AT THE ENTRANCES ARE INCLUDED IN TEMPORARY BRIDGE TRAFFIC SIGNALS - 1 EACH.
 9. TEMPORARY BRIDGE TRAFFIC SIGNALS SHALL BE A 3-PHASE SIGNAL WITH ACTUATION PROVIDED FOR THE SIDE ROAD (GOLDEN PLOVER RD.) AT STATION 63+41 LT.
 10. THE TRAFFIC BARRIER TERMINAL TYPE 6A (SPECIAL) SHALL BE INSTALLED WITH A 30' RADIUS AS SHOWN IN THE PLANS, SUBJECT TO APPROVAL BY THE ENGINEER.

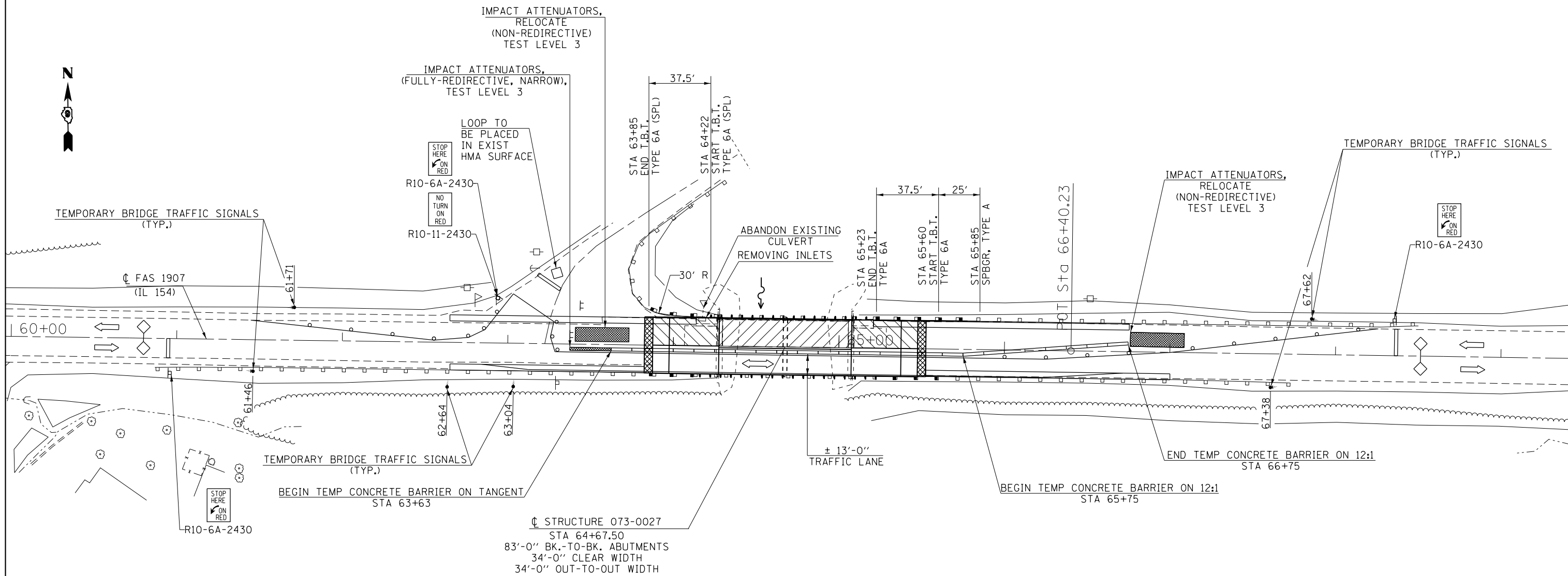

- ◇ DETECTOR LOOP
- ‡ TYPE III BARRICADE
- DRUM WITH STEADY BURNING BI-DIRECTIONAL LIGHT
- TRAFFIC SIGNAL, SIGNAL DIRECTION INDICATED (10' MINIMUM TO BOTTOM OF SIGNAL)
- TRAFFIC SIGNAL WITH BACKPLATE, SIGNAL DIRECTION INDICATED
- ▨ TEMP. RAMP
- ▨ SUPER STRUCTURE REMOVAL
- ▨ PAVEMENT REMOVAL

1 REVISED SHEET 8-30-2017

STAGE II TRAFFIC

FILE NAME =	USER NAME = halsteadtw	DESIGNED -	REVISED -	STATE OF ILLINOIS DEPARTMENT OF TRANSPORTATION	STAGE II TRAFFIC CONTROL				F.A.P. RTE.	SECTION	COUNTY	TOTAL SHEETS	SHEET NO.
pw:\IL\084EBIDINTEG.illinois.gov\PIWIDOT\Documents\DOT Offices\District 9\Projects\78156\Drawings\CADsheets\78156-sht-plen.dgn		CHECKED -	REVISED -		841	(34)BR-1	PERRY	33	12				
Default	PLOT SCALE = 60.0000' / in.	DATE -	REVISED -		CONTRACT NO. 78156				ILLINOIS FED. AID PROJECT				
	PLOT DATE = 8/30/2017				SCALE:	SHEET	OF	SHEETS	STA.	TO	STA.		

DATE	
BY	
FINAL SURVEY	
SURVEYED	
PLOTTED	
TEMPLATE	
NOTE BOOK	
AREAS CHECKED	
NO.	

DATE	
BY	
ORIGINAL SURVEY	
SURVEYED	
PLOTTED	
TEMPLATE	
NOTE BOOK	
AREAS CHECKED	
NO.	

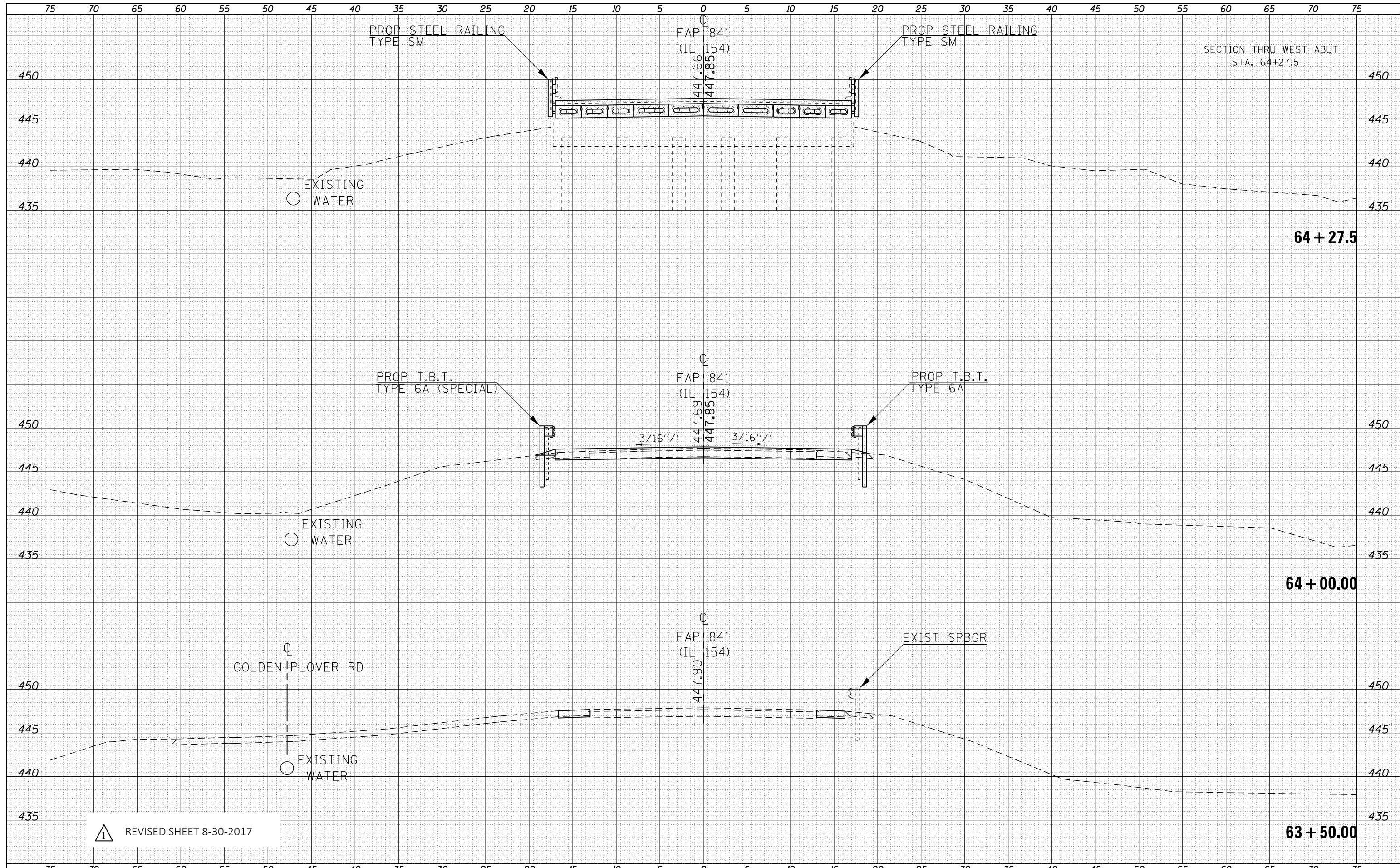

▲ REVISED SHEET 8-30-2017

FILE NAME =	USER NAME = portercw	DESIGNED -	REVISIED -	STATE OF ILLINOIS DEPARTMENT OF TRANSPORTATION	IL 154 CROSS SECTIONS	F.A.P. RTÉ.	SECTION	COUNTY	TOTAL SHEETS	SHEET NO.
p:\1\084EBIDINTEG\Illinois.gov\PWIDOT\Documents\DOT Offices\District 9\Projects\78156\CADD\DRAWINGS\78156-sht-XS154.dgn	DRWN	REVISIED -	REVISIED -			841	(34)BR-1	PERRY	33	30
PLOT SCALE = 10.0000' / in.	CHECKED -	REVISIED -	REVISIED -			CONTRACT NO. 78156				
PLOT DATE = 8/30/2017	DATE -	REVISIED -	REVISIED -			ILLINOIS FED. AID PROJECT				
SCALE: 1"=5'						SHEET NO. OF SHEETS		STA. 63+50.00 TO STA. 64+26.00		

DATE	
BY	
FINAL SURVEY	SURVEYED
NOTE BOOK	PLOTTED
NO.	TEMPLATE
	AREAS
	CHECKED

DATE	
BY	
ORIGINAL SURVEY	SURVEYED
NOTE BOOK	PLOTTED
NO.	TEMPLATE
	AREAS
	CHECKED

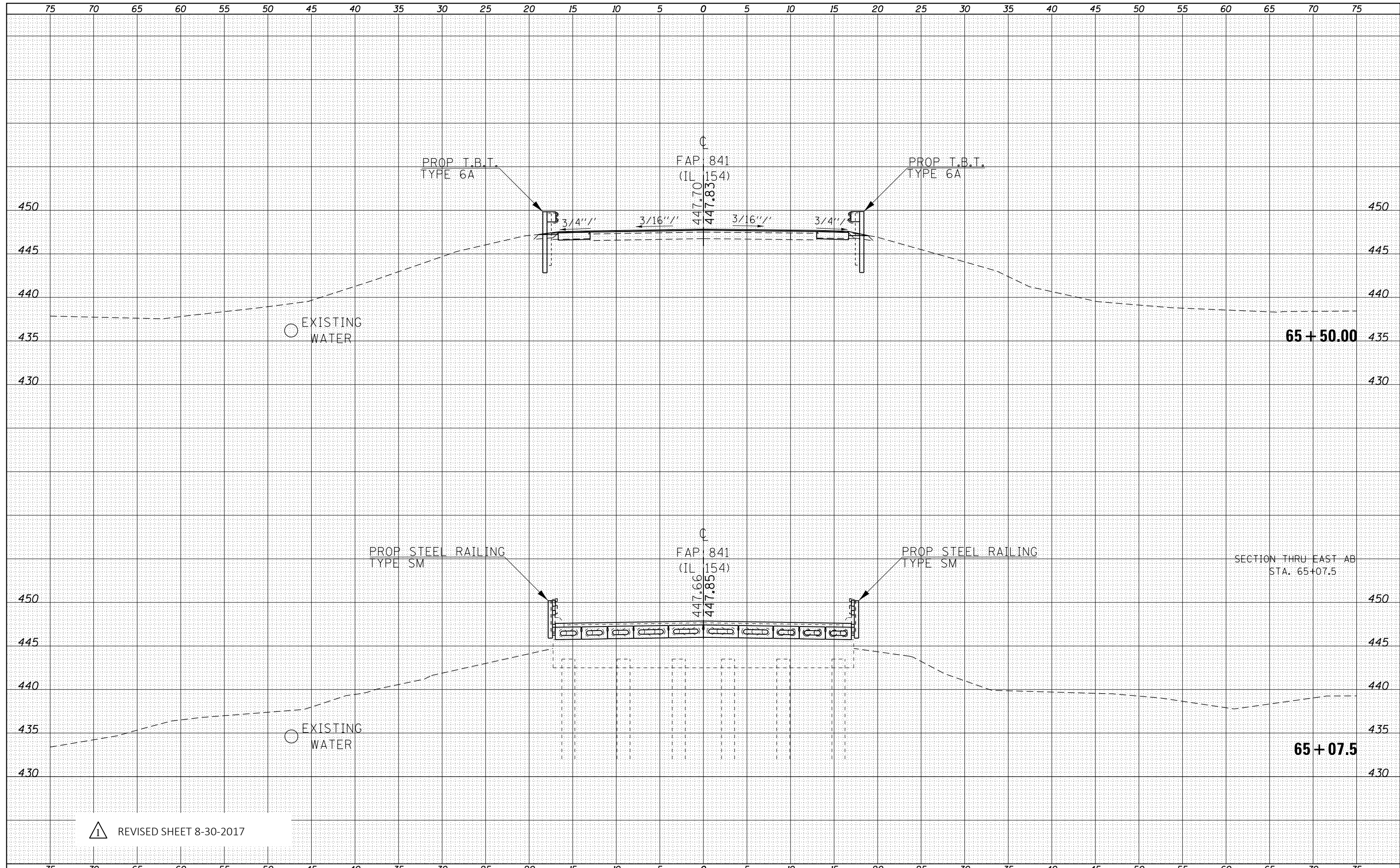

⚠️ REVISED SHEET 8-30-2017

FILE NAME =	USER NAME = portercw	DESIGNED -	REVISOR -	STATE OF ILLINOIS DEPARTMENT OF TRANSPORTATION	IL 154 CROSS SECTIONS	F.A.P. RTE.	SECTION	COUNTY	TOTAL SHEETS	SHEET NO.
p:\1\084EBIDINTEG\Illinois.gov\PIWIDOT\Documents\DOT Offices\District 9\Projects\78156\CADD\Drawings\78156-sht-XS154.dgn	DRW	REVISOR -	REVISOR -			841	(34)BR-1	PERRY	33	32
PLOT SCALE = 10.0000" / in.	CHECKED -	REVISOR -	REVISOR -			CONTRACT NO. 78156			ILLINOIS FED. AID PROJECT	
PLOT DATE = 8/30/2017	DATE -	REVISOR -	REVISOR -			SCALE: 1"=5'	SHEET NO.	OF SHEETS	STA. 65+09.00	TO STA. 65+50.00