

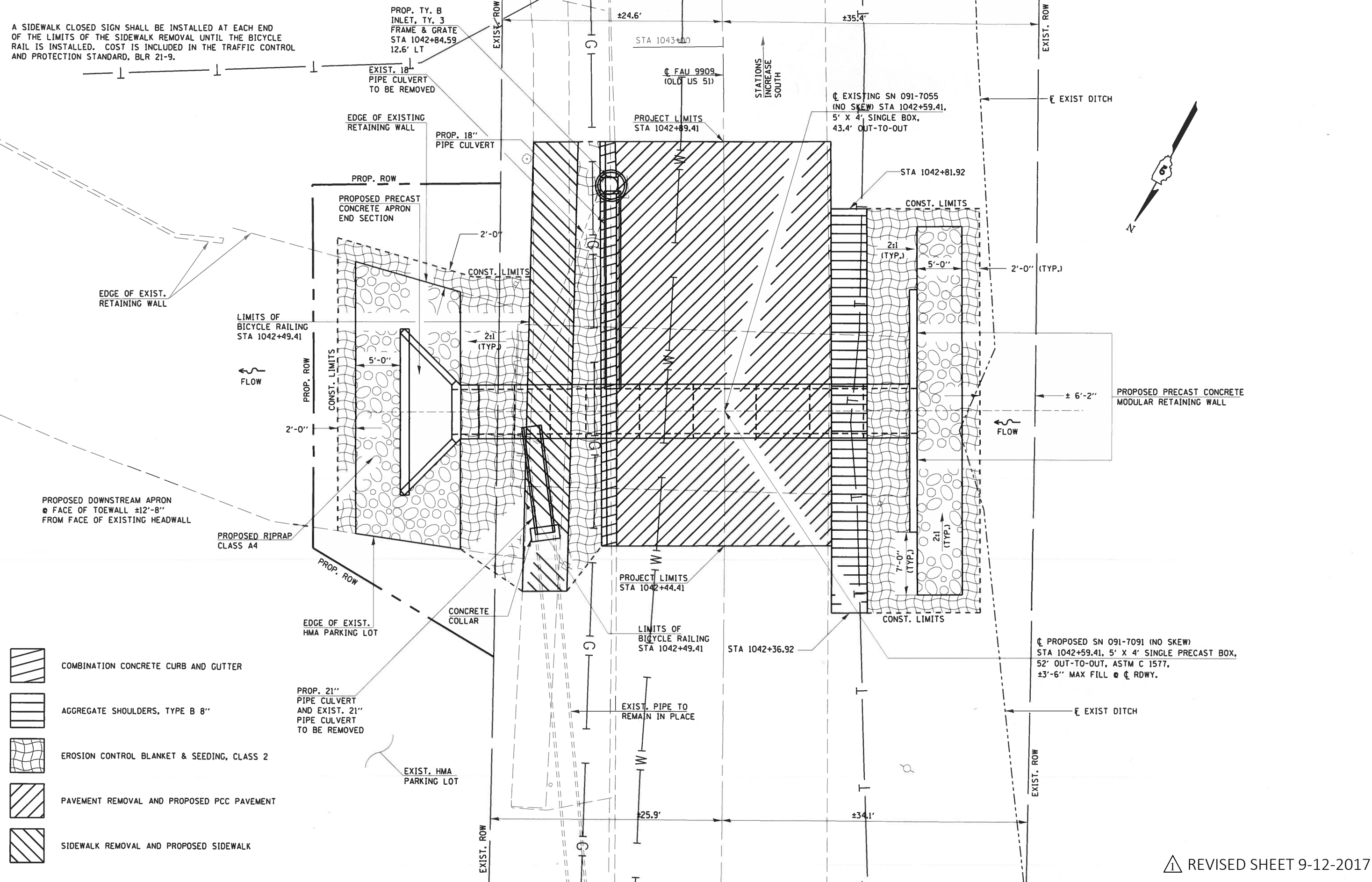





A SIDEWALK CLOSED SIGN SHALL BE INSTALLED AT EACH END OF THE LIMITS OF THE SIDEWALK REMOVAL UNTIL THE BICYCLE RAIL IS INSTALLED. COST IS INCLUDED IN THE TRAFFIC CONTROL AND PROTECTION STANDARD, BLR 21-9.



-  COMBINATION CONCRETE CURB AND GUTTER
-  AGGREGATE SHOULDERS, TYPE B 8"
-  EROSION CONTROL BLANKET & SEEDING, CLASS 2
-  PAVEMENT REMOVAL AND PROPOSED PCC PAVEMENT
-  SIDEWALK REMOVAL AND PROPOSED SIDEWALK

△ REVISED SHEET 9-12-2017

FILE NAME =	USER NAME = adamsam	DESIGNED -	REVISED -	<b>STATE OF ILLINOIS DEPARTMENT OF TRANSPORTATION</b>	<b>GENERAL PLAN SN 091-7091 (P)</b>	F.A. RTE.	SECTION	COUNTY	TOTAL SHEETS	SHEET NO.	
pw:\IL084EB\INTEG.illinois.gov\PWIDOT\Documents\IDOT Offices\District 9\Projects\78500\CADData\CAD\09178500.sht.dgn		CHECKED -	REVISED -			*	12B-1;10B-2	**	32	11	
Default	PLOT SCALE = 10.0000' / in.	DATE -	REVISED -			CONTRACT NO. 78500					
	PLOT DATE = 9/12/2017					ILLINOIS FED. AID PROJECT					



DATE	
BY	
SUBMITTED	
PLOTTED	
TEMPLATE	
NOTE BOOK	
AREAS CHECKED	
NO.	

DATE	
BY	
SUBMITTED	
PLOTTED	
TEMPLATE	
NOTE BOOK	
AREAS CHECKED	
NO.	

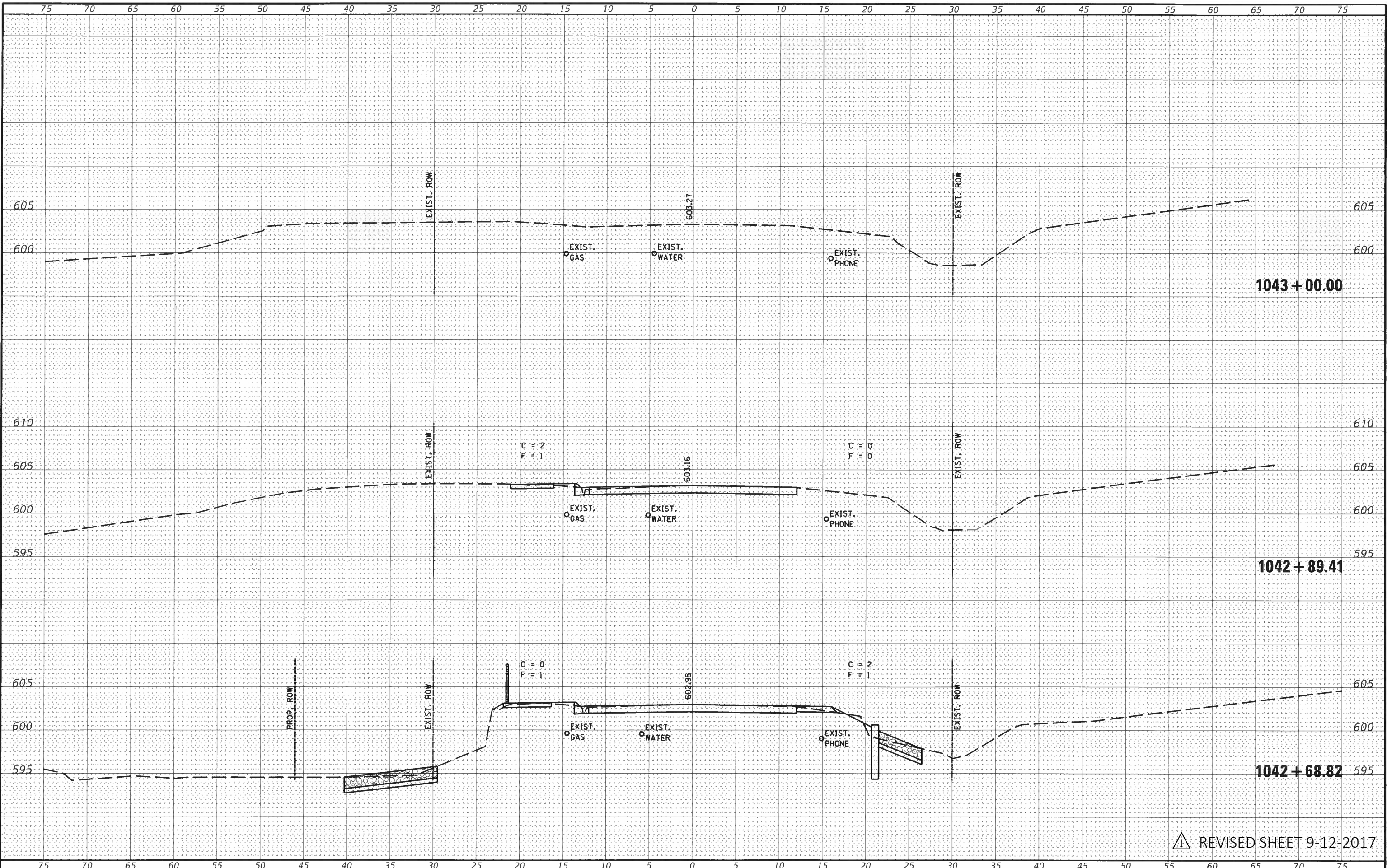



△ REVISED SHEET 9-12-2017

FILE NAME =	USER NAME = adamsam	DESIGNED -	REVISED -	<b>STATE OF ILLINOIS DEPARTMENT OF TRANSPORTATION</b>	<b>CROSS SECTIONS SN 091-7091 (P)</b>	F.A. RTE.	SECTION	COUNTY	TOTAL SHEETS	SHEET NO.
pw:\IL084EBID\INTEG.illinois.gov\PWIDOT\Documents\IDOT\offices\District 9\Projects\78500\CADData\CADsheets\78500\DRW\12B-1\10B-2.dwg		CHECKED -	REVISED -			*	12B-1:10B-2	**	32	16
PLOT SCALE = 10.0000' / in.		DATE -	REVISED -			CONTRACT NO. 78500				
PLOT DATE = 9/12/2017						ILLINOIS FED. AID PROJECT				
SCALE: _____ SHEET _____ OF _____ SHEETS					STA. 1042+68.66 TO STA. 1043+00.00		* FAU ROUTE 9909 & FAS ROUTE 1911 ** UNION & JACKSON			

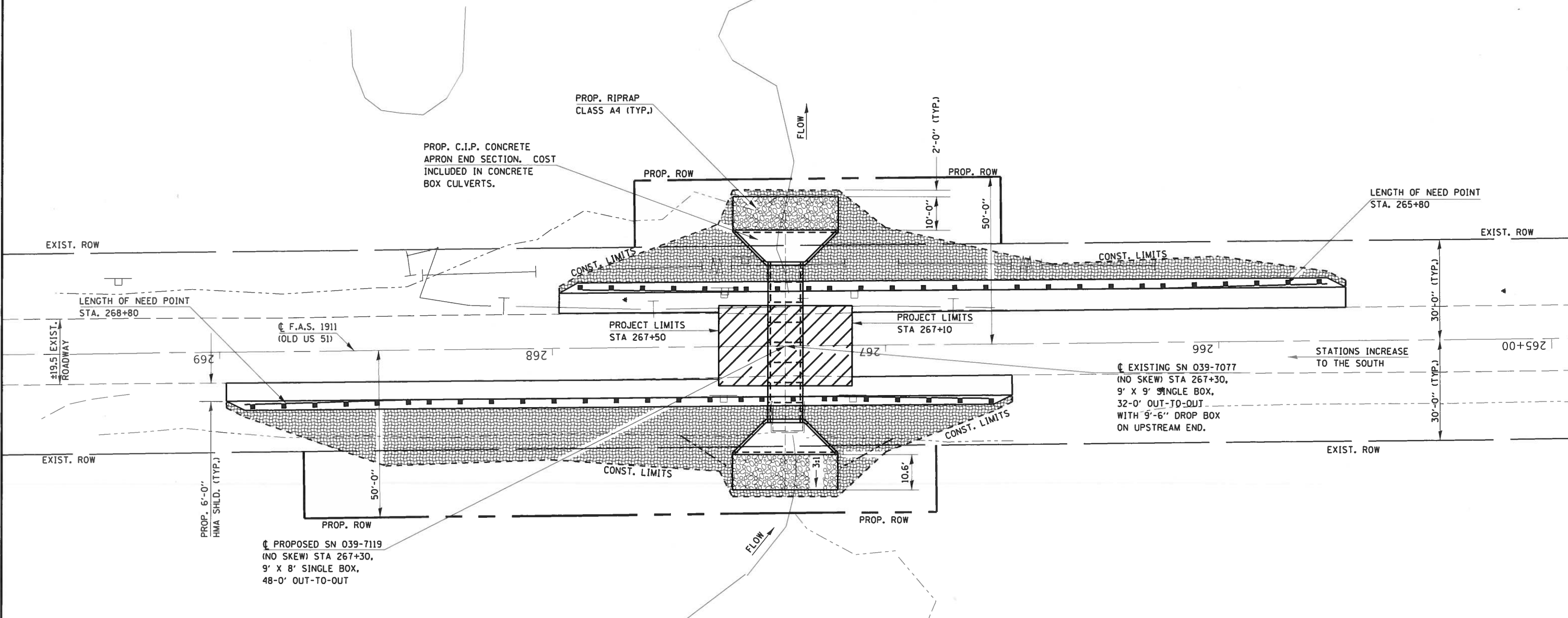
EROSION CONTROL BLANKET SHALL BE INSTALLED ON ALL SLOPES GREATER THAN 3:1.



-  PROPOSED RIPRAP, CLASS A4
-  EROSION CONTROL BLANKET & SEEDING, CLASS 2
-  PAVEMENT REMOVAL AND PROPOSED PCC PAVEMENT

REVISION SYMBOL REVISED SHEET 9-12-2017

FILE NAME =	USER NAME = adamsam	DESIGNED -	REVISIONS	<b>STATE OF ILLINOIS DEPARTMENT OF TRANSPORTATION</b>	<b>GENERAL PLAN SN 039-7119 (P)</b>	F.A. RTE.:	SECTION	COUNTY	TOTAL SHEETS	SHEET NO.	
pw:\ML084EBIDINTEG\Illinois.gov\PWIDOT\Documents\IDOT Offices\District 9\Projects\78500\CADDData\CADSe-039-7119.sht.dgn		CHECKED -	1			*	12B-1;10B-2	**	32	20	
PLOT SCALE = 30.0000" / in.		DATE -	2			CONTRACT NO. 78500					
PLOT DATE = 9/12/2017		REVISIONS	3			ILLINOIS FED. AID PROJECT					

FINAL SURVEY	SURVEYED	DATE
NOTE BOOK	PLOTTED	BY
AREAS CHECKED	TEMPLATE	
	AREAS	
	CHECKED	

ORIGINAL SURVEY	SURVEYED	DATE
NOTE BOOK	PLOTTED	BY
AREAS CHECKED	TEMPLATE	
	AREAS	
	CHECKED	

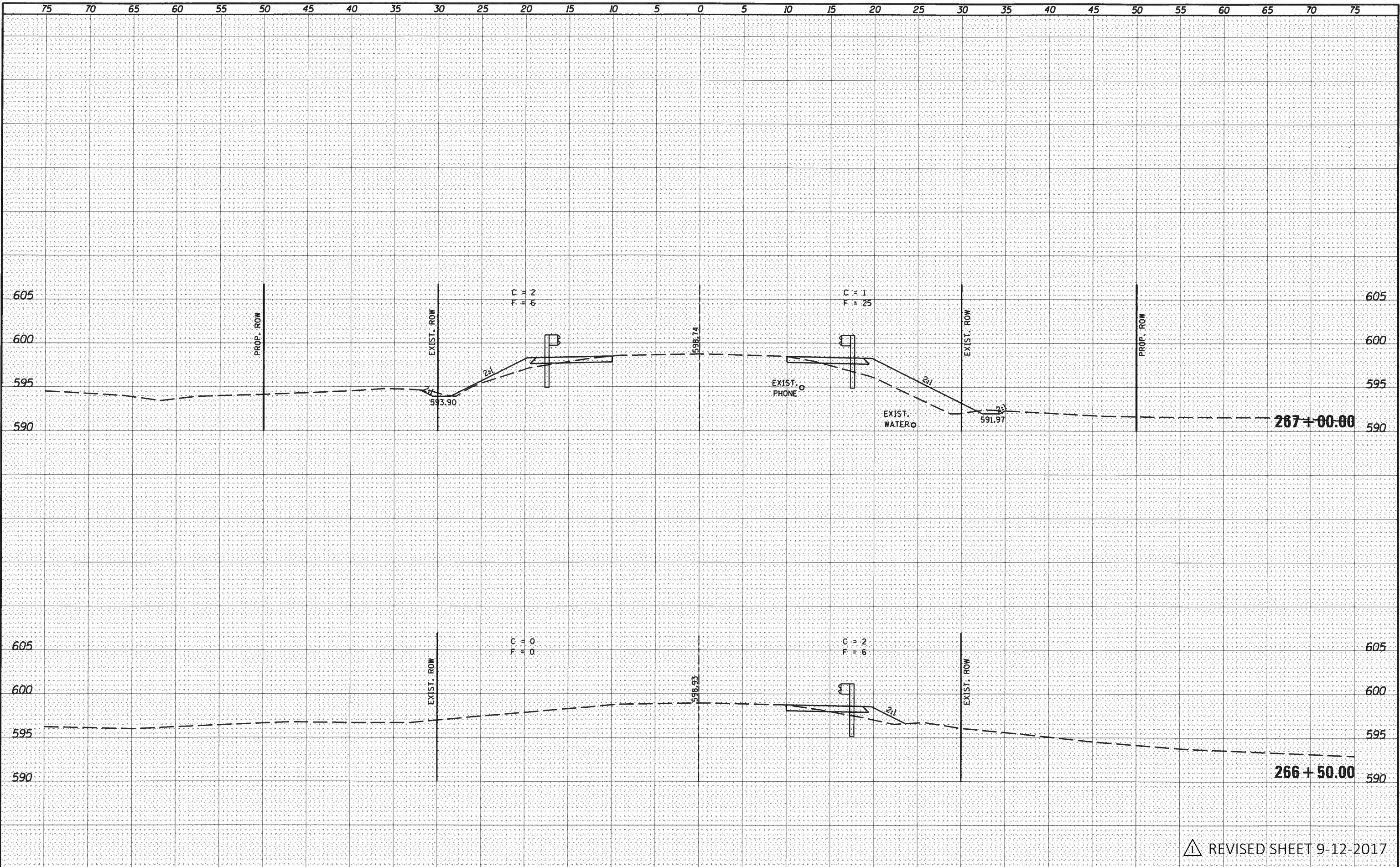

△ REVISED SHEET 9-12-2017

FILE NAME =	USER NAME = adamsam	DESIGNED -	REVISED -	<p align="center"><b>STATE OF ILLINOIS</b> <b>DEPARTMENT OF TRANSPORTATION</b></p> <p align="center"><b>CROSS SECTIONS</b> <b>SN 039-7119 (P)</b></p> <p>SCALE: _____ SHEET _____ OF _____ SHEETS STA. <b>266+50.00</b> TO STA. <b>267+00.00</b></p>	F.A. RTE.	SECTION	COUNTY	TOTAL SHEETS	SHEET NO.
pw:\IL084EB\INTEG.illinois.gov\PW\DOT\Documents\IDOT\offices\District 9\Projects\78500\CADData\CADsheets\78500\0397119\03971197_xs_sht.dgn		CHECKED -	REVISED -		*	12B-1;10B-2	--	32	27
PLOT SCALE = 10.0000' / in.		DATE -	REVISED -		CONTRACT NO. 78500				
PLOT DATE = 9/12/2017					ILLINOIS   FED. AID PROJECT				

\* FAU ROUTE 9909 & FAS ROUTE 1911 \*\* UNION & JACKSON

FINAL SURVEY	SUBMITTED	DATE
NOTE BOOK	REVIEWED	BY
NO.	TEMPERATURE	
	AREAS CHECKED	

ORIGINAL SURVEY	SUBMITTED	DATE
NOTE BOOK	REVIEWED	BY
NO.	TEMPERATURE	
	AREAS CHECKED	

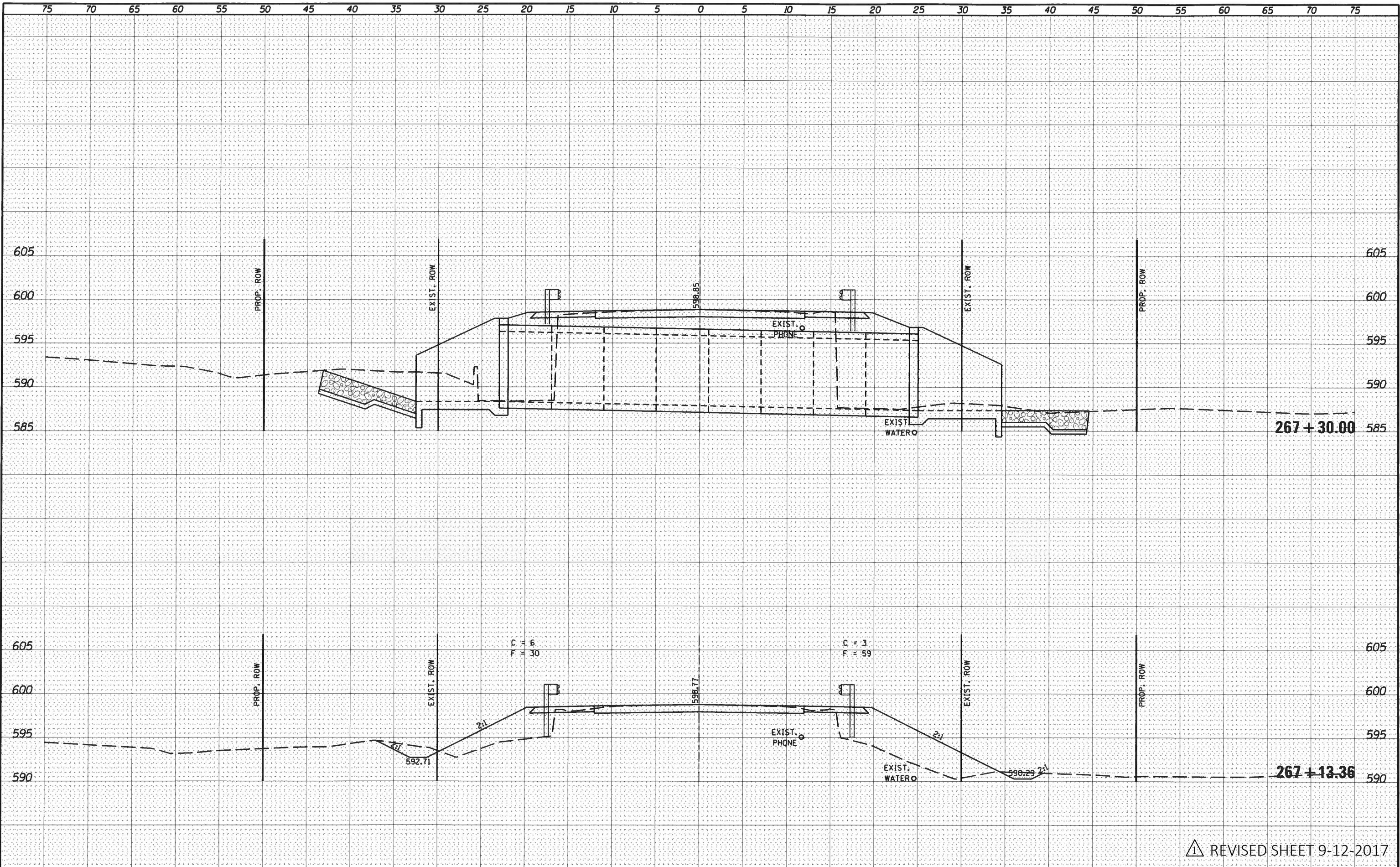

△ REVISED SHEET 9-12-2017

FILE NAME =	USER NAME = adamsam	DESIGNED -	REVISED -	<b>STATE OF ILLINOIS</b> <b>DEPARTMENT OF TRANSPORTATION</b>	<b>CROSS SECTIONS</b> <b>SN 039-7119 (P)</b>	F.A. RTE.	SECTION	COUNTY	TOTAL SHEETS	SHEET NO.	
pw:\IL084EBID\INTEG\Illinois.gov\PWIDOT\Documents\IDOT\offices\District 9\Projects\78500\CADData\CAD\Drawings\78500\000007_xs_sht.dgn		CHECKED -	REVISED -			*	12B-1;10B-2	**	32	28	
Default	PLOT DATE = 9/12/2017	DATE -	REVISED -			CONTRACT NO. 78500		ILLINOIS FED. AID PROJECT			
						SCALE: _____	SHEET _____ OF _____ SHEETS	STA. 267+13.36 TO STA. 267+30.00		* FAU ROUTE 9909 & FAS ROUTE 1911 ** UNION & JACKSON	



DATE	
BY	
SUBMITTED	
FINAL SURVEY	
NOTE BOOK	
NO.	

DATE	
BY	
SUBMITTED	
ORIGINAL SURVEY	
NOTE BOOK	
NO.	

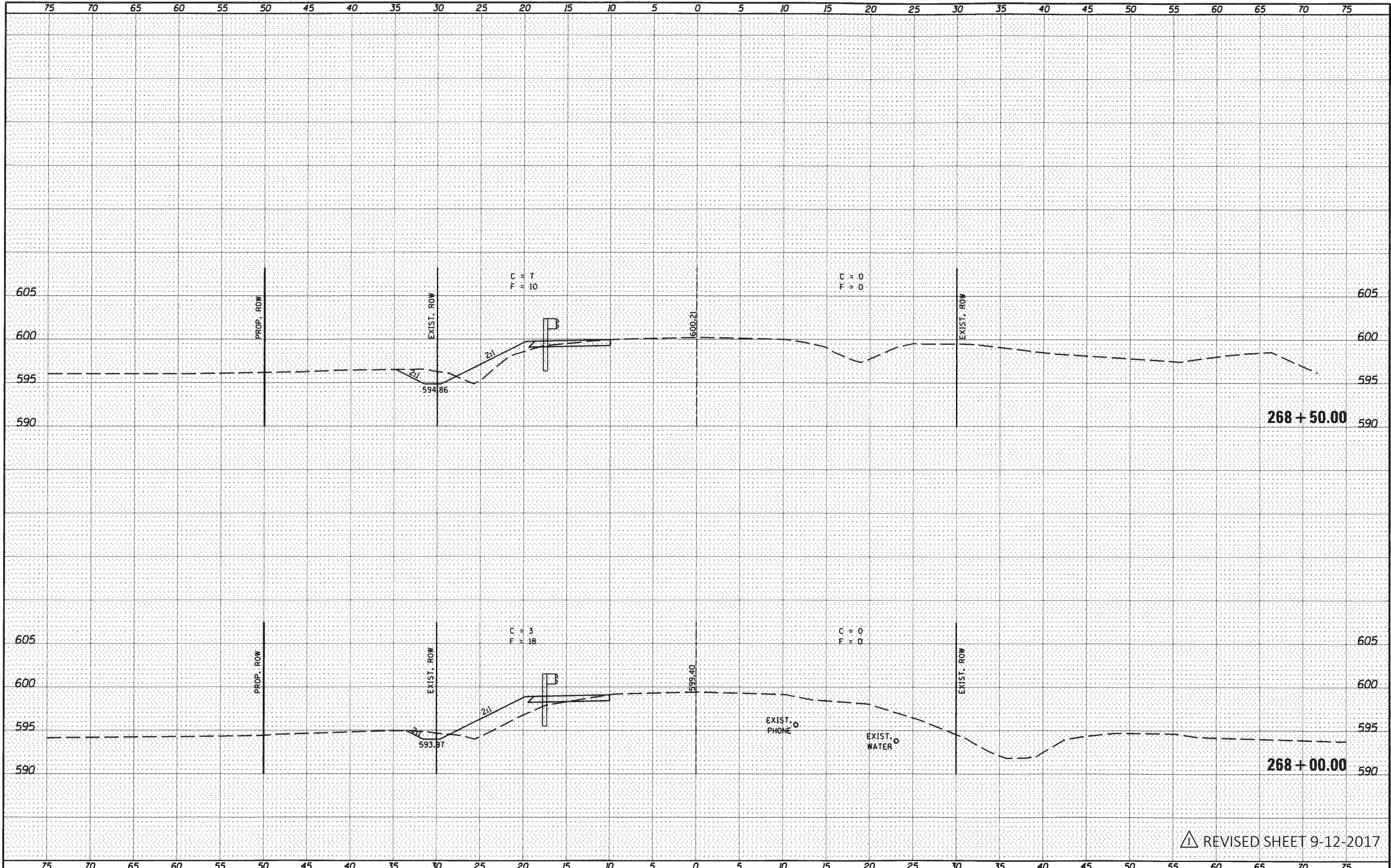

△ REVISED SHEET 9-12-2017

FILE NAME =	USER NAME = adamsam	DESIGNED -	REVISED -	<b>STATE OF ILLINOIS DEPARTMENT OF TRANSPORTATION</b>	<b>CROSS SECTIONS SN 039-7119 (P)</b>	F.A. RTE.	SECTION	COUNTY	TOTAL SHEETS	SHEET NO.	
pw:\U084EB\INTEG.illinois.gov\PW\DOT\Documents\DOT\Projects\District 9\Projects\78500\CADData\CAD\Sheets\78500\039-7119_7_xs_sht.dgn						*	12B-1;10B-2	**	32	30	
PLOT SCALE = 10.0000" / in.	CHECKED -	REVISED -	SCALE: _____			SHEET _____	OF _____	SHEETS	STA. 268+00.00	TO STA. 268+50.00	CONTRACT NO. 78500
PLOT DATE = 9/12/2017	DATE -	REVISED -	ILLINOIS   FED. AID PROJECT								

\* FAU ROUTE 9909 & FAS ROUTE 1911 \*\* UNION & JACKSON