

MODEL: Default
 FILE NAME: 1116974 Lechner_Various_Routes_Counties_PTB_190-03916974D - W04#4-Ruby_ST_ME1.0 Project Data\Cadd\CADD_REV\CivilRoadway_Sheets\0999901-62P11-03-500.dgn

CONSTRUCTION CODE	
BRIDGE	
0013	
80% FED 20% STATE	
URBAN	
RUBY STREET SN 099-9901	

CODE NO.	ITEM	UNIT	TOTAL QUANTITY	
67100100	MOBILIZATION	L SUM	1	1
70307120	TEMPORARY PAVEMENT MARKING - LINE 4" - TYPE IV TAPE	FOOT	800	800
X7010238	CHANGEABLE MESSAGE SIGN(SPECIAL)	CAL MO	9	9
X0326557	REFURBISHING OF OPERATING MACHINERY	L SUM	1	1
X0326559	NON-DESTRUCTIVE TESTING (NDT)	L SUM	1	1
X0326561	REPLACEMENT OF TRUNNION BEARING BOLTS AND ANCHOR BOLTS	L SUM	1	1
X6700407	ENGINEER'S FIELD OFFICE, TYPE A (D1)	CAL MO	15	15
X7010216	TRAFFIC CONTROL AND PROTECTION, (SPECIAL)	L SUM	1	1
Z0073500	TEMPORARY SUPPORT SYSTEM	L SUM	1	1
Z0073510	TEMPORARY TRAFFIC SIGNAL TIMING	EACH	17	17
Z0076600	TRAINEES	HOURS	2000	2000
Z0076604	TRAINEES - TRAINING PROGRAM GRADUATE	HOURS	2000	2000
Z0076700	TRUNNION BEARING GREASE GROOVE CLEANING	L SUM	1	1

Reference Drawings Key

- 1343-xx Original 1933 Design Plans
- 5075-xx Original 1935 Shop Drawings
- 60193-xx 2002 Bridge Rehabilitation Plans (Section M-B-DR-I-1)
- 62714-xx 2011 Bridge Repair Plans (Section M-BDR-1)
- 62A22-xx 2015 Bridge Repair Plans (Section 2014-078BR)
- 62B79-xx 2016 Bridge Repair Plans (Section M-BDR(BR))



USER NAME = USMA696622	DESIGNED -	REVISED -
	DRAWN - RM	REVISED -
PLOT SCALE = 2.0000' / in.	CHECKED - MPV	REVISED -
PLOT DATE = 7/19/2023	DATE -	REVISED -

**STATE OF ILLINOIS
 DEPARTMENT OF TRANSPORTATION**

SUMMARY OF QUANTITIES			
RUBY STREET OVER DES PLAINES RIVER (S.N. 099-9901)			
SCALE:	SHEET	OF	SHEETS
	STA.	TO	STA.

2 REVISIED SHEET 9/8/2023			0042
F.A.P. RTE.	SECTION	COUNTY	TOTAL SHEETS
112	2021-074-BR&BP	WILL	16
			3
			CONTRACT NO. 62P11
			ILLINOIS FED. AID PROJECT

MODEL: Default
 FILE: \\na-jackson-bvld-svte-400-1\DOT Phase II Verbose Design\20230425-00 - IDOT Phase II Verbose Design\20230425-00.WD08_62P11_IL 53.ctb
 PROJECT: \\na-jackson-bvld-svte-400-1\DOT Phase II Verbose Design\20230425-00 - IDOT Phase II Verbose Design\20230425-00.WD08_62P11_IL 53.ctb
 DRAWING: \\na-jackson-bvld-svte-400-1\DOT Phase II Verbose Design\20230425-00 - IDOT Phase II Verbose Design\20230425-00.WD08_62P11_IL 53.ctb
 CURRENT: \\na-jackson-bvld-svte-400-1\DOT Phase II Verbose Design\20230425-00 - IDOT Phase II Verbose Design\20230425-00.WD08_62P11_IL 53.ctb

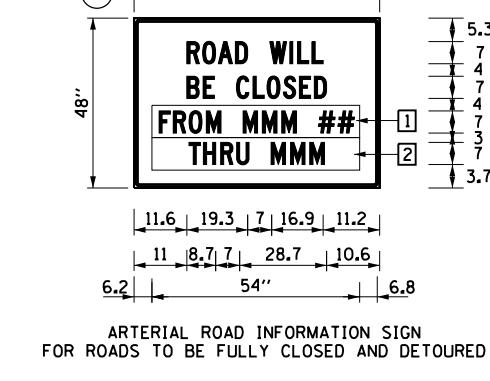
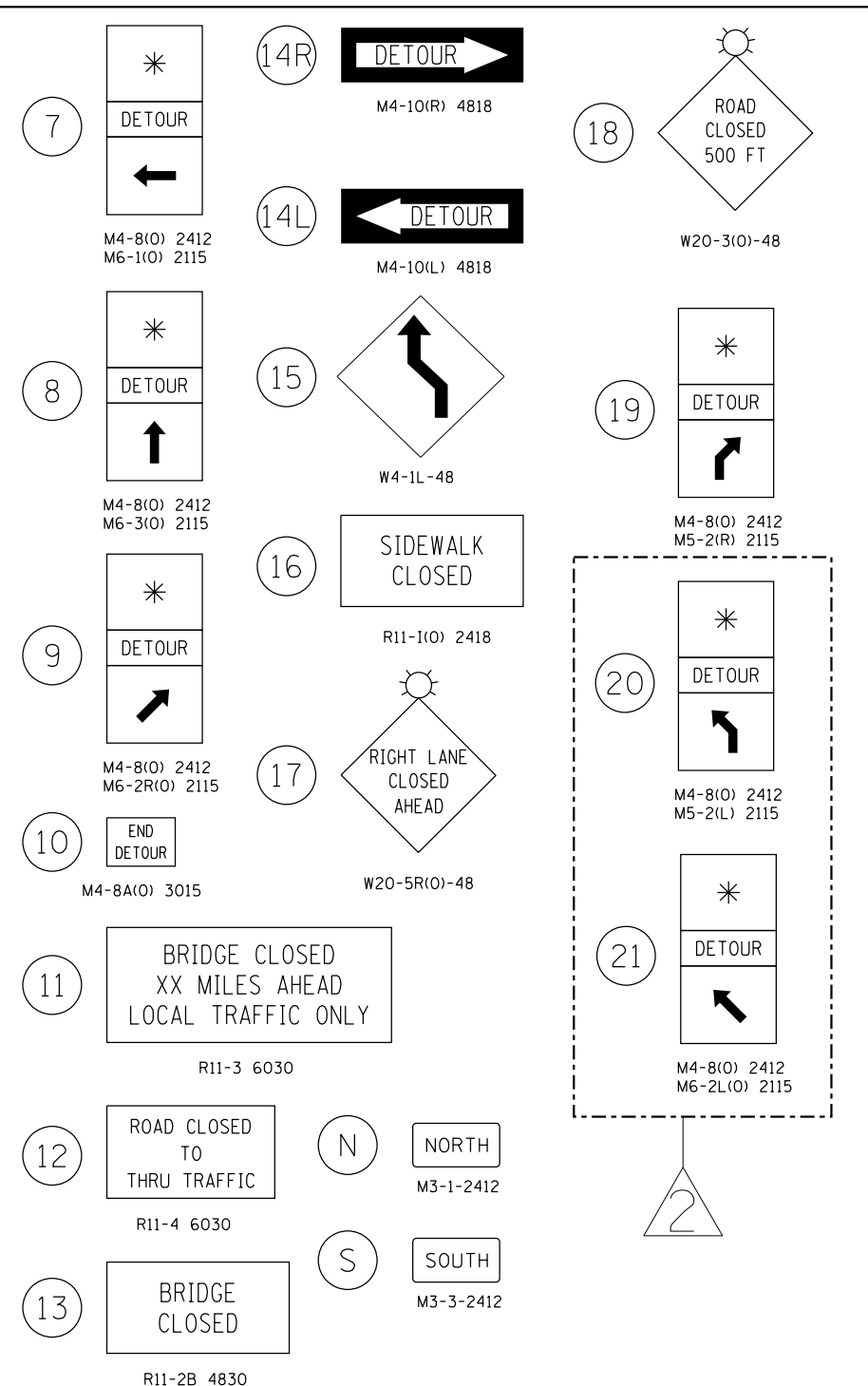
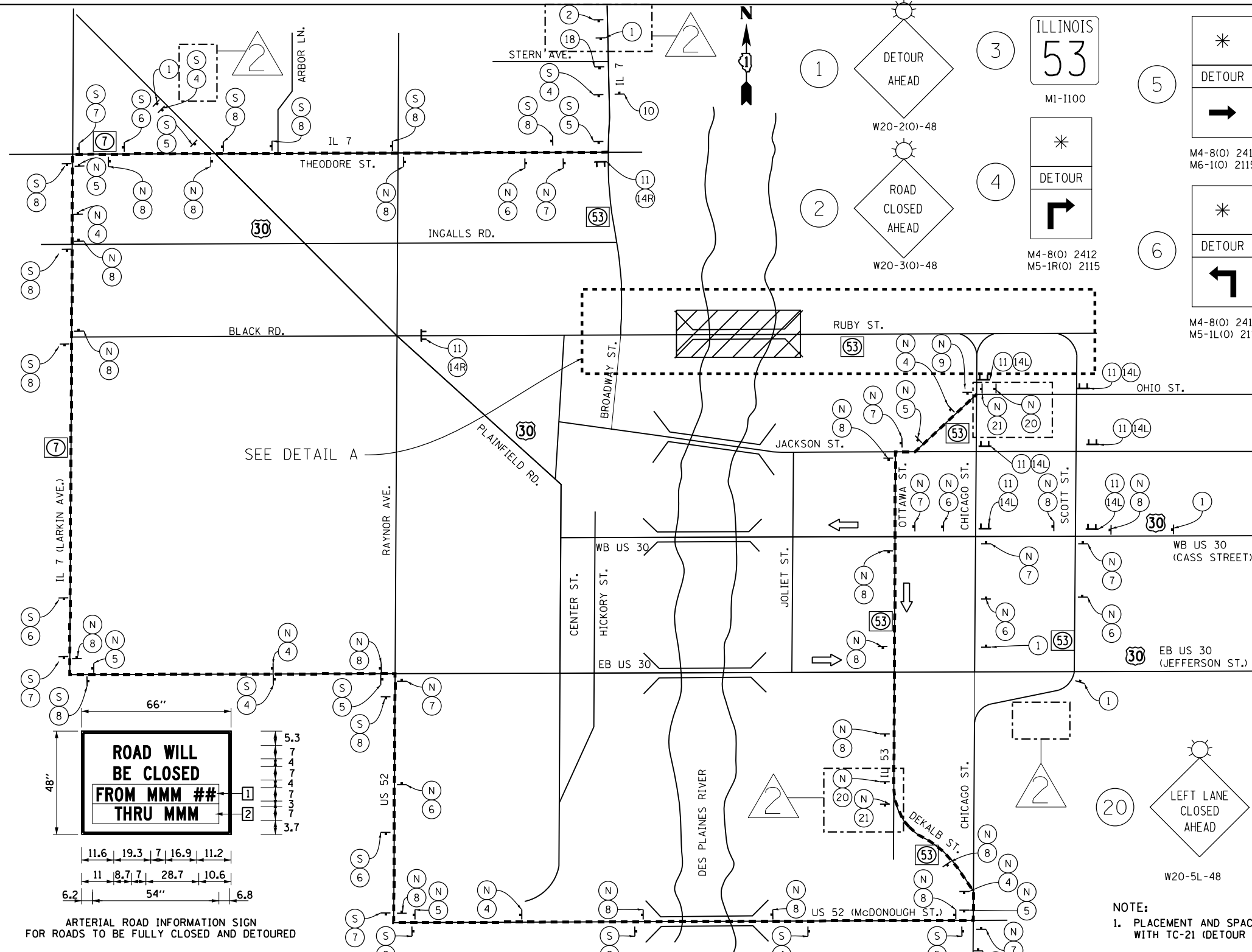

- ARTERIAL ROAD INFORMATION SIGN NOTES:**
- SIGN SHALL BE PAID FOR AS TEMPORARY INFORMATION SIGNING. ONE SIGN ASSEMBLY EQUALS 27.3 SQ FT.
 - OVERLAY PANELS SHALL BE "HIGHWAY C" FONT
 - OVERLAY PANEL 1 TO CONTAIN STARTING DATE OF FULL CLOSURE AND DETOUR IMPLEMENTATION
 - OVERLAY PANEL 2 TO CONTAIN ENDING MONTH OF FULL CLOSURE AND DETOUR. OMIT THE DATE ON PANEL; MONTH ONLY.
 - ERECT SIGN ASSEMBLY (POST-MOUNTED) WITH PANELS 1 AND 2 IN PLACE ON ROAD TO BE CLOSED IN EACH DIRECTION NEAR POINT OF CLOSURE OR WITHIN SECTION TO BE FULLY CLOSED TWO (2) WEEKS PRIOR TO START DATE OF FULL CLOSURE. REMOVE ASSEMBLY AFTER CLOSURE.

- LEGEND:**
- * SEE ROUTE MARKER - SEE SIGN 3
 - DETOUR ROUTE
 - ▨ CONSTRUCTION ZONE
 - ⊥ SIGN PANEL
 - ⊥ TYPE III BARRICADE W/2 STEADY BURN LIGHTS EACH (2 OR MORE)
 - ⊙ AMBER FLASHING LIGHT
 - ⚠ SIGN 14 IS TO BE MOUNTED ABOVE TYPE III BARRICADE
 - ⚠ REVISED SHEET 9/8/2023

- NOTE:**
- PLACEMENT AND SPACING OF SIGNS AND BARRICADES SHALL BE IN ACCORDANCE WITH TC-21 (DETOUR SIGNING FOR CLOSING STATE HIGHWAYS).
 - THE COST OF SUPPLYING, ERECTING AND MAINTAINING BARRICADES, WARNING LIGHTS AND SIGNS SHALL BE INCLUDED IN THE CONTRACT COST OF TRAFFIC CONTROL AND PROTECTION (SPECIAL).
 - THE CONTRACTOR SHALL DEVELOP AND MAINTAIN APPROPRIATE SIGNAL TIMINGS FOR THE FOLLOWING INTERSECTIONS, OR AS DIRECTED BY THE ENGINEER
 - A) THEODORE ST/BROADWAY ST H) LARKIN AVE/BLACK RD O) RAYNOR AVE/MARION AVE
 - B) THEODORE ST/RAYNOR AVE I) LARKIN AVE/GLENWOOD AVE P) RAYNOR AVE/MCDONOUGH ST
 - C) THEODORE ST/ARBOR LN J) LARKIN AVE/JEFFERSON ST Q) MCDONOUGH ST/CHICAGO ST
 - D) THEODORE ST/US ROUTE 30 K) JEFFERSON ST/STRYKER AVE
 - E) THEODORE ST/LARKIN AVE L) JEFFERSON ST/MIDLAND AVE
 - F) LARKIN AVE/PRIVATE DRIVE M) JEFFERSON ST/REED ST (NORTH RIDGE PLAZA)
 - G) LARKIN AVE/INGALLS AVE N) JEFFERSON ST/RAYNOR AVE
 - THE CONTRACTOR SHALL NOT OBSTRUCT ANY EXISTING SIGN WITH THE PLACEMENT OF DETOUR SIGNS.
 - THE CONTRACTOR SHALL MAINTAIN LOCAL ACCESS TO RESIDENTS AND BUSINESSES AT ALL TIMES.



USER NAME = rvandemus	DESIGNED -	REVISED - 09/06/2023 RMV
DRAWN - RM	REVISOR -	
CHECKED - MPV	REVISOR -	
DATE - 9/6/2023	REVISOR -	

**STATE OF ILLINOIS
DEPARTMENT OF TRANSPORTATION**

**MAINTENANCE OF TRAFFIC DETOUR PLANS
RUBY STREET OVER DES PLAINES RIVER (S.N. 099-9901)**

F.A.P. RTE. 112	SECTION 2021-074-BR&BP	COUNTY WILL	TOTAL SHEETS 72	SHEET NO. 4
CONTRACT NO. 62P11				
ILLINOIS FED. AID PROJECT				

SCALE: SHEET OF SHEETS STA. TO STA.

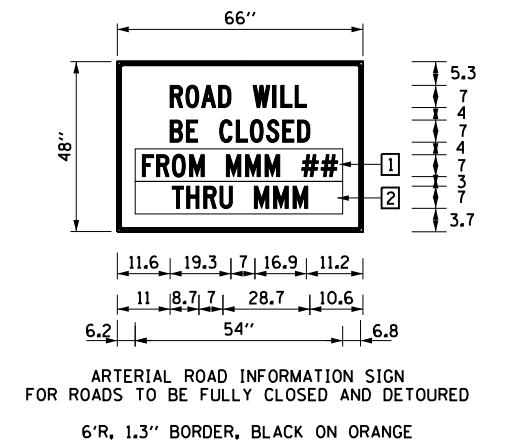
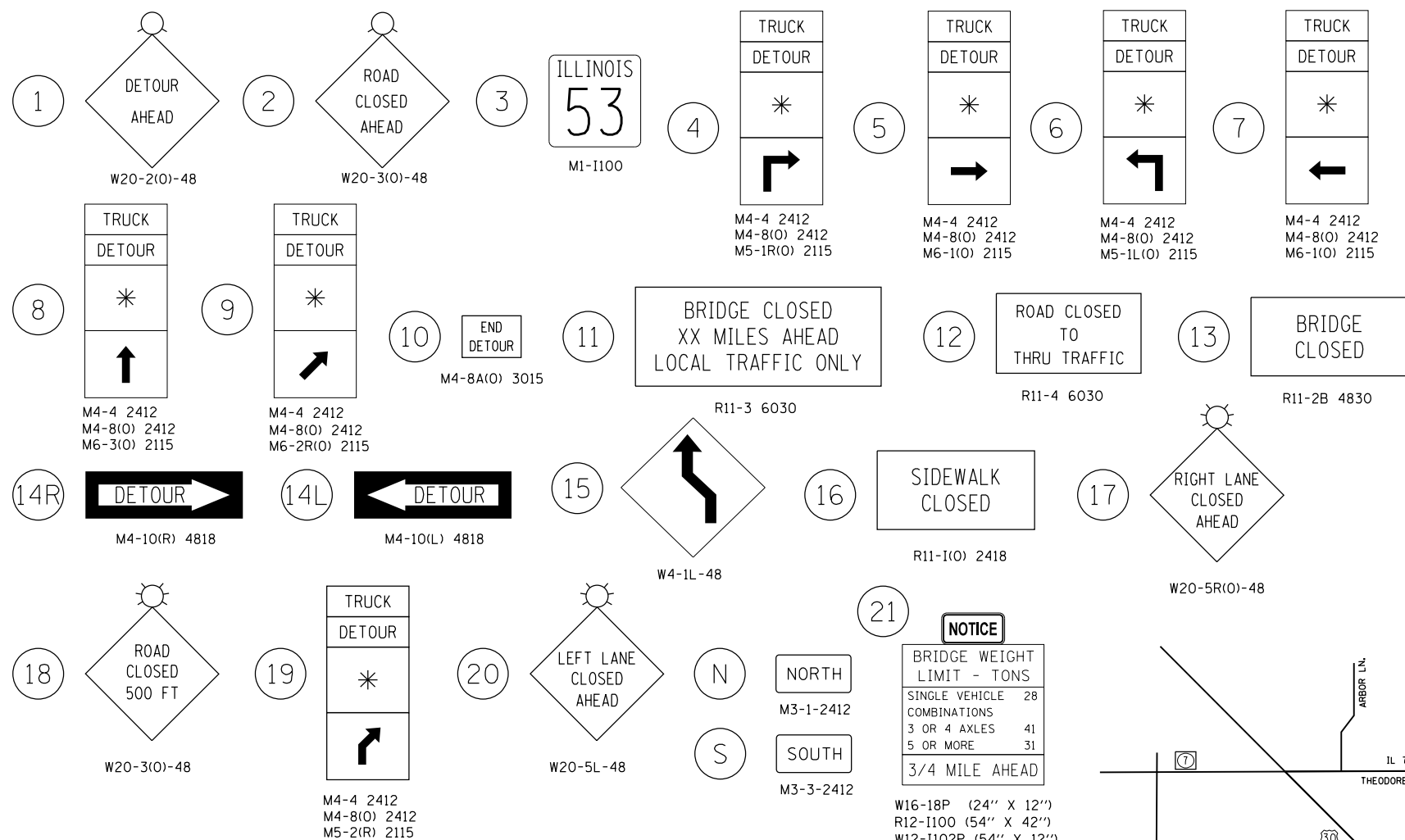

- NOTE:**
1. PLACEMENT AND SPACING OF SIGNS AND BARRICADES SHALL BE IN ACCORDANCE WITH TC-21 (DETOUR SIGNING FOR CLOSING STATE HIGHWAYS).
 2. THE COST OF SUPPLYING, ERECTING AND MAINTAINING BARRICADES, WARNING LIGHTS AND SIGNS SHALL BE INCLUDED IN THE CONTRACT COST OF TRAFFIC CONTROL AND PROTECTION (SPECIAL).
 3. THE CONTRACTOR SHALL DEVELOP AND MAINTAIN APPROPRIATE SIGNAL TIMINGS FOR THE FOLLOWING INTERSECTIONS, OR AS DIRECTED BY THE ENGINEER.

A) SCOTT ST. / JEFFERSON ST.	H) COLLINS ST. / COLUMBIA ST.
B) JEFFERSON ST. / EASTERN AVE.	I) COLLINS ST. / WOODRUFF RD.
C) JEFFERSON ST. / RICHARDS ST.	J) STATE ST. / DIVISION ST.
D) COLLINS ST. / CASS ST.	K) STATE ST. / 13TH ST.
E) COLLINS ST. / JACKSON ST.	L) STATE ST. / 10TH ST.
F) COLLINS ST. / HERKIMER DR	M) STATE ST. / 9TH ST.
G) COLLINS ST. / OHIO ST.	N) 9TH ST. / INDEPENDENCE BLVD
 4. THE CONTRACTOR SHALL NOT OBSTRUCT ANY EXISTING SIGN WITH THE PLACEMENT OF DETOUR SIGNS.
 5. THE CONTRACTOR SHALL MAINTAIN LOCAL ACCESS TO RESIDENTS AND BUSINESSES AT ALL TIMES.

- ARTERIAL ROAD INFORMATION SIGN NOTES:**
1. SIGN SHALL BE PAID FOR AS TRAFFIC CONTROL AND PROTECTION, SPECIAL. ONE SIGN ASSEMBLY EQUALS 27.3 SQ FT.
 2. OVERLAY PANELS SHALL BE "HIGHWAY C" FONT
 3. OVERLAY PANEL 1 TO CONTAIN STARTING DATE OF FULL CLOSURE AND DETOUR IMPLEMENTATION
 4. OVERLAY PANEL 2 TO CONTAIN ENDING MONTH OF FULL CLOSURE AND DETOUR. OMIT THE DATE ON PANEL; MONTH ONLY.
 5. ERECT SIGN ASSEMBLY (POST-MOUNTED) WITH PANELS 1 AND 2 IN PLACE ON ROAD TO BE CLOSED IN EACH DIRECTION NEAR POINT OF CLOSURE OR WITHIN SECTION TO BE FULLY CLOSED TWO (2) WEEKS PRIOR TO START DATE OF FULL CLOSURE. REMOVE ASSEMBLY AFTER CLOSURE.

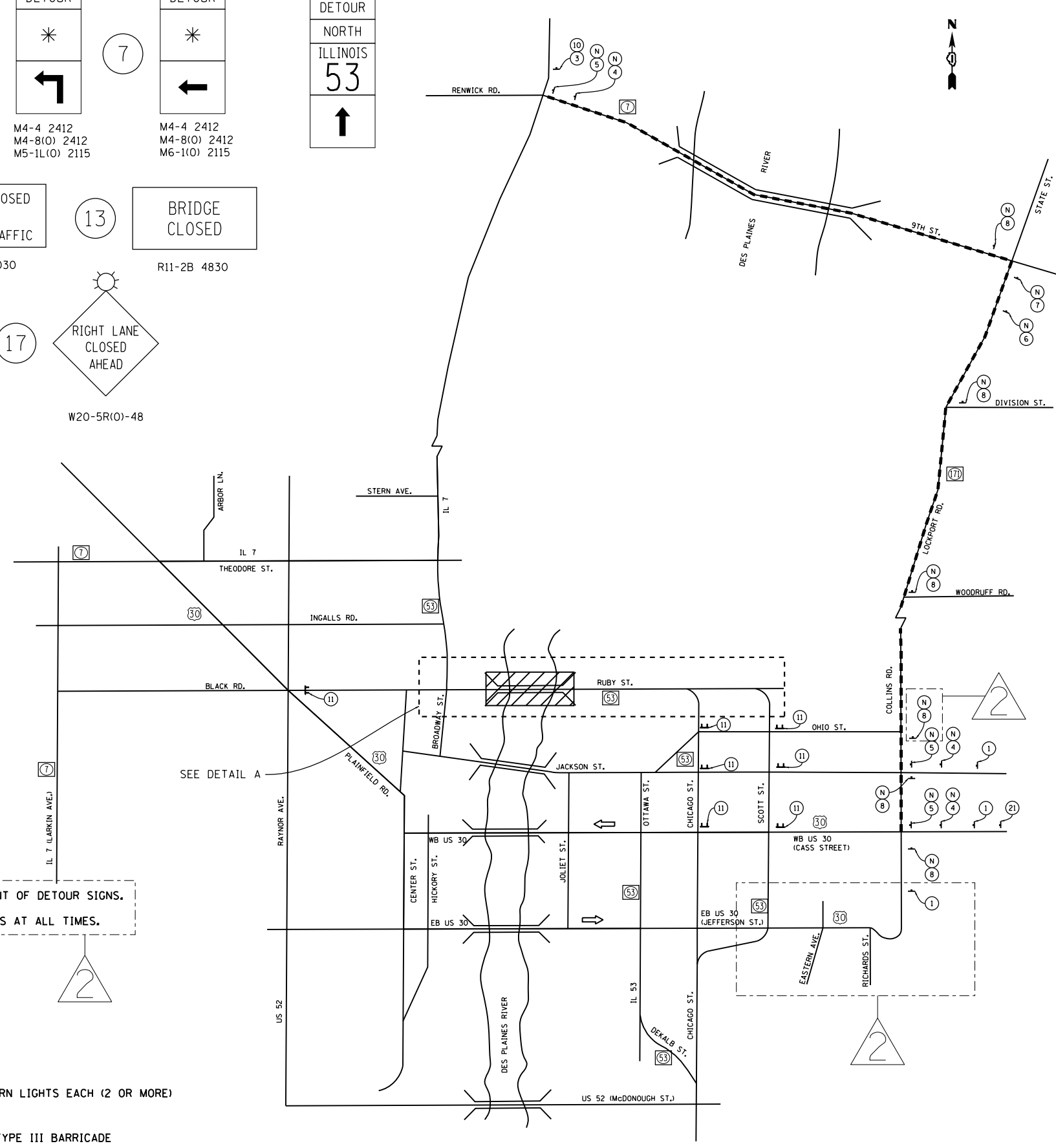
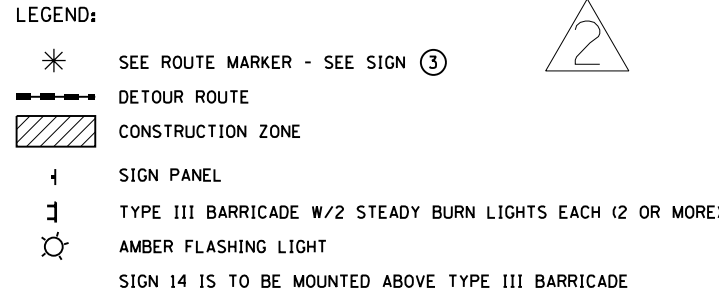

MODEL: Default
 FILE: \\blm\c:\p\primera-pw\k\ben\p\primera-pw\01\Documents\01 - Project\Phase II Verbose Design\20230425\08_W008_62P11_IL 53 at DesPlaines_River\Drawings\Current_Drawing_Files\CADD_Sheet\Roadway\0999901_62P11-05-MOT-C02
 450 N. JACKSON BLVD, SUITE 400, CHICAGO, IL 60611, P.312-405-4000 F.312-405-4015



USER NAME = r.vandermus	DESIGNED -	REVISED - 09/06/2023 RMV
PLOT SCALE = 40,0000 ' / in.	DRAWN - RM	REVISED -
PLOT DATE = 9/6/2023	CHECKED - MPV	REVISED -
	DATE -	REVISED -

**STATE OF ILLINOIS
DEPARTMENT OF TRANSPORTATION**

**MAINTENANCE OF TRAFFIC DETOUR PLANS
RUBY STREET OVER DES PLAINES RIVER (S.N. 099-9901)**

F.A.P. RTE.	SECTION	COUNTY	TOTAL SHEETS	SHEET NO.
112	2021-074-BR&BP	WILL	72	5
CONTRACT NO. 62P11				
ILLINOIS FED. AID PROJECT				

2 REVISED SHEET 9/8/2023

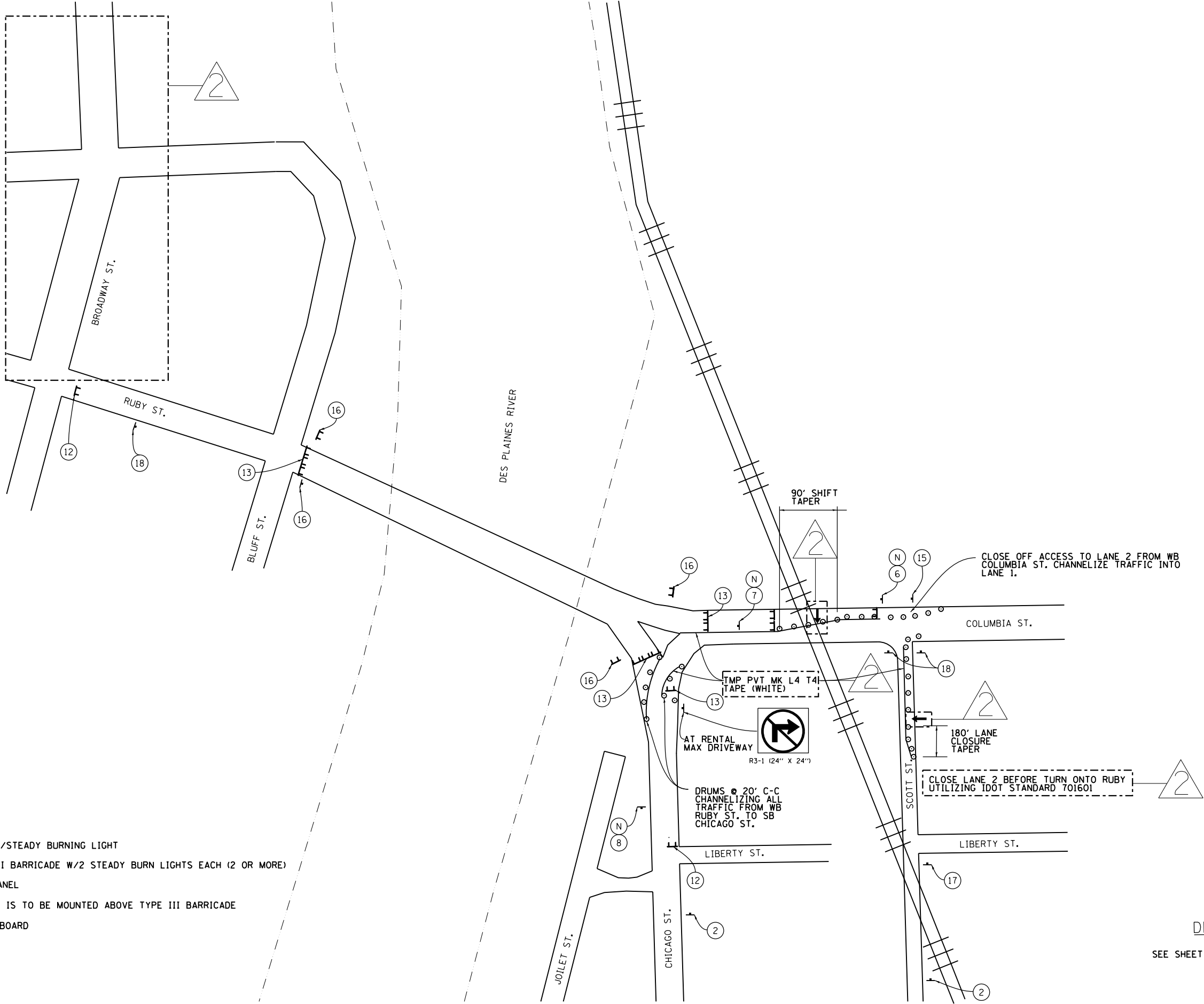

- LEGEND:**
- ⊙ DRUM W/STEADY BURNING LIGHT
 - ⊠ TYPE III BARRICADE W/2 STEADY BURN LIGHTS EACH (2 OR MORE)
 - ⊣ SIGN PANEL
 - ⊣ SIGN 14 IS TO BE MOUNTED ABOVE TYPE III BARRICADE
 - ➔ ARROW BOARD

DETAIL A
SEE SHEET 4 FOR SIGN LEGEND

REVISOR'S MARK: REVISED SHEET 9/8/2023

MODEL: Default
 FILE: \\bluffc:\pwworking\primera-pw\bluffc\pwworking\primera-pw\01\Documents\01 - Project\2023\09\04\25\00 - IDOT Phase II Verbus - Detail\20230925\08_W008_62P11_IL_S3_at_DesPlaines_River\Drawings\Current Drawings Files\CADD_Sheet\Roadway\0999901_62P11-06-MOT-C03



USER NAME = r.vandermus	DESIGNED -	REVISED - 09/06/2023 RMV
PLOT SCALE = 1/60,000 S. / in.	DRAWN - RM	REVISED -
PLOT DATE = 9/6/2023	CHECKED - MPV	REVISED -
	DATE -	REVISED -

**STATE OF ILLINOIS
DEPARTMENT OF TRANSPORTATION**

**MAINTENANCE OF TRAFFIC DETOUR PLANS
RUBY STREET OVER DES PLAINES RIVER (S.N. 099-9901)**

SCALE: SHEET OF SHEETS STA. TO STA.

F.A.P. RTE.	SECTION	COUNTY	TOTAL SHEETS	SHEET NO.
112	2021-074-BR&BP	WILL	72	6
CONTRACT NO. 62P11				
ILLINOIS FED. AID PROJECT				