

F.A.I. RTE.	SECTION	COUNTY	TOTAL SHEETS	SHEET NO.
55	2005-040 GPR	WILL	14	6
STA. 98+00		TO STA. 113+00		
FED. ROAD DIST. NO.	ILLINOIS	FED. AID PROJECT		

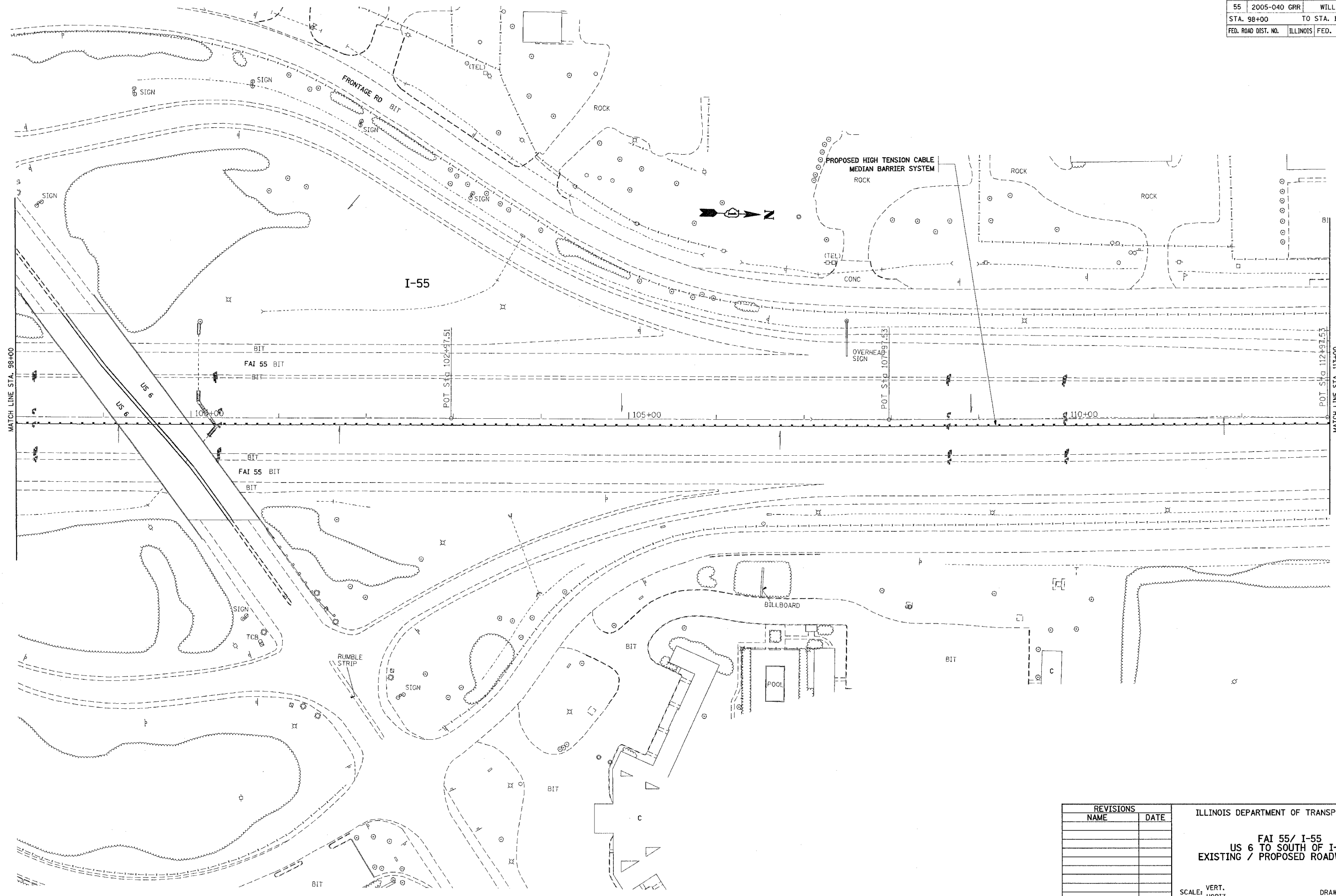

REVISIONS	
NAME	DATE

ILLINOIS DEPARTMENT OF TRANSPORTATION

**FAI 55/ I-55**  
**US 6 TO SOUTH OF I-80**  
**EXISTING / PROPOSED ROADWAY PLAN**

SCALE: VERT. \_\_\_\_\_  
 HORIZ. \_\_\_\_\_

DATE \_\_\_\_\_

DRAWN BY: HMO  
 CHECKED BY: \_\_\_\_\_

PLOT DATE = 7/16/2005  
 FILE NAME = c:\p\proj\60a11\27205\sh\11-85co-2.dwg  
 PLOT SCALE = 5/8"=1' IN.  
 USER NAME = cmanhin