

F.A. RTE.	SECTION	COUNTY	TOTAL SHEETS	SHEET NO.
55	2005-040 GRR	WILL	14	10
STA. 158+00		TO STA. 173+00		
FED. ROAD DIST. NO.		ILLINOIS FED. AID PROJECT		

MAINTENANCE

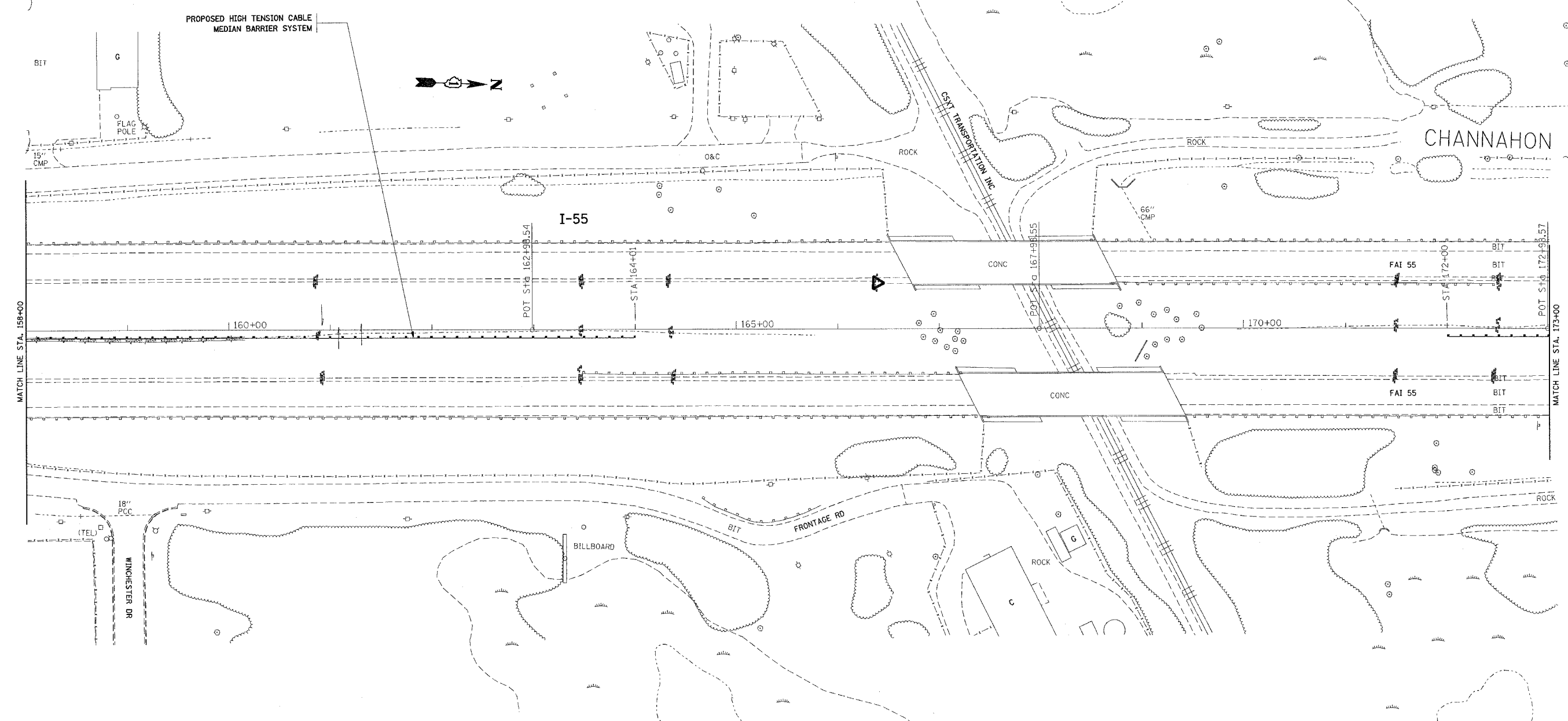

REVISIONS		ILLINOIS DEPARTMENT OF TRANSPORTATION
NAME	DATE	
		<p align="center">FAI 55/ I-55 US 6 TO SOUTH OF I-80 EXISTING / PROPOSED ROADWAY PLAN</p> <p>SCALE: VERT. 1"=50' HORIZ. 1"=50' DATE 7/8/2005</p> <p align="right">DRAWN BY: HMO CHECKED BY:</p>

PLOT DATE = 7/8/2005
 PLOT NAME = I:\AS\1127285\1127285\1127285.dwg
 PLOT SCALE = 5/8"=1'-0"
 USER NAME = osmerhm