

F.A.I. RTE.	SECTION	COUNTY	TOTAL SHEETS	SHEET NO.
94/90		COOK	598	368
STA. 1482+50		TO STA. 1494+50		
FED. ROAD DIST. NO.	ILLINOIS FED. AID PROJECT			
62302 • (1818, ETC, 2324.6-1)PR-9				



HH 3408, TYPE S1
STA 1488+71, FUTURE WORK BY OTHERS
3" PVC ENCASED, FUTURE WORK BY OTHERS
2" GSC IN TRENCH, FUTURE WORK BY OTHERS

HH 3409, TYPE S1
STA 1488+71
3" PVC ENCASED

2" GSC IN TRENCH, BY OTHERS

NOTE: PER OVERHEAD SIGN FOUNDATION PLANS,
PROVIDE 3" GSC STUBOUT FOR FUTURE CONNECTION

NOTE: PROVIDE 3' OF 2" GSC STUBOUT
FOR FUTURE CONDUIT CONNECTION
CENTER OF CONDUIT ELEV. = 5.66

MATCH LINE STA. 1482+50
SEE SHEET EI-33

MATCH LINE STA. 1494+50
SEE SHEET EI-35

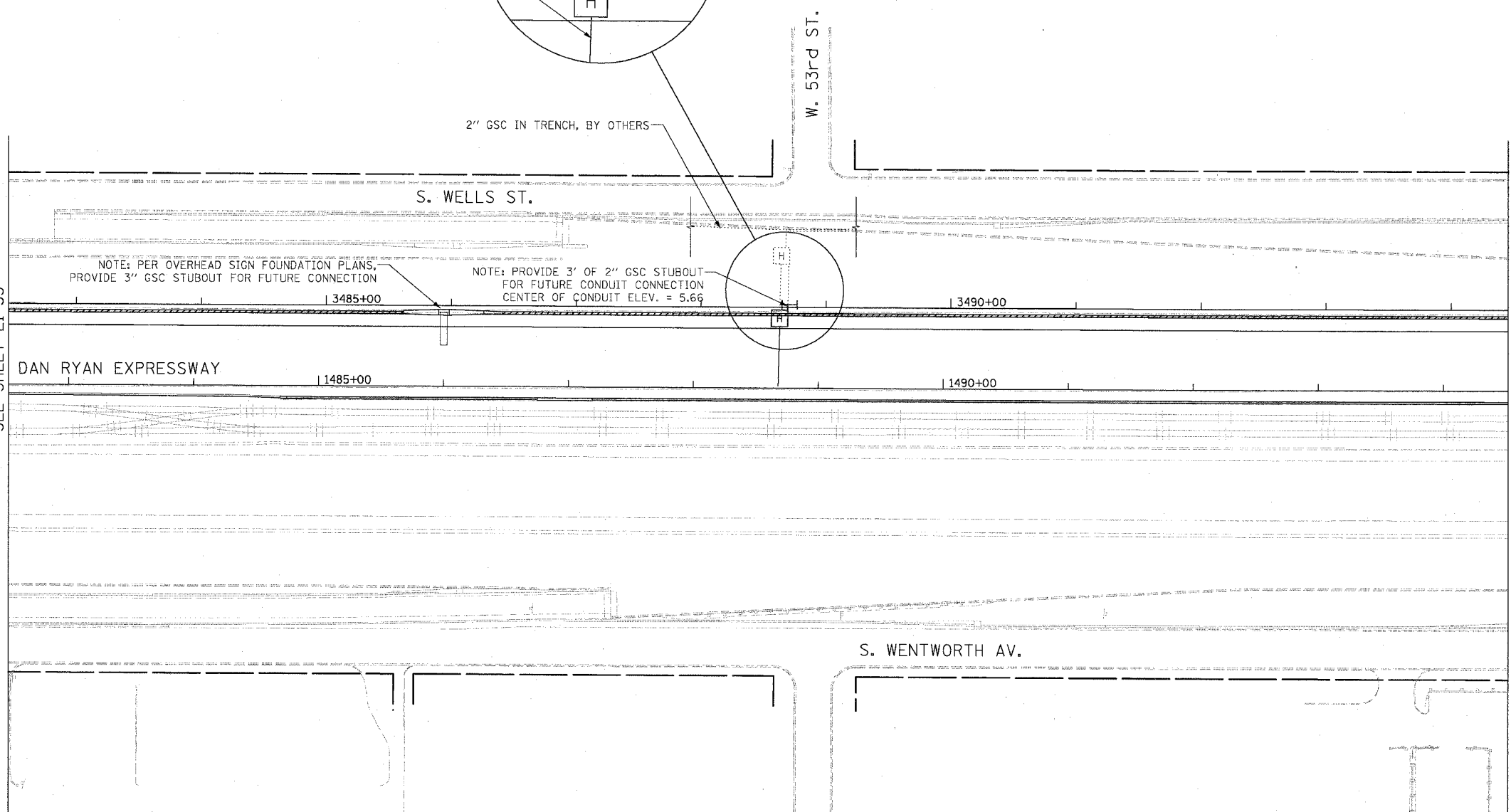

- NOTES:**
1. SEE DRAWING EI-100 AND EI-101 FOR ELECTRICAL SYSTEMS AND ABBREVIATIONS.
 2. UNLESS OTHERWISE STATED, ALL NOTED CABLE TO BE FURNISHED AND INSTALLED UNDER ANOTHER CONTRACT.
 3. TRENCHED CONDUITS INSTALLED IN PARALLEL ARE TO BE INSTALLED IN COMMON TRENCH.
 4. THIS SHEET ONLY DEPICTS INSTALLATION OF DETECTION/RAMP METER ELEMENTS. REFER TO SHEETS FOR OTHER SUBSYSTEMS FOR ADDITIONAL ELEMENTS IN THE AREA SHOWN.
 5. DETECTOR LOOPS INSTALLED BY OTHERS.
 6. REFER TO HANDHOLE DETAILS. SEE DRAWING DT-29.



EI-34

**Edwards
AND
Kelcey**
ONE NORTH FRANKLIN
CHICAGO, IL 60606
PHONE: (312) 251-3000
FAX: (312) 251-3015
WEB: WWW.EKCORP.COM

REVISIONS	
NAME	DATE

ILLINOIS DEPARTMENT OF TRANSPORTATION
F.A.I. 94/90 (DAN RYAN EXPRESSWAY)
31ST STREET TO 71ST STREET
SB EXPRESS LANE RECONSTRUCTION
ELECTRICAL INFRASTRUCTURE PLAN
SOUTHBOUND STA 1482+50 TO 1494+50

SCALE: 1"=50'
DATE: 7/7/05

DRAWN BY: CJH
CHECKED BY: MJL

06/24/2005 12:02:51 PM