

62806

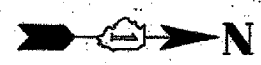

F. A. RITE	SECTION	COUNTY	TOTAL SHEETS	SHEET NO.
90/94	#	COOK	35	22
STA. 556+00	TO STA. 565+00			
FED. ROAD DIST. NO. 1		ILLINOIS	FED AID PROJECTS	
* 2004-067L				

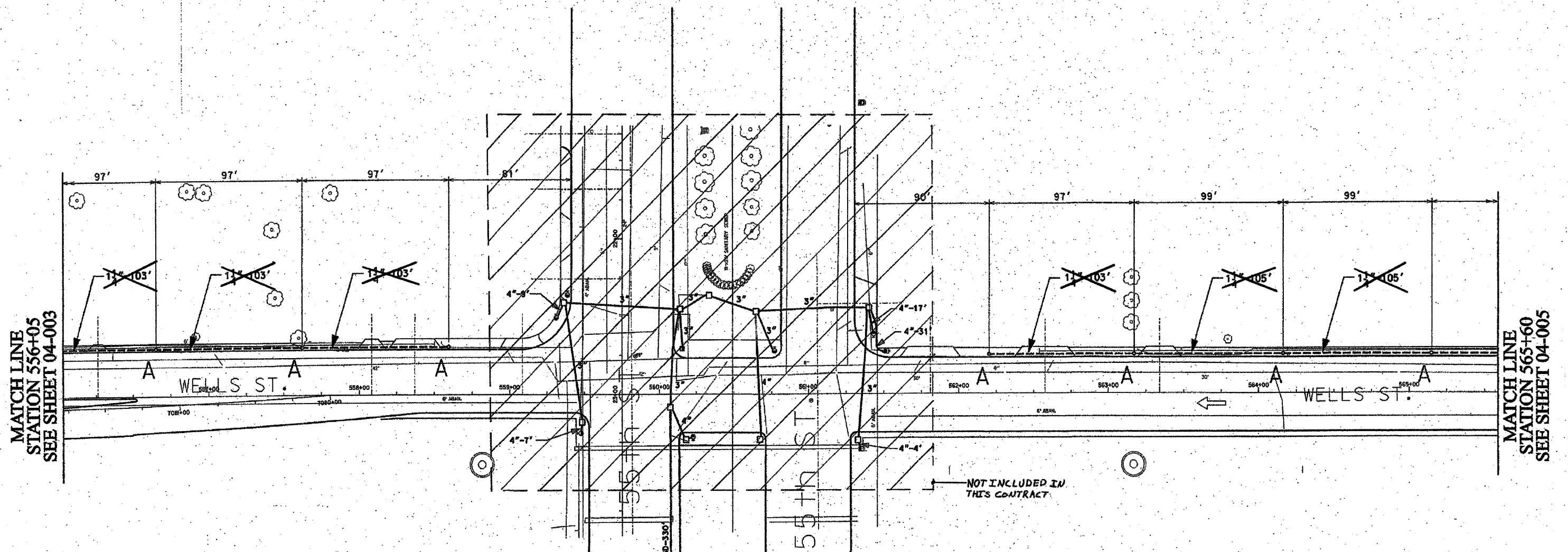

MATCH LINE  
STATION 556+05  
SEE SHEET 04-003

MATCH LINE  
STATION 565+60  
SEE SHEET 04-005

NOT INCLUDED IN THIS CONTRACT

- ~~1" DIRECT BORED CONDUIT SCHEDULE #80 AS PER IDOT ARTICLE 010.03~~
- ~~4" DIRECT BORED CONDUIT SCHEDULE #80 AS PER IDOT ARTICLE 010.03~~
- ~~2" CONDUIT SCHEDULE #40 INSTALLED IN TRENCH AS PER IDOT ARTICLE 010.03~~
- ~~2" GALVANIZED RIGID STEEL ELBOW ON STRUCTURE~~
- ~~2" GALVANIZED RIGID STEEL CONDUIT INSTALLED IN TRENCH AS PER IDOT ARTICLE 010.03~~
- ~~HAND HOLE 30" x 36" WITH 24" FRAME AND COVER~~
- ~~CONCRETE FOUNDATION - 5' x 20", 10" B.C., 1" ANCHOR RODS~~

**NOTES: CONTRACTOR IS TO ~~INSTALL UNDERGROUND CONDUIT AND PULL ROPE BETWEEN FOUNDATIONS AS WELL AS~~ PERFORM THE FOLLOWING WORK ITEMS ACCORDING TO BUREAU OF ELECTRICITY SPECIFICATIONS:**

"A" - INSTALL 20" x 5' FOUNDATION, 10" B.C., 1" ANCHOR RODS AS PER DRAWING NO. 565, 2' OFF FACE OF CURB, UNLESS NOTED OTHERWISE. BUILD FOUNDATIONS FLUSH WITH SIDEWALK SURFACE.

"B" - INSTALL 30" HANDHOLE AS PER DRAWING NO. 867 WITH 24" FRAME AND COVER.

FOR INSTALLATION PLAN SEE SHEETS 04-017, 04-018  
FOR REMOVAL PLAN SEE SHEET 04-025

CITY OF CHICAGO  
DEPT. OF STREETS AND SANITATION  
BUREAU OF ELECTRICITY  
DIVISION OF ELECTRICAL ENGINEERING

DRAFTSMAN B. GARNSEY	CHIEF DRAFTSMAN ROBERT CARTER	ENGINEER B. GARNSEY
SUPERVISING ENGINEER	ELEC. DESIGN ENGR.	DWG. NO. <b>04-004</b>
ENGINEER OF ELECTRICITY		DATE: 1/20/04
GEN'L SUPT. OF ELECTRICITY		SCALE: 1" = 30'
DEPUTY COMMISSIONER		DRAWN BY: B.T.G.
ILLINOIS DEPARTMENT OF TRANSPORTATION F.A.I. 90/94 (DAN RYAN EXPRESSWAY) 57th St. TO 47th St. (FRONTAGE ROADS)		
STREET LIGHTING UNDERGROUND CONDUIT FACILITIES		
DATE: February 11, 2005		CHECKED BY: O.L.

REVISIONS	
NAME	DATE

Revised Sheet 9/9/05