

62807



NOTE: CONTRACTOR IS TO CONTACT ALL UTILITY COMPANIES TO VERIFY EXACT LOCATION OF UNDERGROUND UTILITIES PRIOR TO START OF CONSTRUCTION WORK. MOVE FOUNDATIONS AND CONDUIT RUNS ACCORDINGLY.

F. A. RTE	SECTION	COUNTY	TOTAL SHEETS	SHEET NO.
90/94	*	COOK	37	25
STA. 191+05	TO STA. 204+00			
FED. ROAD DIST NO. 1	ILLINOIS	FED AID PROJECTS		

* 2004-068 L

MATCH LINE
STATION 191+05
SEE SHEET 04-013

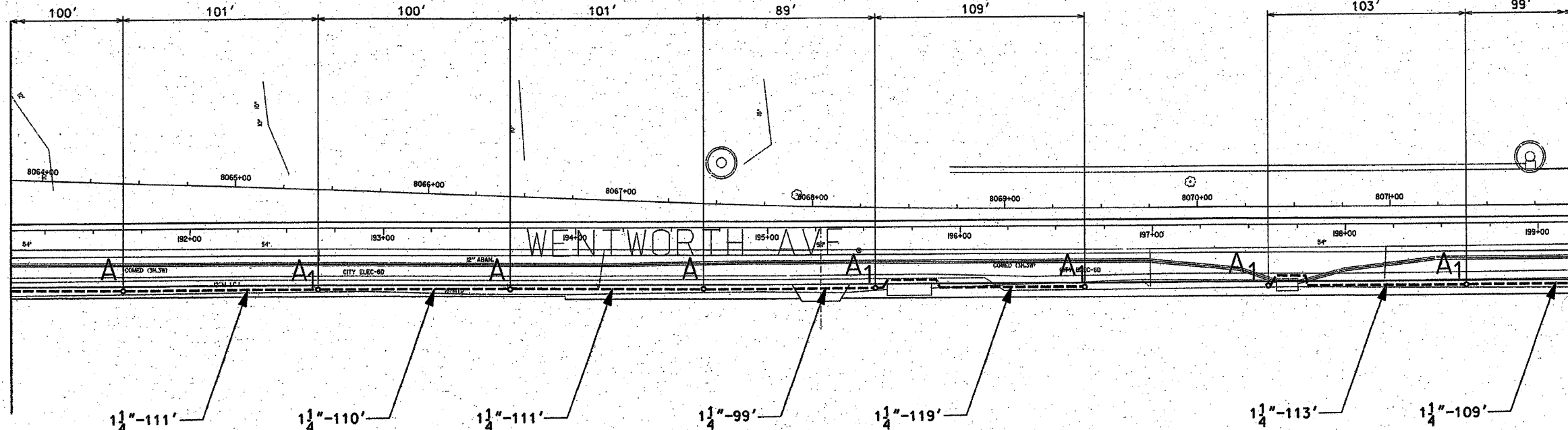

MATCH LINE
STATION 199+15

MATCH LINE
STATION 199+15

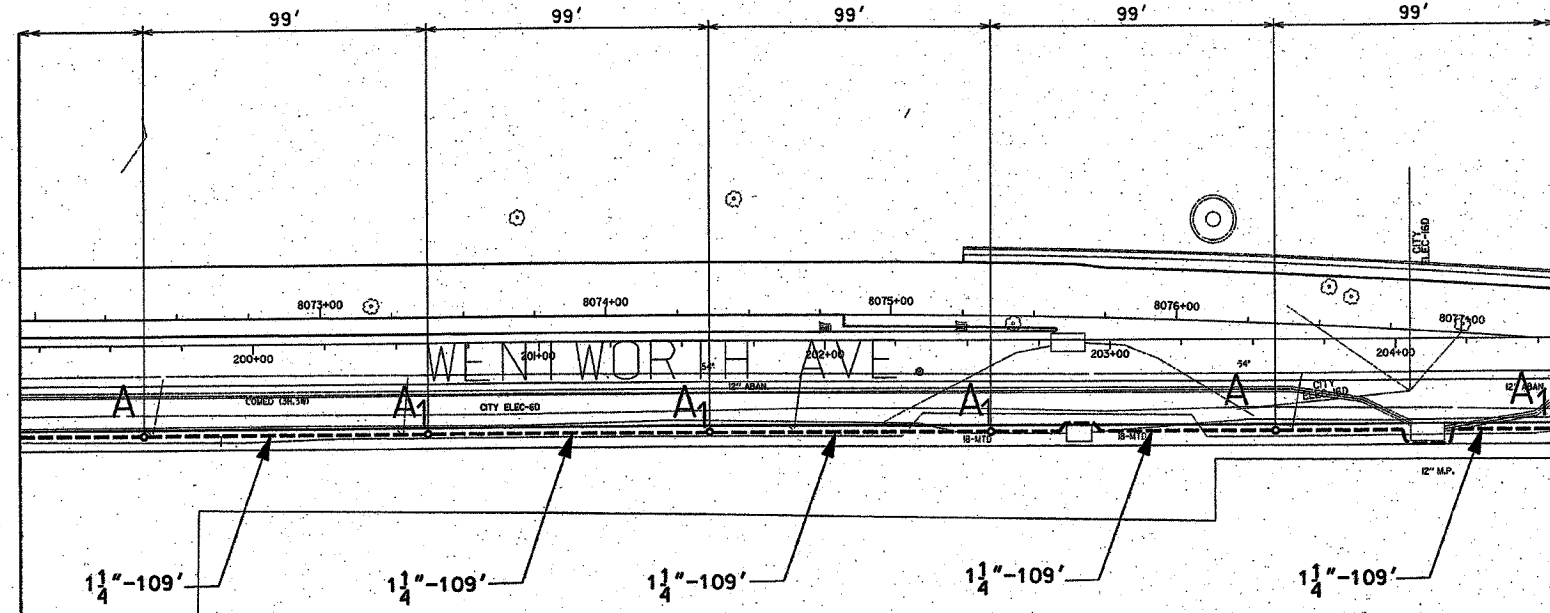

MATCH LINE
STATION 204+60
SEE SHEET 04-015

NOTES: CONTRACTOR IS TO INSTALL UNDERGROUND CONDUIT AND PULL ROPE BETWEEN FOUNDATIONS AS WELL AS PERFORM THE FOLLOWING WORK ITEMS ACCORDING TO BUREAU OF ELECTRICITY SPECIFICATIONS:

"A" - INSTALL 20" x 5' FOUNDATION, 10" B.C., 1" ANCHOR RODS AS PER DRAWING NO. 565, FLUSH IN CONCRETE SIDEWALK, 2' OFF FACE OF CURB, UNLESS NOTED OTHERWISE.

"A1" - INSTALL 20" x 5' OFFSET FOUNDATION, 10" B.C., 1" ANCHOR RODS SIMILAR AS PER DRAWING NO. 937, 2' OFF FACE OF CURB, UNLESS NOTED OTHERWISE. BUILD FOUNDATION FLUSH WITH SIDEWALK.

"B" - INSTALL 30" HANDHOLE AS PER DRAWING NO. 867 WITH 24" FRAME AND COVER.

1 1/4" DIRECT BORED CONDUIT SCHEDULE #80 AS PER IDOT ARTICLE 810.03
CONCRETE FOUNDATION - 5' x 20", 10" B.C., 1" ANCHOR RODS
OFFSET CONCRETE FOUNDATION - 5' x 20", 10" B.C., 1" ANCHOR RODS

FOR INSTALLATION PLAN SEE SHEET 04-023
FOR REMOVAL PLAN SEE SHEET 04-029

CITY OF CHICAGO			
DEPT. OF STREETS AND SANITATION			
BUREAU OF ELECTRICITY			
DIVISION OF ELECTRICAL ENGINEERING			
DRAFTSMAN: P.R.S./ B.T.G.	CHIEF DRAFTSMAN: ROBERT CARTER	ENGINEER: P.R.S./ B.T.G.	
SUPERVISING ENGINEER:	ELEC. DESIGN ENGR.		DWG. NO. 04-014
ENGINEER OF ELECTRICITY:			
GEN'L SUPT. OF ELECTRICITY:			
DEPUTY COMMISSIONER:			
SIZE: 22" x 36"	SCALE: 1"=30'	DATE: 1/20/04	
ILLINOIS DEPARTMENT OF TRANSPORTATION F.A.I. 90/94 (DAN RYAN EXPRESSWAY) 59th St. TO 47th St. (FRONTAGE ROADS)			
STREET LIGHTING UNDERGROUND CONDUIT FACILITIES			
SCALE: 1" = 30'		DRAWN BY: B.T.G.	
DATE: February 11, 2005		CHECKED BY: O.L.	

REVISIONS	
NAME	DATE