

F.A.I. RTE.	SECTION	COUNTY	TOTAL SHEETS	SHEET NO.
290	0305-302K-L3	COOK	17	17
STA.	TO STA.			
FED. ROAD DIST. NO.	ILLINOIS FED. AID PROJECT			

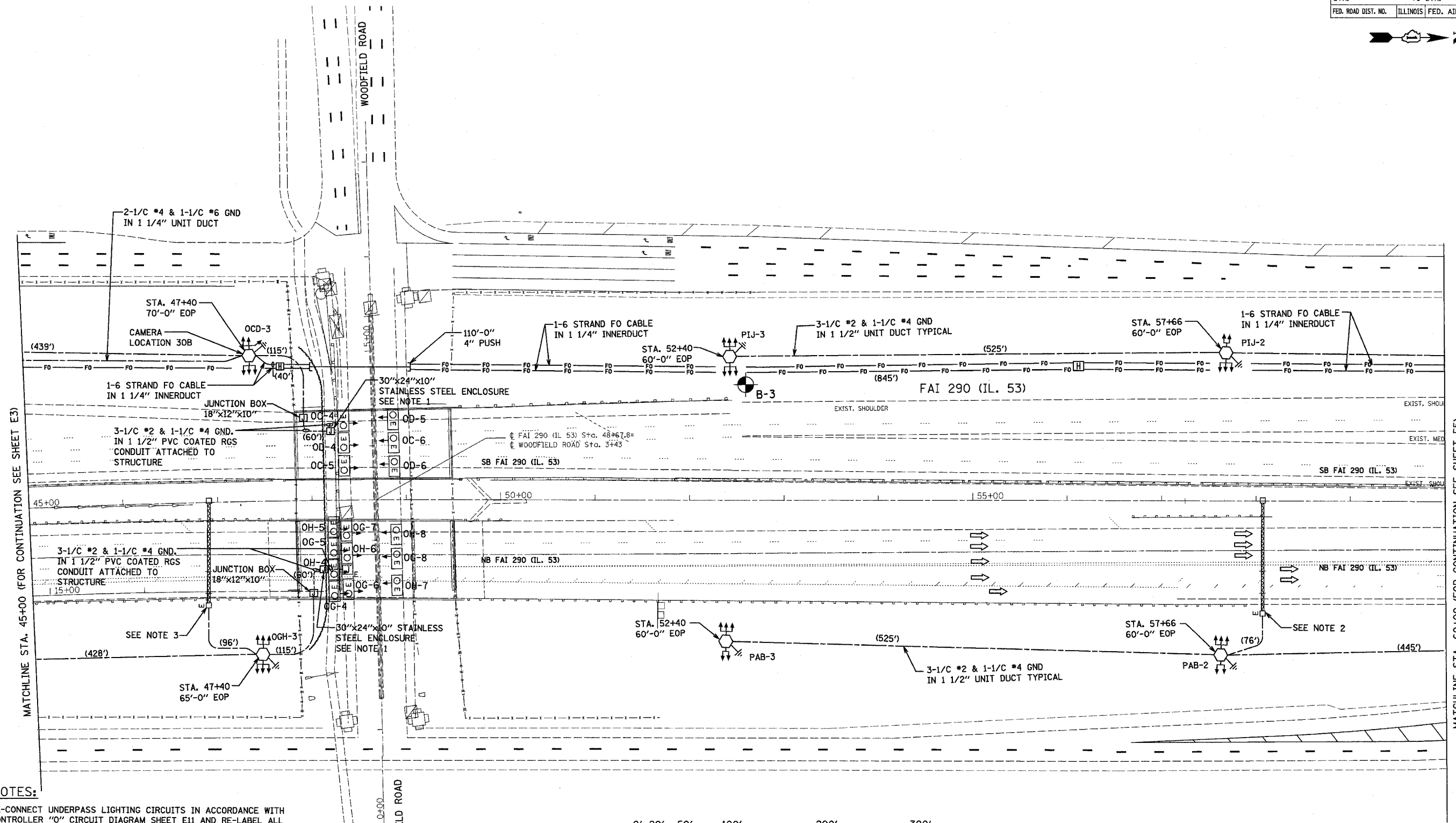

NOTES:

- RE-CONNECT UNDERPASS LIGHTING CIRCUITS IN ACCORDANCE WITH CONTROLLER "O" CIRCUIT DIAGRAM SHEET E11 AND RE-LABEL ALL ASSOCIATED LUMINAIRE NUMBERING DECALS. SEE DETAIL#4 SHEET E17 FOR TRANSFORMER MOUNTING DETAILS.
- REMOVE EXISTING STEP-DOWN TRANSFORMERS. EXTEND SIGN LUMINAIRE CIRCUITS TO LOAD SIDE OF EXISTING DISCONNECT SWITCH. CONNECT LINE SIDE OF EXISTING DISCONNECT SWITCH TO PROPOSED LIGHTING CIRCUIT IN ACCORDANCE WITH CIRCUIT DIAGRAM, SHEET E12.
- REMOVE EXISTING STEP-DOWN TRANSFORMERS. EXTEND SIGN LUMINAIRE CIRCUITS TO LOAD SIDE OF EXISTING DISCONNECT SWITCH. CONNECT LINE SIDE OF EXISTING DISCONNECT SWITCH TO PROPOSED LIGHTING CIRCUIT IN ACCORDANCE WITH CIRCUIT DIAGRAM, SHEET E11.

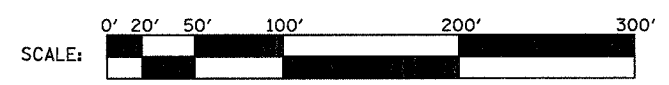

PLOT DATE = 04/28/2005
 FILE NAME = #FILE#
 PLOT SCALE = #SCALE#
 REFERENCE = #REF#

HOH HARRY O. HETTER - ASSOCIATES, INC.
 DESIGN AND CONSULTING ENGINEERS
 53 East Jackson Blvd.
 Chicago, Illinois 60604
 312/346-8131

PROJECT NUMBER: 2672
 PROJECT PATH: G:\PROJECTS\0872\08NS\FINAL_04_01_05\SEGMENT 1\LIGHTING

REVISIONS	
NAME	DATE

ILLINOIS DEPARTMENT OF TRANSPORTATION

LIGHTING PLAN
ILLINOIS ROUTE 53
I-53 AT WOODFIELD RD.

SCALE: VERT. 1"=50'
 HORIZ. DATE 02-28-2005

DRAWN BY MEK
 CHECKED BY RER